

Lower Thames Crossing  
**Map Book 3: Engineering Plans**

# Lower Thames Crossing map books

The three map books for the community impacts consultation contain plans of our proposals, under the following headings:

- Map book 1: General Arrangements (layout plans)
- Map book 2: Land Use Plans
- Map book 3: Engineering Plans

The orientation of Map Books 1 and 2 has been updated to enable all drawings to have a north up orientation.

These plans also show the changes we have made since our design refinement consultation last year and are published for the purposes of this consultation. Following this consultation, we will consider the feedback received and use that to inform our Development Consent Order (DCO) application, which we plan to submit to the Planning Inspectorate later this year.

The plans run from the A2 in the south to the M25 in the north. Identically numbered sheets in the Map Books 1 and 2 show the same area. For example sheet 3 shows the A2/LTC junction in Map Books 1 and 2.

## Map Book 1: General Arrangements

The General Arrangements show the proposed layout of the project, including:

- Permanent works; new roads, earthworks and roadside features
- Construction compounds
- Environment mitigation; landscaping and tree planting
- Utilities diversions
- Order Limits (previously known as the development boundary)
- Open space and replacement land

**NB:** The key plans show the relative location of each drawing sheet within the map book and the area they cover. On sheets where there is no information on the key plans, this represents drawings where works are being carried out away from the main route alignment.

## Map Book 2: Land Use Plans

The land use plans show the areas of land we are seeking powers to compulsorily acquire or to acquire rights on, under or over. They also show the land we require temporary powers to use, to construct and operate the project. Areas we may need to purchase interests or rights over include the land required for the permanent works, temporary works, compensation land and replacement land.

### Permanent works

Compulsory purchase of land or compulsory acquisition of rights will be required for the route of the road, to re-connect local roads and for associated structures like drainage ponds and the tunnel control building. In some land parcels, only the acquisition of subsoil will be required. For example, the construction of the tunnel beneath the River Thames.

### Temporary works

Temporary use of land is needed for the project's construction works and to provide sufficient space to do so safely. The land use plans show land that may be required temporarily for the main construction compounds at the tunnel entrances north and south of the River Thames, and at various locations along the route. We will also require permanent and temporary rights over land to divert utilities such as gas pipelines, electricity cables and water pipes.

### Compensation land

Compensation land may include environmental protection measures such as habitat creation and flood compensation. This land may also need to be permanently acquired or be subject to permanent rights.

### Replacement land

Land is also included in respect of the replacement of special category land such as open space, or common land which is being compulsorily acquired or in respect of which permanent rights are sought.

## Map Book 3: Engineering Plans

This book contains engineering drawings in the following order:

- The plan and profile drawings which detail the vertical and horizontal road alignment
- The junction arrangements showing the proposed layout
- The cross sections throughout the route showing the lanes and earthworks

The plan and profile drawings show the highway details of the route in plan and profile (level above or below existing ground). The drawings are split into two views with the plan on the top and profile underneath.

The profile gives the road level in relation to existing ground at a given chainage\*. An exaggerated scale is used in the profile to help show the differences in levels and gradients of the design. The profile also shows where existing roads and public rights of way cross over or under the route.

All levels are given in relation to the Above Ordnance Datum level\*\* the profile reference level might be different on each drawing.

\* Chainage measures the distance along the route in metres.

\*\* Above Ordnance Datum level (AOD) is a measurement above mean sea level taken from a reference point at Newlyn in Cornwall.

## Large maps

Large maps that cover a greater area have also been produced, which detail the following:

- Environmental constraints – 1 sheet
- Land use – 6 sheets
- Operation (General Arrangements – 6 sheets larger coverage)
- Construction (Compounds and Access - 6 sheets)
- General Arrangement (full route) – 1 sheet
- Aerial view of the proposed LTC route – 1 sheet

Main works access routes shown on these maps represent a snapshot in time. They will evolve in line with the surrounding works.



LEGEND:  
 Lower Thames Crossing (LTC)

Client



Project

**PROPOSALS FOR CONSULTATION**

LOWER THAMES CROSSING  
 COMMUNITY IMPACTS CONSULTATION

Drawing title

**PLAN AND PROFILE  
 KEY PLAN**

**LEGEND - PLAN**

	Earthworks - Cutting
	Structure
	Retaining wall
	Emergency area
	Earthworks - Embankment

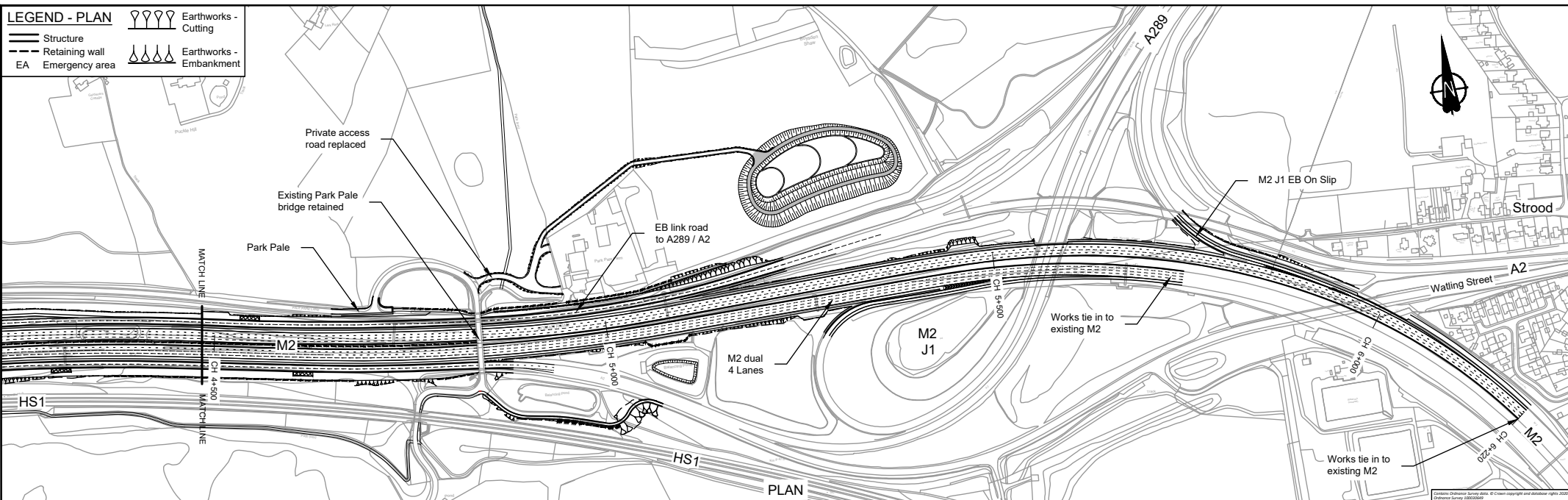

**LEGEND - PROFILE**

	Route Vertical Alignment
	Existing Ground Profile
	Structure - Bridge
	Structure - Underpass

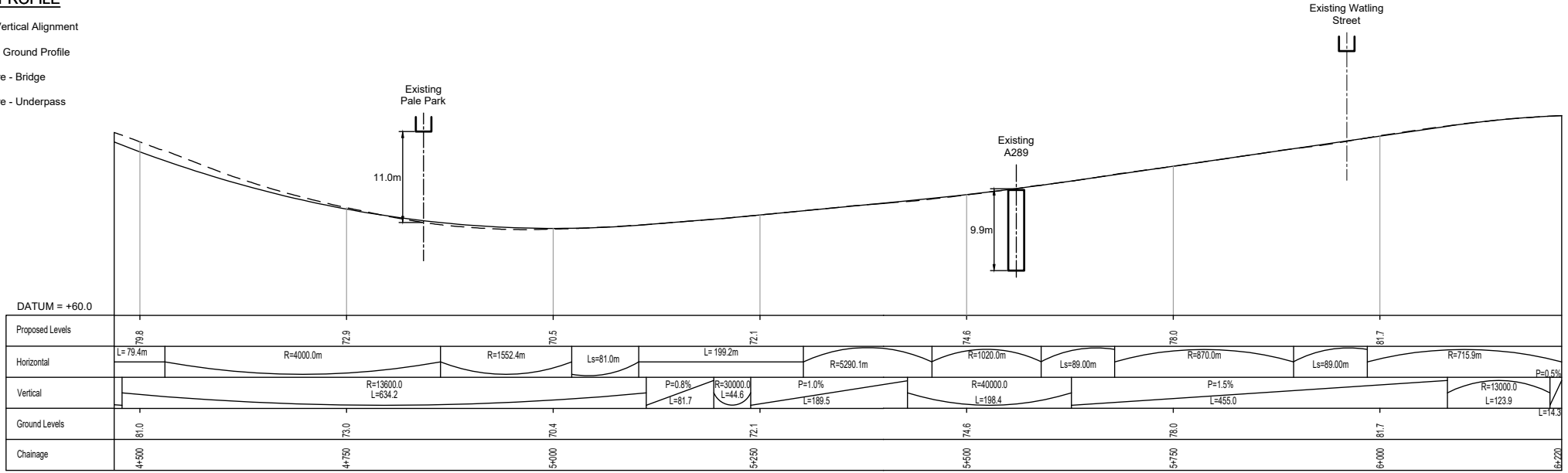

- NOTES**
- Do not scale from this drawing.
  - All dimensions are in metres unless stated otherwise.
  - All levels are in metres relative to the Ordnance Datum.
  - For scheme location refer to Plan and Profile Key Plan.
  - Profile uses an exaggerated scale of 1 horizontal :10 vertical

NB - Northbound  
WB - Westbound  
EB - Eastbound  
SB - Southbound

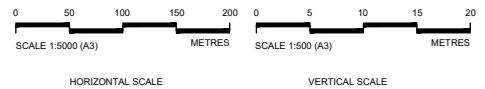

Client

**PROPOSALS FOR CONSULTATION**

Project LOWER THAMES CROSSING  
COMMUNITY IMPACTS CONSULTATION

Drawing title **PLAN AND PROFILE SHEET 1**

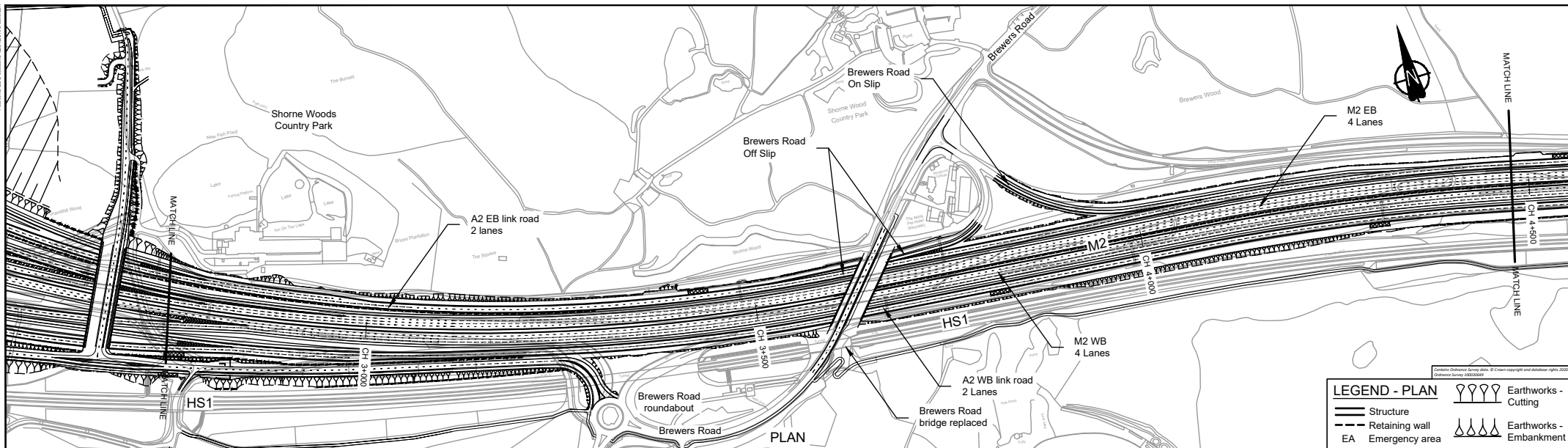

**LEGEND - PLAN**

	Structure		Earthworks - Cutting
	Retaining wall		Earthworks - Embankment
	EA Emergency area		

**LEGEND - PROFILE**

- Route Vertical Alignment
- Existing Ground Profile
- Structure - Bridge
- Structure - Underpass

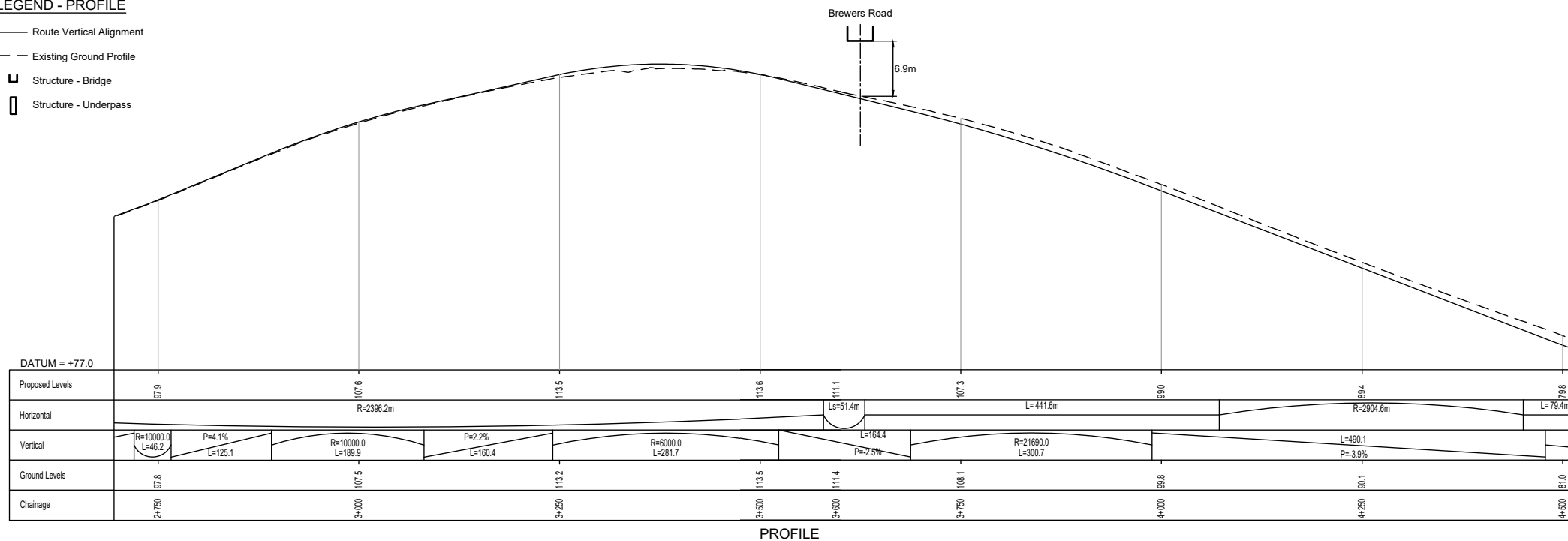

- NOTES**
- Do not scale from this drawing.
  - All dimensions are in metres unless stated otherwise.
  - All levels are in metres relative to the Ordnance Datum.
  - For scheme location refer to Plan and Profile Key Plan.
  - Profile uses an exaggerated scale of 1 horizontal :10 vertical

NB - Northbound  
WB - Westbound  
EB - Eastbound  
SB - Southbound



Client

**PROPOSALS FOR CONSULTATION**

Project LOWER THAMES CROSSING  
COMMUNITY IMPACTS CONSULTATION

Drawing title **PLAN AND PROFILE SHEET 2**

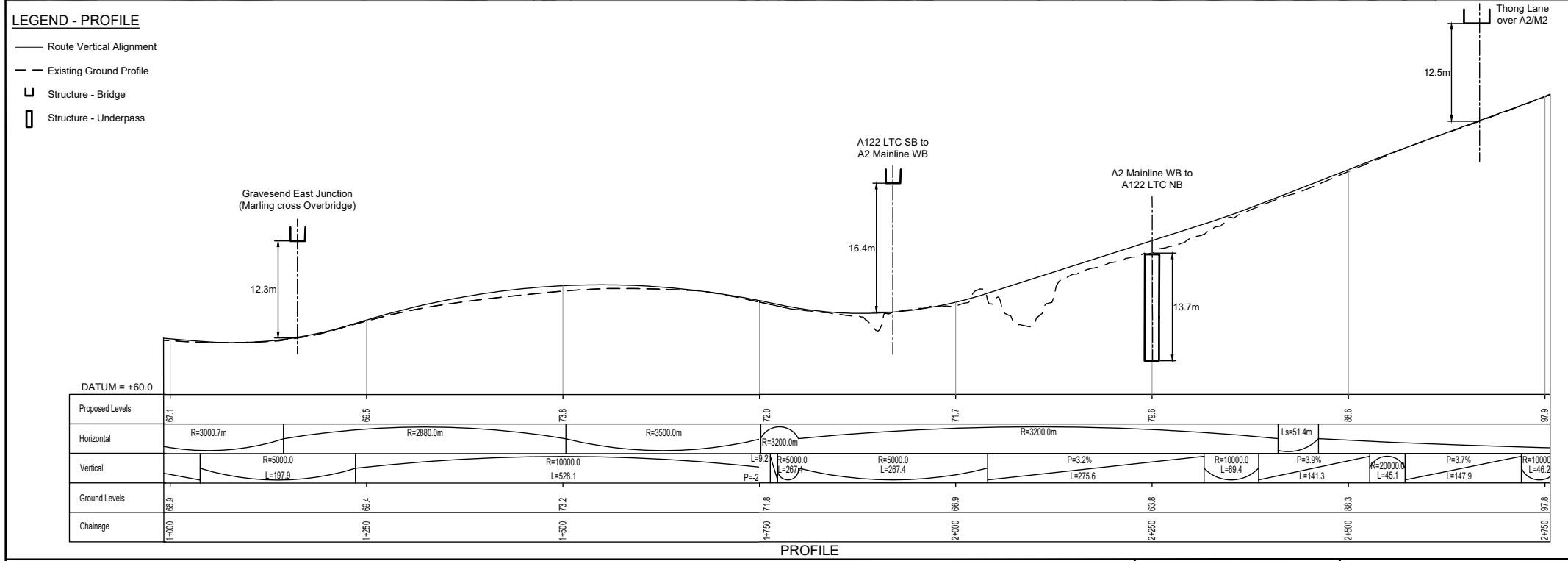
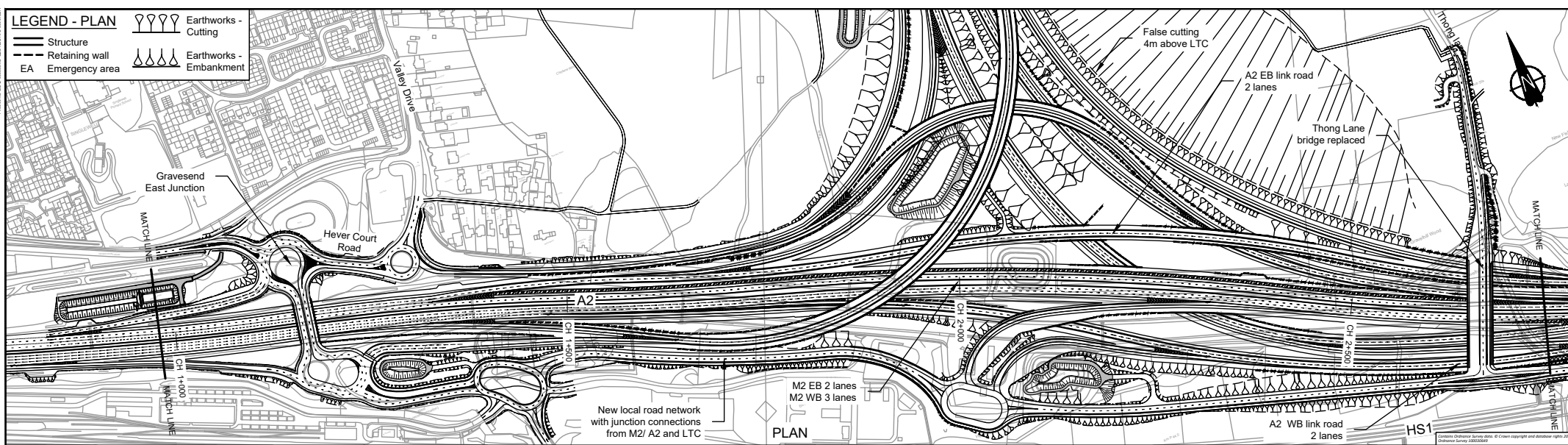

- NOTES**
- Do not scale from this drawing.
  - All dimensions are in metres unless stated otherwise.
  - All levels are in metres relative to the Ordnance Datum.
  - For scheme location refer to Plan and Profile Key Plan.
  - Profile uses an exaggerated scale of 1 horizontal :10 vertical

NB - Northbound  
WB - Westbound  
EB - Eastbound  
SB - Southbound

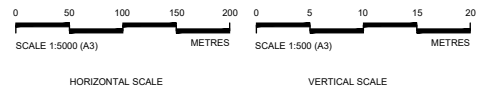

Client **highways england**

**PROPOSALS FOR CONSULTATION**

Project **LOWER THAMES CROSSING COMMUNITY IMPACTS CONSULTATION**

Drawing title **PLAN AND PROFILE SHEET 3**

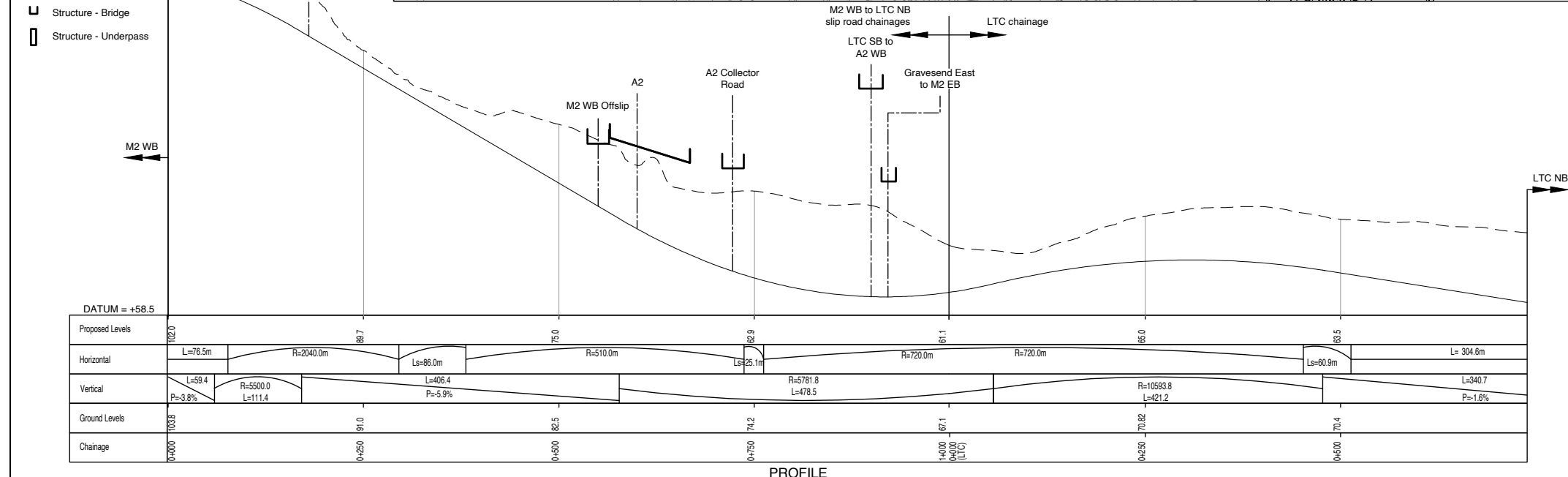
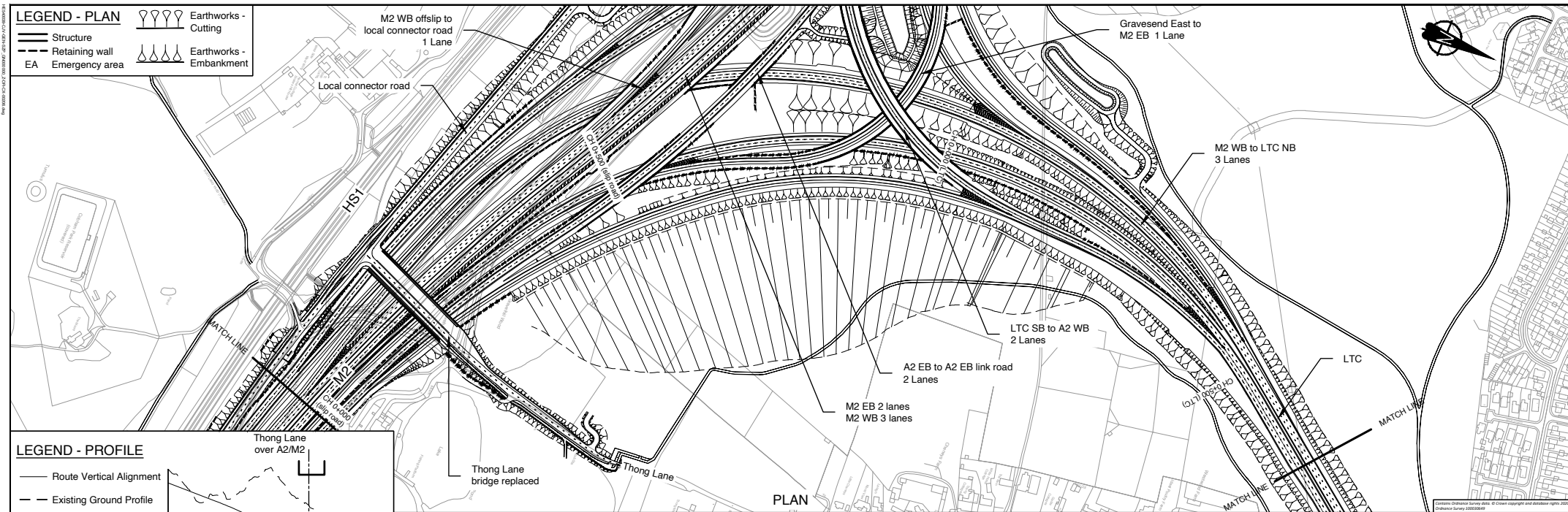

- NOTES**
- Do not scale from this drawing.
  - All dimensions are in metres unless stated otherwise.
  - All levels are in metres relative to the Ordnance Datum.
  - For scheme location refer to Plan and Profile Key Plan.
  - Profile uses an exaggerated scale of 1 horizontal :10 vertical

NB - Northbound  
WB - Westbound  
EB - Eastbound  
SB - Southbound

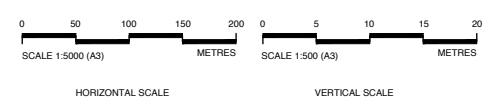

Client: highways england

Project: LOWER THAMES CROSSING COMMUNITY IMPACTS CONSULTATION

Drawing title: **PROPOSALS FOR CONSULTATION**

Sheet title: **PLAN AND PROFILE SHEET 3a**

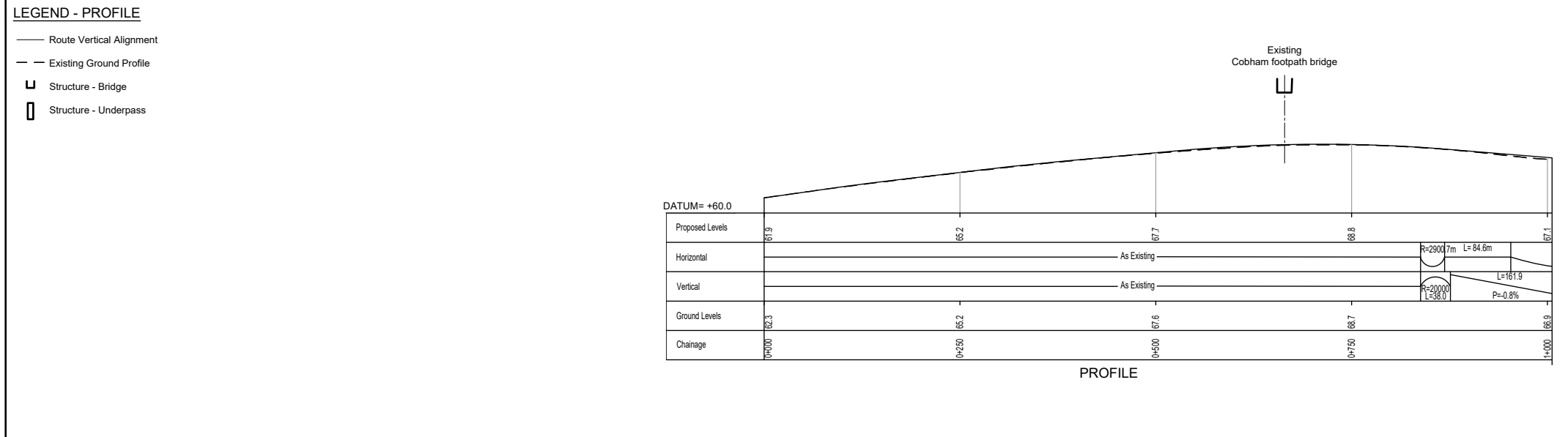
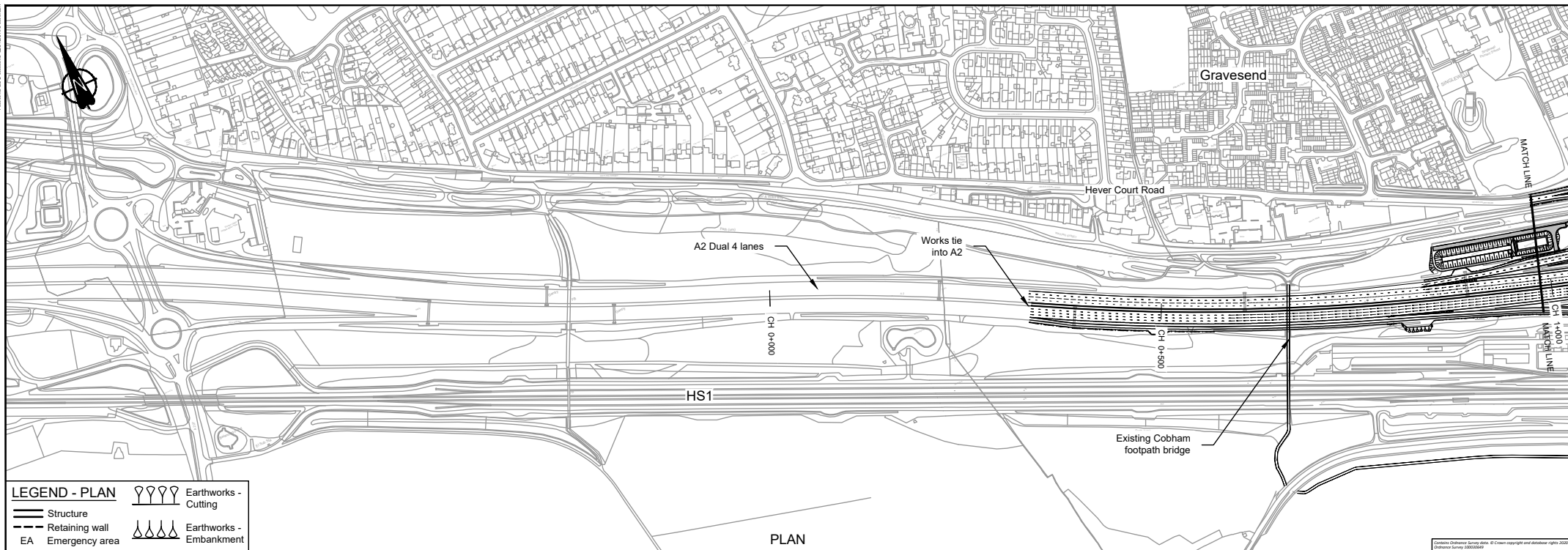

**NOTES**

- Do not scale from this drawing.
- All dimensions are in metres unless stated otherwise.
- All levels are in metres relative to the Ordnance Datum.
- For scheme location refer to Plan and Profile Key Plan.
- Profile uses an exaggerated scale of 1 horizontal :10 vertical

NB - Northbound  
 WB - Westbound  
 EB - Eastbound  
 SB - Southbound



Client

**PROPOSALS FOR CONSULTATION**

Project LOWER THAMES CROSSING  
 COMMUNITY IMPACTS CONSULTATION

Drawing title **PLAN AND PROFILE SHEET 4**



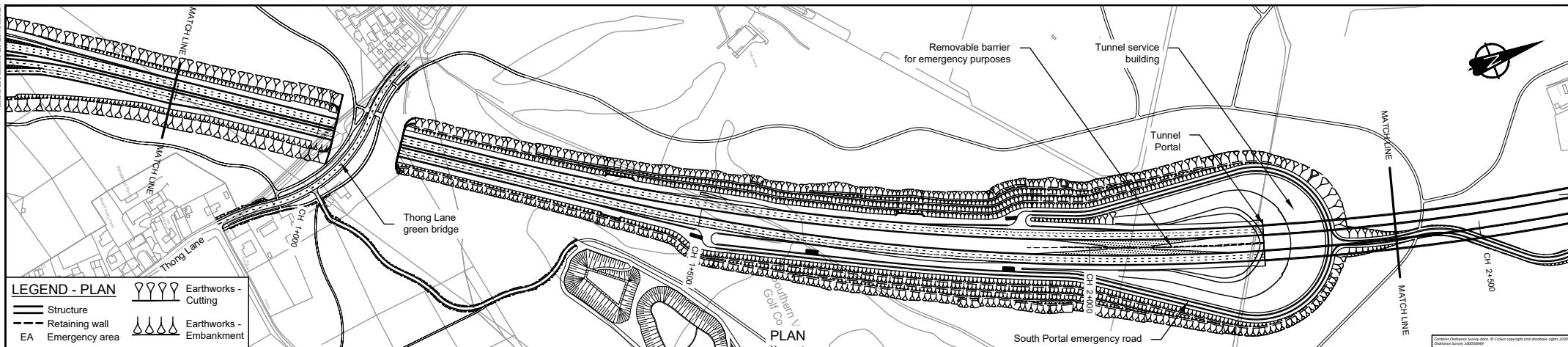

**LEGEND - PLAN**

	Structure		Earthworks - Cutting
	Retaining wall		Earthworks - Embankment
	EA		

**LEGEND - PROFILE**

	Route Vertical Alignment
	Existing Ground Profile
	Structure - Bridge
	Structure - Underpass

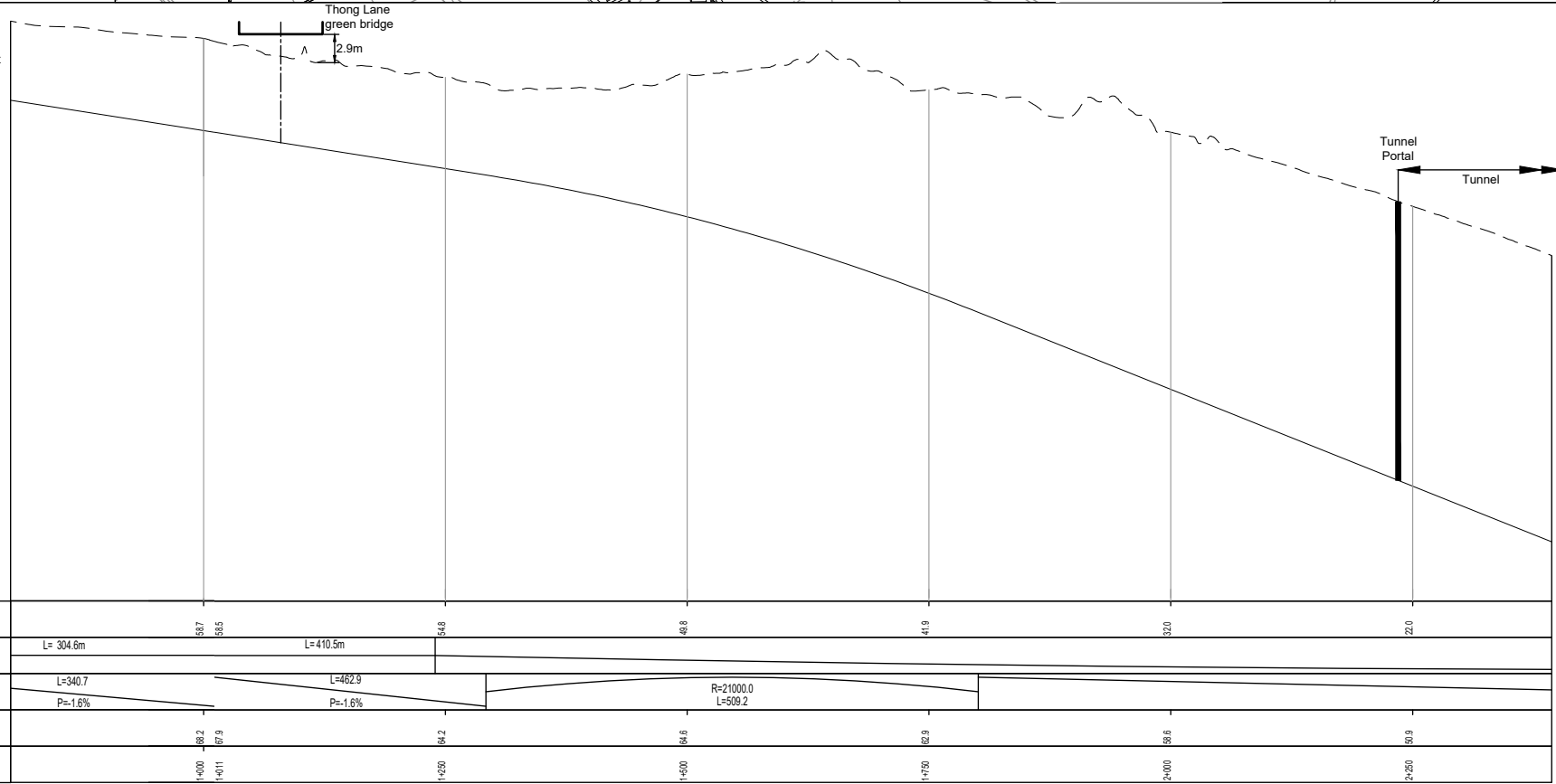

DATUM = +10.0

Proposed Levels		58.7	58.5	54.8	49.8	41.9	32.0	22.0
Horizontal	L= 304.6m		L= 410.5m					
Vertical	L=340.7 P=-1.6%		L=462.9 P=-1.6%		R=21000.0 L=509.2			
Ground Levels		68.2	67.9	64.2	64.6	62.9	58.6	50.9
Chainage		1+000	1+011	1+230	1+500	1+750	2+000	2+250

**PROFILE**

**NOTES**

- Do not scale from this drawing.
- All dimensions are in metres unless stated otherwise.
- All levels are in metres relative to the Ordnance Datum.
- For scheme location refer to Plan and Profile Key Plan.
- Profile uses an exaggerated scale of 1 horizontal :10 vertical

NB - Northbound  
WB - Westbound  
EB - Eastbound  
SB - Southbound

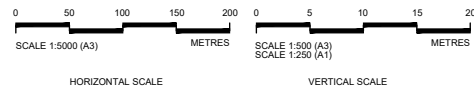

Client

**PROPOSALS FOR CONSULTATION**

Project LOWER THAMES CROSSING  
COMMUNITY IMPACTS CONSULTATION

Drawing title

**PLAN AND PROFILE SHEET 5**

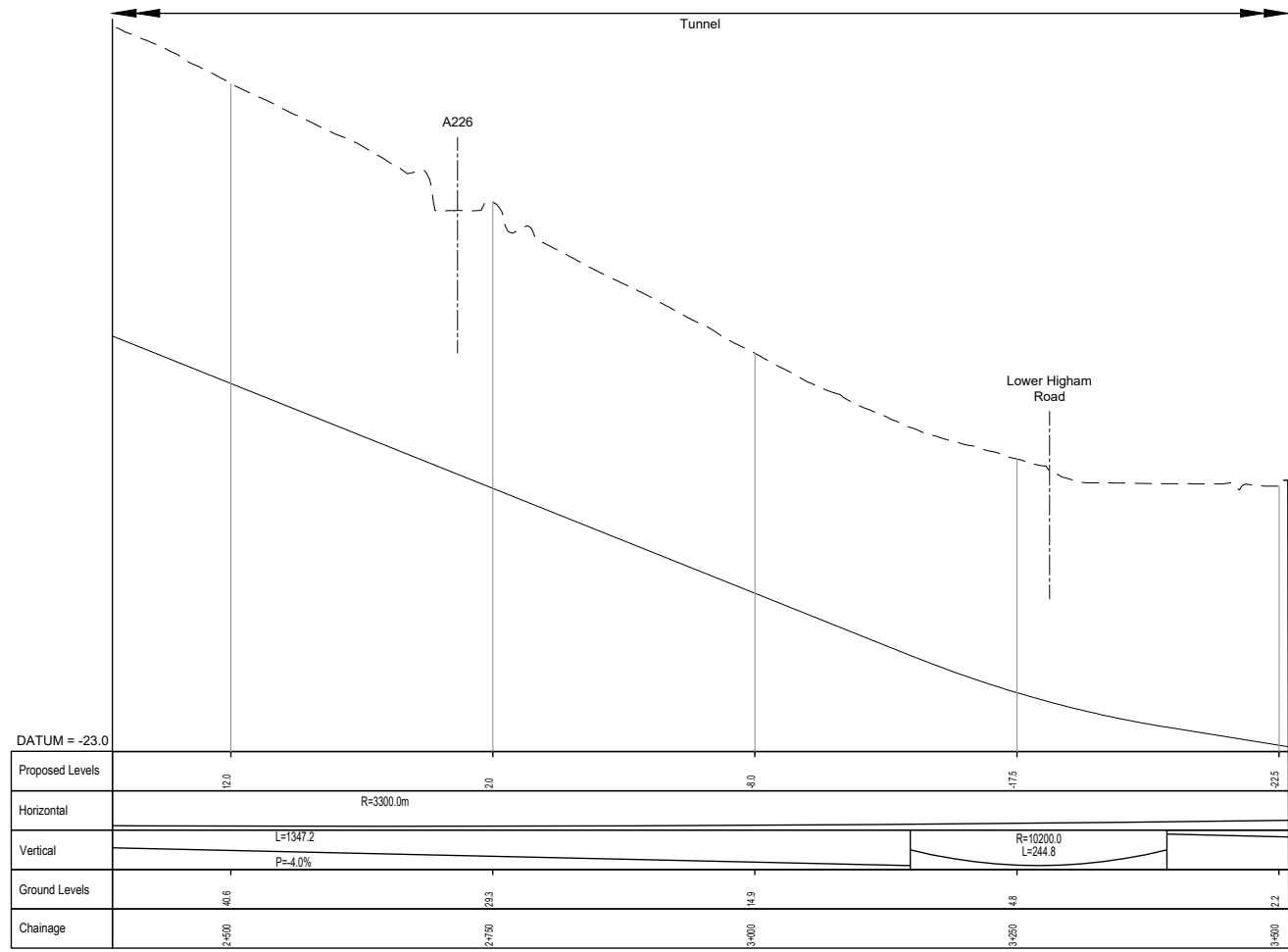
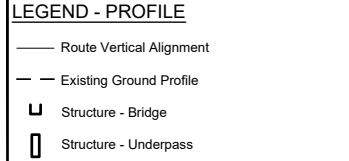
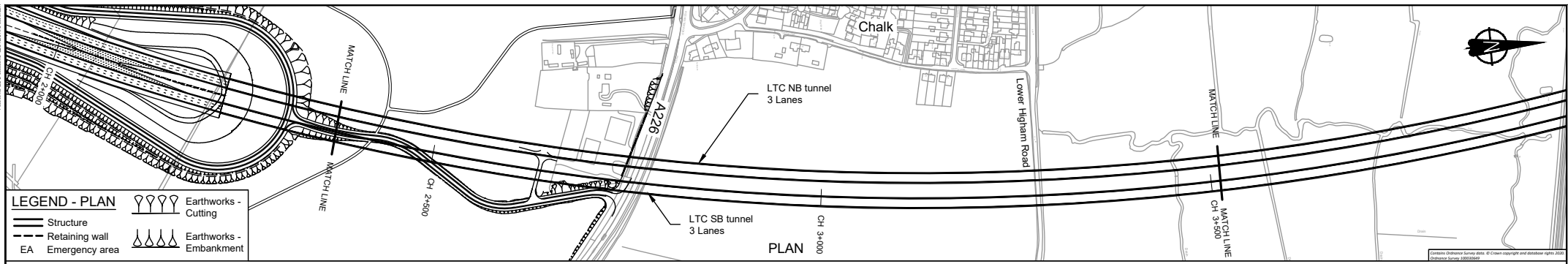

PROFILE

- NOTES**
- Do not scale from this drawing.
  - All dimensions are in metres unless stated otherwise.
  - All levels are in metres relative to the Ordnance Datum.
  - For scheme location refer to Plan and Profile Key Plan.
  - Profile uses an exaggerated scale of 1 horizontal : 5 vertical

NB - Northbound  
 WB - Westbound  
 EB - Eastbound  
 SB - Southbound

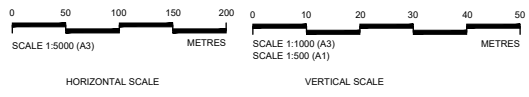

Client

**PROPOSALS FOR CONSULTATION**

Project LOWER THAMES CROSSING  
 COMMUNITY IMPACTS CONSULTATION

Drawing title

**PLAN AND PROFILE SHEET 6**

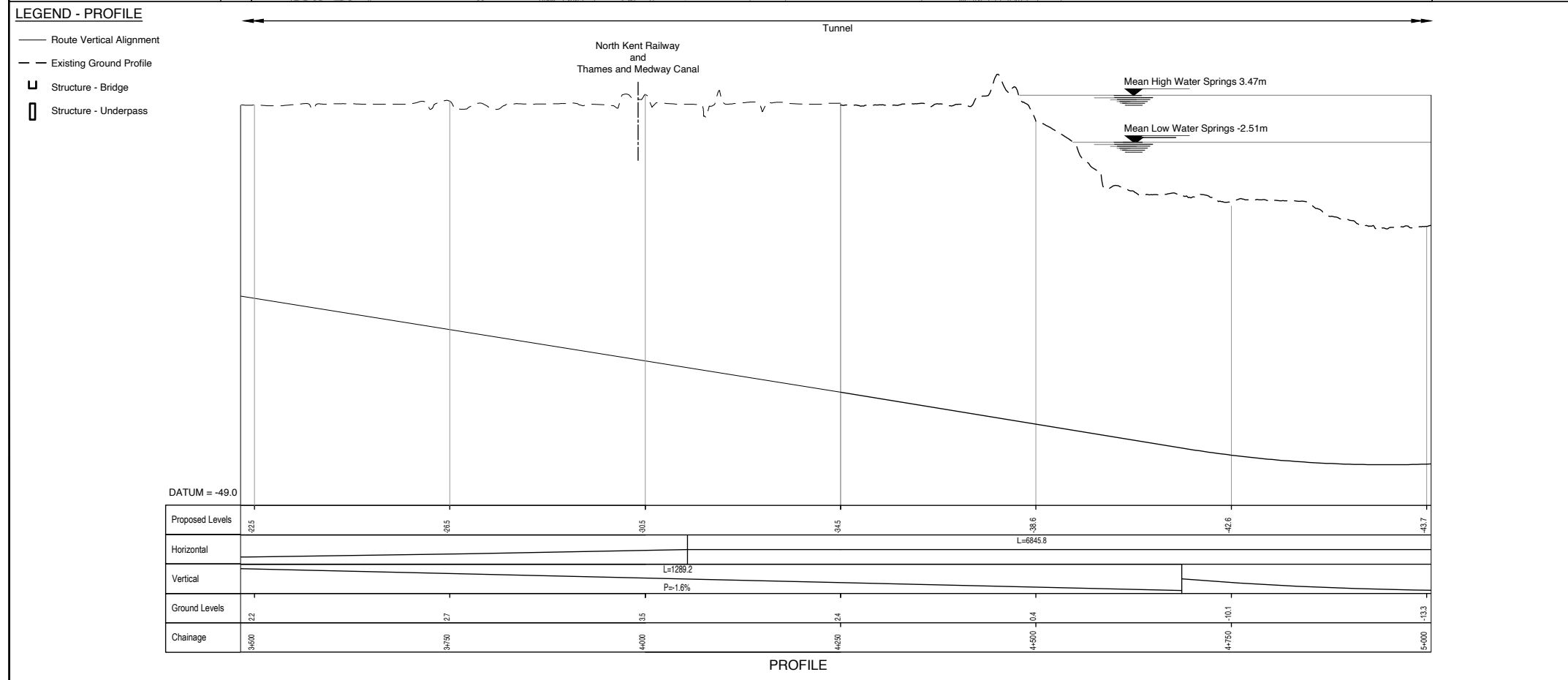
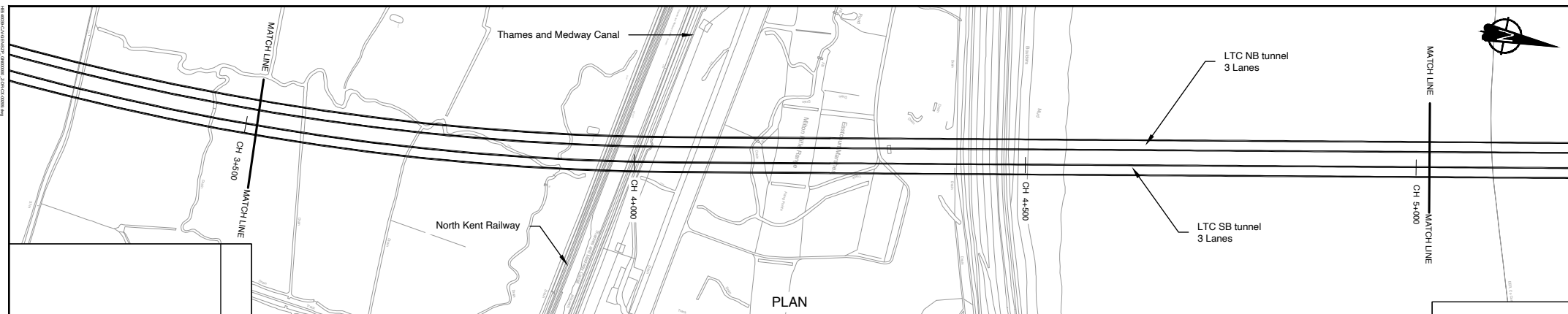

- NOTES
1. Do not scale from this drawing.
  2. All dimensions are in metres unless stated otherwise.
  3. All levels are in metres relative to the Ordnance Datum.
  4. For scheme location refer to Plan and Profile Key Plan.
  5. Profile uses an exaggerated scale of 1 horizontal :10 vertical

NB - Northbound  
 WB - Westbound  
 EB - Eastbound  
 SB - Southbound

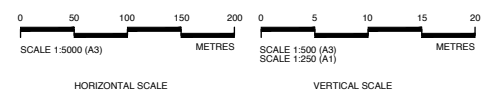

Client 

**PROPOSALS FOR CONSULTATION**

Project LOWER THAMES CROSSING  
 COMMUNITY IMPACTS CONSULTATION

Drawing title **PLAN AND PROFILE SHEET 7**

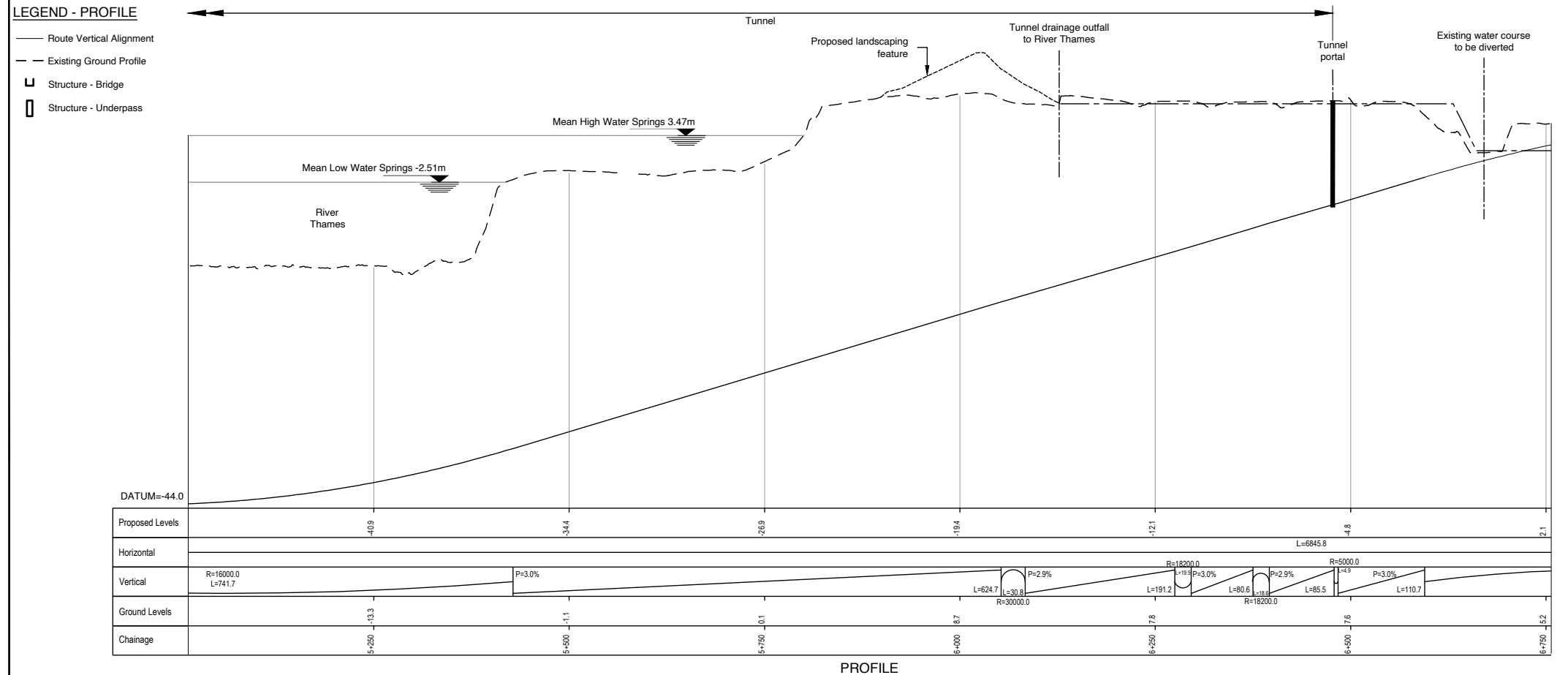
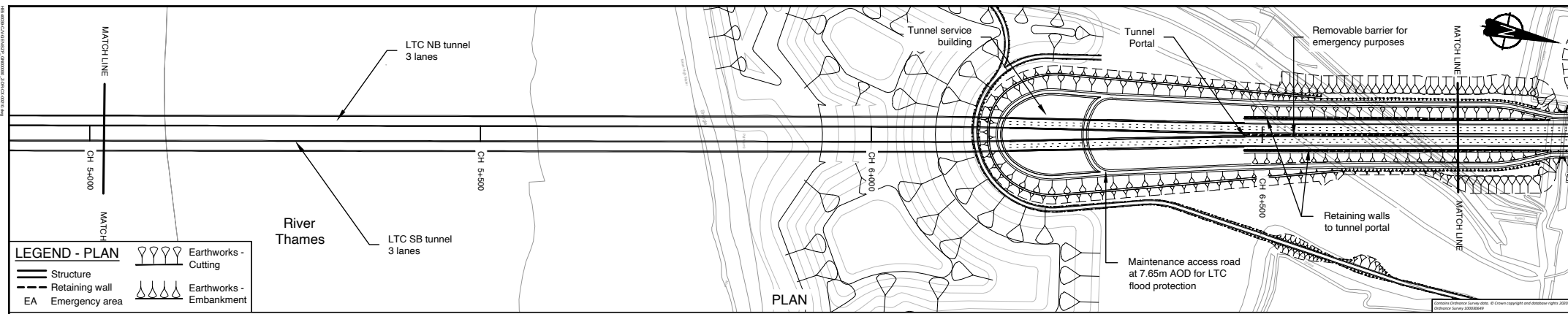

- NOTES**
- Do not scale from this drawing.
  - All dimensions are in metres unless stated otherwise.
  - All levels are in metres relative to the Ordnance Datum.
  - For scheme location refer to Plan and Profile Key Plan.
  - Profile uses an exaggerated scale of 1 horizontal :10 vertical

NB - Northbound  
WB - Westbound  
EB - Eastbound  
SB - Southbound



Client **highways england**

**PROPOSALS FOR CONSULTATION**

Project LOWER THAMES CROSSING  
COMMUNITY IMPACTS CONSULTATION

Drawing title **PLAN AND PROFILE SHEET 8**

- LEGEND - PLAN**
- Earthworks - Cutting
  - Structure
  - Retaining wall
  - EA
  - Earthworks - Embankment

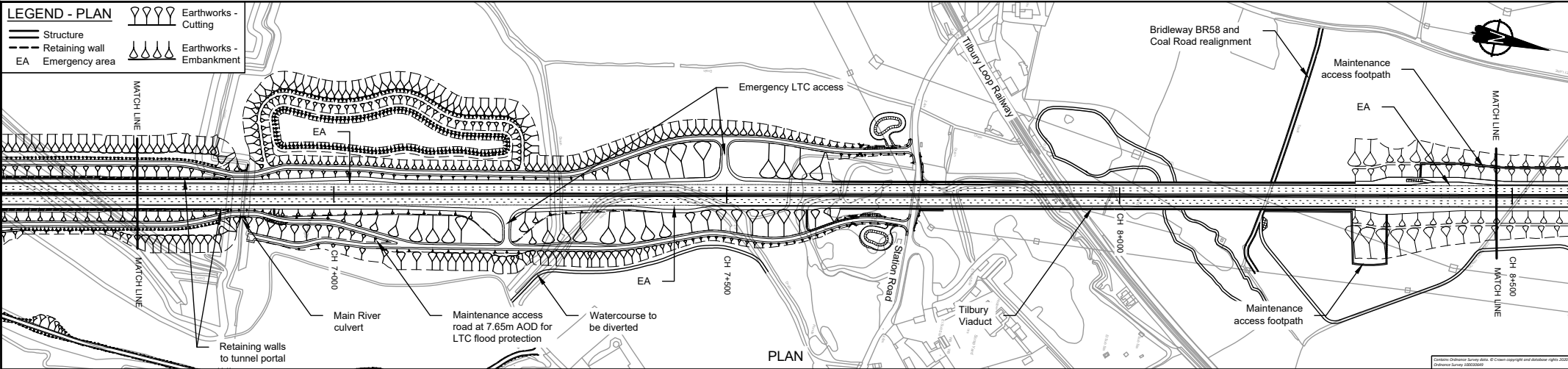

**LEGEND - PROFILE**

- Route Vertical Alignment
- Existing Ground Profile
- Structure - Bridge
- Structure - Underpass

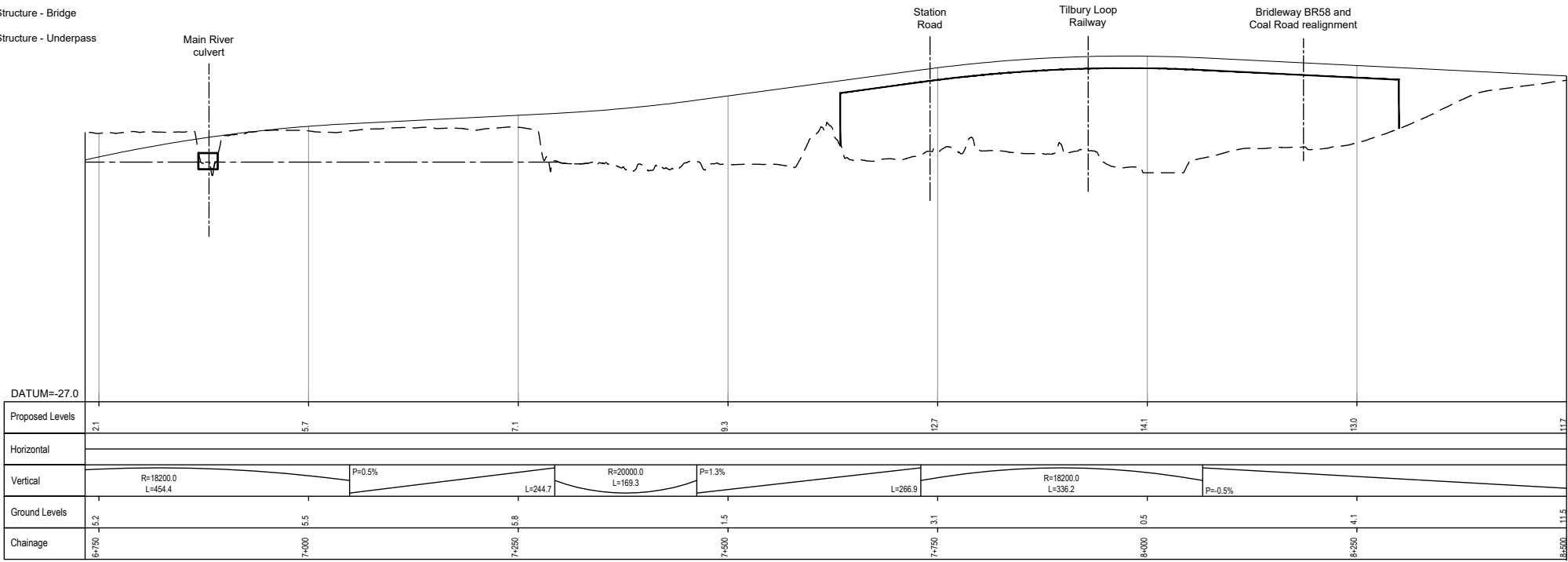

PROFILE

**NOTES**

1. Do not scale from this drawing.
2. All dimensions are in metres unless stated otherwise.
3. All levels are in metres relative to the Ordnance Datum.
4. For scheme location refer to Plan and Profile Key Plan.
5. Profile uses an exaggerated scale of 1 horizontal :10 vertical

- NB - Northbound
- WB - Westbound
- EB - Eastbound
- SB - Southbound

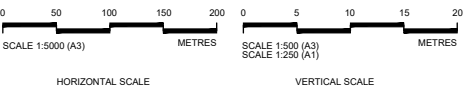

Client

**PROPOSALS FOR CONSULTATION**

Project LOWER THAMES CROSSING  
COMMUNITY IMPACTS CONSULTATION

Drawing title **PLAN AND PROFILE SHEET 9**

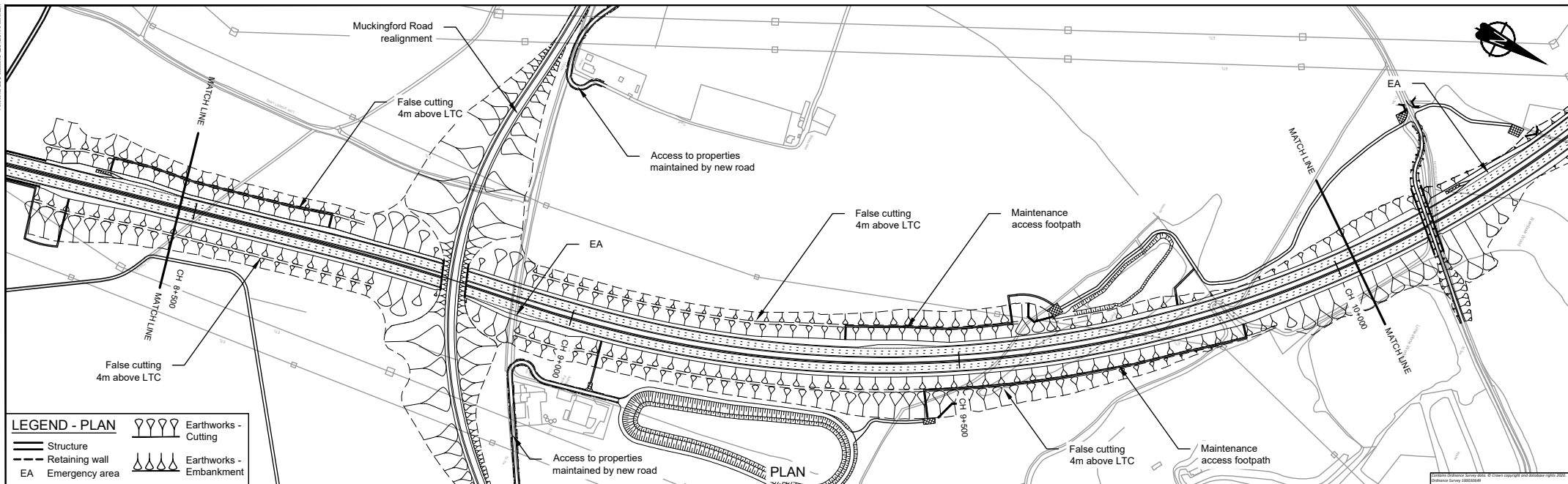

**LEGEND - PROFILE**

- Route Vertical Alignment
- Existing Ground Profile
- Structure - Bridge
- Structure - Underpass

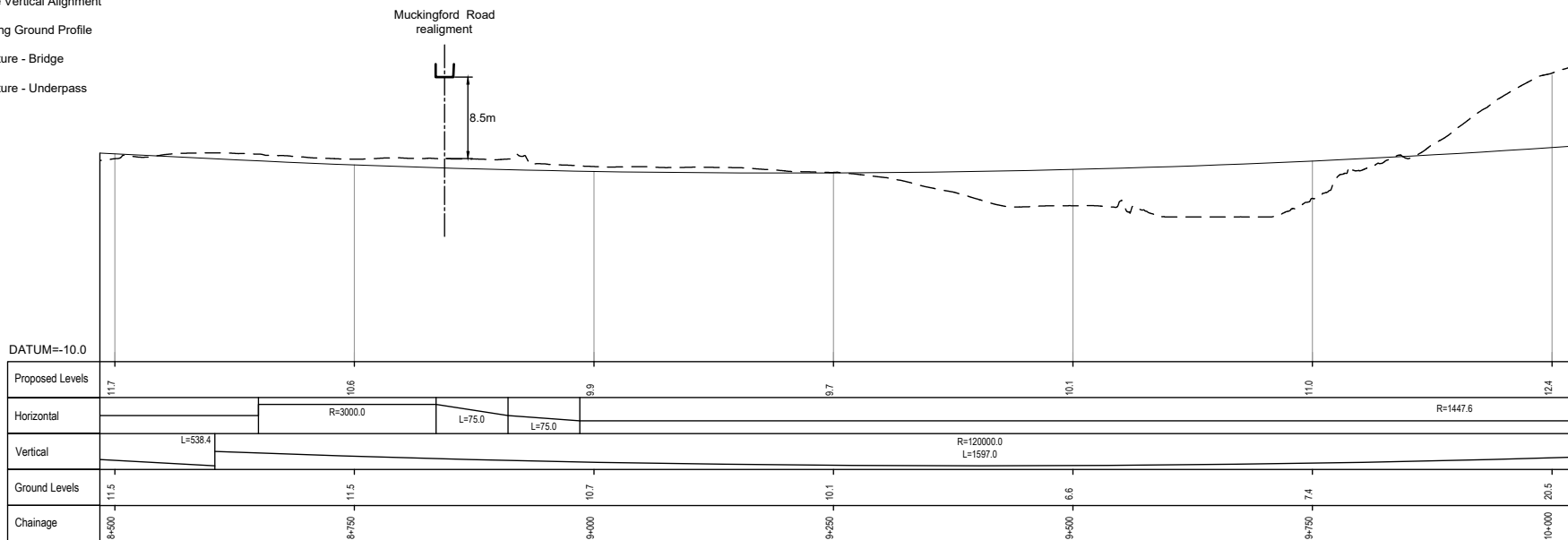

**NOTES**

- Do not scale from this drawing.
- All dimensions are in metres unless stated otherwise.
- All levels are in metres relative to the Ordnance Datum.
- For scheme location refer to Plan and Profile Key Plan.
- Profile uses an exaggerated scale of 1 horizontal :10 vertical

- NB - Northbound
- WB - Westbound
- EB - Eastbound
- SB - Southbound

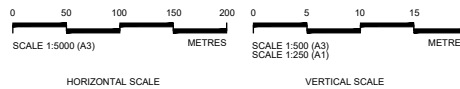

Client: **highways england**

**PROPOSALS FOR CONSULTATION**

Project: **LOWER THAMES CROSSING COMMUNITY IMPACTS CONSULTATION**

Drawing title: **PLAN AND PROFILE SHEET 10**

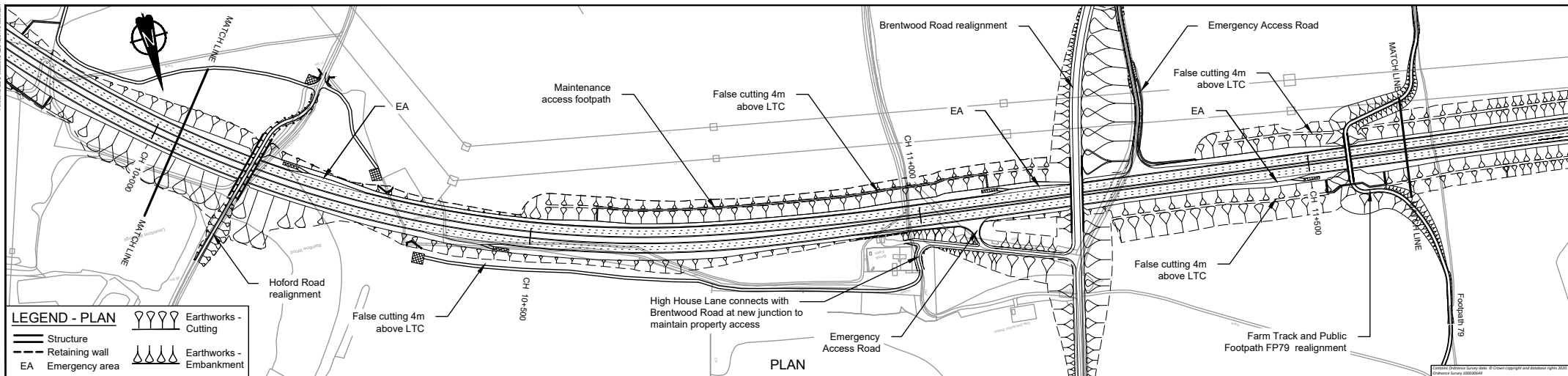

**LEGEND - PLAN**

	Earthworks - Cutting
	Structure
	Retaining wall
	Emergency area
	Earthworks - Embankment

**LEGEND - PROFILE**

	Route Vertical Alignment
	Existing Ground Profile
	Structure - Bridge
	Structure - Underpass

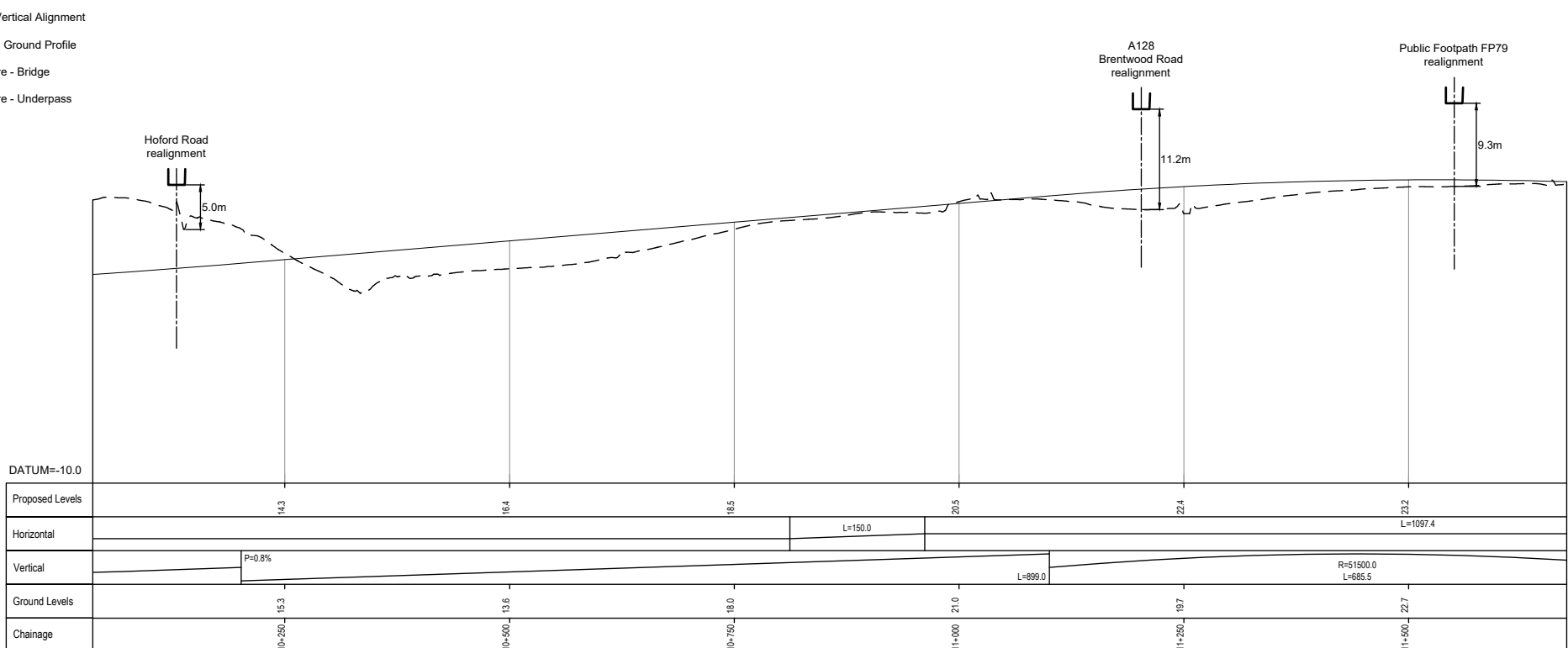

PROFILE

- NOTES**
- Do not scale from this drawing.
  - All dimensions are in metres unless stated otherwise.
  - All levels are in metres relative to the Ordnance Datum.
  - For scheme location refer to Plan and Profile Key Plan.
  - Profile uses an exaggerated scale of 1 horizontal :10 vertical

NB - Northbound  
 WB - Westbound  
 EB - Eastbound  
 SB - Southbound

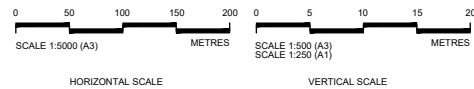

Client

**PROPOSALS FOR CONSULTATION**

Project LOWER THAMES CROSSING  
 COMMUNITY IMPACTS CONSULTATION

Drawing title **PLAN AND PROFILE SHEET 11**

**LEGEND - PLAN**

- Structure
- Retaining wall
- Emergency area
- Earthworks - Cutting
- Earthworks - Embankment

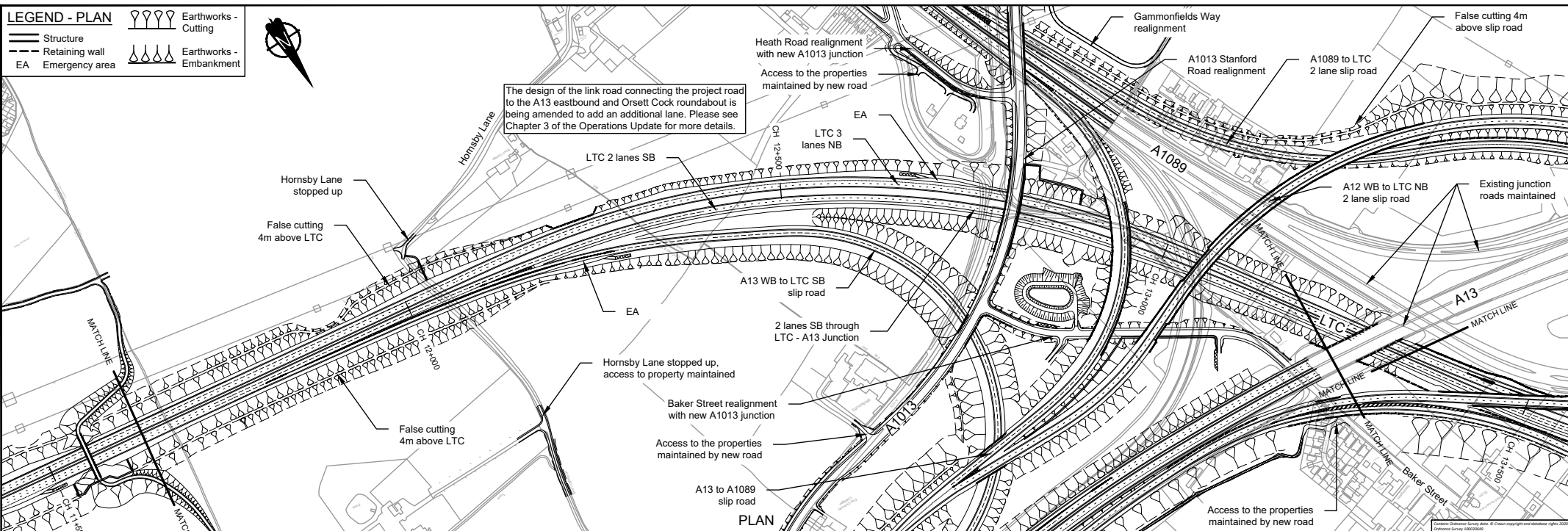

**LEGEND - PROFILE**

- Route Vertical Alignment
- Existing Ground Profile
- Structure - Bridge
- Structure - Underpass

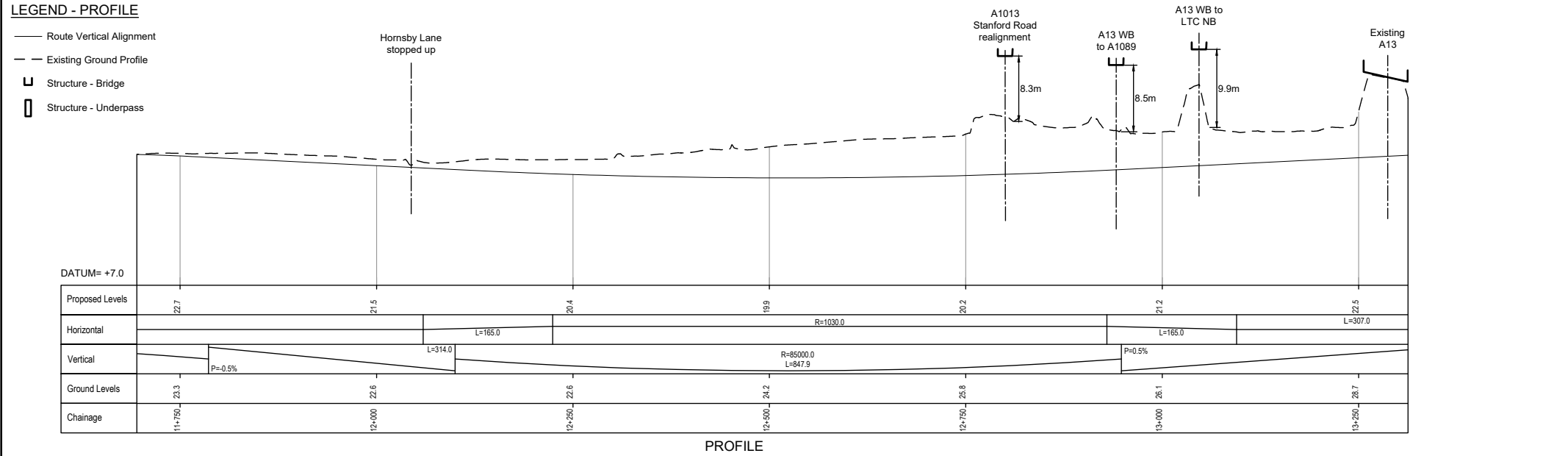

- NOTES**
1. Do not scale from this drawing.
  2. All dimensions are in metres unless stated otherwise.
  3. All levels are in metres relative to the Ordnance Datum.
  4. For scheme location refer to Plan and Profile Key Plan.
  5. Profile uses an exaggerated scale of 1 horizontal :10 vertical

NB - Northbound  
WB - Westbound  
EB - Eastbound  
SB - Southbound

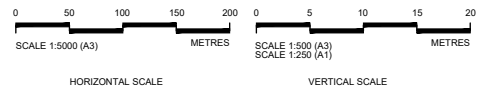

Client

**PROPOSALS FOR CONSULTATION**

Project LOWER THAMES CROSSING  
COMMUNITY IMPACTS CONSULTATION

Drawing title **PLAN AND PROFILE SHEET 12**



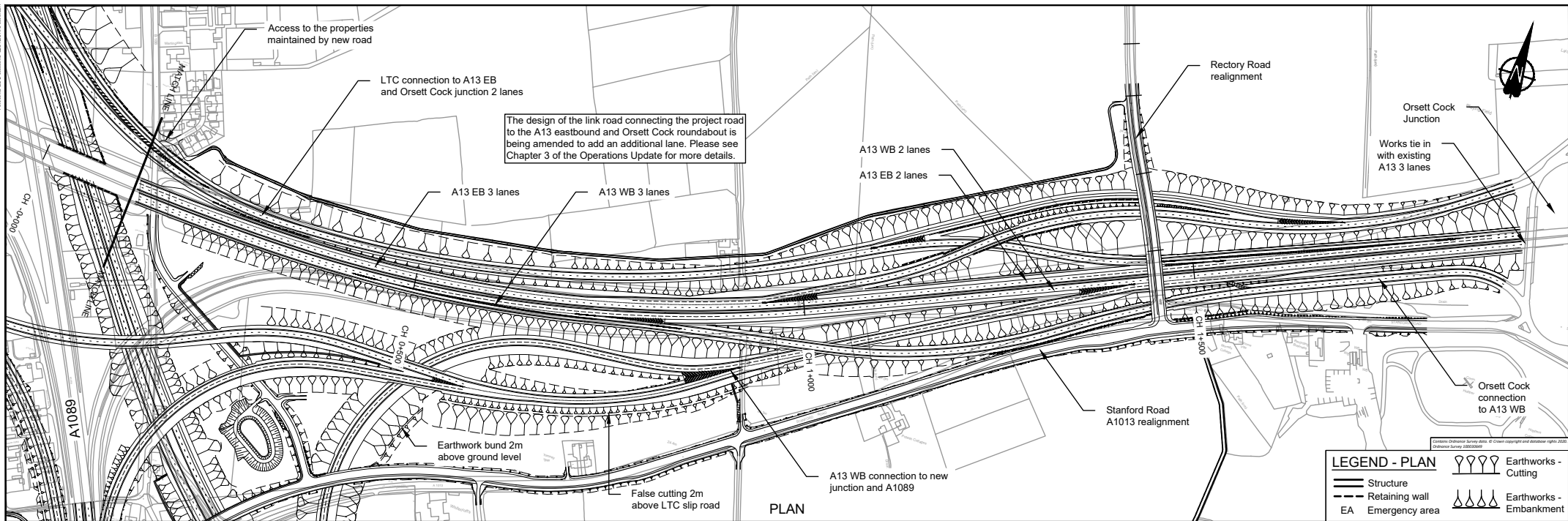

**LEGEND - PROFILE**

- Route Vertical Alignment
- Existing Ground Profile
- Structure - Bridge
- Structure - Underpass

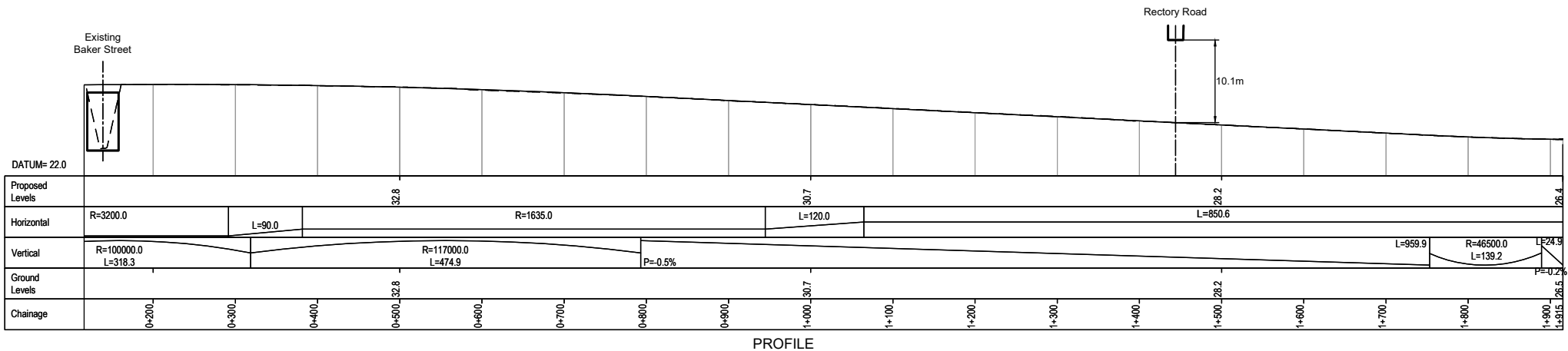

PROFILE

- NOTES**
- Do not scale from this drawing.
  - All dimensions are in metres unless stated otherwise.
  - All levels are in metres relative to the Ordnance Datum.
  - For scheme location refer to Plan and Profile Key Plan.
  - Profile uses an exaggerated scale of 1 horizontal :10 vertical

- NB - Northbound
- WB - Westbound
- EB - Eastbound
- SB - Southbound

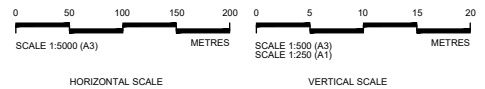

Client **highways england**

**PROPOSALS FOR CONSULTATION**

Project **LOWER THAMES CROSSING COMMUNITY IMPACTS CONSULTATION**

Drawing title **PLAN AND PROFILE SHEET 13**

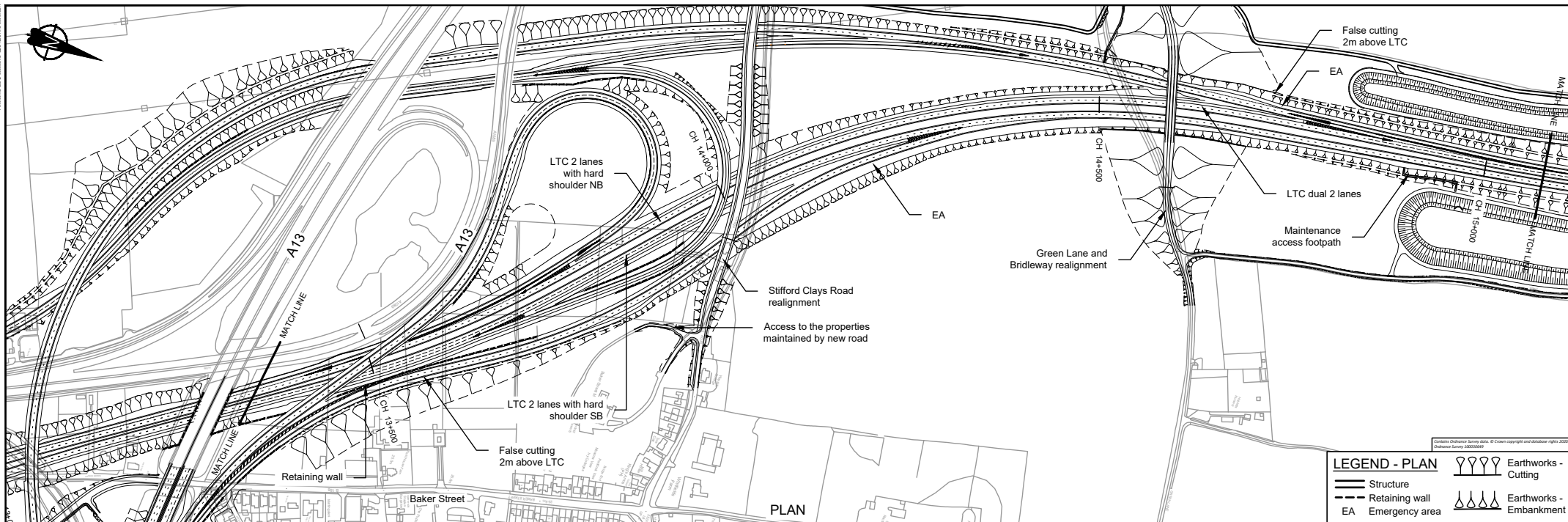

**LEGEND - PLAN**

	Structure		Earthworks - Cutting
	Retaining wall		Earthworks - Embankment
	EA		

**LEGEND - PROFILE**

- Route Vertical Alignment
- Existing Ground Profile
- Structure - Bridge
- Structure - Underpass

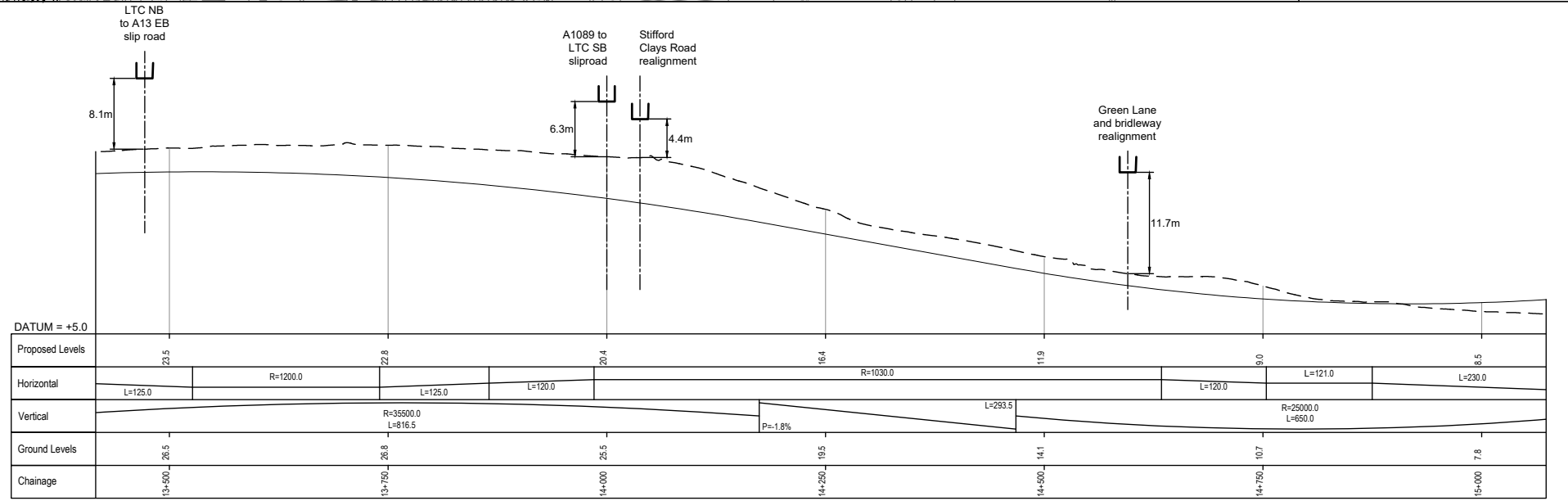

- NOTES**
- Do not scale from this drawing.
  - All dimensions are in metres unless stated otherwise.
  - All levels are in metres relative to the Ordnance Datum.
  - For scheme location refer to Plan and Profile Key Plan.
  - Profile uses an exaggerated scale of 1 horizontal :10 vertical

NB - Northbound  
WB - Westbound  
EB - Eastbound  
SB - Southbound

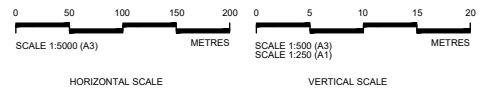

Client

**PROPOSALS FOR CONSULTATION**

Project LOWER THAMES CROSSING  
COMMUNITY IMPACTS CONSULTATION

Drawing title **PLAN AND PROFILE SHEET 14**

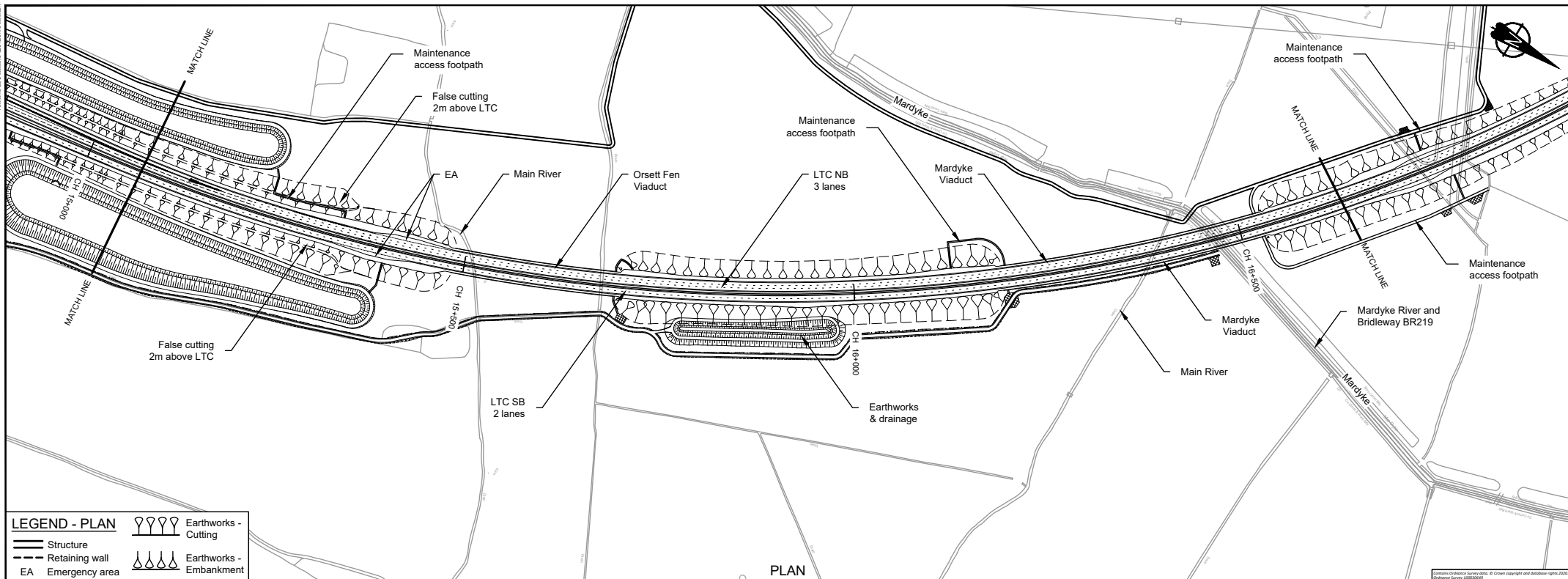

**LEGEND - PLAN**

	Earthworks - Cutting
	Structure
	Retaining wall
	Emergency area
	Earthworks - Embankment

PLAN

**LEGEND - PROFILE**

- Route Vertical Alignment
- Existing Ground Profile
- Structure - Bridge
- Structure - Underpass

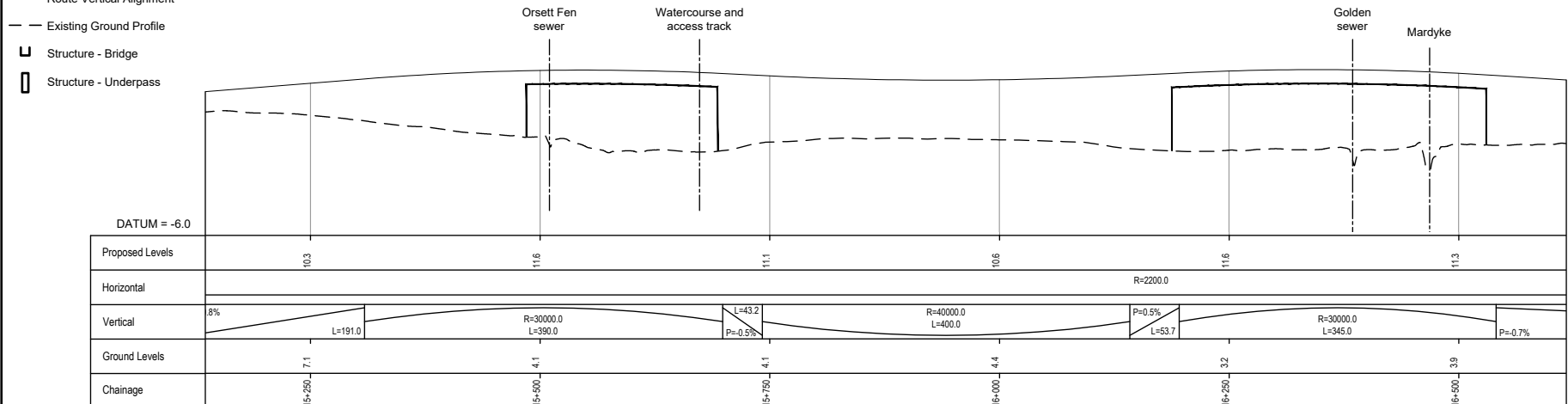

PROFILE

- NOTES**
- Do not scale from this drawing.
  - All dimensions are in metres unless stated otherwise.
  - All levels are in metres relative to the Ordnance Datum.
  - For scheme location refer to Plan and Profile Key Plan.
  - Profile uses an exaggerated scale of 1 horizontal :10 vertical

- NB - Northbound
- WB - Westbound
- EB - Eastbound
- SB - Southbound

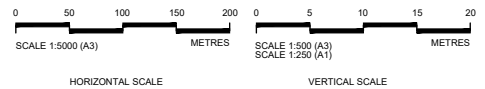

Client

**PROPOSALS FOR CONSULTATION**

Project LOWER THAMES CROSSING  
COMMUNITY IMPACTS CONSULTATION

Drawing title  
**PLAN AND PROFILE  
SHEET 15**

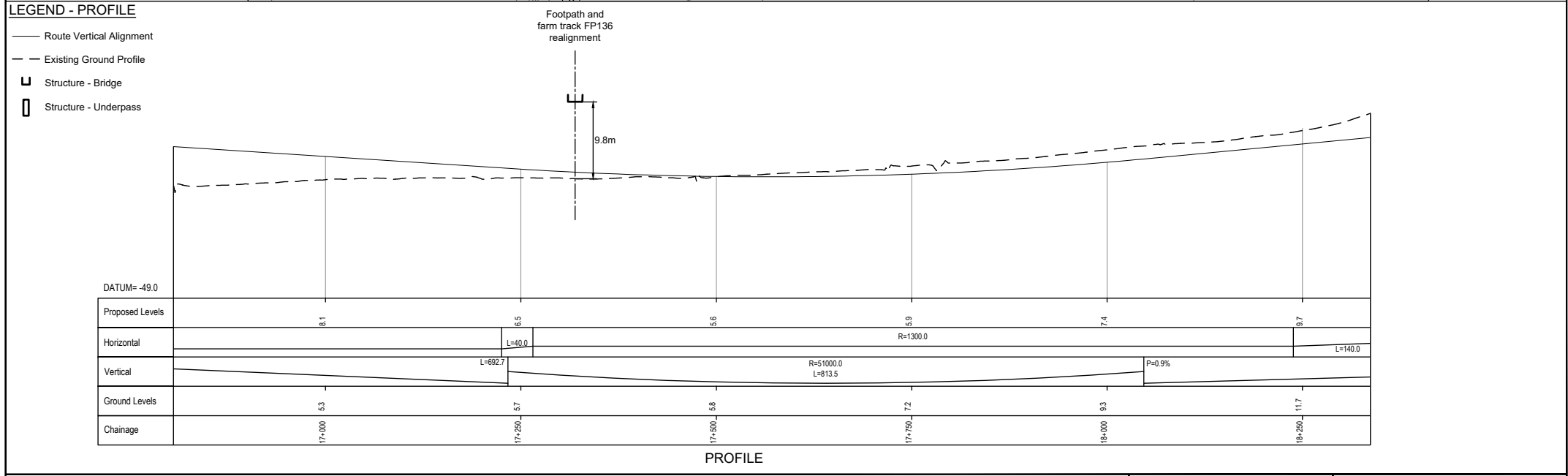
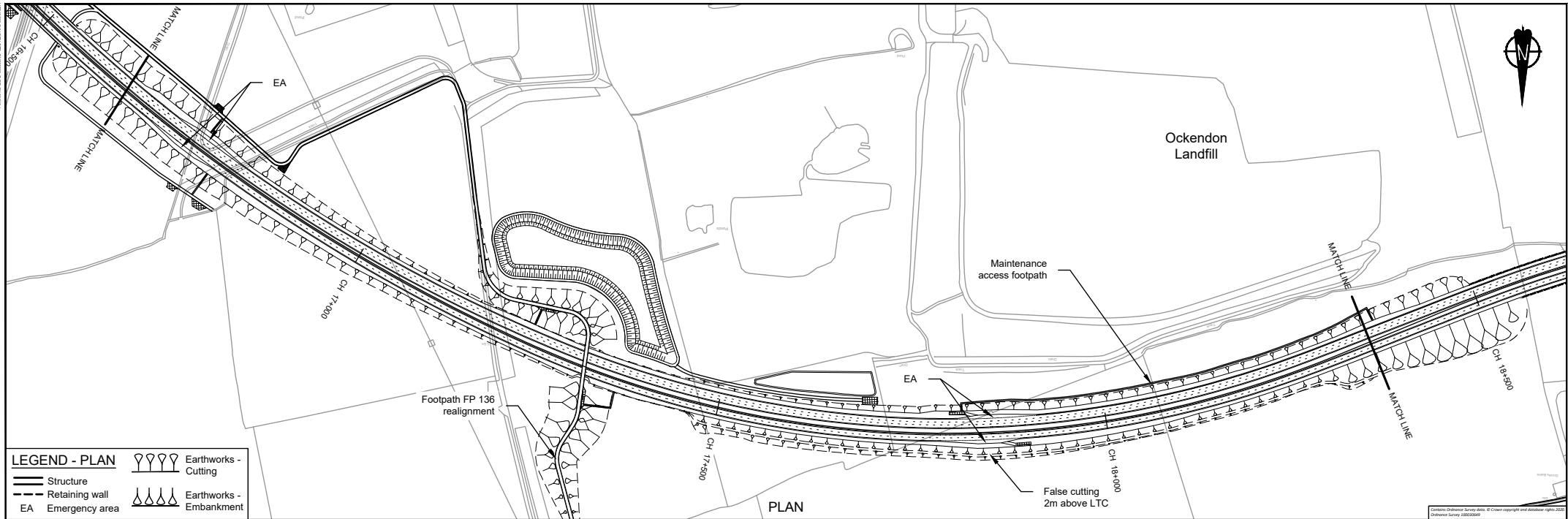

**NOTES**

- Do not scale from this drawing.
- All dimensions are in metres unless stated otherwise.
- All levels are in metres relative to the Ordnance Datum.
- For scheme location refer to Plan and Profile Key Plan.
- Profile uses an exaggerated scale of 1 horizontal :10 vertical

NB - Northbound  
WB - Westbound  
EB - Eastbound  
SB - Southbound

Client: **highways england**

Project: LOWER THAMES CROSSING  
COMMUNITY IMPACTS CONSULTATION

Drawing title: **PROPOSALS FOR CONSULTATION**

Scale: HORIZONTAL SCALE 1:5000 (A3) METRES; VERTICAL SCALE 1:500 (A3) 1:250 (A1) METRES

Project: **PLAN AND PROFILE SHEET 16**

**LEGEND - PLAN**

	Earthworks - Cutting
	Structure
	Retaining wall
	Emergency area
	Earthworks - Embankment

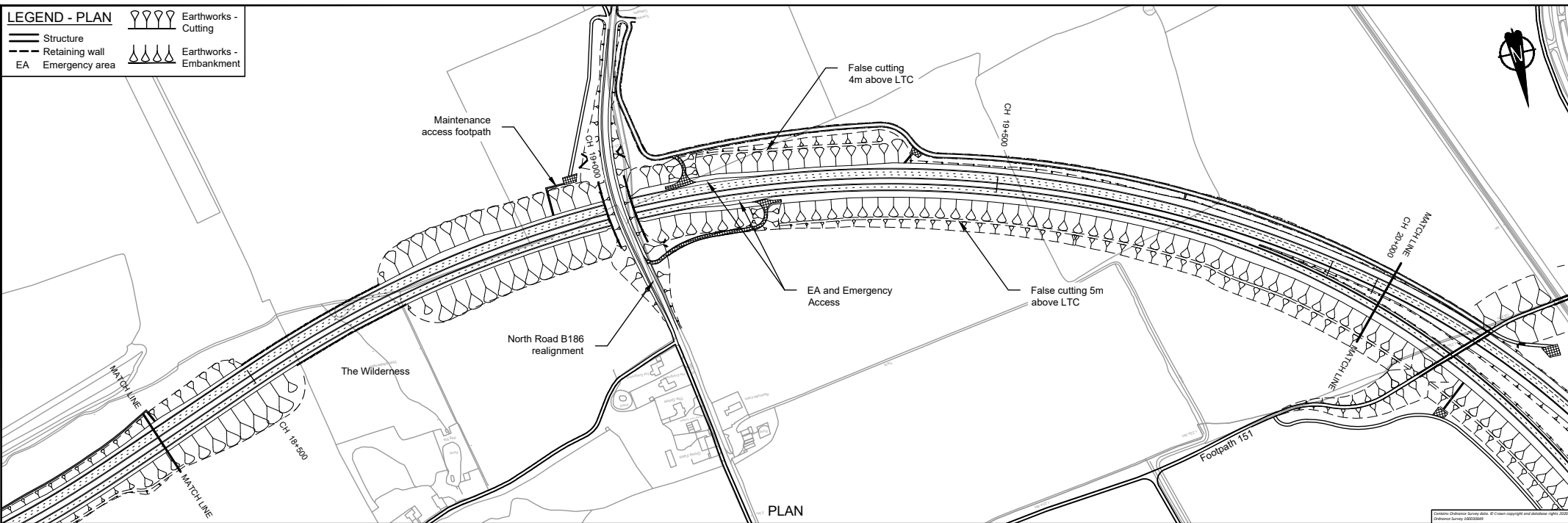

**LEGEND - PROFILE**

- Route Vertical Alignment
- - Existing Ground Profile
- 
- 

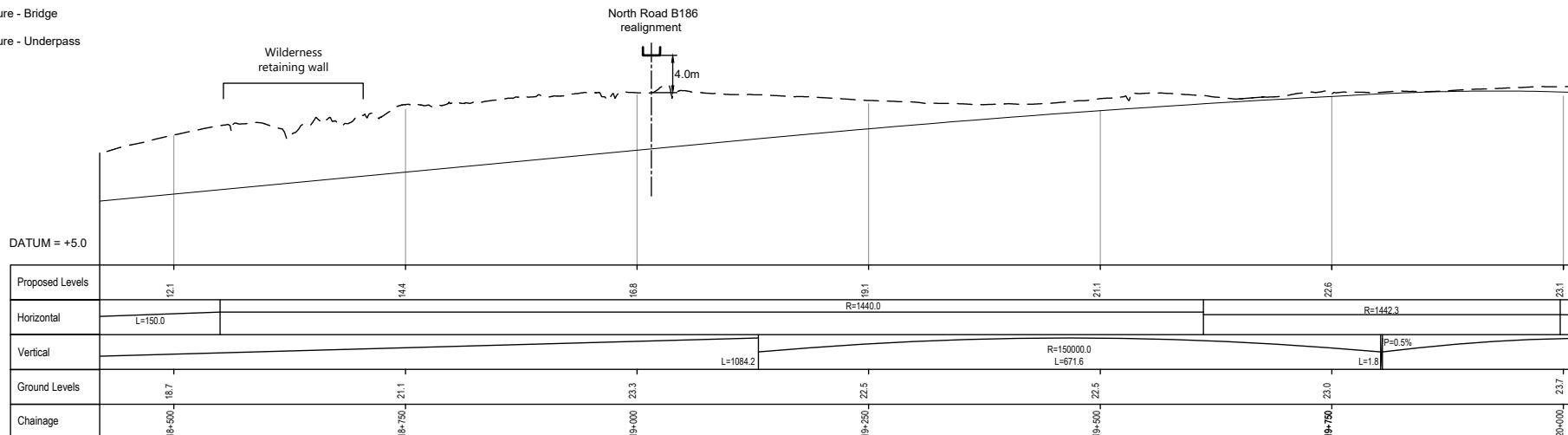

PROFILE

**NOTES**

- Do not scale from this drawing.
- All dimensions are in metres unless stated otherwise.
- All levels are in metres relative to the Ordnance Datum.
- For scheme location refer to Plan and Profile Key Plan.
- Profile uses an exaggerated scale of 1 horizontal :10 vertical

- NB - Northbound
- WB - Westbound
- EB - Eastbound
- SB - Southbound

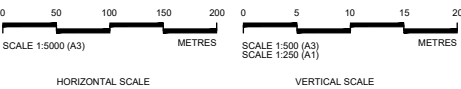

Client

**PROPOSALS FOR CONSULTATION**

Project LOWER THAMES CROSSING  
COMMUNITY IMPACTS CONSULTATION

Drawing title **PLAN AND PROFILE SHEET 17**

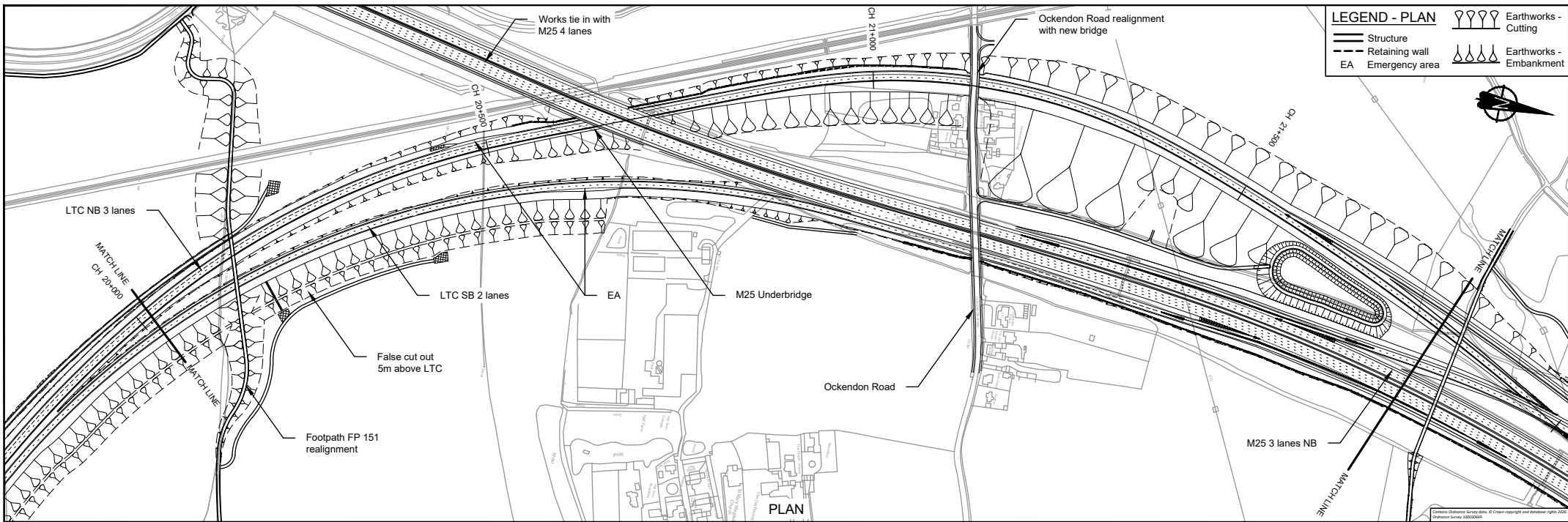

**LEGEND - PROFILE**

- Route Vertical Alignment
- Existing Ground Profile
- Structure - Bridge
- Structure - Underpass

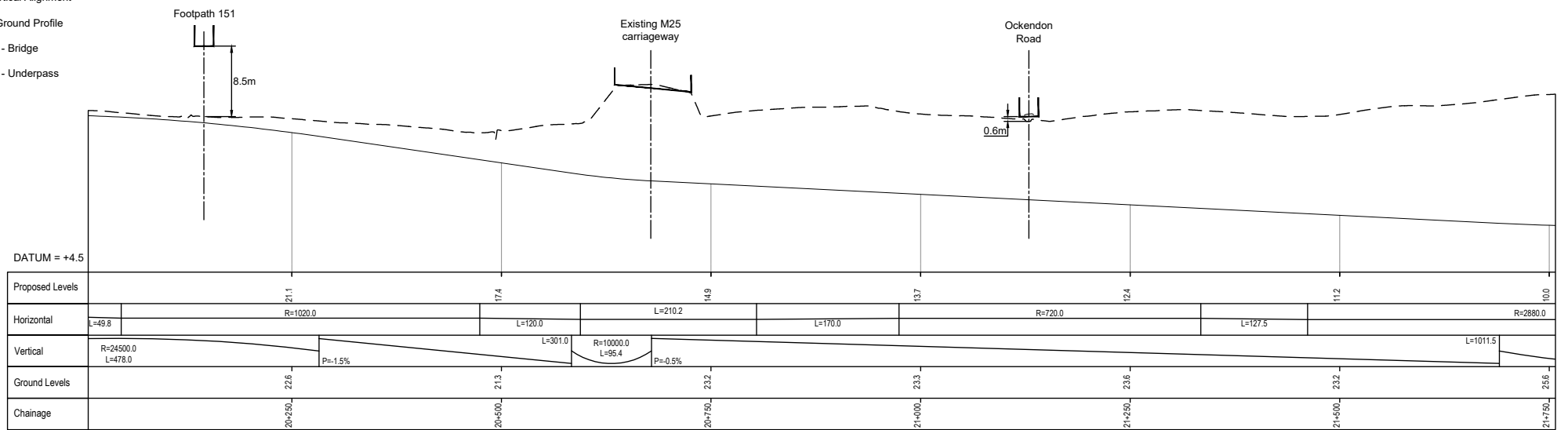

**PROFILE**

**NOTES**

- Do not scale from this drawing.
- All dimensions are in metres unless stated otherwise.
- All levels are in metres relative to the Ordnance Datum.
- For scheme location refer to Plan and Profile Key Plan.
- Profile uses an exaggerated scale of 1 horizontal :10 vertical

- NB - Northbound
- WB - Westbound
- EB - Eastbound
- SB - Southbound

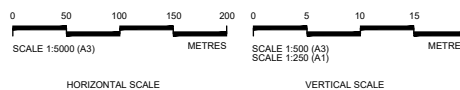

	Client	LOWER THAMES CROSSING COMMUNITY IMPACTS CONSULTATION
	Project	LOWER THAMES CROSSING COMMUNITY IMPACTS CONSULTATION
	Drawing title	PLAN AND PROFILE SHEET 18
<b>PROPOSALS FOR CONSULTATION</b>		

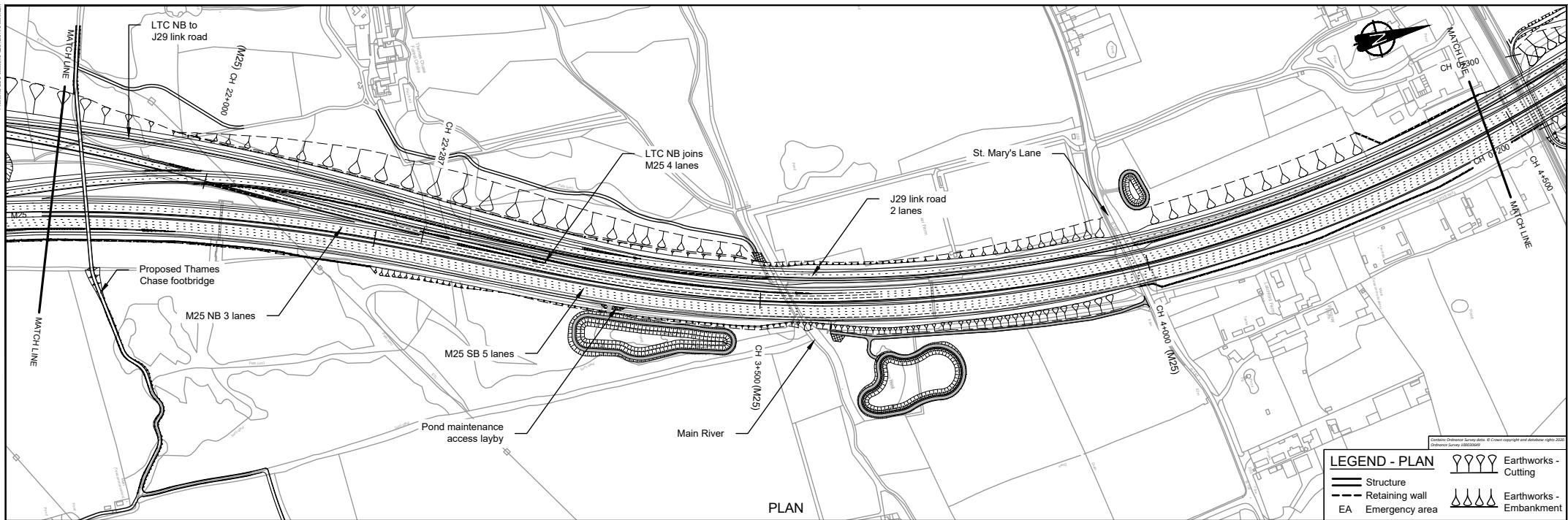

**LEGEND - PLAN**

	Structure		Earthworks - Cutting
	Retaining wall		Earthworks - Embankment
	EA Emergency area		

**LEGEND - PROFILE**

- Route Vertical Alignment
- - Existing Ground Profile
- 
- Structure - Bridge
- 
- Structure - Underpass

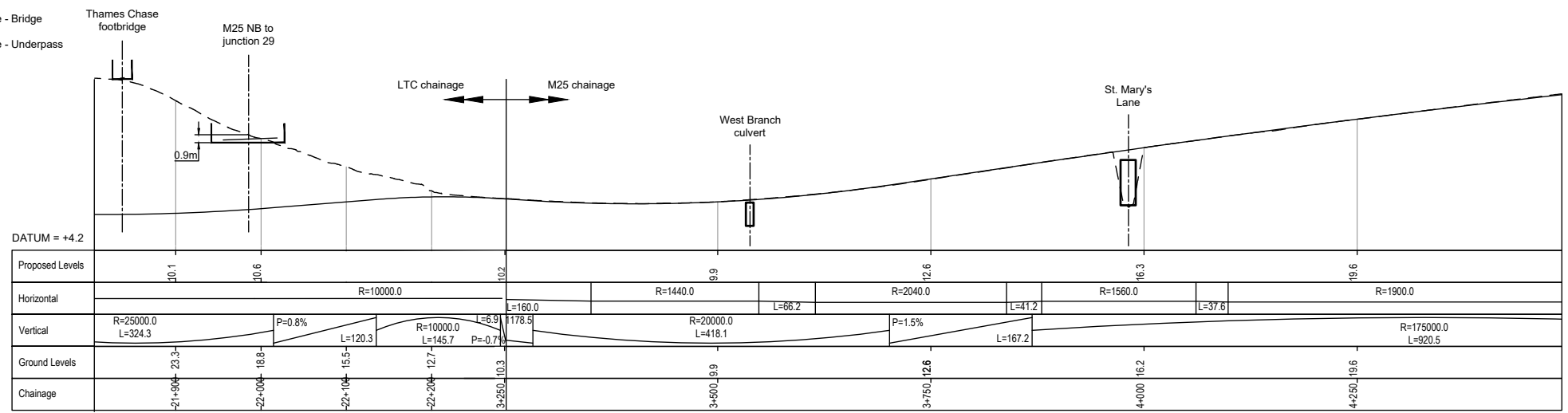

- NOTES**
- Do not scale from this drawing.
  - All dimensions are in metres unless stated otherwise.
  - All levels are in metres relative to the Ordnance Datum.
  - For scheme location refer to Plan and Profile Key Plan.
  - Profile uses an exaggerated scale of 1 horizontal :10 vertical

NB - Northbound  
WB - Westbound  
EB - Eastbound  
SB - Southbound

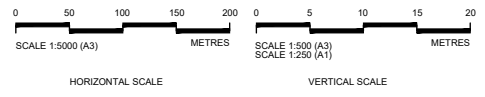

Client

**PROPOSALS FOR CONSULTATION**

Project LOWER THAMES CROSSING  
COMMUNITY IMPACTS CONSULTATION

Drawing title **PLAN AND PROFILE SHEET 19**

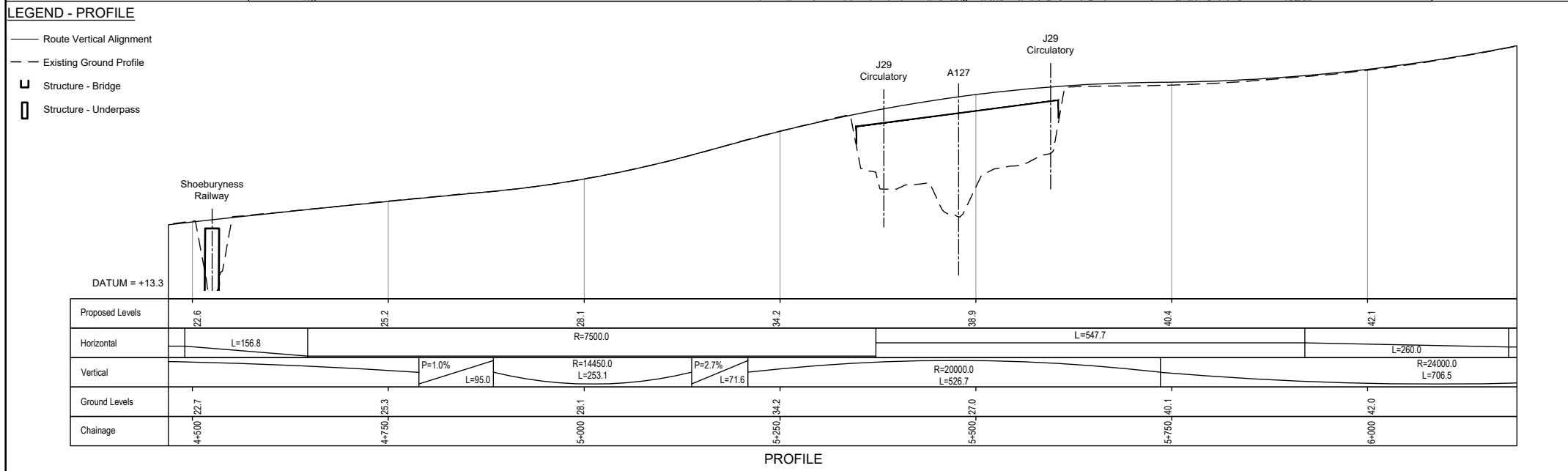
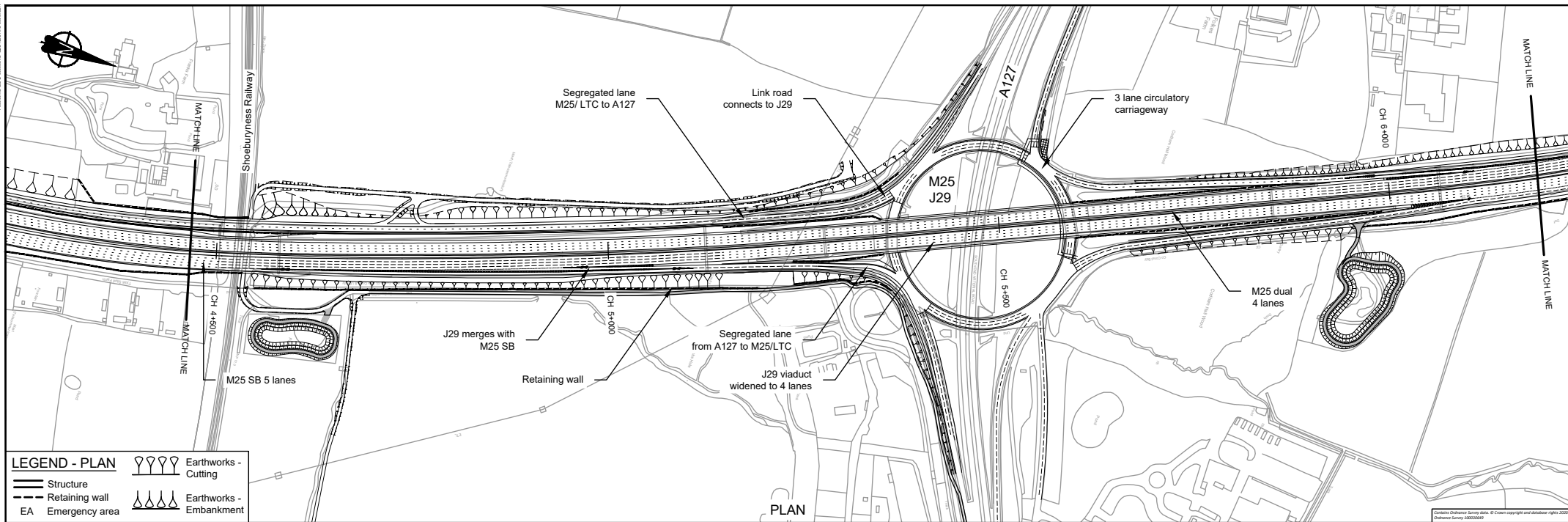

**NOTES**

- Do not scale from this drawing.
- All dimensions are in metres unless stated otherwise.
- All levels are in metres relative to the Ordnance Datum.
- For scheme location refer to Plan and Profile Key Plan.
- Profile uses an exaggerated scale of 1 horizontal :10 vertical

NB - Northbound  
WB - Westbound  
EB - Eastbound  
SB - Southbound

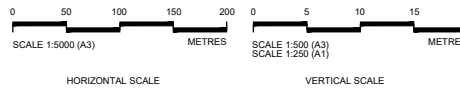

Client

**PROPOSALS FOR CONSULTATION**

Project

**LOWER THAMES CROSSING  
COMMUNITY IMPACTS CONSULTATION**

Drawing title

**PLAN AND PROFILE  
SHEET 20**



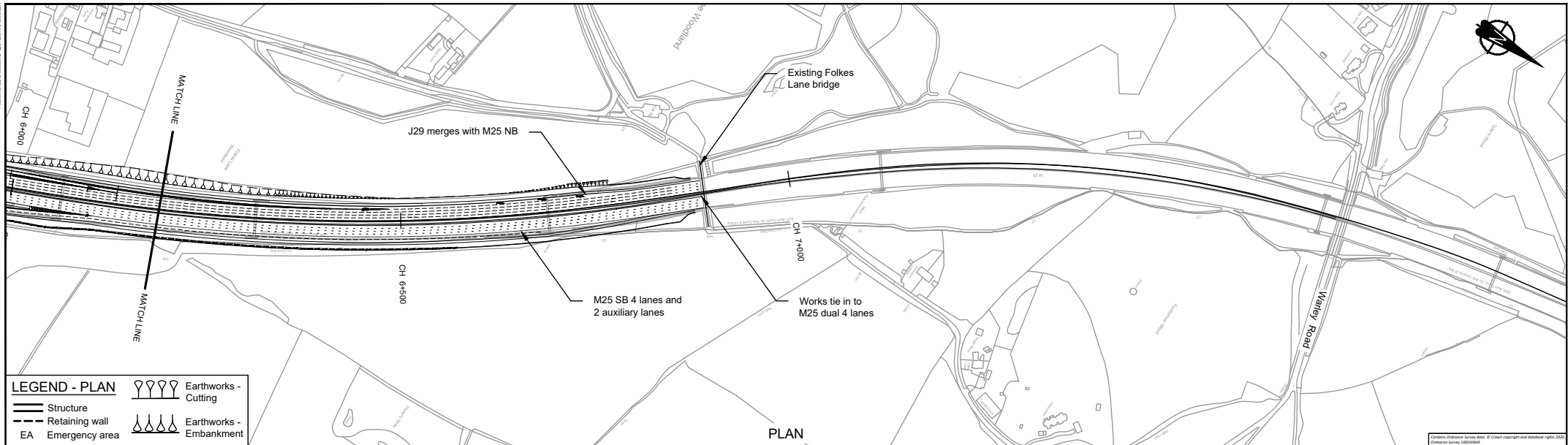

**LEGEND - PLAN**

	Earthworks - Cutting
	Structure
	Retaining wall
	EA Emergency area
	Earthworks - Embankment

**LEGEND - PROFILE**

	Route Vertical Alignment
	Existing Ground Profile
	Structure - Bridge
	Structure - Underpass

Existing Folkes Lane Bridge

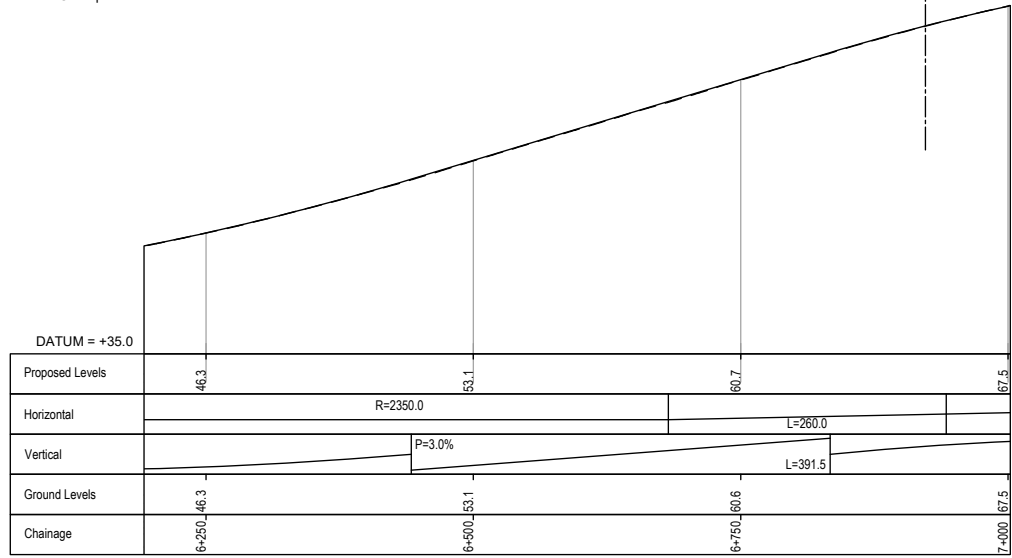

PROFILE

**NOTES**

- Do not scale from this drawing.
- All dimensions are in metres unless stated otherwise.
- All levels are in metres relative to the Ordnance Datum.
- For scheme location refer to Plan and Profile Key Plan.
- Profile uses an exaggerated scale of 1 horizontal :10 vertical

NB - Northbound  
WB - Westbound  
EB - Eastbound  
SB - Southbound

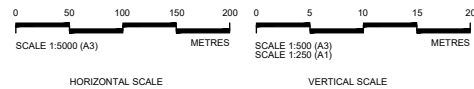

Client

**PROPOSALS FOR CONSULTATION**

Project LOWER THAMES CROSSING  
COMMUNITY IMPACTS CONSULTATION

Drawing title **PLAN AND PROFILE SHEET 21**

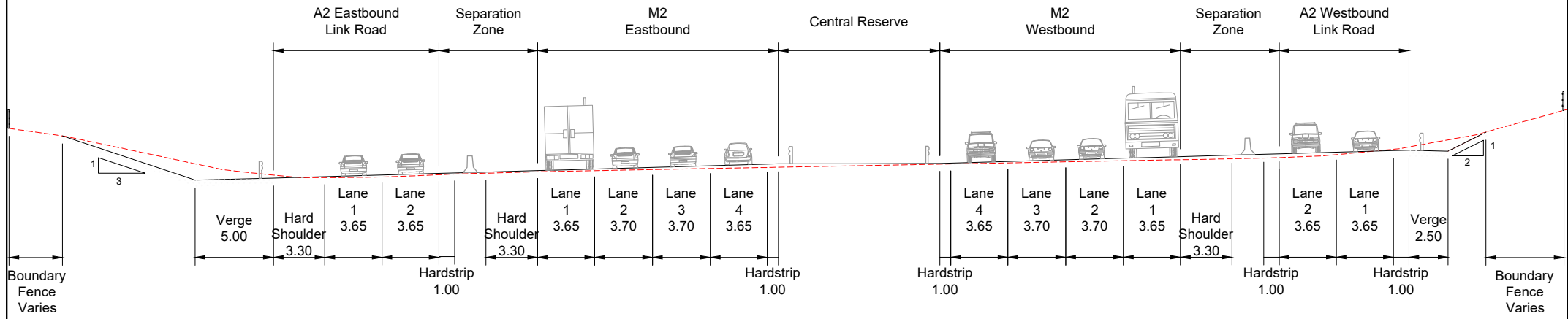
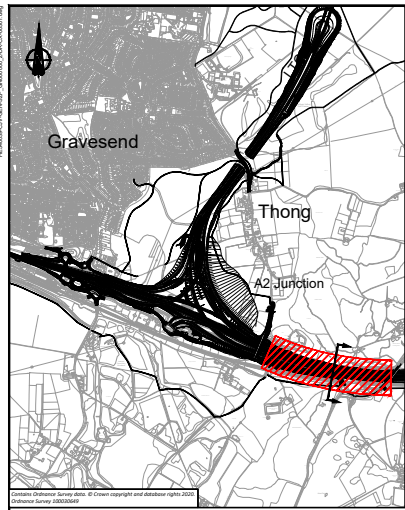

TYPICAL CROSS SECTION ALONG M2/A2

**LEGEND:**  
 — Proposed ground level  
 - - - Existing ground level

**NOTES:**  
 1. All dimensions are in metres unless stated otherwise.

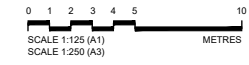

Client **highways england**

**PROPOSALS FOR CONSULTATION**

Project LOWER THAMES CROSSING  
 COMMUNITY IMPACTS CONSULTATION

Drawing title **CROSS SECTION A2 WIDENING**



© Ordnance Survey 2015. All rights reserved. Ordnance Survey Licence No: 100019000

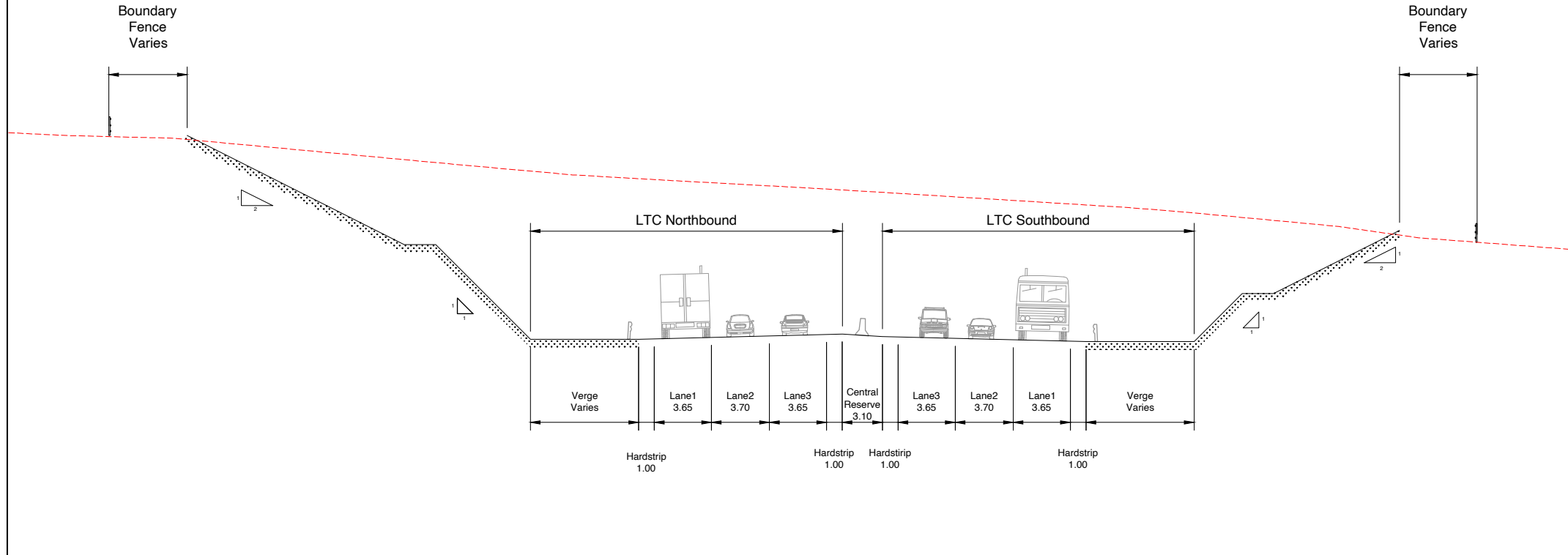

TYPICAL CROSS SECTION IN CHALK CUTTING

**LEGEND:**  
 — Proposed ground level  
 - - - Existing ground level

**NOTES**  
 1. All dimensions are in metres unless stated otherwise.

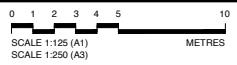

Client

**PROPOSALS FOR CONSULTATION**

Project LOWER THAMES CROSSING  
 COMMUNITY IMPACTS CONSULTATION

Drawing title  
**CROSS SECTION SOUTH OF THE RIVER CHALK CUTTING**

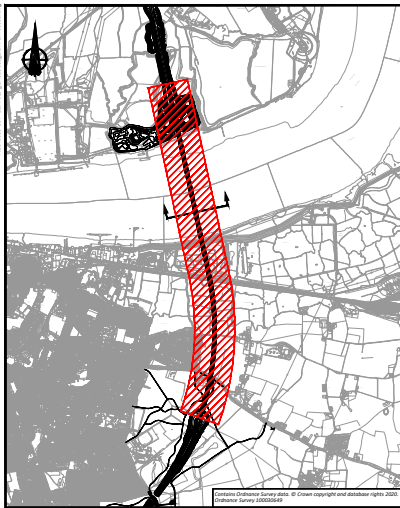

Mean Water Level =3.47m

Depth of tunnel varies

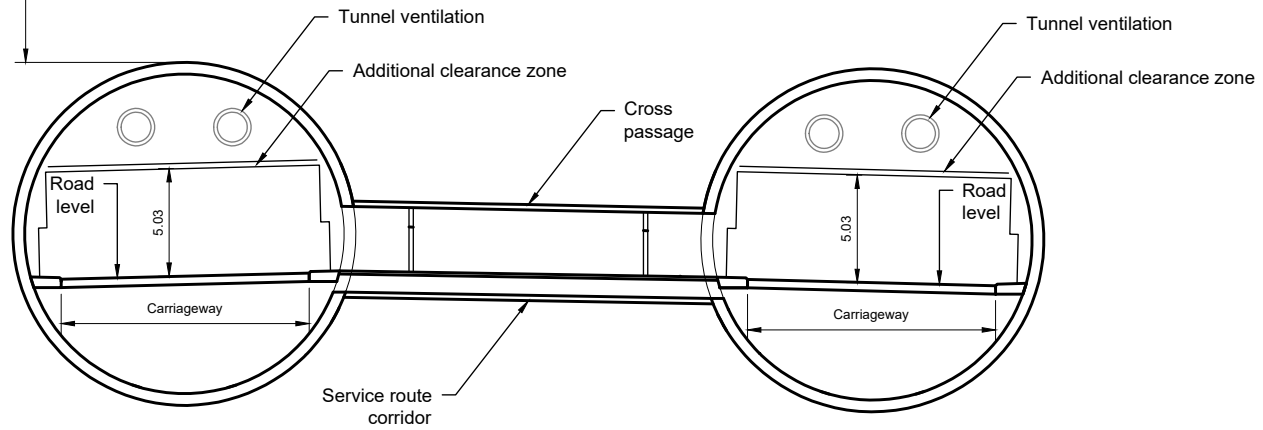

TYPICAL CROSS SECTION THROUGH THE TUNNEL

LEGEND:

- Proposed ground level
- - - Riverbed level

NOTES:

1. All dimensions are in metres unless stated otherwise.

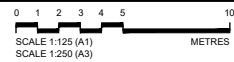

Client



PROPOSALS FOR CONSULTATION

Project

LOWER THAMES CROSSING  
COMMUNITY IMPACTS CONSULTATION

Drawing title

CROSS SECTION  
TUNNEL

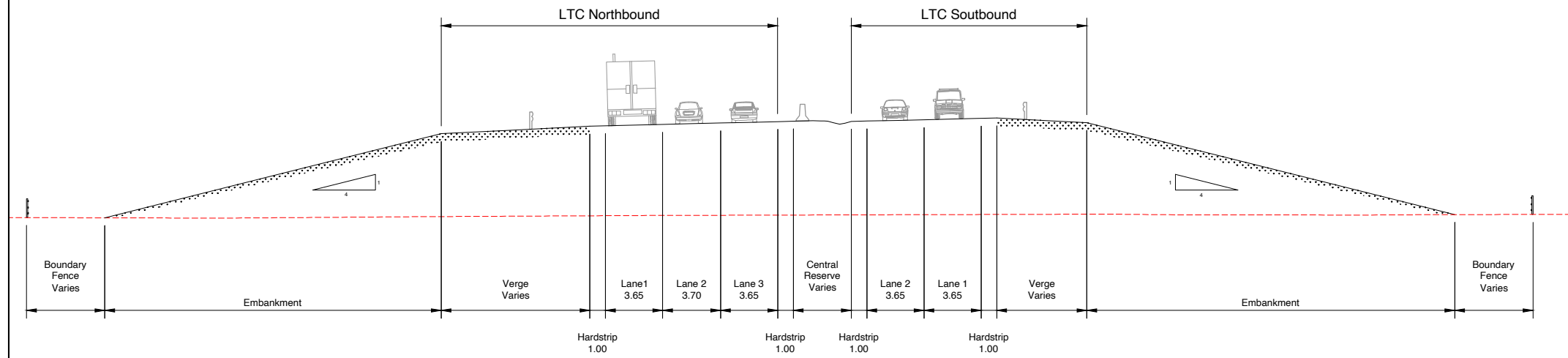
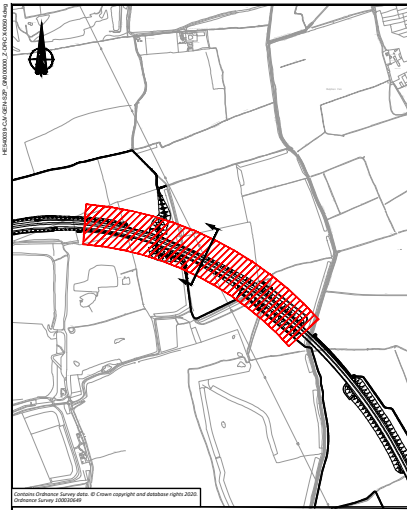

TYPICAL CROSS SECTION THROUGH ORSETT FENN

**LEGEND:**  
 — Proposed ground level  
 - - - Existing ground level

**NOTES**  
 1. All dimensions are in metres unless stated otherwise.

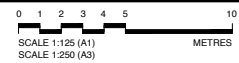

**PROPOSALS FOR CONSULTATION**

Client: **highways england**  
 Project: LOWER THAMES CROSSING COMMUNITY IMPACTS CONSULTATION  
 Drawing title:

**CROSS SECTION OCKENDON LINK**

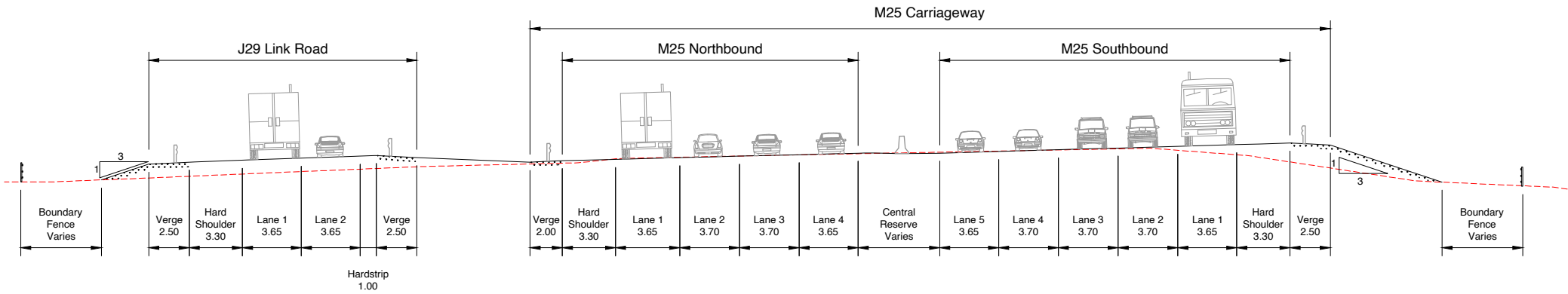
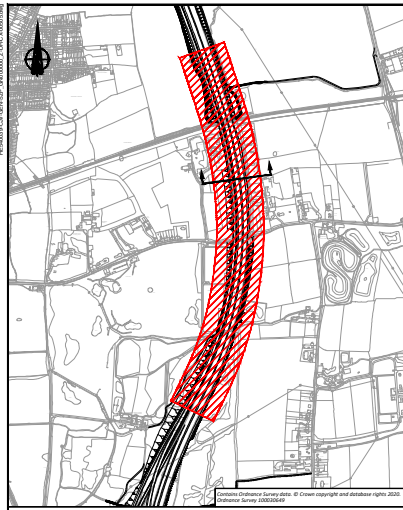

TYPICAL CROSS SECTION THROUGH M25 WITH LINK ROAD

LEGEND:

- Proposed ground level
- - - Existing ground level

NOTES

- All dimensions are in metres unless stated otherwise.

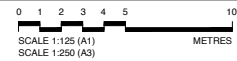

PROPOSALS FOR CONSULTATION

Project LOWER THAMES CROSSING  
COMMUNITY IMPACTS CONSULTATION

Drawing title  
CROSS SECTION  
M25 WIDENING WITH  
LINK ROAD

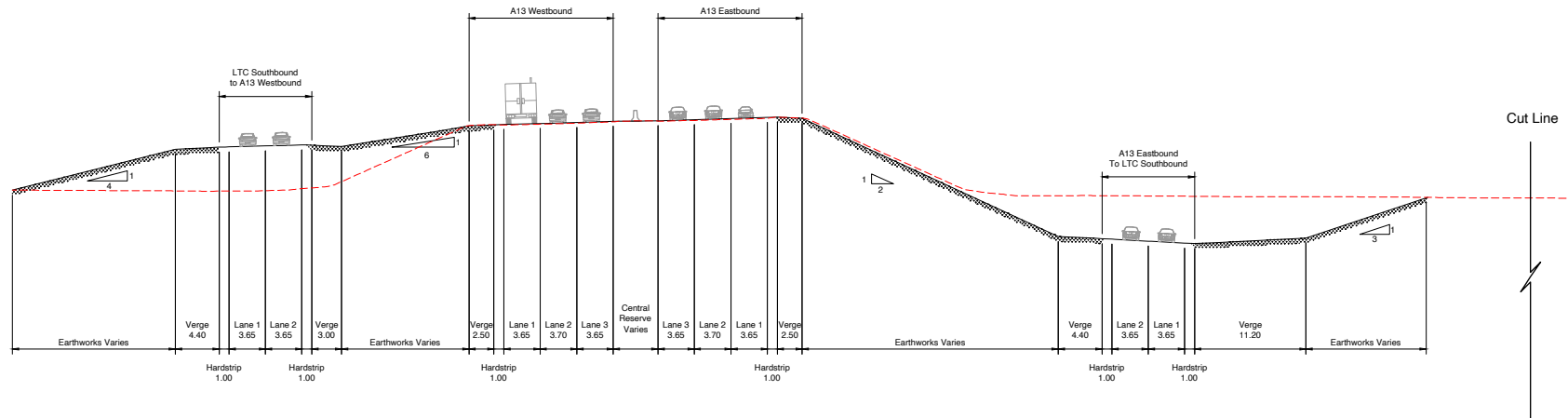

TYPICAL CROSS SECTION THROUGH A13 CORRIDOR

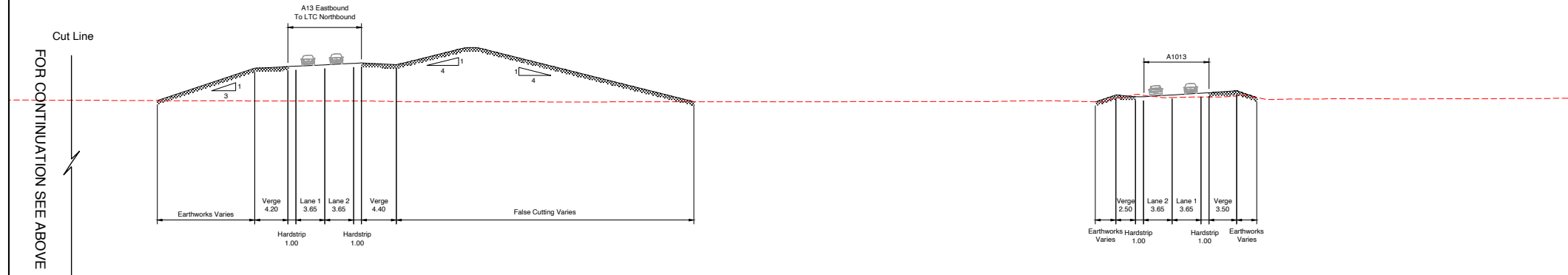

TYPICAL CROSS SECTION THROUGH A13 CORRIDOR

LEGEND:

- Proposed ground level
- - - Existing ground level

NOTES

- All dimensions are in metres unless stated otherwise.



PROPOSALS FOR CONSULTATION

Project LOWER THAMES CROSSING  
COMMUNITY IMPACTS CONSULTATION

CROSS SECTION  
A13



LEGEND:  
 Lower Thames Crossing (LTC)

Client



**PROPOSALS FOR  
CONSULTATION**

Project LOWER THAMES CROSSING  
COMMUNITY IMPACTS CONSULTATION

Drawing title

**PLAN AND PROFILE  
KEY PLAN**



If you need help accessing this or any other Highways England information, please call **0300 123 5000** and we will help you.

### Visit our consultation website

 [www.highwaysengland.co.uk/ltcconsultation](http://www.highwaysengland.co.uk/ltcconsultation)

© Crown copyright 2021.

You may re-use this information (not including logos) free of charge in any format or medium, under the terms of the Open Government Licence. To view this licence:

visit [www.nationalarchives.gov.uk/doc/open-government-licence/](http://www.nationalarchives.gov.uk/doc/open-government-licence/)

write to the **Information Policy Team, The National Archives, Kew, London TW9 4DU**, or email [psi@nationalarchives.gsi.gov.uk](mailto:psi@nationalarchives.gsi.gov.uk).

Mapping (where present): © Crown copyright and database rights 2021 OS 100030649. You are permitted to use this data solely to enable you to respond to, or interact with, the organisation that provided you with the data. You are not permitted to copy, sub-licence, distribute or sell any of this data to third parties in any form.

This document is also available on our website at [www.highwaysengland.co.uk](http://www.highwaysengland.co.uk)

For an accessible version of this publication please call **0300 123 5000** and we will help you.

If you have any enquiries about this publication email [info@highwaysengland.co.uk](mailto:info@highwaysengland.co.uk) or call **0300 123 5000**\*. Please quote the Highways England publications code **PR73/21**

Highways England creative job number BED21 0052

\*Calls to 03 numbers cost no more than a national rate call to an 01 or 02 number and must count towards any inclusive minutes in the same way as 01 and 02 calls.

These rules apply to calls from any type of line including mobile, BT, other fixed line or payphone. Calls may be recorded or monitored.

Printed on paper from well-managed forests and other controlled sources when issued directly by Highways England.

Registered office Bridge House, 1 Walnut Tree Close, Guildford GU1 4LZ

Highways England Company Limited registered in England and Wales number 09346363