

SAFETY, HEALTH AND ENVIRONMENTAL INFORMATION BOX

IT IS ASSUMED THAT ALL WORKS ON THIS DRAWING WILL BE CARRIED OUT BY A COMPETENT CONTRACTOR WORKING, WHERE APPROPRIATE, TO AN APPROPRIATE METHOD STATEMENT.

THIS DRAWING IS TO BE USED ONLY FOR THE PURPOSE OF ISSUE THAT IT WAS ISSUED FOR AND IS SUBJECT TO AMENDMENT.

EXCEPTIONAL RISKS RELATING TO THE WORKS ASSOCIATED WITH THIS DRAWING ARE IDENTIFIED BELOW.

CONSTRUCTION

MAINTENANCE / OPERATION / DECOMMISSIONING / DEMOLITION

- Legend**
- The Scheme
 - Order limits
 - Proposed site compound location
 - Existing retained woodland
 - Existing retained ancient woodland
 - Veteran trees
 - Existing ponds
 - Existing watercourse - open
 - Existing watercourse - culvert
 - Existing PRoW - footpath
 - Existing PRoW - bridleway
- Proposed Mitigation**
- Proposed ancient woodland compensation woodland - EFD
 - Proposed species rich grassland (LE1.3) - EFB / EFD
 - Proposed amenity grassland (LE1.1) - EFB
 - Proposed woodland (LE2.1) - EFB / EFD
 - Proposed woodland (LE2.1) - EFA
 - Proposed native species hedgerow (LE4.3) - EFB / EFD
 - Proposed native species hedgerow (LE4.3) - EFA
 - Proposed individual trees (LE5.1) - EFB
 - Proposed marsh and wet grassland (LE6.4) - EFB / EFD
 - False cutting - EFA / EFG
 - Existing watercourse - diverted - EFH
 - Proposed drainage ponds - EFH
 - Diverted watercourse - culvert - EFH
 - Proposed ditch - EFH
 - Proposed noise barrier - EFG
 - PRoW / footway removal
 - Proposed PRoW - Footpath
 - Proposed PRoW - Bridleway
 - Proposed shared footpath / cycleway
- Ecology**
- Proposed area for ecology pond - EFD
 - Proposed mammal tunnels - EFD
- Planned Environmental Objectives**
- Visual screening
 - Landscape integration
 - Nature conservation and biodiversity
 - Water quality
 - Auditory amenity

DRAFT

General updates	LB	RW	08.11.2019	PO9
Revision Details	By	Check	Date	Suffix

Purpose of issue
SUITABLE FOR INFORMATION

Client
Highways England
Major Projects
The Cule
199 Wharfside Street
Birmingham
B1 1RN



Development Consent Order Number
TR010054

Project Title
M54 to M6 Link Road

Drawing Title
**FIGURE 2.2
DRAFT ENVIRONMENTAL
MASTERPLAN
KEYPLAN**

Designed	Drawn	Checked	Approved	Date
NW	LB	RW	TP	08.11.2019
Internal Project No. 60536736			Suitability S2	
Scale @ A1 1:1500			Zone Highways General	

THIS DOCUMENT HAS BEEN PREPARED PURSUANT TO AND SUBJECT TO THE TERMS OF AECOM'S APPOINTMENT BY ITS CLIENT. AECOM ACCEPTS NO LIABILITY FOR ANY USE OF THIS DOCUMENT OTHER THAN BY ITS ORIGINAL CLIENT OR FOLLOWING AECOM'S EXPRESS AGREEMENT TO SUCH USE, AND ONLY FOR THE PURPOSES FOR WHICH IT WAS PREPARED AND PROVIDED.

Drawing Number	Highways England PIN	1 Originator	1 Volume	Rev
HE514465	-ACM	-ELS	-	PO9
M54	Location	-SW-R	-0002	
		I Type	I Role	I Number

All watercourses and watercourse diversions shown on this plan are approximate, and are potentially subject to change

Proj Code: 08 November 2019 11:41:03
File Name: L:\PROJECTS\2019\BUSINESS\461\LINKS\00_Technical\8 - DRAFT ENVIRONMENTAL MITIGATION PROMISE ENVIRONMENTAL MASTERPLAN P09.8

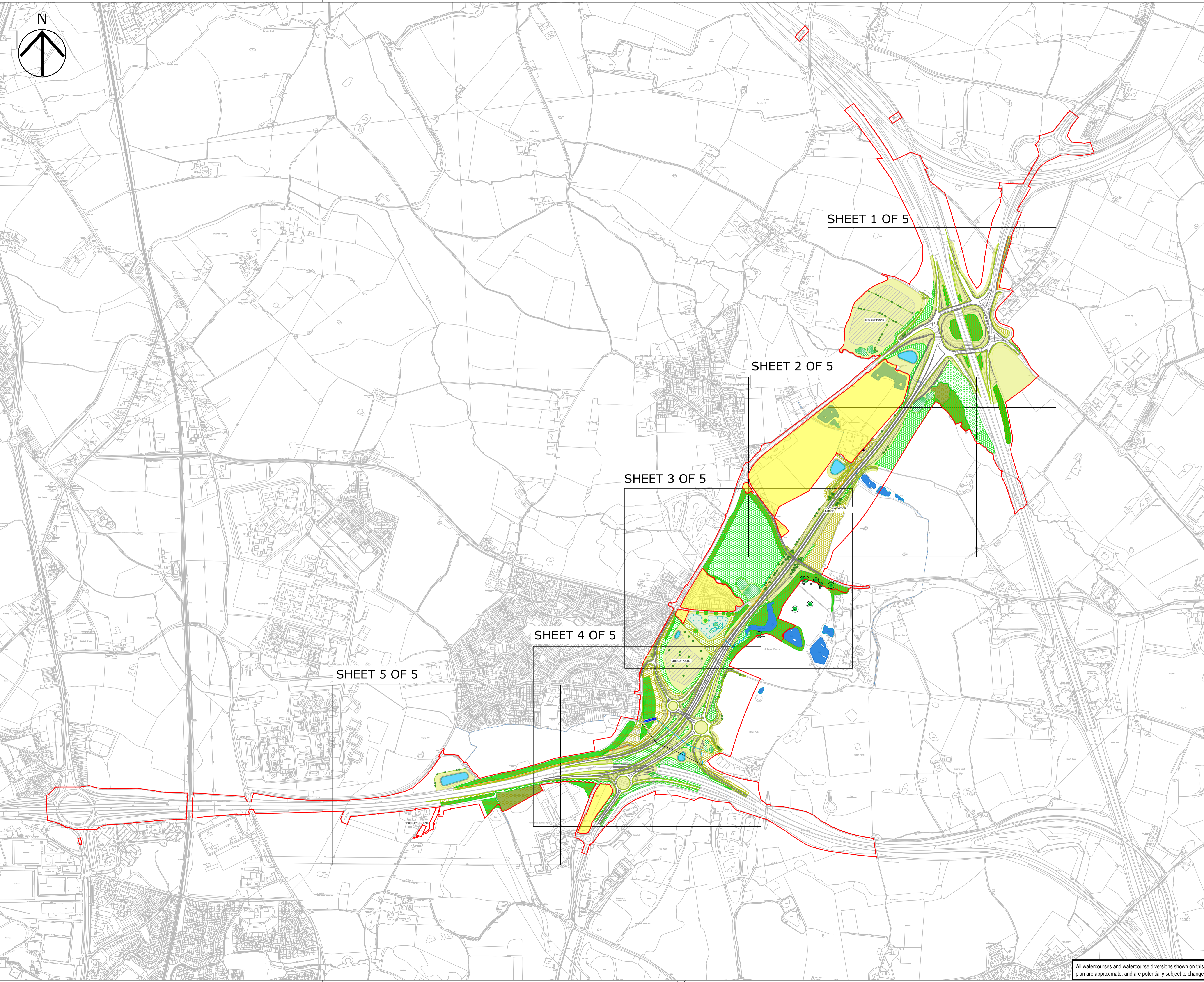

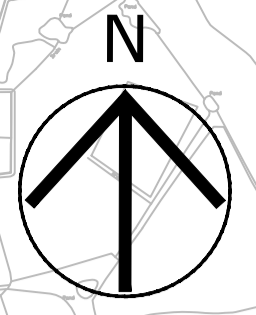

SAFETY, HEALTH AND ENVIRONMENTAL INFORMATION BOX

IT IS ASSUMED THAT ALL WORKS ON THIS DRAWING WILL BE CARRIED OUT BY A COMPETENT CONTRACTOR WORKING, WHERE APPROPRIATE, TO AN APPROPRIATE METHOD STATEMENT.

THIS DRAWING IS TO BE USED ONLY FOR THE PURPOSE OF ISSUE THAT IT WAS ISSUED FOR AND IS SUBJECT TO AMENDMENT.

EXCEPTIONAL RISKS RELATING TO THE WORKS ASSOCIATED WITH THIS DRAWING ARE IDENTIFIED BELOW.

CONSTRUCTION

MAINTENANCE / OPERATION / DECOMMISSIONING / DEMOLITION

- Legend**
- The Scheme
 - Order limits
 - Proposed site compound location
 - Existing retained woodland
 - Existing retained ancient woodland
 - Veteran trees
 - Existing ponds
 - Existing watercourse - open
 - Existing watercourse - culvert
 - Existing PRoW - footpath
 - Existing PRoW - bridleway
- Proposed Mitigation**
- Proposed ancient woodland compensation woodland - EFD
 - Proposed species rich grassland (LE1.3) - EFB / EFD
 - Proposed amenity grassland (LE1.1) - EFB
 - Proposed woodland (LE2.1) - EFB / EFD
 - Proposed woodland (LE2.1) - EFA
 - Proposed native species hedgerow (LE4.3) - EFB / EFD
 - Proposed native species hedgerow (LE4.3) - EFA
 - Proposed individual trees (LE5.1) - EFB
 - Proposed marsh and wet grassland (LE6.4) - EFB / EFD
 - False cutting - EFA / EFG
 - Existing watercourse - diverted - EFH
 - Proposed drainage ponds - EFH
 - Diverted watercourse - culvert - EFH
 - Proposed ditch - EFH
 - Proposed noise barrier - EFG
 - PRoW / footway removal
 - Proposed PRoW - Footpath
 - Proposed PRoW - Bridleway
 - Proposed shared footpath / cycleway
- Ecology**
- Proposed area for ecology pond - EFD
 - Proposed mammal tunnels - EFD
- Planned Environmental Objectives**
- Visual screening
 - Landscape integration
 - Nature conservation and biodiversity
 - Water quality
 - Auditory amenity

DRAFT

General updates	LB	RW	08.11.2019	PO9
Revision Details	By	Check	Date	Suffix

Purpose of issue
SUITABLE FOR INFORMATION

Client
Highways England
Major Projects
The Cuts
199 Wharfside Street
Birmingham
B1 1RN



Development Consent Order Number
TR010054

Project Title
M54 to M6 Link Road

Drawing Title
**FIGURE 2.1
DRAFT ENVIRONMENTAL
MASTERPLAN
OVERVIEW**

Designed NW	Drawn LB	Checked RW	Approved TP	Date 08.11.2019
Internal Project No. 60536736			Suitability S2	
Scale @ A1 1:1500			Zone Highways General	

THIS DOCUMENT HAS BEEN PREPARED PURSUANT TO AND SUBJECT TO THE TERMS OF AECOM'S APPOINTMENT BY ITS CLIENT. AECOM ACCEPTS NO LIABILITY FOR ANY USE OF THIS DOCUMENT OTHER THAN BY ITS ORIGINAL CLIENT OR FOLLOWING AECOM'S EXPRESS AGREEMENT TO SUCH USE, AND ONLY FOR THE PURPOSES FOR WHICH IT WAS PREPARED AND PROVIDED.

Drawing Number HE514465	Originator -ACM	Volume -ELS -	Rev P09
Location M54	I Type -SW-R	I Number -0001	

All watercourses and watercourse diversions shown on this plan are approximate, and are potentially subject to change.

P09 Date: 08 November 2019 11:39:47
 File Name: \\PROJECTS\BIDDING\BIDDING\AS\LINKS\00_Technicals\1 - DIVERSION\ENVIRONMENTAL MITIGATION\ENVIRONMENTAL MASTERPLAN P09.B

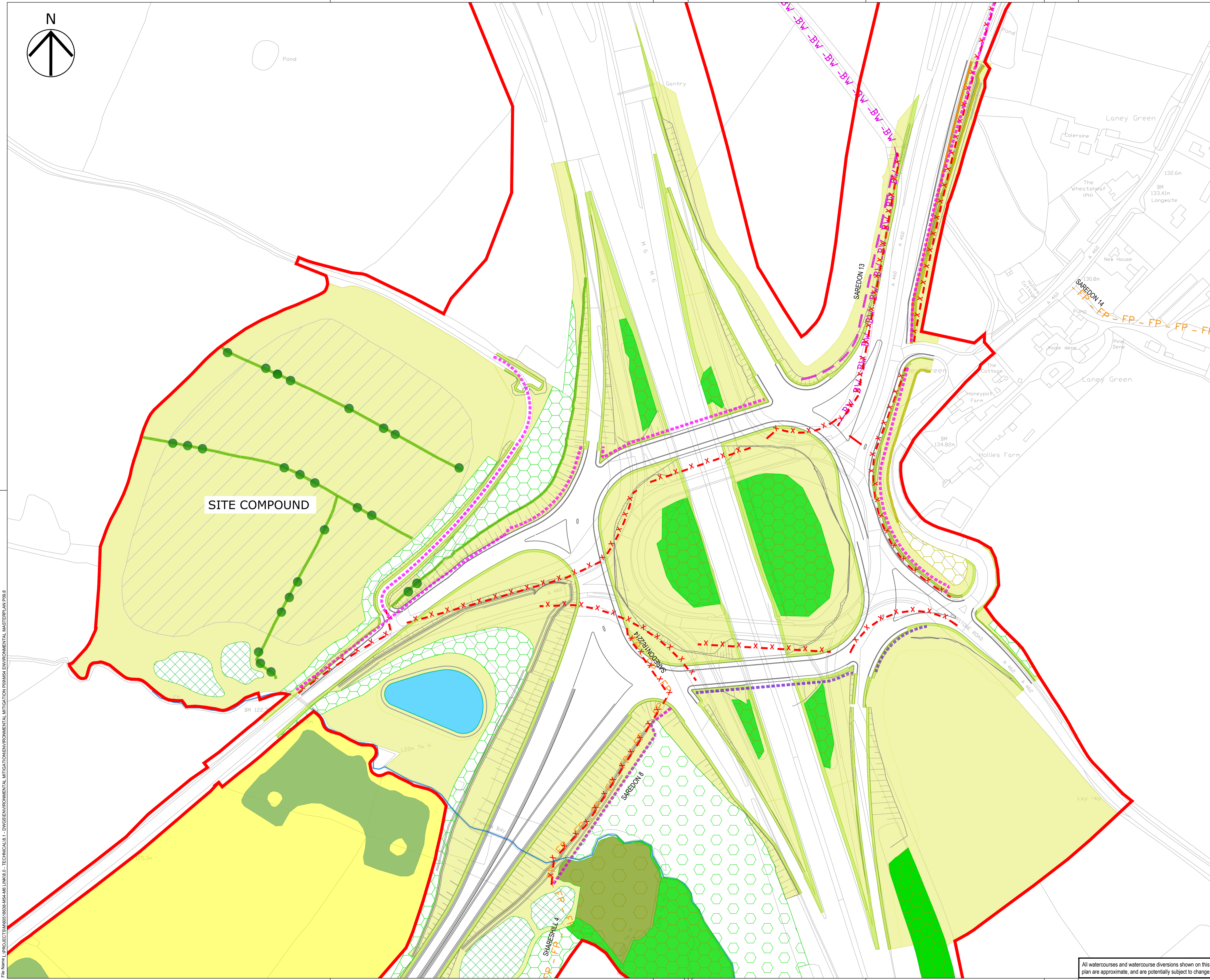
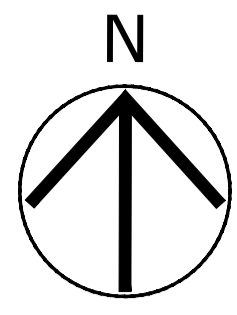

SAFETY, HEALTH AND ENVIRONMENTAL INFORMATION BOX

IT IS ASSUMED THAT ALL WORKS ON THIS DRAWING WILL BE CARRIED OUT BY A COMPETENT CONTRACTOR WORKING, WHERE APPROPRIATE, TO AN APPROPRIATE METHOD STATEMENT.

THIS DRAWING IS TO BE USED ONLY FOR THE PURPOSE OF ISSUE THAT IT WAS ISSUED FOR AND IS SUBJECT TO AMENDMENT.

EXCEPTIONAL RISKS RELATING TO THE WORKS ASSOCIATED WITH THIS DRAWING ARE IDENTIFIED BELOW.

CONSTRUCTION

MAINTENANCE / OPERATION / DECOMMISSIONING / DEMOLITION

- Legend**
- The Scheme
 - Order limits
 - Proposed site compound location
 - Existing retained woodland
 - Existing retained ancient woodland
 - Veteran trees
 - Existing ponds
 - Existing watercourse - open
 - Existing watercourse - culvert
 - Existing PRoW - footpath
 - Existing PRoW - bridleway
- Proposed Mitigation**
- Proposed ancient woodland compensation woodland - EFD
 - Proposed species rich grassland (LE1.3) - EFB / EFD
 - Proposed amenity grassland (LE1.1) - EFB
 - Proposed woodland (LE2.1) - EFB / EFD
 - Proposed woodland (LE2.1) - EFA
 - Proposed native species hedgerow (LE4.3) - EFB / EFD
 - Proposed native species hedgerow (LE4.3) - EFA
 - Proposed individual trees (LE5.1) - EFB
 - Proposed marsh and wet grassland (LE6.4) - EFB / EFD
 - False cutting - EFA / EFG
 - Existing watercourse - diverted - EFH
 - Proposed drainage ponds - EFH
 - Diverted watercourse - culvert - EFH
 - Proposed ditch - EFH
 - Proposed noise barrier - EFG
 - PRoW / footway removal
 - Proposed PRoW - Footpath
 - Proposed PRoW - Bridleway
 - Proposed shared footpath / cycleway
- Ecology**
- Proposed area for ecology pond - EFD
 - Proposed mammal tunnels - EFD
- Planned Environmental Objectives**
- Visual screening
 - Landscape integration
 - Nature conservation and biodiversity
 - Water quality
 - Auditory amenity

DRAFT

General updates	LB	08.11.2019	PO9
Revision Details	By	Check	Date

Purpose of issue
SUITABLE FOR INFORMATION

Client
Highways England
Major Projects
The Cule
199 Wharfside Street
Birmingham
B1 1RN



Development Consent Order Number
TR010054

Project Title
M54 to M6 Link Road

Drawing Title
**FIGURE 2.3
DRAFT ENVIRONMENTAL
MASTERPLAN
SHEET 1 OF 5**

Designed NW	Drawn LB	Checked RW	Approved TP	Date 08.11.2019
Internal Project No. 60536736			Suitability S2	
Scale @ A1 1:1500			Zone Highways General	

THIS DOCUMENT HAS BEEN PREPARED PURSUANT TO AND SUBJECT TO THE TERMS OF AECOM'S APPOINTMENT BY ITS CLIENT. AECOM ACCEPTS NO LIABILITY FOR ANY USE OF THIS DOCUMENT OTHER THAN BY ITS ORIGINAL CLIENT OR FOLLOWING AECOM'S EXPRESS AGREEMENT TO SUCH USE, AND ONLY FOR THE PURPOSES FOR WHICH IT WAS PREPARED AND PROVIDED.

Drawing Number HE514465	Highways England PIN -ACM	1 Originator -ELS	1 Volume -SW-R -0003	Rev P09
M54	Location	1 Type	1 Role	1 Number

All watercourses and watercourse diversions shown on this plan are approximate, and are potentially subject to change.

PU Date: 08 November 2019 11:42:43
 File Name: L:\PROJECTS\2019\20190820\BUSINESS\AS\LINK\8.0 - TECHNICALS\1 - DIVISION\ENVIRONMENTAL MITIGATION\ENVIRONMENTAL MASTERPLAN\F09.8

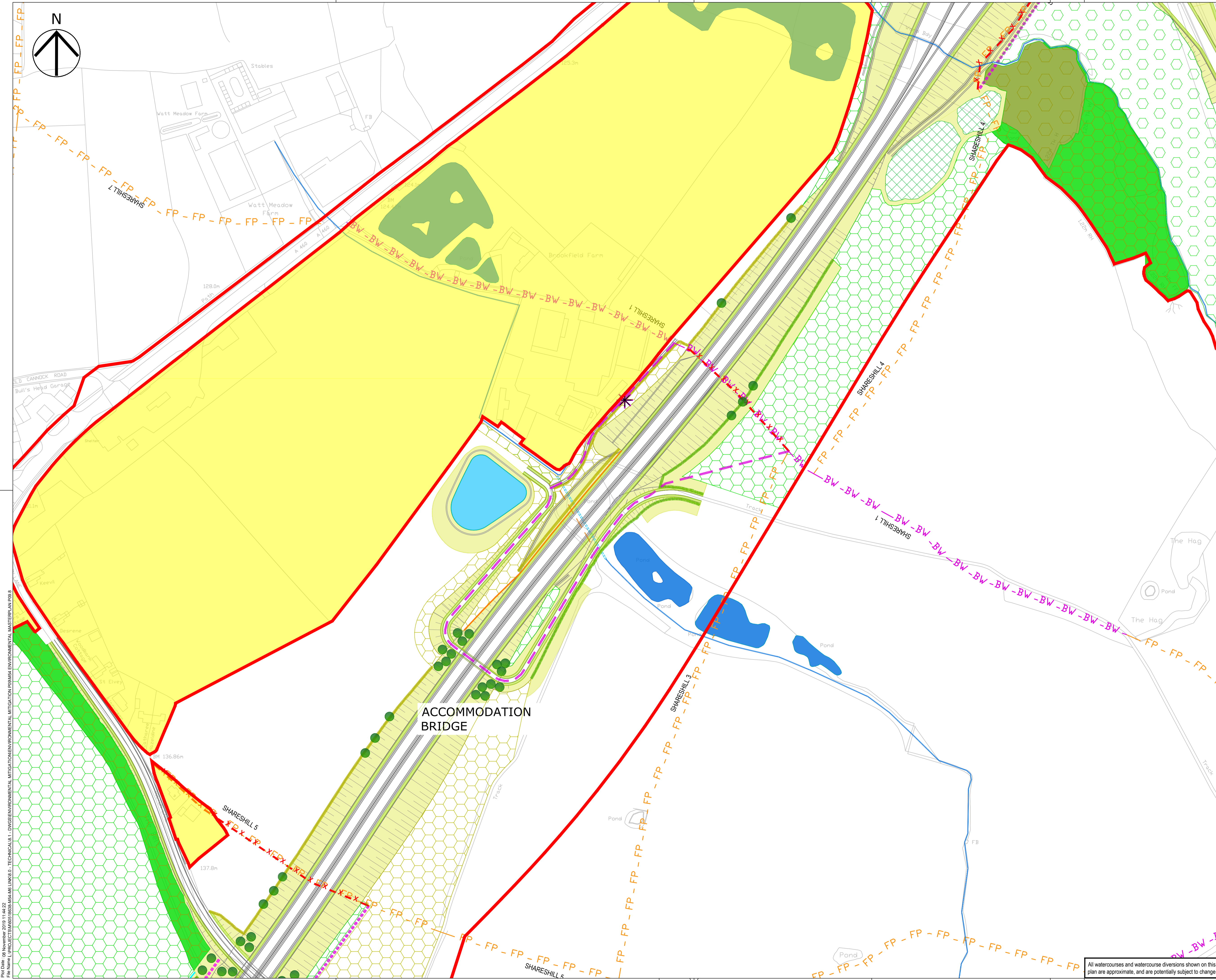

SAFETY, HEALTH AND ENVIRONMENTAL INFORMATION BOX	
IT IS ASSUMED THAT ALL WORKS ON THIS DRAWING WILL BE CARRIED OUT BY A COMPETENT CONTRACTOR WORKING, WHERE APPROPRIATE, TO AN APPROPRIATE METHOD STATEMENT.	
THIS DRAWING IS TO BE USED ONLY FOR THE PURPOSE OF ISSUE THAT IT WAS ISSUED FOR AND IS SUBJECT TO AMENDMENT.	
EXCEPTIONAL RISKS RELATING TO THE WORKS ASSOCIATED WITH THIS DRAWING ARE IDENTIFIED BELOW.	
CONSTRUCTION	
MAINTENANCE / OPERATION / DECOMMISSIONING / DEMOLITION	
Legend <ul style="list-style-type: none"> The Scheme Order limits Proposed site compound location Existing retained woodland Existing retained ancient woodland Veteran trees Existing ponds Existing watercourse - open Existing watercourse - culvert Existing PRoW - footpath Existing PRoW - bridleway 	
Proposed Mitigation <ul style="list-style-type: none"> Proposed ancient woodland compensation woodland - EFD Proposed species rich grassland (LE1.3) - EFB / EFD Proposed amenity grassland (LE1.1) - EFB Proposed woodland (LE2.1) - EFB / EFD Proposed woodland (LE2.1) - EFA Proposed native species hedgerow (LE4.3) - EFB / EFD Proposed native species hedgerow (LE4.3) - EFA Proposed individual trees (LE5.1) - EFB Proposed marsh and wet grassland (LE6.4) - EFB / EFD False cutting - EFA / EFG Existing watercourse - diverted - EFH Proposed drainage ponds - EFH Diverted watercourse - culvert - EFH Proposed ditch - EFH Proposed noise barrier - EFG PRoW / footway removal Proposed PRoW - Footpath Proposed PRoW - Bridleway Proposed shared footpath / cycleway 	
Ecology <ul style="list-style-type: none"> Proposed area for ecology pond - EFD Proposed mammal tunnels - EFD 	
Planned Environmental Objectives <ul style="list-style-type: none"> Visual screening Landscape integration Nature conservation and biodiversity Water quality Auditory amenity 	

DRAFT

General updates	LB	RW	Check	Date	Suffix
				08.11.2019	PO9

Purpose of issue
SUITABLE FOR INFORMATION

Client
 Highways England
 Major Projects
 The Cuts
 199 Wharfedale Street
 Birmingham
 B1 1RN



Development Consent Order Number
TR010054

Project Title
M54 to M6 Link Road

Drawing Title
**FIGURE 2.4
 DRAFT ENVIRONMENTAL
 MASTERPLAN
 SHEET 2 OF 5**

Designed	Draw	Checked	Approved	Date
NW	LB	RW	TP	08.11.2019

Internal Project No.
 60536736

Scale	Zone	Highways General
1:1500		

THIS DOCUMENT HAS BEEN PREPARED PURSUANT TO AND SUBJECT TO THE TERMS OF AECOM'S APPOINTMENT BY ITS CLIENT. AECOM ACCEPTS NO LIABILITY FOR ANY USE OF THIS DOCUMENT OTHER THAN BY ITS ORIGINAL CLIENT OR FOLLOWING AECOM'S EXPRESS AGREEMENT TO SUCH USE, AND ONLY FOR THE PURPOSES FOR WHICH IT WAS PREPARED AND PROVIDED.

All watercourses and watercourse diversions shown on this plan are approximate, and are potentially subject to change.

P09 Date: 08 November 2019 11:44:22
 File Name: L:\PROJECTS\50000\BIRMINGHAM\LINK60 - TECHNICALS - DIVISION\ENVIRONMENTAL MITIGATION\ENVIRONMENTAL MASTERPLAN\F09.8

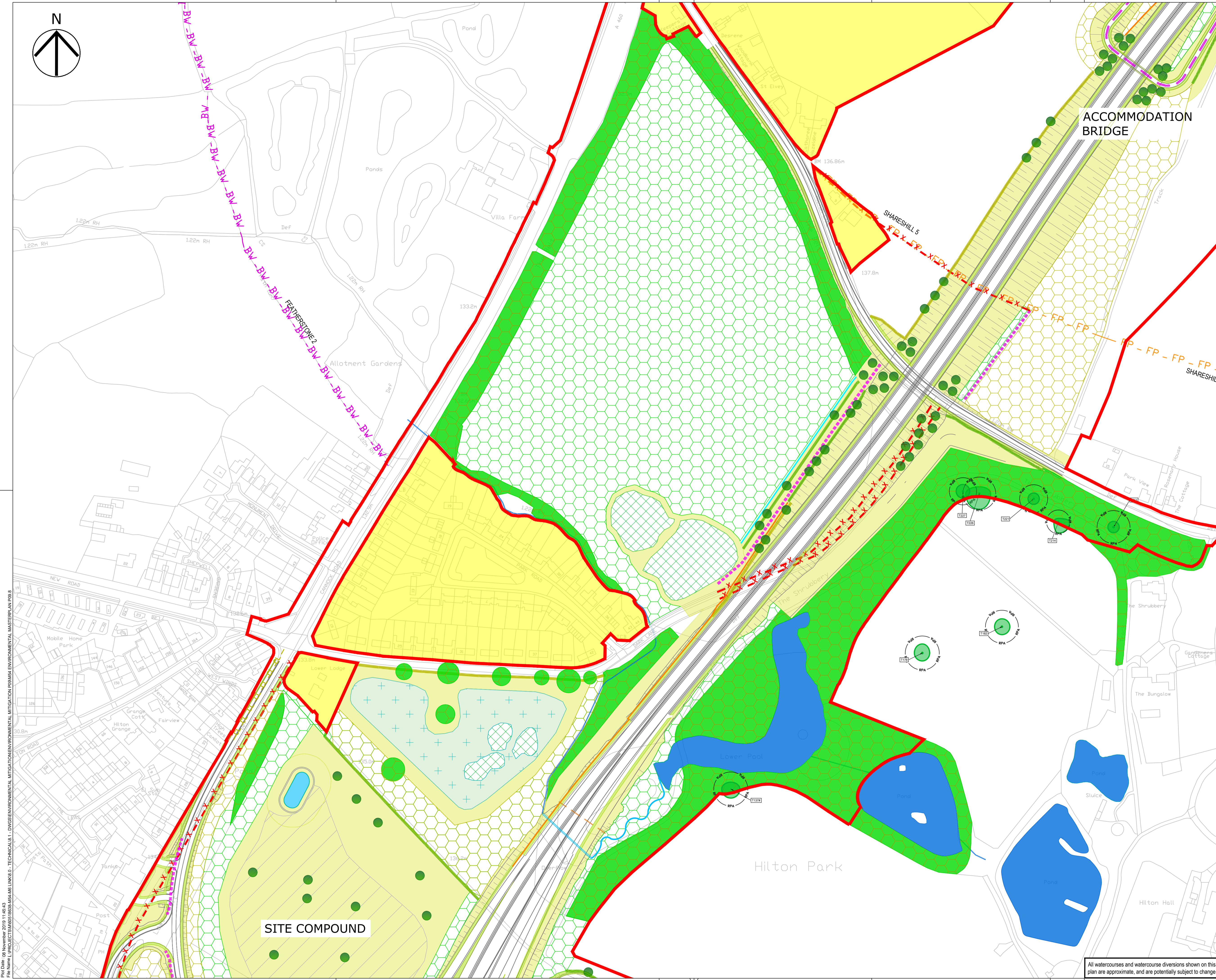
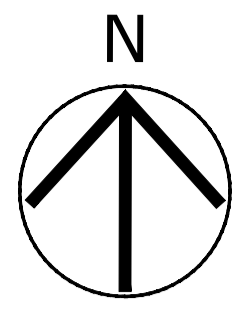

SAFETY, HEALTH AND ENVIRONMENTAL INFORMATION BOX

IT IS ASSUMED THAT ALL WORKS ON THIS DRAWING WILL BE CARRIED OUT BY A COMPETENT CONTRACTOR WORKING, WHERE APPROPRIATE, TO AN APPROPRIATE METHOD STATEMENT.

THIS DRAWING IS TO BE USED ONLY FOR THE PURPOSE OF ISSUE THAT IT WAS ISSUED FOR AND IS SUBJECT TO AMENDMENT.

EXCEPTIONAL RISKS RELATING TO THE WORKS ASSOCIATED WITH THIS DRAWING ARE IDENTIFIED BELOW.

CONSTRUCTION

MAINTENANCE / OPERATION / DECOMMISSIONING / DEMOLITION

- Legend**
- The Scheme
 - Order limits
 - Proposed site compound location
 - Existing retained woodland
 - Existing retained ancient woodland
 - Veteran trees
 - Existing ponds
 - Existing watercourse - open
 - Existing watercourse - culvert
 - Existing PRoW - footpath
 - Existing PRoW - bridleway
- Proposed Mitigation**
- Proposed ancient woodland compensation woodland - EFD
 - Proposed species rich grassland (LE1.3) - EFB / EFD
 - Proposed amenity grassland (LE1.1) - EFB
 - Proposed woodland (LE2.1) - EFB / EFD
 - Proposed woodland (LE2.1) - EFA
 - Proposed native species hedgerow (LE4.3) - EFB / EFD
 - Proposed native species hedgerow (LE4.3) - EFA
 - Proposed individual trees (LE5.1) - EFB
 - Proposed marsh and wet grassland (LE6.4) - EFB / EFD
 - False cutting - EFA / EFG
 - Existing watercourse - diverted - EFH
 - Proposed drainage ponds - EFH
 - Diverted watercourse - culvert - EFH
 - Proposed ditch - EFH
 - Proposed noise barrier - EFG
 - PRoW / footway removal
 - Proposed PRoW - Footpath
 - Proposed PRoW - Bridleway
 - Proposed shared footpath / cycleway
- Ecology**
- Proposed area for ecology pond - EFD
 - Proposed mammal tunnels - EFD
- Planned Environmental Objectives**
- Visual screening
 - Landscape integration
 - Nature conservation and biodiversity
 - Water quality
 - Auditory amenity

DRAFT

General updates	LB	RW	08.11.2019	PO9
Revision Details	By	Check	Date	Suffix

Purpose of issue

SUITABLE FOR INFORMATION

Client
Highways England
 Major Projects
 The Cule
 199 Wharfedale Street
 Birmingham
 B1 1RN



Development Consent Order Number
TR010054

Project Title
M54 to M6 Link Road

Drawing Title
**FIGURE 2.5
 DRAFT ENVIRONMENTAL
 MASTERPLAN
 SHEET 3 OF 5**

Designed	DRAWN	CHECKED	APPROVED	DATE
NW	LB	RW	TP	08.11.2019
Internal Project No.	Suitability			
60536736	S2			
Scale @ A1	Zone			
1:1500	Highways General			

THIS DOCUMENT HAS BEEN PREPARED PURSUANT TO AND SUBJECT TO THE TERMS OF AECOM'S APPOINTMENT BY ITS CLIENT. AECOM ACCEPTS NO LIABILITY FOR ANY USE OF THIS DOCUMENT OTHER THAN BY ITS ORIGINAL CLIENT OR FOLLOWING AECOM'S EXPRESS AGREEMENT TO SUCH USE, AND ONLY FOR THE PURPOSES FOR WHICH IT WAS PREPARED AND PROVIDED.

Drawing Number	1 Originator	1 Volume	Rev
HE514465 -ACM	-ELS -	-SW-R -0005	PO9
M54	Location	I Type	I Role

All watercourses and watercourse diversions shown on this plan are approximate, and are potentially subject to change.

P09 Date: 08 November 2019 11:46:43
 File Name: L:\PROJECTS\30000\B003\464\M54\LINK\3.0 - TECHNICALS - 1 - CIVIS\ENVIRONMENTAL MITIGATION\ENVIRONMENTAL MASTERPLAN P09.B

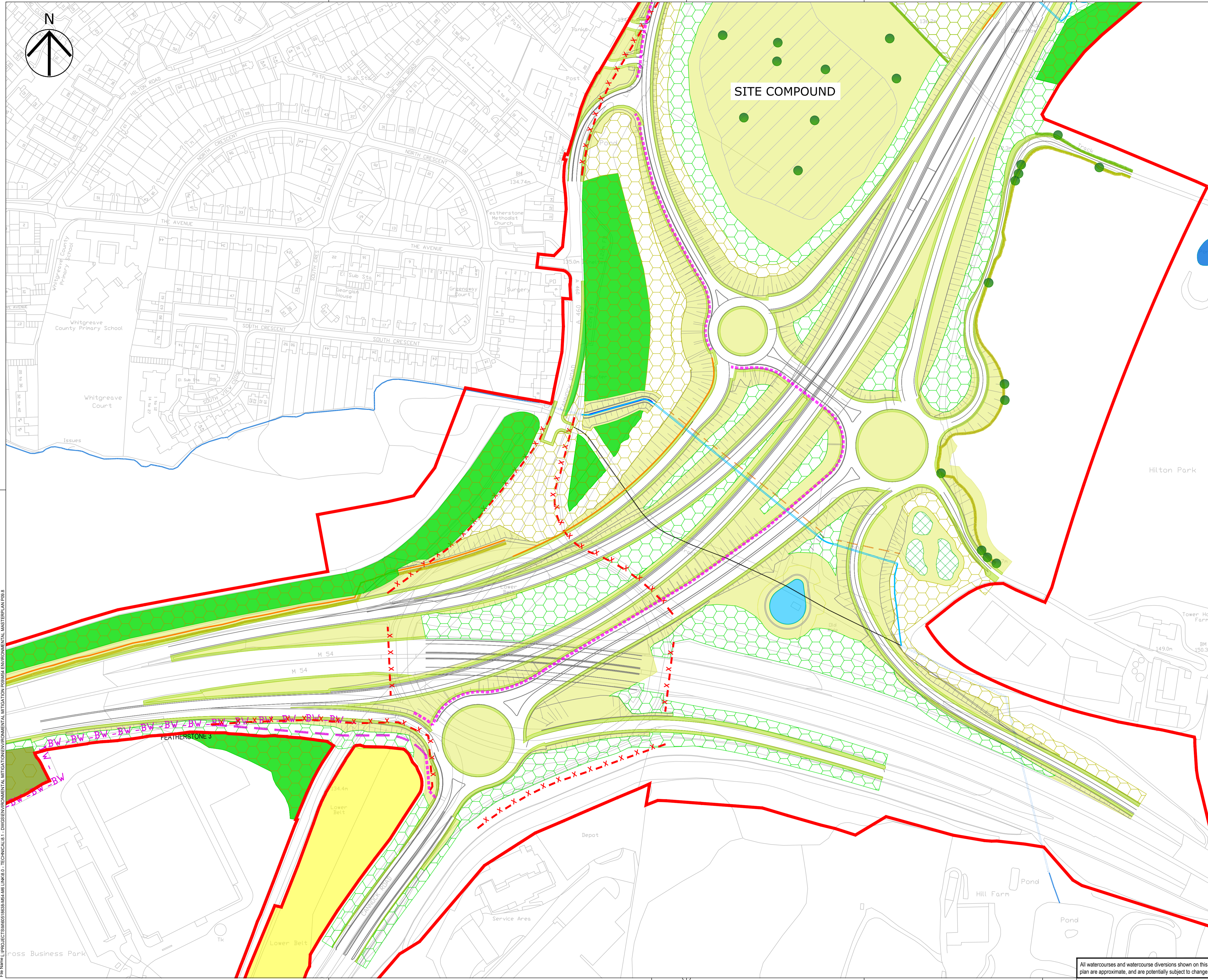
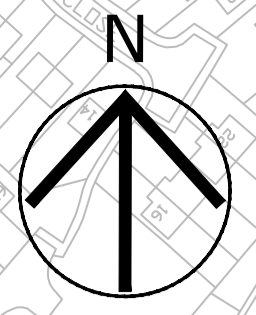

SAFETY, HEALTH AND ENVIRONMENTAL INFORMATION BOX

IT IS ASSUMED THAT ALL WORKS ON THIS DRAWING WILL BE CARRIED OUT BY A COMPETENT CONTRACTOR WORKING, WHERE APPROPRIATE, TO AN APPROPRIATE METHOD STATEMENT.

THIS DRAWING IS TO BE USED ONLY FOR THE PURPOSE OF ISSUE THAT IT WAS ISSUED FOR AND IS SUBJECT TO AMENDMENT.

EXCEPTIONAL RISKS RELATING TO THE WORKS ASSOCIATED WITH THIS DRAWING ARE IDENTIFIED BELOW.

CONSTRUCTION

MAINTENANCE / OPERATION / DECOMMISSIONING / DEMOLITION

Legend

- The Scheme
- Order limits
- Proposed site compound location
- Existing retained woodland
- Existing retained ancient woodland
- Veteran trees
- Existing ponds
- Existing watercourse - open
- Existing watercourse - culvert
- Existing PRoW - footpath
- Existing PRoW - bridleway

Proposed Mitigation

- Proposed ancient woodland compensation woodland - EFD
- Proposed species rich grassland (LE1.3) - EFB / EFD
- Proposed amenity grassland (LE1.1) - EFB
- Proposed woodland (LE2.1) - EFB / EFD
- Proposed woodland (LE2.1) - EFA
- Proposed native species hedgerow (LE4.3) - EFB / EFD
- Proposed native species hedgerow (LE4.3) - EFA
- Proposed individual trees (LE5.1) - EFB
- Proposed marsh and wet grassland (LE6.4) - EFB / EFD
- False cutting - EFA / EFG
- Existing watercourse - diverted - EFH
- Proposed drainage ponds - EFH
- Diverted watercourse - culvert - EFH
- Proposed ditch - EFH
- Proposed noise barrier - EFG
- PRoW / footway removal
- Proposed PRoW - Footpath
- Proposed PRoW - Bridleway
- Proposed shared footpath / cycleway

Ecology

- Proposed area for ecology pond - EFD
- Proposed mammal tunnels - EFD

Planned Environmental Objectives

- Visual screening
- Landscape integration
- Nature conservation and biodiversity
- Water quality
- Auditory amenity

DRAFT

General updates	LB	08.11.2019	PO9
Revision Details	By	Check	Date

SUITABLE FOR INFORMATION

Client: Highways England
 Major Projects
 The Cube
 199 Wharfedale Street
 Birmingham
 B1 1RN

Development Consent Order Number: **TR010054**

Project Title: **M54 to M6 Link Road**

Drawing Title: **FIGURE 2.6
DRAFT ENVIRONMENTAL
MASTERPLAN
SHEET 4 OF 5**

Designed	Draw	Checked	Approved	Date
NW	LB	RW	TP	08.11.2019

Internal Project No. 60536736
 Scale @ A1 1:1500
 Zone Highways General

THIS DOCUMENT HAS BEEN PREPARED PURSUANT TO AND SUBJECT TO THE TERMS OF AECOM'S APPOINTMENT BY ITS CLIENT. AECOM ACCEPTS NO LIABILITY FOR ANY USE OF THIS DOCUMENT OTHER THAN BY ITS ORIGINAL CLIENT OR FOLLOWING AECOM'S EXPRESS AGREEMENT TO SUCH USE, AND ONLY FOR THE PURPOSES FOR WHICH IT WAS PREPARED AND PROVIDED.

Drawing Number	Highways England PIN	I Originator	I Volume	Rev
M54	HE514465	-ACM	-ELS -	PO9
Location		I Type	I Role	I Number
		-SWR	-0006	

All watercourses and watercourse diversions shown on this plan are approximate, and are potentially subject to change.

Proj Date: 08 November 2019 11:47:25
 File Name: PROJECTS\M54\M6 LINK ROAD - TECHNICALS - DIVISIONS\ENVIRONMENTAL MITIGATION\ENVIRONMENTAL MASTERPLAN P09.B

