

# Appendix E

## Existing technology geographic layout drawings

DO NOT SCALE

A1

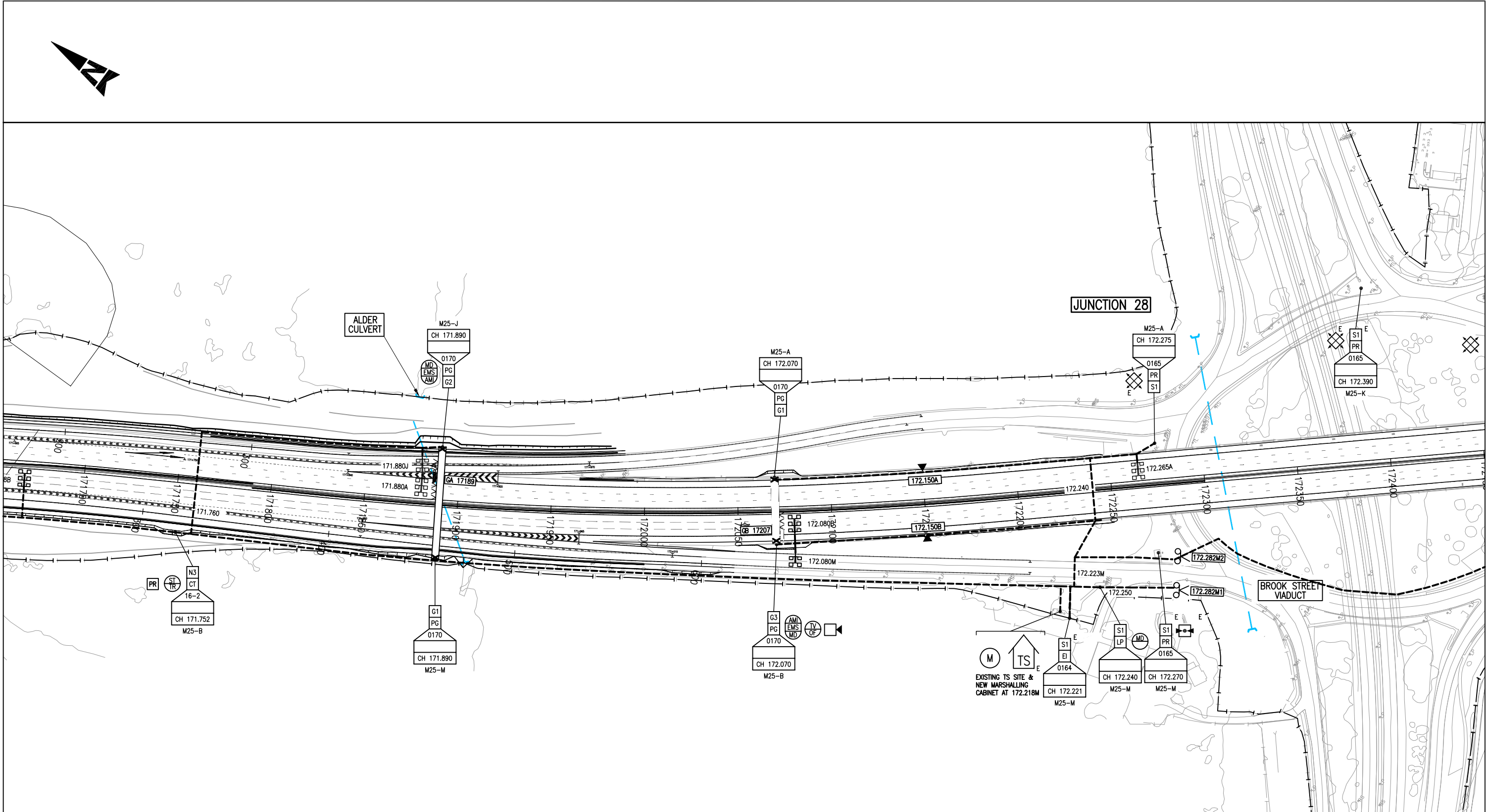

THIS MAP IS BASED ON ORDNANCE SURVEY MATERIAL WITH THE PERMISSION OF ORDNANCE SURVEY ON BEHALF OF THE CONTROLLER OF HER MAJESTY'S STATIONERY OFFICE. © CROWN COPYRIGHT. UNAUTHORISED REPRODUCTION INFRINGES CROWN COPYRIGHT AND MAY LEAD TO PROSECUTION OR CIVIL PROCEEDINGS. HIGHWAYS AGENCY 100018926, 2008.

PRIOR TO USING THIS DRAWING THE CONTRACTOR MUST REFER TO THE DESIGNER'S DESIGN RISK ASSESSMENTS AND TO THE HEALTH AND SAFETY PLAN FOR RISKS CONCERNING THIS SECTION OF THE WORKS. THE PRINCIPAL CONTRACTOR AND OTHER CONTRACTORS SHOULD NOTE THAT THE RISKS IDENTIFIED IN THESE DOCUMENTS MAY NOT BE EXHAUSTIVE AND FURTHER CONSIDERATION BY THEM MAY BE NECESSARY.

THE CONTRACTOR IS RESPONSIBLE FOR CO-ORDINATING UTILITY WORKS SUCH THAT THERE IS NO CLASH WITH ROADWORKS.

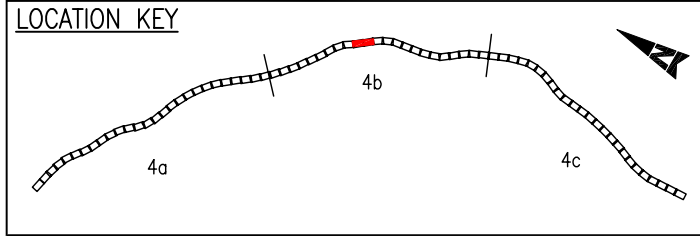

NOTE  
1. EI AT 172.221M IS 3 PHASE SUPPLY

IFC ISSUE SUBJECT TO THE APPROVAL OF ALL OUTSTANDING DEPARTURES. PLEASE REFER TO THE DEPARTURE TRACKER REFERENCE 5074439/S4/00/GEN/1513 FOR A SUMMARY OF DEPARTURE STATUS.

SAFETY, HEALTH AND ENVIRONMENTAL INFORMATION

IN ADDITION TO THE HAZARDS/RISKS NORMALLY ASSOCIATED WITH THE TYPES OF WORK DETAILED ON THIS DRAWING, NOTE THE FOLLOWING SIGNIFICANT RESIDUAL RISKS (REFERENCE SHALL ALSO BE MADE TO THE DESIGN HAZARD LOG).

CONSTRUCTION	NONE
MAINTENANCE/CLEANING	NONE
USE	NONE
DECOMMISSIONING/DEMOLITION	NONE

Stat	Rev	Purpose of Issue	Date	Auth	Rev	Description	LH	By	Date	Chk'd	Auth
						X AS BUILT	LH		15.06.11	AE	DM

Contractor  
**Connect Plus**

Designer  
**ATKINS** **Gifford WSP**

Client  
**HIGHWAYS AGENCY**

Project  
**M25 DBFO WIDENING**

Title <b>SECTION 4 - TECHNOLOGY GEOGRAPHIC LAYOUT CHAINAGE 171700 - 172400</b>	
Sheet Size <b>A1</b>	Original Scale 1:1000
Designed/Drawn K.H. Date 27/07/09	Checked O.M. Date 28/07/09
Authorised J.H. Date 28/07/09	Rev -
Status X	Drawing Number 5074439/S4b/DR/TC/4111a

DO NOT SCALE

A1

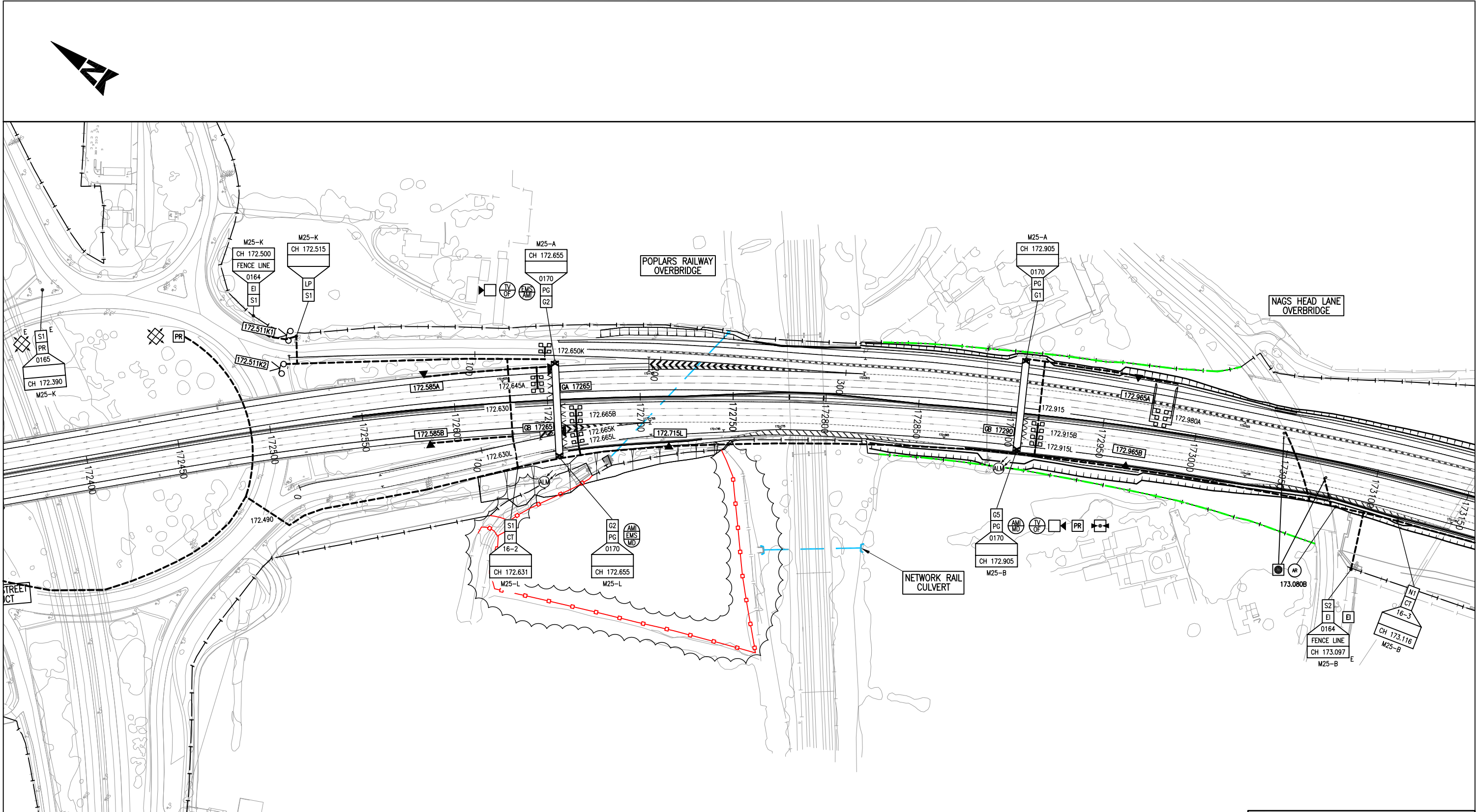

THIS MAP IS BASED ON ORDNANCE SURVEY MATERIAL WITH THE PERMISSION OF ORDNANCE SURVEY ON BEHALF OF THE CONTROLLER OF HER MAJESTY'S STATIONERY OFFICE. © CROWN COPYRIGHT. UNAUTHORISED REPRODUCTION INFRINGES CROWN COPYRIGHT AND MAY LEAD TO PROSECUTION OR CIVIL PROCEEDINGS. HIGHWAYS AGENCY 100018926, 2008.

PRIOR TO USING THIS DRAWING THE CONTRACTOR MUST REFER TO THE DESIGNER'S DESIGN RISK ASSESSMENTS AND TO THE HEALTH AND SAFETY PLAN FOR RISKS CONCERNING THIS SECTION OF THE WORKS. THE PRINCIPAL CONTRACTOR AND OTHER CONTRACTORS SHOULD NOTE THAT THE RISKS IDENTIFIED IN THESE DOCUMENTS MAY NOT BE EXHAUSTIVE AND FURTHER CONSIDERATION BY THEM MAY BE NECESSARY.

THE CONTRACTOR IS RESPONSIBLE FOR CO-ORDINATING UTILITY WORKS SUCH THAT THERE IS NO CLASH WITH ROADWORKS.

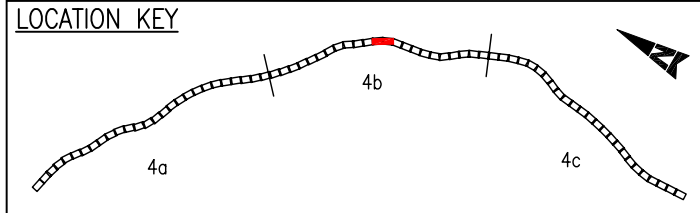

Stat	Rev	Purpose of Issue	Date	Auth	Rev	Description	By	Date	Chk'd	Auth
	X	AS BUILT	LH 15.06.11	AE	DM					

Contractor  
**Connect Plus**

Designer  
**ATKINS** **Gifford WSP**

Client  
**HIGHWAYS AGENCY**

Project  
**M25 DBFO WIDENING**

SAFETY, HEALTH AND ENVIRONMENTAL INFORMATION				
IN ADDITION TO THE HAZARDS/RISKS NORMALLY ASSOCIATED WITH THE TYPES OF WORK DETAILED ON THIS DRAWING, NOTE THE FOLLOWING SIGNIFICANT RESIDUAL RISKS (REFERENCE SHALL ALSO BE MADE TO THE DESIGN HAZARD LOG).				
CONSTRUCTION				
NONE				
MAINTENANCE/CLEANING				
NONE				
USE				
NONE				
DECOMMISSIONING/DEMOLITION				
NONE				
IFC ISSUE SUBJECT TO THE APPROVAL OF ALL OUTSTANDING DEPARTURES. PLEASE REFER TO THE DEPARTURE TRACKER REFERENCE 5074439/S4/DO/GEN/1513 FOR A SUMMARY OF DEPARTURE STATUS.				
Title SECTION 4 - TECHNOLOGY GEOGRAPHIC LAYOUT CHAINAGE 172400 - 173100				
Sheet Size <b>A1</b>	Original Scale 1:1000	Designed/Drawn K.H. Date 27/07/09	Checked O.M. Date 28/07/09	Authorised J.H. Date 28/07/09
Status X	Drawing Number 5074439/S4b/DR/TC/4111b	Rev -		

DO NOT SCALE

100  
Millimetres

0 10

### TECHNOLOGY GEOGRAPHIC SYMBOLS

**CABINET SITES**

XXXX — CARRIAGEWAY REFERENCE  
 XXXX — SITE CHAINAGE REFERENCE  
 XXXX — MARKER POST LOCATION  
 XXXX — ABOVE GROUND JOINT FRAME TYPE / EI SITE REFERENCE  
 X — CABINET TYPE 'X' TM DENOTES AN ROTTM SITE  
 X — PLINTH DETAIL REFERENCE  
 G = GANTRY CABINET SITE  
 C = CANTILEVER CABINET SITE  
 N = NON-GANTRY CABINET SITE  
 S = CABINET SITE LOCATED OFF MAIN-LINE SPECIFIC ARRANGEMENT

EI — CABINET USED AS A ELECTRICITY SUPPLY INTERFACE CABINET, CABINET TO BE 609 FOR SINGLE PHASE AND CUSTOM FEEDER PILLAR FOR 3 PHASE.  
 PR — CABINET TYPE 609 USED AS A POWER SUPPLY FOR RURAL EQUIPMENT  
 PG — CABINET TYPE 609 USED AS A POWER SUPPLY FOR GANTRY  
 LP — CABINET TYPE 609 USED AS A POWER SUPPLY FOR RURAL EQUIPMENT AND PROVISION FOR DATA ISOLATION  
 TC — TRANSMISSION CABINET  
 P-TM — P-TM INDICATES BATTERY ENCLOSURE BACK-UP AND ELECTRICAL DISTRIBUTION UNIT TO TRAFFIC MANAGEMENT LED SIGNS. THIS IS HOUSED IN EITHER A BESPOKE CABINET AT VERGE SIDE OR LOCATED IN VOID WITHIN CSB FOR CR SITES

AM MD — CABINET TYPE 600 USED TO HOUSE AM (ADVANCED MOTORWAY INDICATOR) ROADSIDE CONTROLLER) AND MD (MIDAS DETECTOR EQUIPMENT)  
 MS4 — CABINET TYPE 600 USED TO MS4 MESSAGE SIGN EQUIPMENT  
 NRTS MD — CABINET TYPE 600 USED TO HOUSE NRTS (NRTS EQUIPMENT) AND MD (MIDAS DETECTOR EQUIPMENT)  
 MS3 — CABINET TYPE 600 USED TO MS3 MESSAGE SIGN EQUIPMENT  
 NRTS — CABINET TYPE 600 USED TO HOUSE NRTS TRANSMISSION EQUIPMENT  
 AM EMS MD — CABINET TYPE 600 USED TO HOUSE AM (ADVANCED MOTORWAY INDICATOR), EMS (MESSAGE SIGN) AND MD (MIDAS DETECTOR) EQUIPMENT  
 MS4 AM MD — CABINET TYPE 600 USED TO HOUSE MS4 (MESSAGE SIGN) AND AM (ADVANCED MOTORWAY INDICATOR) ROADSIDE CONTROLLER) MS4 (MESSAGE SIGN) EQUIPMENT.  
 MS4 MD — CABINET TYPE 600 USED TO HOUSE MS4 (MESSAGE SIGN) AND MD (MIDAS DETECTOR) EQUIPMENT.  
 ENF — CABINET TYPE 600 USED AS ENFORCEMENT EQUIPMENT  
 TV — CABINET TYPE 600 USED TO HOUSE CCTV RELATED EQUIPMENT  
 M — CABINET TYPE 600 USED AS MARSHALLING CABINET AT TRANSMISSION STATION BUILDING  
 MD — CABINET TYPE 600 USED TO HOUSE MD (MIDAS DETECTOR EQUIPMENT)  
 NRTS MD — CABINET TYPE 600 USED TO HOUSE NRTS (NRTS EQUIPMENT) AND MD (MIDAS DETECTOR) EQUIPMENT.  
 X — CCTV PTZ SURVEILLANCE CAMERA (MST OR STRUCTURE MOUNTED)  
 EAV — EXTERNAL ASPECT VERIFICATION CAMERA FOR HADECS GANTRY SITES  
 CG — CUSTOM GANTRY CABINET  
 ▼ — EMERGENCY ROADSIDE TELEPHONE TYPE 354  
 ○ — SINGLE POST MOUNTED SLIP ROAD SIGNAL TYPE 9409  
 ○ — AMI MOUNTED ON 2xPOST TYPE 75  
 ○ — FOG DETECTOR EQUIPMENT ON POST TYPE 75  
 — — LED TM SIGN VERGE MOUNTED  
 — — LED TM SIGN CENTRAL RESERVE  
 --- --- EXISTING CABLE DUCT ROUTE  
 --- --- CONCRETE ENCASED DUCTS  
 - - - - PROPOSED CABLE DUCT ROUTE  
 □ □ LOOP ARRAY (NO. OF LOOPS SHOWN DICTATE NUMBER OF LANES) (FLEXIBLE INSTALLATION TYPE)  
 □ □ CANTILEVER GANTRY WITH MS3 MESSAGE SIGN  
 □ □ CANTILEVER GANTRY WITH MS4 MESSAGE SIGN  
 □ □ GANTRY WITH MS4 MESSAGE SIGN AND AM'S  
 □ □ GANTRY WITH MS4 MESSAGE SIGN  
 □ □ GANTRY FOR ADS MESSAGE SIGNS  
 ALM — AMBIENT LIGHT MONITOR (FOR AMI SYSTEM)  
 ○ — POLE MOUNTED RADAR DETECTOR

### TECHNOLOGY CABLE SCHEMATIC SYMBOLS

EI — CABINET USED AS A ELECTRICITY SUPPLY INTERFACE CABINET, CABINET TO BE 609 FOR SINGLE PHASE AND CUSTOM FEEDER PILLAR FOR 3 PHASE.  
 PR — CABINET TYPE 609 USED AS A POWER SUPPLY FOR RURAL EQUIPMENT  
 PG — CABINET TYPE 609 USED AS A POWER SUPPLY FOR GANTRY  
 LP — CABINET TYPE 609 USED AS A POWER SUPPLY FOR RURAL EQUIPMENT AND PROVISION FOR DATA ISOLATION  
 TC — TRANSMISSION CABINET  
 G — GANTRY LIGHTING  
 H — EXISTING ANPR HALDO CABINET  
 AM MD — CABINET TYPE 600 USED TO HOUSE AM (ADVANCED MOTORWAY INDICATOR) ROADSIDE CONTROLLER) AND MD (MIDAS DETECTOR EQUIPMENT)  
 MS4 — CABINET TYPE 600 USED TO MS4 MESSAGE SIGN EQUIPMENT  
 NRTS MD — CABINET TYPE 600 USED TO HOUSE NRTS TRANSMISSION EQUIPMENT AND MD (MIDAS DETECTOR EQUIPMENT)  
 MS3 — CABINET TYPE 600 USED TO MS3 MESSAGE SIGN EQUIPMENT  
 NRTS — CABINET TYPE 600 USED TO HOUSE NRTS TRANSMISSION EQUIPMENT  
 AM EMS MD — CABINET TYPE 600 USED TO HOUSE AM (ADVANCED MOTORWAY INDICATOR), EMS (MESSAGE SIGN) AND MD (MIDAS DETECTOR) EQUIPMENT  
 MS4 AM MD — CABINET TYPE 600 USED TO HOUSE MS4 (MESSAGE SIGN) AND AM (ADVANCED MOTORWAY INDICATOR) ROADSIDE CONTROLLER) MS4 (MESSAGE SIGN) EQUIPMENT.  
 MS4 MD — CABINET TYPE 600 USED TO HOUSE MS4 (MESSAGE SIGN) AND MD (MIDAS DETECTOR) EQUIPMENT.  
 ENF — CABINET TYPE 600 USED AS ENFORCEMENT EQUIPMENT  
 TV — CABINET TYPE 600 USED TO HOUSE CCTV RELATED EQUIPMENT  
 M — CABINET TYPE 600 USED AS MARSHALLING CABINET AT TRANSMISSION STATION BUILDING  
 MD — CABINET TYPE 600 USED TO HOUSE MD (MIDAS DETECTOR EQUIPMENT)  
 NRTS MD — CABINET TYPE 600 USED TO HOUSE NRTS (NRTS EQUIPMENT) AND MD (MIDAS DETECTOR) EQUIPMENT  
 BAT — BESPOKE CABINET USED TO HOUSE ROTTM BATTERIES/POWER MONITORING EQUIPMENT  
 X — CCTV PTZ SURVEILLANCE CAMERA (MST OR STRUCTURE MOUNTED)  
 EAV — EXTERNAL ASPECT VERIFICATION CAMERA FOR HADECS GANTRY SITES  
 CG — CUSTOM GANTRY CABINET  
 WM — PROPOSED 'WM' SENSOR  
 ANPR — PROPOSED ANPR 600 CABINET  
 NRTS MD — PROPOSED 600 CABINET HOUSING NRTS EQUIPMENT AND ROTTM MEDIA CONVERTER  
 MT — EXISTING 600 CABINET HOUSING EXISTING MIDAS DETECTOR AND RELOCATED MIDAS IPT.  
 NRTS MD — BESPOKE CABINET USED TO HOUSE ROTTM BATTERIES/POWER MONITORING EQUIPMENT AND MEDIA CONVERTER  
 PC — SERVICE CATERGORY, 8 IP CONVERTER  
 ▼ — EMERGENCY ROADSIDE TELEPHONE TYPE 354  
 ○ — SINGLE POST MOUNTED SLIP ROAD SIGNAL TYPE 9409  
 ○ — AMI MOUNTED ON 2xPOST TYPE 75  
 ○ — FOG DETECTOR EQUIPMENT ON POST TYPE 85  
 — — LED TM SIGN VERGE MOUNTED  
 □ □ LOOP ARRAY (NO. OF LOOPS SHOWN DICTATE NUMBER OF LANES) (FLEXIBLE INSTALLATION TYPE)  
 □ □ CANTILEVER GANTRY WITH MS3 MESSAGE SIGN  
 □ □ CANTILEVER GANTRY WITH MS4 MESSAGE SIGN  
 ○ — EXISTING ANPR CAMERA (POLE MOUNTED)  
 ○ — EXISTING ANPR CAMERA (BRIDGE MOUNTED)

### TECHNOLOGY CABLE SCHEMATIC SYMBOLS CONTINUED

GANTRY WITH MS4 MESSAGE SIGN AND AM'S  
 GANTRY WITH MS4 MESSAGE SIGN  
 GANTRY FOR ADS MESSAGE SIGNS  
 ALM — AMBIENT LIGHT MONITOR (FOR AMI SYSTEM)  
 C.E OF — OPTICAL FIBRE CABLE JOINT ENCLOSURE HOUSED WITHIN A TYPE CHAMBER  
 CH15-890 — SCHEME CHAINAGE REFERENCE  
 (PCZZ) YYYX — ENERGY CABLE - YY EQUALS THE LAST TWO DIGITS OF THE DRAWING NUMBER, XX EQUALS THE CABLE REFERENCE. CABLE SIZE TO BE 10mm<sup>2</sup> UNLESS INDICATED OTHERWISE BY ZZ EQUALS THE CABLE SIZE mm<sup>2</sup>  
 (Q) YYYX — QUAD CABLE - YY EQUALS THE LAST TWO DIGITS OF THE DRAWING NUMBER AND XX EQUALS THE CABLE REFERENCE  
 (960F-LONG) XXXX — OPTICAL FIBRE CABLE - XXXX EQUALS THE CABLE REFERENCE  
 (OFL) XXXX — LOCAL OPTICAL FIBRE CABLE - XXXX EQUALS THE CABLE REFERENCE  
 (10PR) XXXX — 10 PAIR CABLE - XXXX EQUALS THE CABLE REFERENCE  
 (CATS) XXXX — CATS DATA CABLE  
 (EAV-COMP) — EXTERNAL ASPECT VERIFICATION COMPOSITE CABLE  
 (RADAR-COMP) — RADAR DETECTOR COMPOSITE CABLE  
 (PC10) YYYX — ENERGY CABLE FOR LED TM SIGNS  
 □ — ENERGY CABLE THROUGH JOINT  
 PR — LED TM SIGN - TYPE 609 LOCAL POWER CABINET (ADDITIONAL ELECTRICAL CIRCUIT DISTRIBUTION)  
 P — LED TM SIGN - LOCAL DC DISTRIBUTION CABINET  
 ○ — LED TM SIGN  
 ■ — POWER CABLE REDUCTION JOINT

### TECHNOLOGY DUCT SCHEMATIC SYMBOLS

EI — CABINET USED AS A ELECTRICITY SUPPLY INTERFACE CABINET, CABINET TO BE 609 FOR SINGLE PHASE AND CUSTOM FEEDER PILLAR FOR 3 PHASE.  
 PR — CABINET TYPE 609 USED AS A POWER SUPPLY FOR RURAL EQUIPMENT  
 PG — CABINET TYPE 609 USED AS A POWER SUPPLY FOR GANTRY  
 PW — CABINET TYPE 609 PRIVATE WIRE  
 LP — CABINET TYPE 609 USED AS A POWER SUPPLY FOR RURAL EQUIPMENT AND PROVISION FOR DATA ISOLATION  
 TC — TRANSMISSION CABINET  
 AM MD — CABINET TYPE 600 USED TO HOUSE AM (ADVANCED MOTORWAY INDICATOR) ROADSIDE CONTROLLER) AND MD (MIDAS DETECTOR EQUIPMENT)  
 MS4 — CABINET TYPE 600 USED TO MS4 MESSAGE SIGN EQUIPMENT  
 NRTS MD — CABINET TYPE 600 USED TO HOUSE NRTS TRANSMISSION EQUIPMENT AND MD (MIDAS DETECTOR EQUIPMENT)  
 MS3 — CABINET TYPE 600 USED TO MS3 MESSAGE SIGN EQUIPMENT  
 NRTS — CABINET TYPE 600 USED TO HOUSE NRTS TRANSMISSION EQUIPMENT  
 AM EMS MD — CABINET TYPE 600 USED TO HOUSE AM (ADVANCED MOTORWAY INDICATOR), EMS (MESSAGE SIGN) AND MD (MIDAS DETECTOR) EQUIPMENT  
 MS4 AM MD — CABINET TYPE 600 USED TO HOUSE MS4 (MESSAGE SIGN) AND AM (ADVANCED MOTORWAY INDICATOR) ROADSIDE CONTROLLER) MS4 (MESSAGE SIGN) EQUIPMENT.  
 MS4 MD — CABINET TYPE 600 USED TO HOUSE MS4 (MESSAGE SIGN) AND MD (MIDAS DETECTOR) EQUIPMENT.  
 ENF — CABINET TYPE 600 USED AS ENFORCEMENT EQUIPMENT  
 TV — CABINET TYPE 600 USED TO HOUSE CCTV RELATED EQUIPMENT

### TECHNOLOGY DUCT SCHEMATIC SYMBOLS CONTINUED

M — CABINET TYPE 600 USED AS MARSHALLING CABINET AT TRANSMISSION STATION BUILDING  
 MD — CABINET TYPE 600 USED TO HOUSE MD (MIDAS DETECTOR EQUIPMENT)  
 NRTS MD — CABINET TYPE 600 USED TO HOUSE NRTS (NRTS EQUIPMENT) AND MD (MIDAS DETECTOR EQUIPMENT)  
 WM — PROPOSED 'WM' SENSOR  
 ANPR — PROPOSED ANPR 600 CABINET  
 X — CCTV PTZ SURVEILLANCE CAMERA (MST OR STRUCTURE MOUNTED)  
 EAV — EXTERNAL ASPECT VERIFICATION CAMERA FOR HADECS GANTRY SITES  
 CG — CUSTOM GANTRY CABINET  
 BAT — BESPOKE CABINET USED TO HOUSE ROTTM BATTERIES/POWER MONITORING EQUIPMENT AND MEDIA CONVERTER  
 NRTS MD — PROPOSED 600 CABINET HOUSING NRTS EQUIPMENT AND ROTTM MEDIA CONVERTER  
 BAT — BESPOKE CABINET USED TO HOUSE ROTTM BATTERIES/POWER MONITORING EQUIPMENT  
 ▼ — EMERGENCY ROADSIDE TELEPHONE TYPE 354  
 ○ — SINGLE POST MOUNTED SLIP ROAD SIGNAL TYPE 9409  
 ○ — AMI MOUNTED ON 2xPOST TYPE 75  
 ○ — FOG DETECTOR EQUIPMENT ON POST TYPE 75  
 — — LED TM SIGN VERGE MOUNTED  
 □ □ LOOP ARRAY (NO. OF LOOPS SHOWN DICTATE NUMBER OF LANES) (FLEXIBLE INSTALLATION TYPE)  
 □ □ CANTILEVER GANTRY WITH MS3 MESSAGE SIGN  
 □ □ CANTILEVER GANTRY WITH MS4 MESSAGE SIGN  
 □ □ GANTRY WITH MS4 MESSAGE SIGN AND AM'S  
 □ □ GANTRY WITH MS4 MESSAGE SIGN  
 □ □ GANTRY FOR ADS MESSAGE SIGNS  
 ALM — AMBIENT LIGHT MONITOR (FOR AMI SYSTEM)  
 C.E OF — OPTICAL FIBRE CABLE JOINT ENCLOSURE HOUSED WITHIN A TYPE CHAMBER  
 CH15-890 — SCHEME CHAINAGE REFERENCE  
 CH15-890 — CROSS CARRIAGEWAY DUCT SCHEME CHAINAGE REFERENCE  
 ○ — LED TM SIGN  
 --- --- NEW DUCT ROUTES - NUMBERS AND SIZES OF DUCT AS INDICATED  
 A — NEW CHAMBER TYPE 'A'  
 B — NEW CHAMBER TYPE 'B'  
 C — NEW CHAMBER TYPE 'C'  
 T — TELEPHONE CHAMBER  
 --- --- EXISTING DUCT ROUTES - NUMBERS AND SIZES OF DUCT AS INDICATED  
 A — EXISTING CHAMBER TYPE 'A'  
 B — EXISTING CHAMBER TYPE 'B'  
 T — EXISTING TELEPHONE CHAMBER  
 A<sup>M</sup> — CHAMBER TO BE MODIFIED

#### SAFETY, HEALTH AND ENVIRONMENTAL INFORMATION

In addition to the hazards/risks normally associated with the types of work detailed on this drawing, note the following significant residual risks (Reference shall also be made to the design hazard log).

Construction (Enter "None" if applicable)	P02	PJC	SPT	ARD	19/12/14	
Maintenance / Cleaning (Enter "None" if applicable)	First Issue	P03	PJC	SPT	ARD	26/02/15
Use (Enter "None" if applicable)	Tender Issue	P04	AC	JB	GN	03/07/15
Decommissioning / Demolition (Enter "None" if applicable)	Construction Issue	P05	AC	JB	SC	23/12/15
	For Construction	P06	MWS	JB	GN	01/07/16
	Updates for Construction	P07.1	---	---	---	---
	Updates for Construction	Rev	Drawn	Checked	App	Date
	Description					

Drawing Status	Subability	Project Title			
Work in Progress	S0	M1 Junction 19 to 16 Smart Motorway			
<b>ATKINS</b>					
Working on behalf of <b>highways england</b>					
Drawing Title	Scale	Drawn	Checked	Approved	Authorised
MOTORWAY COMMUNICATIONS LEGEND SHEET	NTS	---	---	---	---
Original Size	Date	Date	Date	Date	Date
A1	---	---	---	---	---
Drawing Number	Revision				
M1J1916-ATK-HW15-ZZ00-DR-E-1500	P07.1				