

A66 - Key Proposed Construction Activities (Phase 2 Works)

Traffic Management for construction works

Traffic will be diverted onto part of the new section of the new A66 to enable the remaining infrastructure works to be completed.

Construction of new carriageway next to existing A66

Where the existing A66 is being widened to the north or south of the existing carriageway and cannot be diverted then the new road will be built in two phases

Phase 2 traffic running on newly constructed road. The existing carriageway will be upgraded with a longitudinal safety zone installed along the edge of the newly constructed road to separate the public from the construction work area

Construction works - Drainage culverts

Drainage works will continue within the construction work area to complete the works, with A66 maintained on the new section of road.

Construction works - Overbridge

The Overbridge has been designed with sufficient working widths to enable the construction of the abutment whilst A66 traffic is maintained.

Traffic management will be required to complete the deck with disruption being minimised.

Construction works - Retaining wall

The retaining wall is essential to enable the widening new A66 carriageway to be constructed. The wall has a small footprint and helps minimise the impacts on the surrounding landscape. Upon completion the new A66 carriageway will be constructed away from the live A66.

Legend

Roads open & in public use

Construction Work Area Phase 1

Construction Work Area Phase 2

Important - Some features shown on this drawing may be different from those shown in the Maps Books. The purpose of the drawings highlight elements of the construction works and where discrepancies with the Map Books exist, the Map Book versions should be regarded as showing the preliminary design.

RESIDUAL DESIGN HAZARDS

(The following information has been collected from Preconstruction Information and the Arney Arup DJV CDM Hazard Management Process.)

- Overhead Services.
- Underground Services.

NOTES

- All levels are in metres above Ordnance Datum.
- All dimensions are in metres unless otherwise stated.
- This drawing is to be read in conjunction with all other relevant drawings.

- ### KEY
- Red line boundary
 - Existing layout
 - Existing watercourse
 - Proposed layout
 - Highway structure
 - Culvert
 - Cut-off drain
 - Surface water channel
 - Dry stone wall
 - Noise barrier
 - Proposed boundary treatment
 - Proposed gate
 - Traffic sign
 - Technology site
 - Proposed vehicle restraint system
 - Headwall
 - Pipe to Outfall
 - Earthworks
 - Pond
 - Proposed Shared Cycle Footway
 - Abandoned Shared Cycle Footway
 - Existing Shared Cycle Footway
 - Farm Track/Access
 - Designated Walkers, Cyclists and Horse Riders Route
 - Maintenance Lay-by
 - Compound/Storage Area
 - Demolished buildings
 - Flood Compensation Area
 - Proposed Environmental Mitigation

THIS DRAWING IS TO BE READ IN CONJUNCTION WITH THE ASSOCIATED SCHEME TECHNICAL NOTE, HE565627-AMY-HGN-S02-TN-CH-000003

Revision	Created	Checked	Reviewed	Approved	Authorised
dd/mm/yy	dd/mm/yy	dd/mm/yy	dd/mm/yy	dd/mm/yy	dd/mm/yy
P01	FBLA 17/02/21	FBLA 17/02/21	ASCR 17/02/21	DKID 17/02/21	---
P02	Freeze D+ FBLA 20/05/21	FBLA 20/05/21	ASCR 20/05/21	DKID 20/05/21	SBAG 20/05/21

Designer
Amey OW Limited
Chancery Exchange
10 Furnival Street
London, EC4A 1AB

A66 NTP Integrated Project Team

Client
3 Piccadilly Place
Manchester
M1 3BN

highways england

Project Name
A66 Northern Trans-Pennine

Drawing Title
**Center Parcs
General Arrangement
Sheet 1 of 6**

Project Ref. No. Stage Scale: 1:1000 @ A0
--- PCF3 Dimensions: M

Drawing Number
Project Originator Volume
HE565627 - AMY - HGN - S03 -DR-CH-200001
Location | Type | Role | Number

Suitability Suitability Description Revision
S1 Fit for Co-ordination P02

A66 - Key Proposed Construction Activities (Phase 2 Works)

Important - Some features shown on this drawing may be different from those shown in the Maps Books. The purpose of the drawings highlight elements of the construction works and where discrepancies with the Map Books exist, the Map Book versions should be regarded as showing the preliminary design.

RESIDUAL DESIGN HAZARDS
 (The following information has been collected from Preconstruction Information and the Arney Arup DJV CDM Hazard Management Process.)

- Overhead Services.
- Underground Services.

NOTES

- All levels are in metres above Ordnance Datum.
- All dimensions are in metres unless otherwise stated.
- This drawing is to be read in conjunction with all other relevant drawings.

KEY

- Red line boundary
- Existing layout
- Existing watercourse
- Proposed layout
- Highway structure
- Culvert
- Cut-off drain
- Surface water channel
- Dry stone wall
- Noise barrier
- Proposed boundary treatment
- Proposed gate
- Traffic sign
- Technology site
- Proposed vehicle restraint system
- Headwall
- Pipe to Outfall
- Earthworks
- Pond
- Proposed Byway Open to All Traffic (BOAT)
- Abandoned Byway Open to All Traffic (BOAT)
- Existing Byway Open to All Traffic (BOAT)
- Proposed Footway/Footpath
- Abandoned Footway/Footpath
- Existing Footway/Footpath
- Proposed Cycleway
- Abandoned Cycleway
- Existing Cycleway
- Proposed Shared Cycle Footway
- Abandoned Shared Cycle Footway
- Existing Shared Cycle Footway
- Farm Track/Access
- Designated Walkers, Cyclists and Horse Riders Route
- Maintenance Lay-by
- Compound/Storage Area
- Demolished buildings
- Flood Compensation Area
- Proposed Environmental Mitigation

THIS DRAWING IS TO BE READ IN CONJUNCTION WITH THE ASSOCIATED SCHEME TECHNICAL NOTE, HE565627-AMY-HGN-S02-TN-CH-000003

Revision	Created	Checked	Reviewed	Approved	Authorised
dd/mm/yy	dd/mm/yy	dd/mm/yy	dd/mm/yy	dd/mm/yy	dd/mm/yy
P01	FBLA 17/02/21	FBLA 17/02/21	ASCR 17/02/21	DKID 17/02/21	---
P02	FBLA 20/05/21	FBLA 20/05/21	ASCR 20/05/21	DKID 20/05/21	SBAG 20/05/21

Designer
 Arney OW Limited
 Chancery Exchange
 10 Furnival Street
 London, EC4A 1AB

A66 NTP Integrated Project Team

Client
 3 Piccadilly Place
 Manchester
 M1 3BN

highways england

Project Name
A66 Northern Trans-Pennine

Drawing Title
**Center Parcs
 General Arrangement
 Sheet 2 of 6**

Project Ref. No. Stage Scale: 1:1000 @ A0
 --- PCF3 Dimensions: M

Drawing Number
 Project HE565627 - Originator - AMY - HGN - S03 -DR-CH-200002
 Location | Type | Role | Number

Suitability S1 Fit for Co-ordination Revision P02

Construction works - Local access road

Access for properties will be maintained with the exception of planned closures to isolated sections of the road to undertaken online road improvements.

Construction of new carriageway

With traffic diverted onto part of the new A66 dual carriageway, the remain new carriageway will be constructed by excavating the road to formation, installing kerbs and drainage followed by the compaction in layers of aggregate and asphalt material to complete the road.

Construction works - Observation point

With traffic diverted onto the new carriageway, upgrading works can take place on the old A66 ready for the new westbound dual carriageway. Works can also be undertaken on the observation platform, with material being excavated out read for road construction materials to be installed.

Legend

- Roads open & in public use
- Construction Work Area Phase 1
- Construction Work Area Phase 2

A66 - Key Proposed Construction Activities (Phase 2 Works)

Important - Some features shown on this drawing may be different from those shown in the Maps Books. The purpose of the drawings highlight elements of the construction works and where discrepancies with the Map Books exist, the Map Book versions should be regarded as showing the preliminary design.

RESIDUAL DESIGN HAZARDS
 (The following information has been collected from Preconstruction Information and the Arney Arup DJV CDM Hazard Management Process.)
 1. Overhead Services.
 2. Underground Services.

NOTES
 1. All levels are in metres above Ordnance Datum.
 2. All dimensions are in metres unless otherwise stated.
 3. This drawing is to be read in conjunction with all other relevant drawings.

- KEY**
- Red line boundary
 - Existing layout
 - Existing watercourse
 - Proposed layout
 - Highway structure
 - Culvert
 - Cut-off drain
 - Surface water channel
 - Dry stone wall
 - Noise barrier
 - Proposed boundary treatment
 - Proposed gate
 - Traffic sign
 - Technology site
 - Proposed vehicle restraint system
 - Headwall
 - Pipe to Outfall
 - Earthworks
 - Pond
 - Proposed Byway Open to All Traffic (BOAT)
 - Abandoned Byway Open to All Traffic (BOAT)
 - Existing Byway Open to All Traffic (BOAT)
 - Proposed Footway/Footpath
 - Abandoned Footway/Footpath
 - Existing Footway/Footpath
 - Proposed Cycleway
 - Abandoned Cycleway
 - Existing Cycleway
 - Proposed Shared Cycle Footway
 - Abandoned Shared Cycle Footway
 - Existing Shared Cycle Footway
 - Farm Track/Access
 - Designated Walkers, Cyclists and Horse Riders Route
 - Maintenance Lay-by
 - Compound/Storage Area
 - Demolished buildings
 - Flood Compensation Area
 - Proposed Environmental Mitigation

Construction of new carriageway

With traffic diverted onto part of the new A66 dual carriageway, the remain new carriageway will be constructed by excavating the road to formation, installing kerbs and drainage followed by the compaction in layers of aggregate and asphalt material to complete the road.

Construction works - Drainage culverts

Drainage works will continue within the construction work area to complete the works, with A66 maintained on the new section of A66 dual carriageway.

Construction works - Underpass Construction

To reduce farm traffic movements across the A66, an underpass is to be completed. This will be excavated into the ground with temporary works required to keep the A66 traffic live whilst ensuring future traffic management is restricted to keep the road moving. The structure will be constructed below ground and then buried to ensure it blends into the surroundings.

Construction works - Local Access

Access for properties will be maintained with the exception of planned closures to isolated sections of the road to undertaken online road improvements. It may be necessary to impose one way traffic restrictions or even a number of night closures on local access road connection points to complete the road in a timely manner.

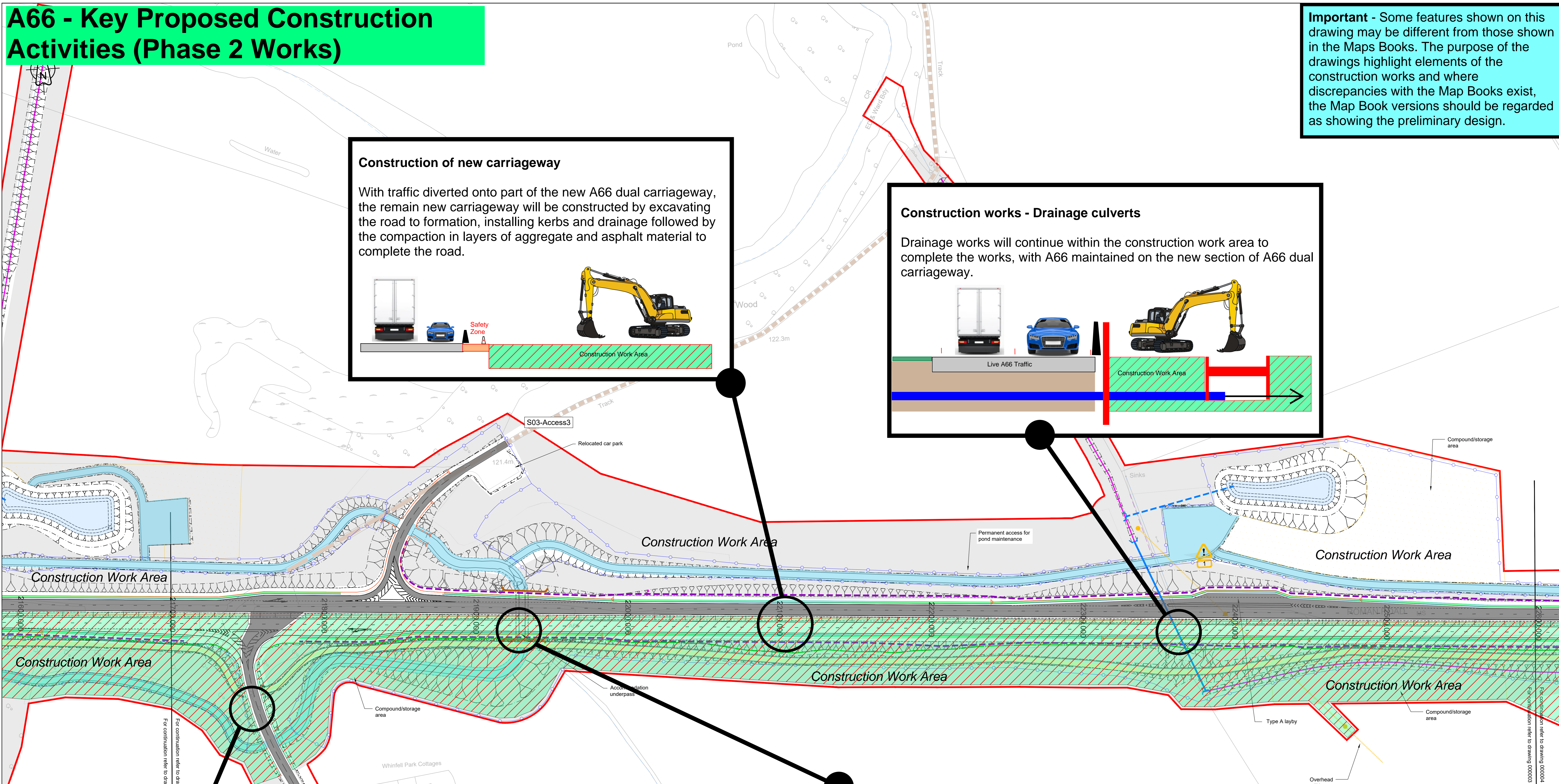

THIS DRAWING IS TO BE READ IN CONJUNCTION WITH THE ASSOCIATED SCHEME TECHNICAL NOTE, HE565627-AMY-HGN-S02-TN-CH-000003

---	---	---	---	---	---
P01	FBLA 17/02/21	FBLA 17/02/21	ASCR 17/02/21	DKID 17/02/21	---
P02	FBLA 20/05/21	FBLA 20/05/21	ASCR 20/05/21	DKID 20/05/21	SBAG 20/05/21
Revision	Created dd/mm/yy	Checked dd/mm/yy	Reviewed dd/mm/yy	Approved dd/mm/yy	Authorised dd/mm/yy

Designer
 Amey OW Limited
 Chancery Exchange
 10 Fumival Street
 London, EC4A 1AB

A66 NTP Integrated Project Team

Client
 3 Piccadilly Place
 Manchester
 M1 3BN

highways england

Project Name
A66 Northern Trans-Pennine

Drawing Title
**Center Parcs
 General Arrangement
 Sheet 3 of 6**

Project Ref. No.	Stage	Scale	@ A0
---	PCF3	1:1000	M

Drawing Number	Project	Originator	Volume
HE565627 - AMY - HGN - S03	HE565627 - AMY - HGN - S03	DR-CH	200003
Location	Type	Role	Number

Suitability	Suitability Description	Revision
S1	Fit for Co-ordination	P02

Legend

Roads open & in public use

Construction Work Area Phase 1

Construction Work Area Phase 2

A66 - Key Proposed Construction Activities (Phase 2 Works)

Construction works - New diversion route

With traffic diverted onto the new section of the A66, the remaining tie in sections of the new westbound A66 carriageway can be undertaken along with resurfacing and upgrade works. These works will be undertaken during day time works, with potential for some night time additional traffic management or closures.

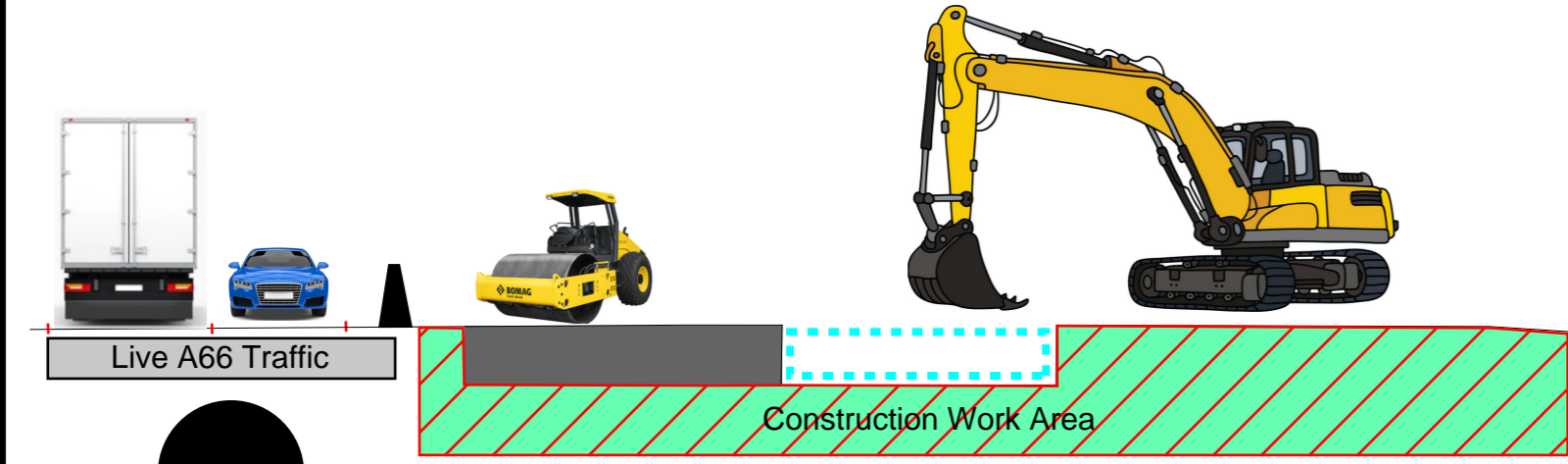

Construction works - New access road

With the new junction complete, the old access point off the A66 will be removed, with full access provided to local stakeholders via the new upgraded A66 road with underpass.



Construction works - Center Parcs access

Access for Center Parcs will be maintained at all times. As works take place to realign the approach roads, traffic management will be required to maintain traffic flow. With some works taking place on the live carriageway, it may be necessary to impose one way traffic restriction to complete the road in a timely manner, which will minimise disruption to road users.

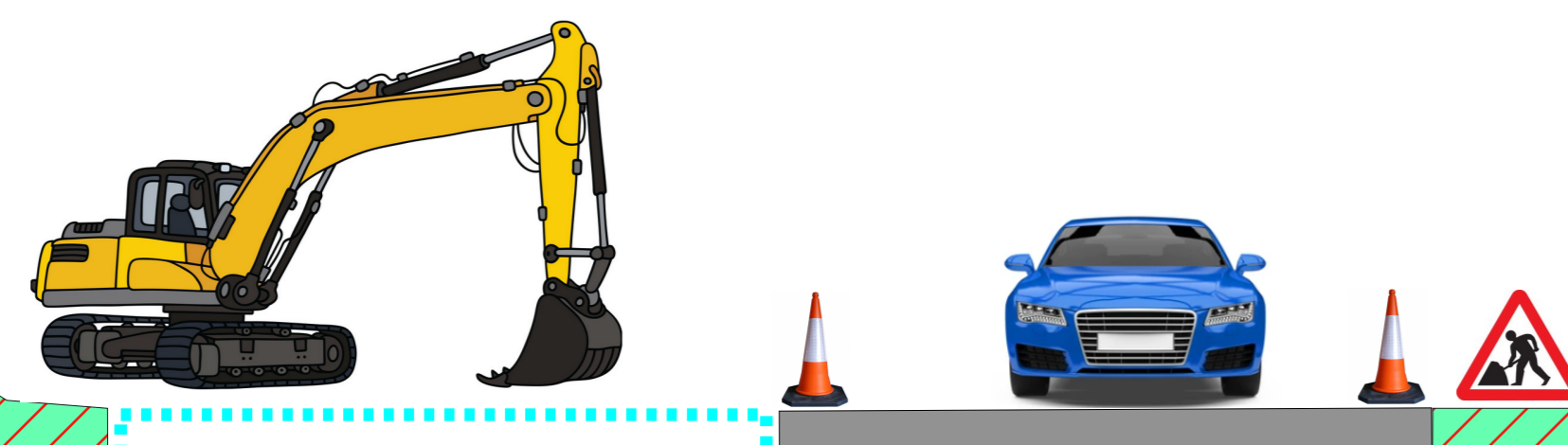

Important - Some features shown on this drawing may be different from those shown in the Maps Books. The purpose of the drawings highlight elements of the construction works and where discrepancies with the Map Books exist, the Map Book versions should be regarded as showing the preliminary design.

RESIDUAL DESIGN HAZARDS

(The following information has been collected from Preconstruction Information and the Arney Arup DJV CDM Hazard Management Process.)

- Overhead Services.
- Underground Services.

NOTES

- All levels are in metres above Ordnance Datum.
- All dimensions are in metres unless otherwise stated.
- This drawing is to be read in conjunction with all other relevant drawings.

KEY

- Red line boundary
- Existing layout
- Existing watercourse
- Proposed layout
- Highway structure
- Culvert
- Cut-off drain
- Surface water channel
- Dry stone wall
- Noise barrier
- Proposed boundary treatment
- Proposed gate
- Traffic sign
- Technology site
- Proposed vehicle restraint system
- Headwall
- Pipe to Outfall
- Earthworks
- Pond
- Proposed Byway Open to All Traffic (BOAT)
- Abandoned Byway Open to All Traffic (BOAT)
- Existing Byway Open to All Traffic (BOAT)
- Proposed Footway/Footpath
- Abandoned Footway/Footpath
- Existing Footway/Footpath
- Proposed Cycleway
- Abandoned Cycleway
- Existing Cycleway
- Proposed Shared Cycle Footway
- Abandoned Shared Cycle Footway
- Existing Shared Cycle Footway
- Farm Track/Access
- Designated Walkers, Cyclists and Horse Riders Route
- Maintenance Lay-by
- Compound/Storage Area
- Demolished buildings
- Flood Compensation Area
- Proposed Environmental Mitigation

THIS DRAWING IS TO BE READ IN CONJUNCTION WITH THE ASSOCIATED SCHEME TECHNICAL NOTE, HE565627-AMY-HGN-S02-TN-CH-000003

---	---	---	---	---	---
P01	FBLA 17/02/21	FBLA 17/02/21	ASCR 17/02/21	DKID 17/02/21	---
P02	FBLA 20/05/21	FBLA 20/05/21	ASCR 20/05/21	DKID 20/05/21	SBAQ 20/05/21

Revision	Created	Checked	Reviewed	Approved	Authorised
	dd/mm/yy	dd/mm/yy	dd/mm/yy	dd/mm/yy	dd/mm/yy

Designer
Arney OW Limited
Chancery Exchange
10 Furnival Street
London, EC4A 1AB

A66 NTP Integrated Project Team

Client
3 Piccadilly Place
Manchester
M1 3BN

highways england

Project Name
A66 Northern Trans-Pennine

Drawing Title
**Center Parcs
General Arrangement
Sheet 4 of 6**

Project Ref. No.	Stage	Scale	@ A0
---	PCF3	1:1000	Dimensions: M

Drawing Number	Project	Originator	Volume
	HE565627 - AMY	AMY	HGN
	S03	-DR-CH-	200004
	Location	Type	Role

Suitability	Suitability Description	Revision
S1	Fit for Co-ordination	P02

Legend

Roads open & in public use

Construction Work Area Phase 1

Construction Work Area Phase 2

A66 - Key Proposed Construction Activities (Phase 2 Works)

Important - Some features shown on this drawing may be different from those shown in the Maps Books. The purpose of the drawings highlight elements of the construction works and where discrepancies with the Map Books exist, the Map Book versions should be regarded as showing the preliminary design.

RESIDUAL DESIGN HAZARDS
 (The following information has been collected from Preconstruction Information and the Arney Arup DJV CDM Hazard Management Process.)
 1. Overhead Services.
 2. Underground Services.

NOTES
 All levels are in metres above Ordnance Datum.
 All dimensions are in metres unless otherwise stated.
 This drawing is to be read in conjunction with all other relevant drawings.

- KEY**
- Red line boundary
 - Existing layout
 - Existing watercourse
 - Proposed layout
 - Highway structure
 - Culvert
 - Cut-off drain
 - Surface water channel
 - Dry stone wall
 - Noise barrier
 - Proposed boundary treatment
 - Proposed gate
 - Traffic sign
 - Technology site
 - Proposed vehicle restraint system
 - Headwall
 - Pipe to Outfall
 - Earthworks
 - Pond
 - Proposed Byway Open to All Traffic (BOAT)
 - Abandoned Byway Open to All Traffic (BOAT)
 - Existing Byway Open to All Traffic (BOAT)
 - Proposed Footway/Footpath
 - Abandoned Footway/Footpath
 - Existing Footway/Footpath
 - Proposed Cycleway
 - Abandoned Cycleway
 - Existing Cycleway
 - Proposed Shared Cycle Footway
 - Abandoned Shared Cycle Footway
 - Existing Shared Cycle Footway
 - Farm Track/Access
 - Designated Walkers, Cyclists and Horse Riders Route
 - Maintenance Lay-by
 - Compound/Storage Area
 - Demolished buildings
 - Flood Compensation Area
 - Proposed Environmental Mitigation

Legend

Roads open & in public use

Construction Work Area Phase 1

Construction Work Area Phase 2

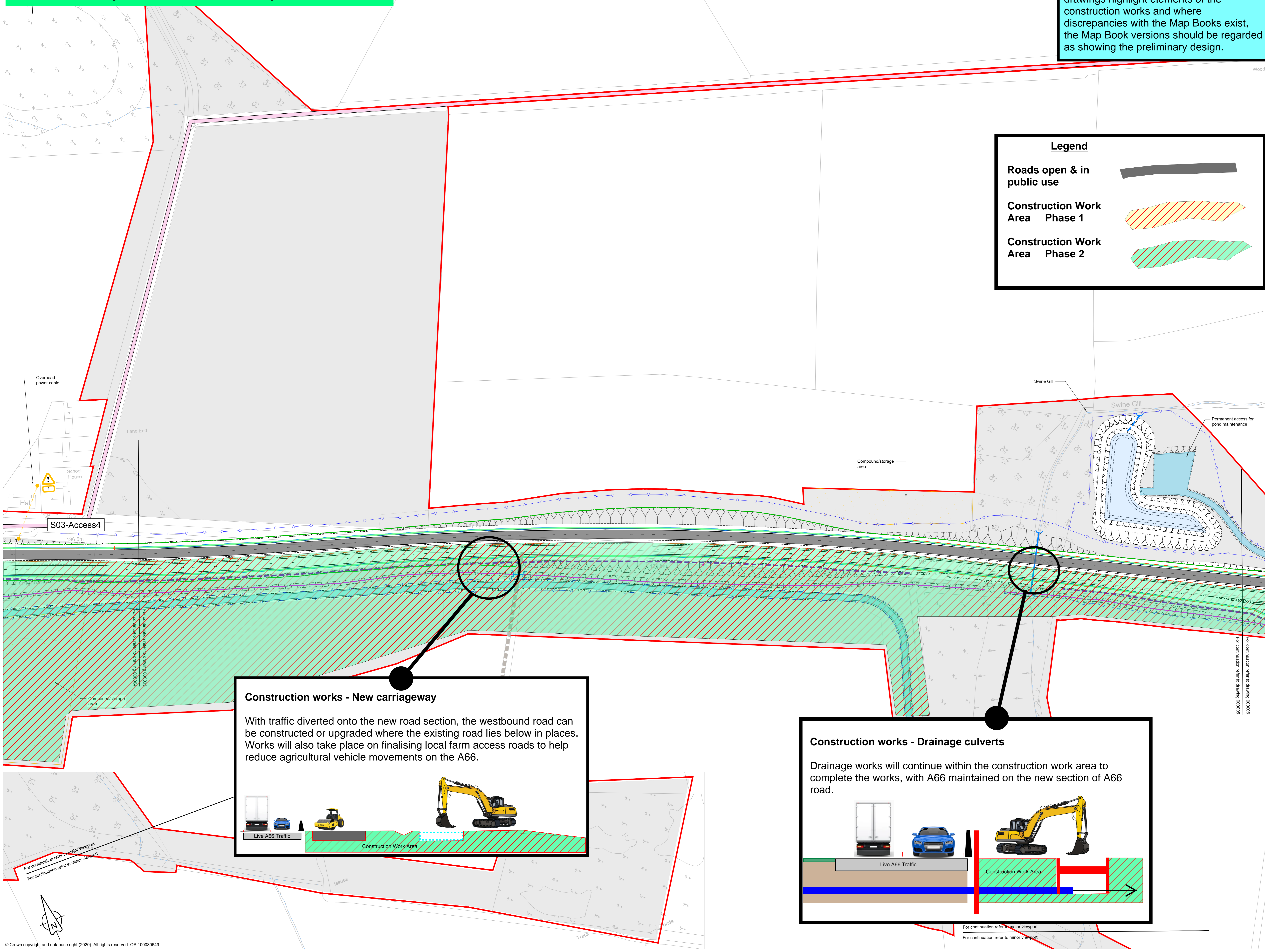

Construction works - New carriageway

With traffic diverted onto the new road section, the westbound road can be constructed or upgraded where the existing road lies below in places. Works will also take place on finalising local farm access roads to help reduce agricultural vehicle movements on the A66.

Construction works - Drainage culverts

Drainage works will continue within the construction work area to complete the works, with A66 maintained on the new section of A66 road.

THIS DRAWING IS TO BE READ IN CONJUNCTION WITH THE ASSOCIATED SCHEME TECHNICAL NOTE, HE565627-AMY-HGN-S02-TN-CH-000003

---	---	---	---	---	---
P01	FBLA 17/02/21	FBLA 17/02/21	ASCR 17/02/21	DKID 17/02/21	---
P02	FBLA 20/05/21	FBLA 20/05/21	ASCR 20/05/21	DKID 20/05/21	SBAG 20/05/21
Revision	Created dd/mm/yy	Checked dd/mm/yy	Reviewed dd/mm/yy	Approved dd/mm/yy	Authorised dd/mm/yy

Designer
 Arney OW Limited
 Chancery Exchange
 10 Furnival Street
 London, EC4A 1AB

A66 NTP Integrated Project Team

Client
 3 Piccadilly Place
 Manchester
 M1 3BN

highways england

Project Name
A66 Northern Trans-Pennine

Drawing Title
**Center Parcs
 General Arrangement
 Sheet 5 of 6**

Project Ref. No. Stage Scale: 1:1000 @ A0
 --- PCF3 Dimensions: M

Drawing Number
 Project HE565627 - Originator VOLUME -
 S03 -DR-CH-200005
 Location | Type | Role | Number

Suitability S1 Suitability Description Fit for Co-ordination Revision P02

A66 - Key Proposed Construction Activities (Phase 2 Works)

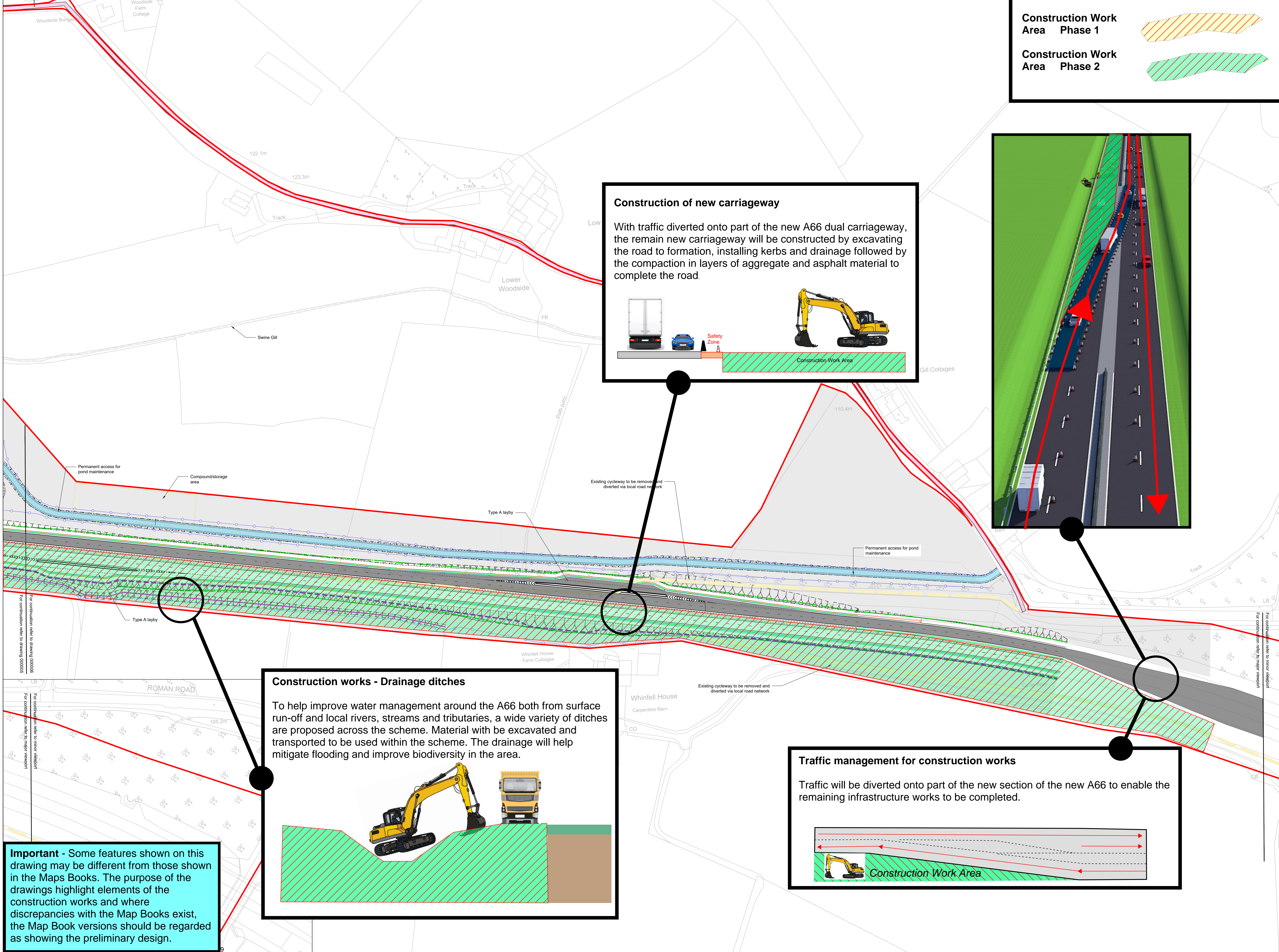

Construction of new carriageway

With traffic diverted onto part of the new A66 dual carriageway, the remain new carriageway will be constructed by excavating the road to formation, installing kerbs and drainage followed by the compaction in layers of aggregate and asphalt material to complete the road.

Construction works - Drainage ditches

To help improve water management around the A66 both from surface run-off and local rivers, streams and tributaries, a wide variety of ditches are proposed across the scheme. Material will be excavated and transported to be used within the scheme. The drainage will help mitigate flooding and improve biodiversity in the area.

Traffic management for construction works

Traffic will be diverted onto part of the new section of the new A66 to enable the remaining infrastructure works to be completed.

Important - Some features shown on this drawing may be different from those shown in the Maps Books. The purpose of the drawings highlight elements of the construction works and where discrepancies with the Map Books exist, the Map Book versions should be regarded as showing the preliminary design.

Legend

Roads open & in public use

Construction Work Area Phase 1

Construction Work Area Phase 2

RESIDUAL DESIGN HAZARDS

(The following information has been collected from Preconstruction Information and the Arney Arup DJV CDM Hazard Management Process.)

- Overhead Services.
- Underground Services.

NOTES

- All levels are in metres above Ordnance Datum.
- All dimensions are in metres unless otherwise stated.
- This drawing is to be read in conjunction with all other relevant drawings.

KEY

- Red line boundary
- Existing layout
- Existing watercourse
- Proposed layout
- Highway structure
- Culvert
- Cut-off drain
- Surface water channel
- Dry stone wall
- Noise barrier
- Proposed boundary treatment
- Proposed gate
- Traffic sign
- Technology site
- Proposed vehicle restraint system
- Headwall
- Pipe to Outfall
- Earthworks
- Pond
- Proposed Byway Open to All Traffic (BOAT)
- Abandoned Byway Open to All Traffic (BOAT)
- Existing Byway Open to All Traffic (BOAT)
- Proposed Footway/Footpath
- Abandoned Footway/Footpath
- Existing Footway/Footpath
- Proposed Cycleway
- Abandoned Cycleway
- Existing Cycleway
- Proposed Shared Cycle Footway
- Abandoned Shared Cycle Footway
- Existing Shared Cycle Footway
- Farm Track/Access
- Designated Walkers, Cyclists and Horse Riders Route
- Maintenance Lay-by
- Compound/Storage Area
- Demolished buildings
- Flood Compensation Area
- Proposed Environmental Mitigation

THIS DRAWING IS TO BE READ IN CONJUNCTION WITH THE ASSOCIATED SCHEME TECHNICAL NOTE, HE565627-AMY-HGN-S02-TN-CH-000003

Revision	Created	Checked	Reviewed	Approved	Authorised
dd/mm/yy	dd/mm/yy	dd/mm/yy	dd/mm/yy	dd/mm/yy	dd/mm/yy
P01	FBLA 17/02/21	FBLA 17/02/21	ASCR 17/02/21	DKID 17/02/21	---
P02	FBLA 20/05/21	FBLA 20/05/21	ASCR 20/05/21	DKID 20/05/21	SBAG 20/05/21

Designer
Amey OW Limited
Chancery Exchange
10 Furnival Street
London, EC4A 1AB

A66 NTP Integrated Project Team

Client
3 Piccadilly Place
Manchester
M1 3BN

highways england

Project Name
A66 Northern Trans-Pennine

Drawing Title
Center Parcs
General Arrangement
Sheet 6 of 6

Project Ref. No. Stage Scale: 1:1000 @ A0
--- PCF3 Dimensions: M

Drawing Number
Project HE565627 - AMY - HGN - S03
Originator | Volume | Location | Type | Role | Number

Suitability S1 Fit for Co-ordination P02