

# A66 Northern Trans-Pennine project

Draft Construction  
Method and  
Management  
Statement

**Indicative  
schematic drawings**

**Volume 2**

**M6 Junction 40 to  
Kemplay Bank**



# A66 - Key Proposed Construction Activities (Phase 1 Works)

**Important** - Some features shown on this drawing may be different from those shown in the Maps Books. The purpose of the drawings highlight elements of the construction works and where discrepancies with the Map Books exist, the Map Book versions should be regarded as showing the preliminary design.

**RESIDUAL DESIGN HAZARDS**  
 (The following information has been collected from Preconstruction Information and the Arney Arup DJV CDM Hazard Management Process.)

- Overhead Services.
- Underground Services.

**NOTES**

- All levels are in metres above Ordnance Datum.
- All dimensions are in metres unless otherwise stated.
- This drawing is to be read in conjunction with all other relevant drawings.

- KEY**
- Red line boundary
  - Existing layout
  - Existing watercourse
  - Proposed layout
  - Highway structure
  - Culvert
  - Cut-off drain
  - Surface water channel
  - Noise barrier
  - Proposed boundary treatment
  - Proposed gate
  - Traffic sign
  - Proposed lighting column
  - Proposed traffic signal
  - Technology site
  - Proposed vehicle restraint system
  - Headwall
  - Pipe to outfall
  - Earthworks
  - Pond
  - Abandoned Footway/Footpath
  - Existing Footway/Footpath
  - Proposed Shared Cycle Footway
  - Existing Shared Cycle Footway
  - Farm Track/Access
  - Haul Road
  - Maintenance Lay-by
  - Compound/Storage Area
  - Potential Environmental Mitigation

THIS DRAWING IS TO BE READ IN CONJUNCTION WITH THE ASSOCIATED SCHEME TECHNICAL NOTE, HE565627-AMY-HGN-S02-TN-CH-000003

P01	FBLA 17/02/21	FBLA 17/02/21	ASCR 17/02/21	DKID 17/02/21	---
P02	FBLA 22/02/21	FBLA 22/02/21	ASCR 22/02/21	DKID 22/02/21	---
P03.4	---	---	---	---	---
Revision	Created dd/mm/yy	Checked dd/mm/yy	Reviewed dd/mm/yy	Approved dd/mm/yy	Authorised dd/mm/yy

Designer  
 Arney OW Limited  
 Chancery Exchange  
 10 Furnival Street  
 London, EC4A 1AB

**A66 NTP** Integrated Project Team

Client  
 3 Piccadilly Place  
 Manchester  
 M1 3BN

highways england

Project Name  
**A66 Northern Trans-Pennine**

Drawing Title  
**Kemplay Bank  
 General Arrangement  
 Sheet 1 of 2**

Project Ref. No. | Stage | Scale | @ A0  
 --- | PCF3 | 1:1000 | M

Drawing Number  
 Project | Originator | Volume |  
**HE565627 - AMY - HGN -**  
**S02 -DR-CH- 100001**  
 Location | Type | Role | Number

Suitability | Suitability Description | Revision  
 S0 | Initial non-contractual code | P03.4

## Construction works - Retaining wall construction

To facilitate the construction of the new underpass, the A66 traffic will be maintained on its existing route while piled foundations are installed where access permits. To enable the full wall to be completed, varying traffic management set ups may be required. The works will be undertaken offline with additional controls implemented where large plant is required to work close to live traffic. Additional temporary works are likely to be required to facilitate the installation of permanent works.

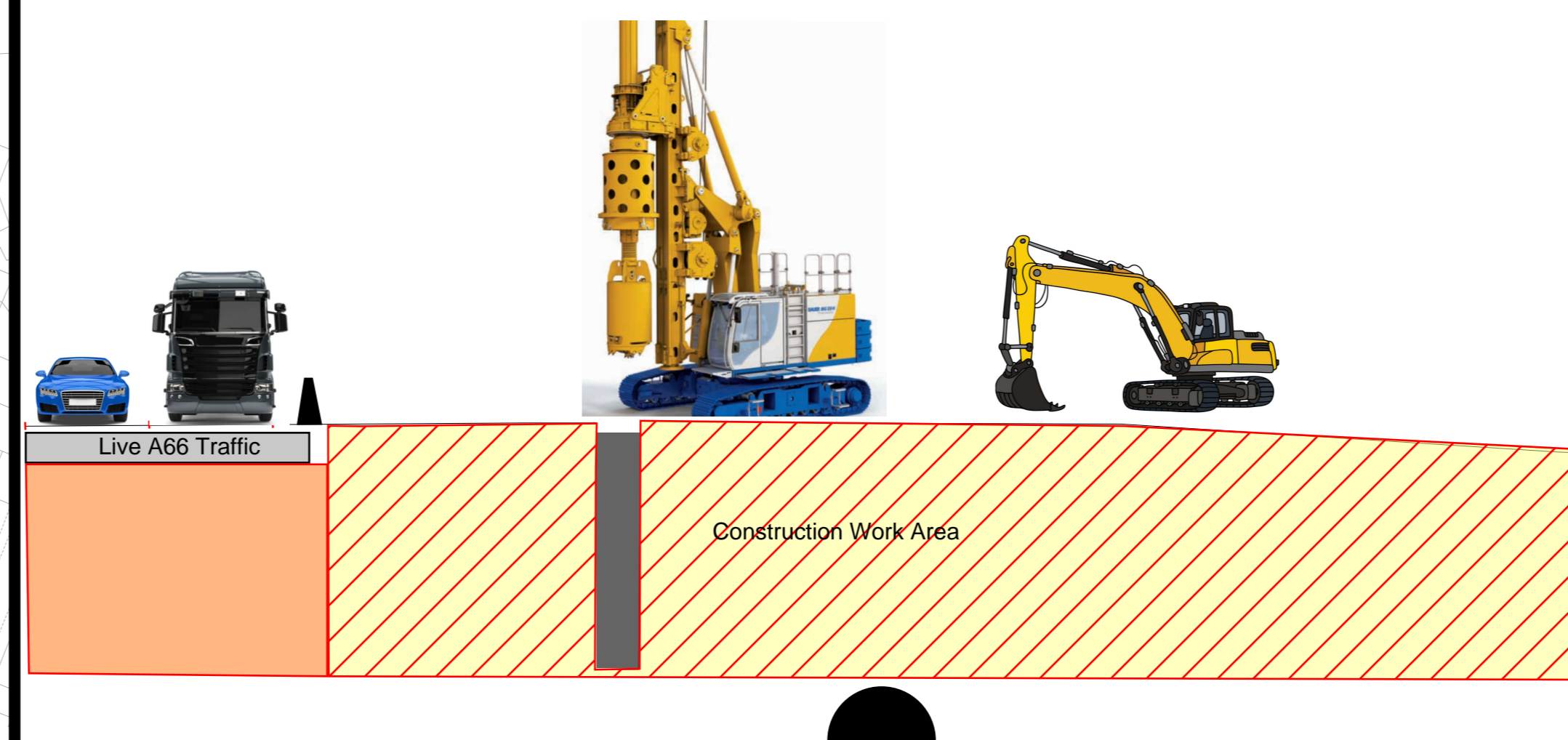

## Construction works - New Slip Road & A66 Widening Embankment Construction.

The embankment construction can be undertaken offline without impact on A66 live traffic. The embankment will be constructed from suitably selected fill materials, compacted in layers. The new slip road and A66 road widening will be constructed on the completed embankment. To finish the road, additional traffic management could be required, along with possible extended closures or night working.

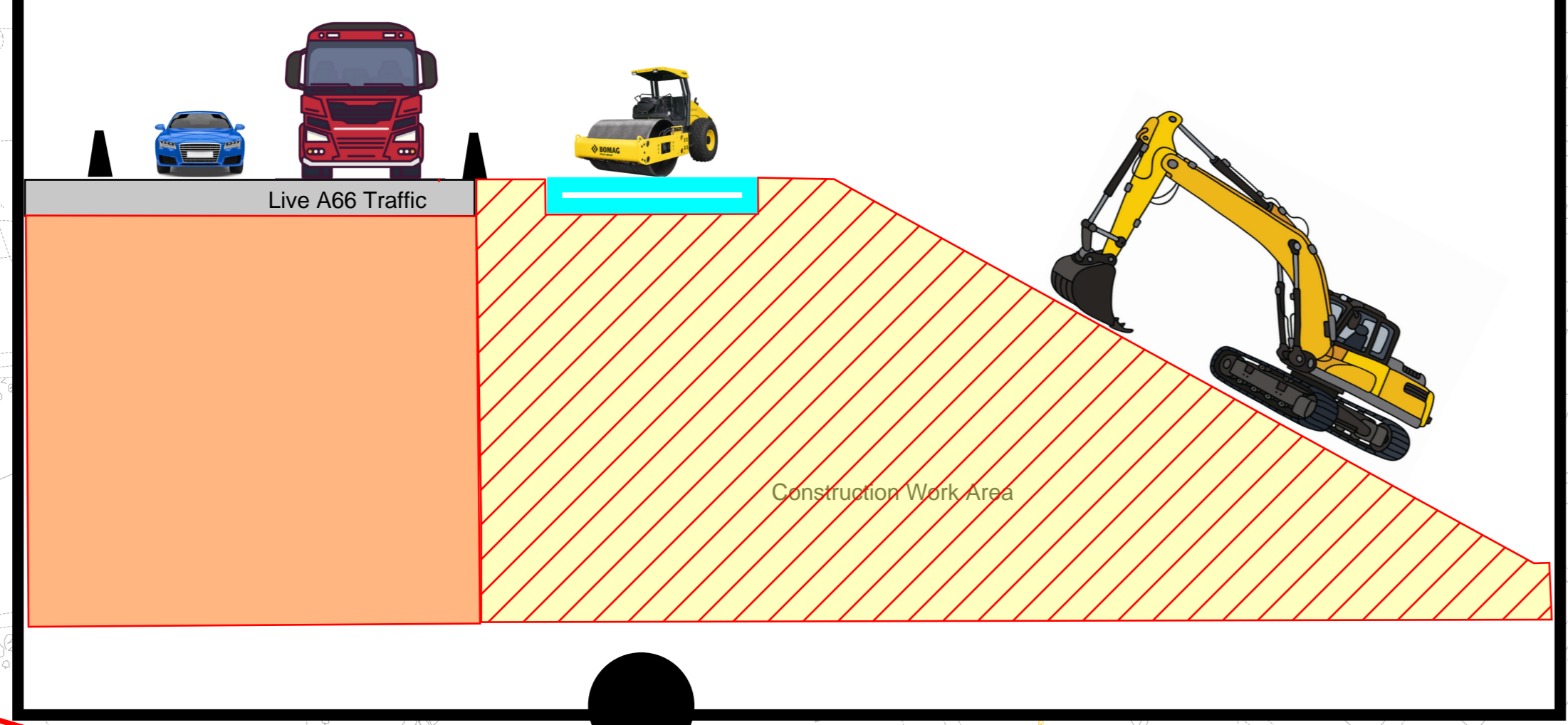

## Construction works - Attenuation pond

To help manage groundwater on the scheme and mitigate the impacts of surface run-off overloading the existing drainage network, attenuation ponds are required. They will be constructed with minimal impacts on the live A66 and will further help biodiversity within the local area. Plant machinery will be used to excavate and line the attenuation pond.

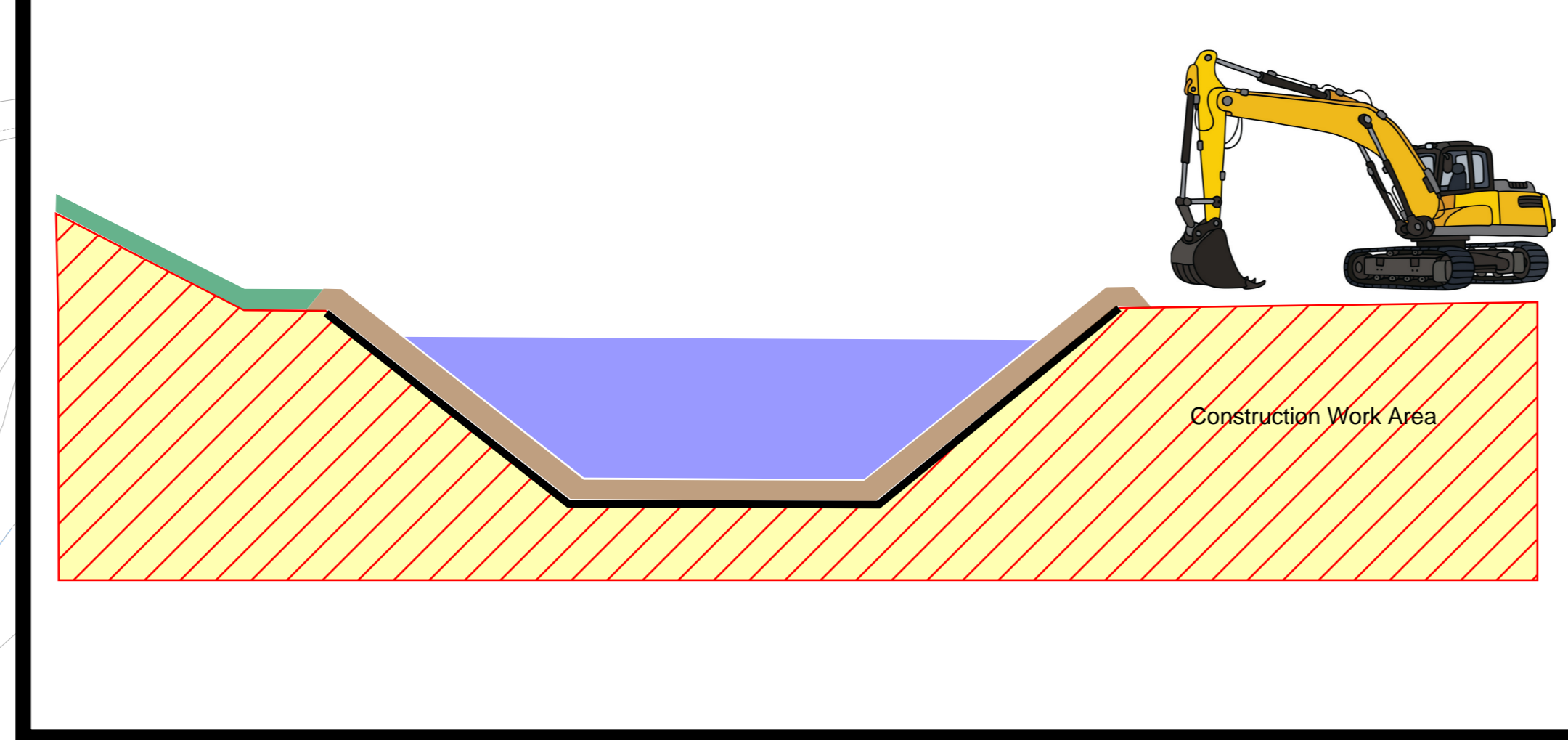

## Construction works - New Access Road to Council Compound

The access road will be constructed with little impact on the live A66 due to the setback distance from the road. Earth will be excavated along the required route and imported material placed and compacted. Traffic management will be required at connection interface points, with possible night time closures required to complete the new road access whilst minimising disruption to road users.

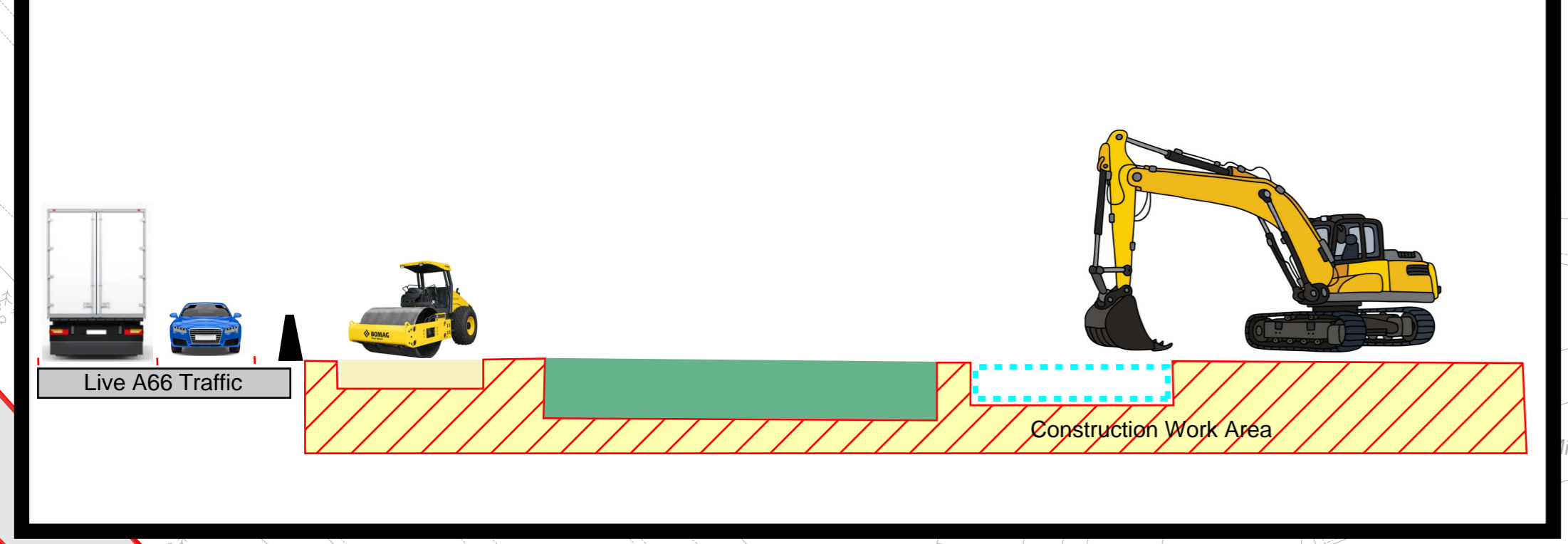

**Legend**

- Roads open & in public use
- Construction Work Area - Phase 1
- Construction Work Area - Phase 2

# A66 - Key Proposed Construction Activities (Phase 1 Works)

## Construction works - Construction of new A686

Where possible the road will be constructed offline, within the construction work area. Where tie in connections are required, traffic management will be utilised to facilitate the works. To construct the new road section earth will be excavated along the required route and imported material placed and compacted.

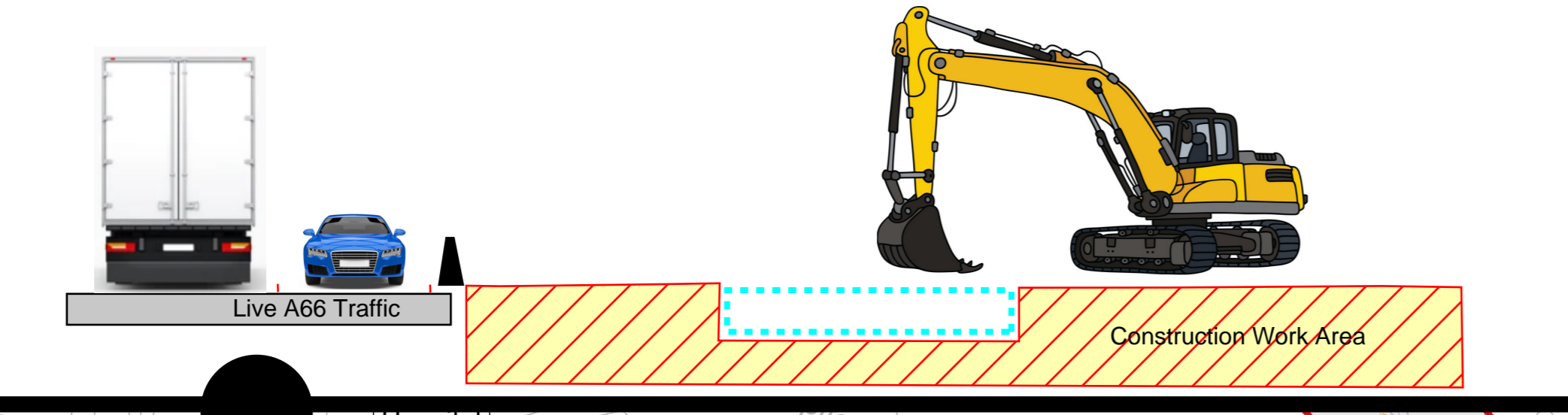

## Construction works - Extend Underpass

To enable the new dual carriageway to be constructed it will be necessary to extend the existing underpass. The underpass will be designed to allow full access to the police headquarters at all times, the new abutment walls being set back to allow unimpeded construction. It is likely that additional traffic management will be required to install the underpass roof beams.



## Construction works - Retaining wall construction

To facilitate the construction of the new dual underpass, the A66 traffic will be maintained on its existing route while piled foundations are installed where access permits. To enable the full wall to be completed, varying traffic management set ups may be required. The works will be undertaken offline with additional controls implemented where large plant is required to work close to live traffic. Additional temporary works are likely to be required to facilitate the installation of permanent works.

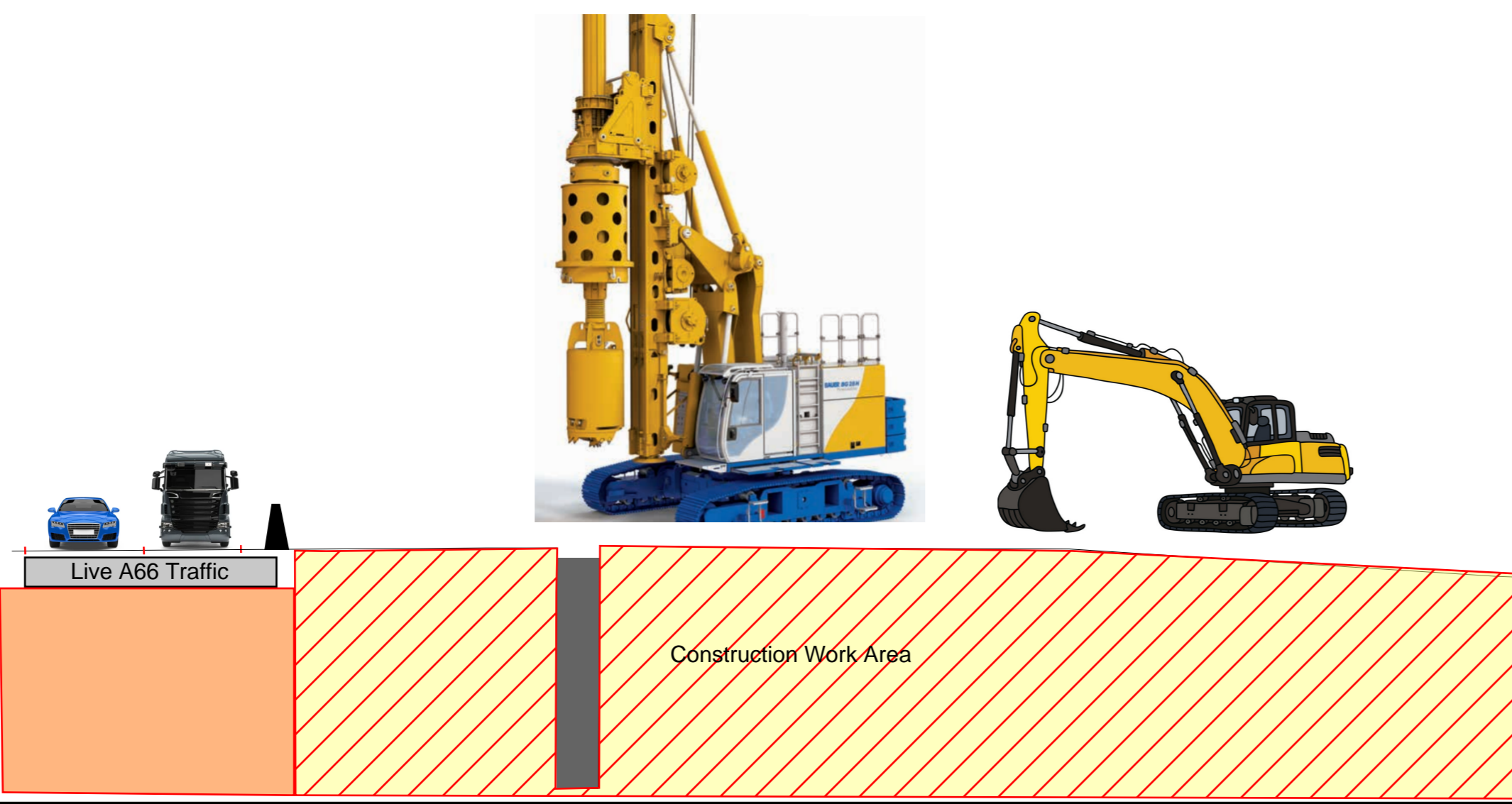

### RESIDUAL DESIGN HAZARDS

(The following information has been collected from Preconstruction Information and the Arup DJV CDM Hazard Management Process.)

1. Please enter project specific hazards here.

**NOTES**  
 1. All levels are in metres above Ordnance Datum.  
 2. All dimensions are in metres unless otherwise stated.  
 3. This drawing is to be read in conjunction with all other relevant drawings.

- KEY**
- Red line boundary
  - Existing layout
  - Existing watercourse
  - Proposed layout
  - Highway structure
  - Culvert
  - Cut-off drain
  - Surface water channel
  - Noise barrier
  - Proposed boundary treatment
  - Proposed gate
  - Traffic sign
  - Proposed lighting column
  - Proposed traffic signal
  - Technology site
  - Proposed vehicle restraint system
  - Headwall
  - Pipe to outfall
  - Earthworks
  - Pond
  - Abandoned Footway/Footpath
  - Existing Footway/Footpath
  - Proposed Shared Cycle Footway
  - Existing Shared Cycle Footway
  - Farm Track/Access
  - Haul Road
  - Maintenance Lay-by
  - Compound/Storage Area
  - Potential Environmental Mitigation

THIS DRAWING IS TO BE READ IN CONJUNCTION WITH THE ASSOCIATED SCHEME TECHNICAL NOTE, HE565627-AMY-HGN-S02-TN-CH-000003

P03	FBLA 20/05/21	FBLA 20/05/21	ASCR 20/05/21	DKID 20/05/21	SBAG 20/05/21
P04	FBLA 27/05/21	FBLA 27/05/21	ASCR 27/05/21	DKID 01/06/21	SBAG 01/06/21
P05	Design Freeze Dr 11/06/21	FBLA 11/06/21	ASCR 11/06/21	DKID 11/06/21	SBAG 11/06/21

Revision	Created	Checked	Reviewed	Approved	Authorised
	dd/mm/yy	dd/mm/yy	dd/mm/yy	dd/mm/yy	dd/mm/yy

Designer  
 Amey OW Limited  
 Chancery Exchange  
 10 Fumival Street  
 London, EC4A 1AB

Client  
 3 Piccadilly Place  
 Manchester  
 M1 3BN

Project Name  
 A66 Northern Trans-Pennine

Drawing Title  
 Kemplay Bank  
 General Arrangement  
 Sheet 2 of 2

Project Ref. No.	Stage	Scale	@ A0
---	PCF3	1:1000	M

Drawing Number	Project	Originator	Volume
HE565627 - AMY - HGN - S02	Location	Type	Role

Suitability	Suitability Description	Revision
S1	Fit for Co-ordination	P05

**Legend**

**Roads open & in public use**

**Construction Work Area Phase 1**

**Construction Work Area Phase 2**

**Important - Some features shown on this drawing may be different from those shown in the Maps Books. The purpose of the drawings highlight elements of the construction works and where discrepancies with the Map Books exist, the Map Book versions should be regarded as showing the preliminary design.**

# A66 - Key Proposed Construction Activities (Phase 2 Works)

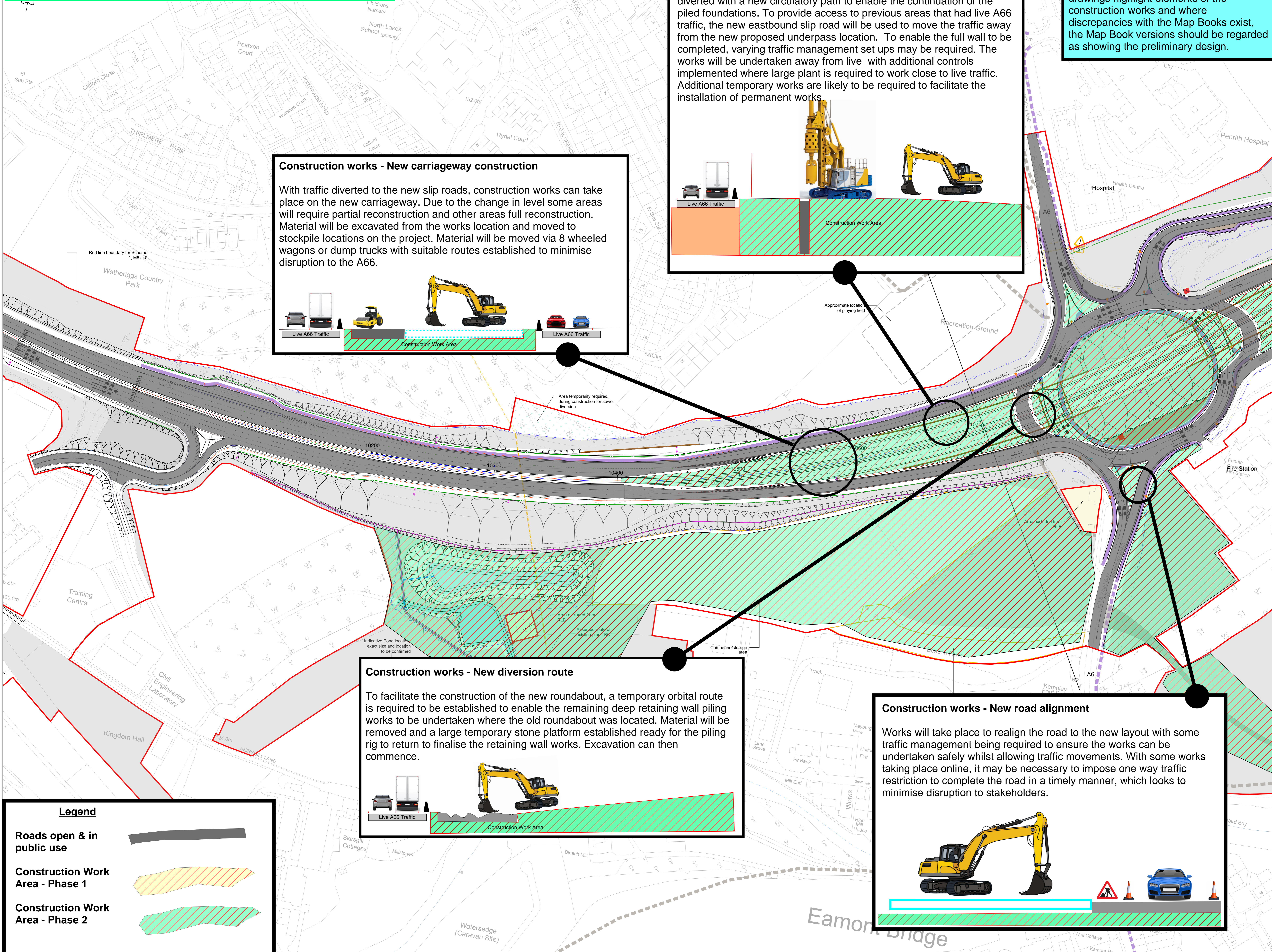

### Construction works - Retaining wall construction

To facilitate the construction of the new underpass, the A66 traffic will be diverted with a new circulatory path to enable the continuation of the piled foundations. To provide access to previous areas that had live A66 traffic, the new eastbound slip road will be used to move the traffic away from the new proposed underpass location. To enable the full wall to be completed, varying traffic management set ups may be required. The works will be undertaken away from live with additional controls implemented where large plant is required to work close to live traffic. Additional temporary works are likely to be required to facilitate the installation of permanent works.

**Important** - Some features shown on this drawing may be different from those shown in the Maps Books. The purpose of the drawings highlight elements of the construction works and where discrepancies with the Map Books exist, the Map Book versions should be regarded as showing the preliminary design.

### Construction works - New carriageway construction

With traffic diverted to the new slip roads, construction works can take place on the new carriageway. Due to the change in level some areas will require partial reconstruction and other areas full reconstruction. Material will be excavated from the works location and moved to stockpile locations on the project. Material will be moved via 8 wheeled wagons or dump trucks with suitable routes established to minimise disruption to the A66.

### Construction works - New diversion route

To facilitate the construction of the new roundabout, a temporary orbital route is required to be established to enable the remaining deep retaining wall piling works to be undertaken where the old roundabout was located. Material will be removed and a large temporary stone platform established ready for the piling rig to return to finalise the retaining wall works. Excavation can then commence.

### Construction works - New road alignment

Works will take place to realign the road to the new layout with some traffic management being required to ensure the works can be undertaken safely whilst allowing traffic movements. With some works taking place online, it may be necessary to impose one way traffic restriction to complete the road in a timely manner, which looks to minimise disruption to stakeholders.

### RESIDUAL DESIGN HAZARDS

(The following information has been collected from Preconstruction Information and the Arney Arup DJV CDM Hazard Management Process.)

- Overhead Services.
- Underground Services.

### NOTES

- All levels are in metres above Ordnance Datum.
- All dimensions are in metres unless otherwise stated.
- This drawing is to be read in conjunction with all other relevant drawings.

### KEY

- Red line boundary
- Existing layout
- Existing watercourse
- Proposed layout
- Highway structure
- Culvert
- Cut-off drain
- Surface water channel
- Noise barrier
- Proposed boundary treatment
- Proposed gate
- Traffic sign
- Proposed lighting column
- Proposed traffic signal
- Technology site
- Proposed vehicle restraint system
- Headwall
- Pipe to outfall
- Earthworks
- Pond
- Abandoned Footway/Footpath
- Existing Footway/Footpath
- Proposed Shared Cycle Footway
- Existing Shared Cycle Footway
- Farm Track/Access
- Haul Road
- Maintenance Lay-by
- Compound/Storage Area
- Potential Environmental Mitigation

THIS DRAWING IS TO BE READ IN CONJUNCTION WITH THE ASSOCIATED SCHEME TECHNICAL NOTE, HE565627-AMY-HGN-S02-TN-CH-000003

P01	FBLA	FBLA	ASCR	DKID	---
	17/02/21	17/02/21	17/02/21	17/02/21	---
P02	FBLA	FBLA	ASCR	DKID	---
	22/02/21	22/02/21	22/02/21	22/02/21	---
P03.4	---	---	---	---	---
Revision	Created	Checked	Reviewed	Approved	Authorised
	dd/mm/yy	dd/mm/yy	dd/mm/yy	dd/mm/yy	dd/mm/yy

Designer  
Amey OW Limited  
Chancery Exchange  
10 Fumival Street  
London, EC4A 1AB

**A66 NTP** Integrated Project Team

Client  
3 Piccadilly Place  
Manchester  
M1 3BN

highways england

Project Name  
A66 Northern Trans-Pennine

Drawing Title  
Kemplay Bank  
General Arrangement  
Sheet 1 of 2

Project Ref. No. | Stage | Scale | @ A0  
--- | PCF3 | 1:1000 | M

Drawing Number  
Project | Originator | Volume |  
HE565627 - AMY - HGN -  
S02 -DR-CH- 100001  
Location | Type | Role | Number

Suitability | Suitability Description | Revision  
S0 | Initial non-contractual code | P03.4

### Legend

- Roads open & in public use
- Construction Work Area - Phase 1
- Construction Work Area - Phase 2

# A66 - Key Proposed Construction Activities (Phase 2 Works)

## Construction works - New diversion route and continued underpass works

To facilitate the construction of the new underpass, the A66 traffic will be diverted with a new circulatory path to enable the continuation of the piled foundations. To provide access to previous areas that had live A66 traffic, the new eastbound slip road will be used to move the traffic away from the new proposed underpass location. To enable the full wall to be completed, varying traffic management set ups may be required. The works will be undertaken offline with additional controls implemented where large plant is required to work close to live traffic. Additional temporary works are likely to be required to facilitate the installation of permanent works.

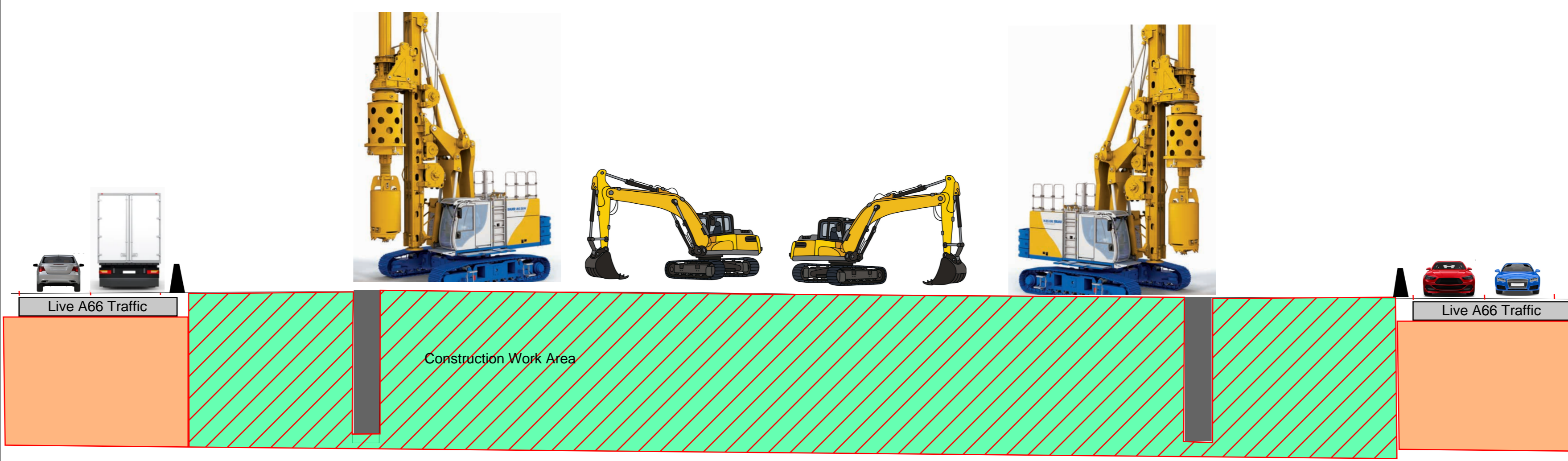

**Important** - Some features shown on this drawing may be different from those shown in the Maps Books. The purpose of the drawings highlight elements of the construction works and where discrepancies with the Map Books exist, the Map Book versions should be regarded as showing the preliminary design.

**RESIDUAL DESIGN HAZARDS**  
 (The following information has been collected from Preconstruction Information and the Amey Arup DJV CDM Hazard Management Process.)  
 1. Please enter project specific hazards here.

**NOTES**  
 1. All levels are in metres above Ordnance Datum.  
 2. All dimensions are in metres unless otherwise stated.  
 3. This drawing is to be read in conjunction with all other relevant drawings.

**KEY**

- Red line boundary
- Existing layout
- Existing watercourse
- Proposed layout
- Highway structure
- Culvert
- Cut-off drain
- Surface water channel
- Noise barrier
- Proposed boundary treatment
- Proposed gate
- Traffic sign
- Proposed lighting column
- Proposed traffic signal
- Technology site
- Proposed vehicle restraint system
- Headwall
- Pipe to Outfall
- Earthworks
- Pond
- Abandoned Footway/Footpath
- Existing Footway/Footpath
- Proposed Shared Cycle Footway
- Existing Shared Cycle Footway
- Farm Track/Access
- Haul Road
- Maintenance Lay-by
- Compound/Storage Area
- Potential Environmental Mitigation

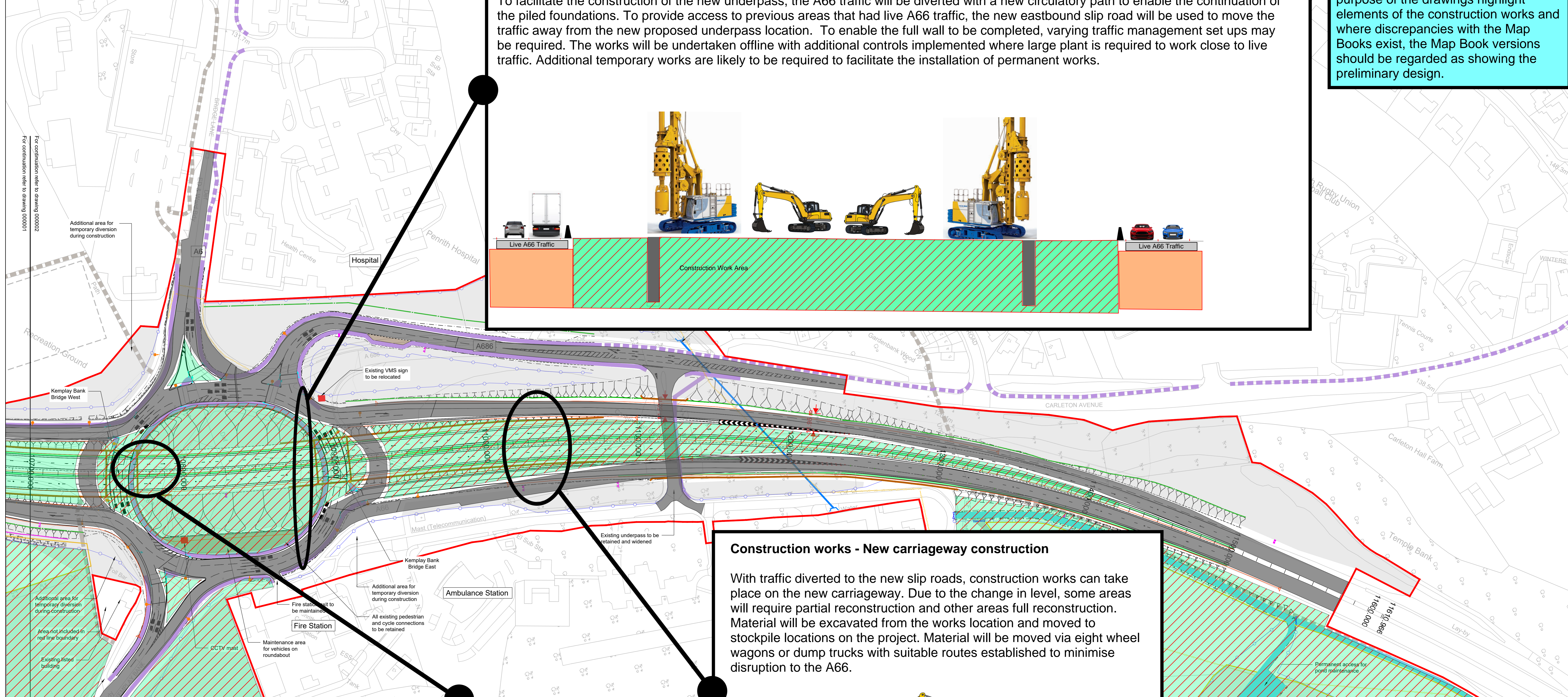

## Construction works - New carriageway construction

With traffic diverted to the new slip roads, construction works can take place on the new carriageway. Due to the change in level, some areas will require partial reconstruction and other areas full reconstruction. Material will be excavated from the works location and moved to stockpile locations on the project. Material will be moved via eight wheel wagons or dump trucks with suitable routes established to minimise disruption to the A66.

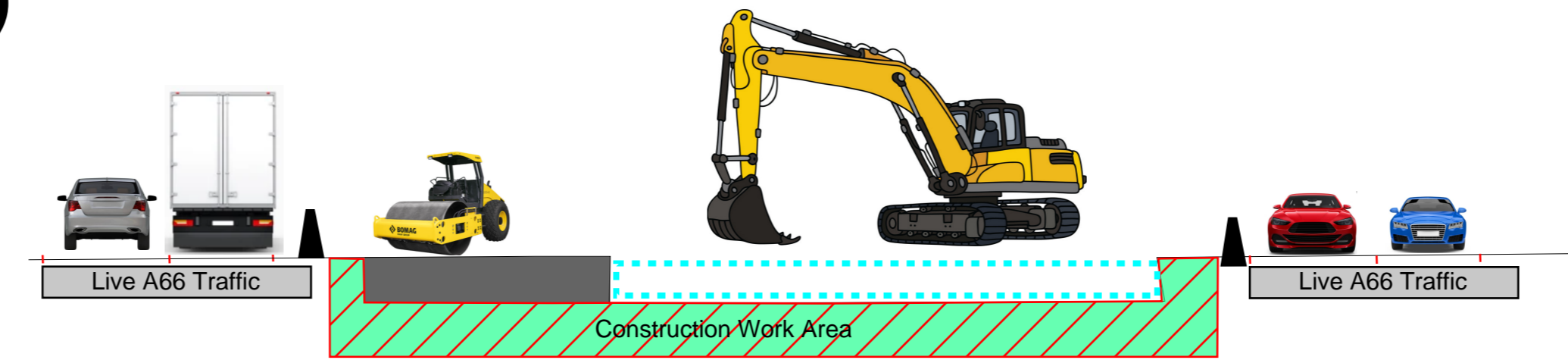

## Construction works - Underpass excavation and bridge construction

Following the completion of the permanent piling works to retain the earth on the edges of the roundabout, excavation works will commence using excavators and articulated dump trucks, subject to suitable haul routes being established. Material will be moved to fill locations at Kemplay or onto other schemes. Once progressed the abutments will be formed and the bridge beams placed on top, enabling the deck to be completed. This will then be followed by road construction works to complete the new bridge.

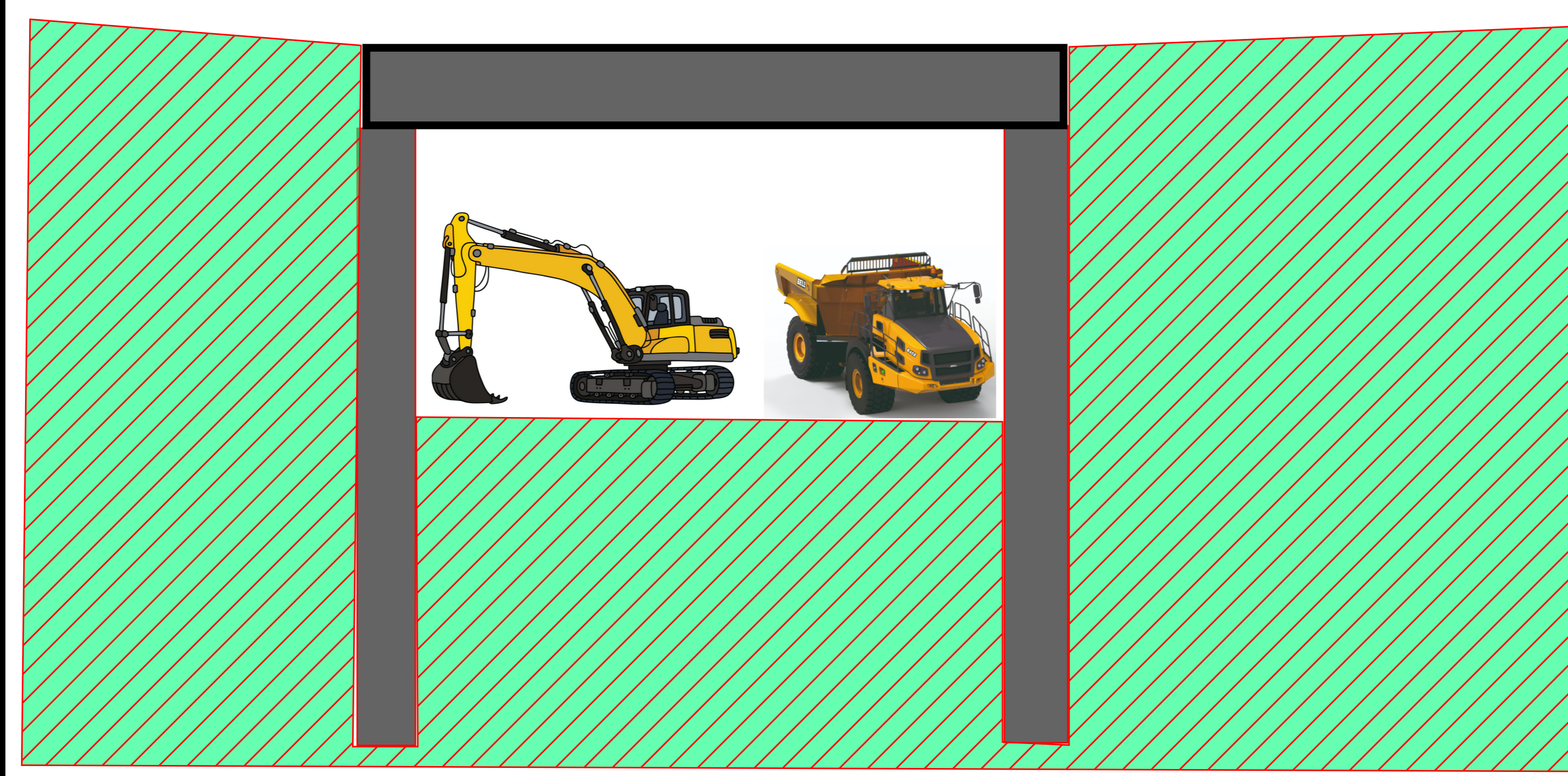

## Construction works - Attenuation pond

To help manage groundwater on the scheme and mitigate the impacts of surface run-off overloading the existing drainage network, attenuation ponds are required. They will be constructed with minimal impacts on the live A66 and will further help biodiversity within the local area. Plant machinery will be used to excavate and line the attenuation pond.

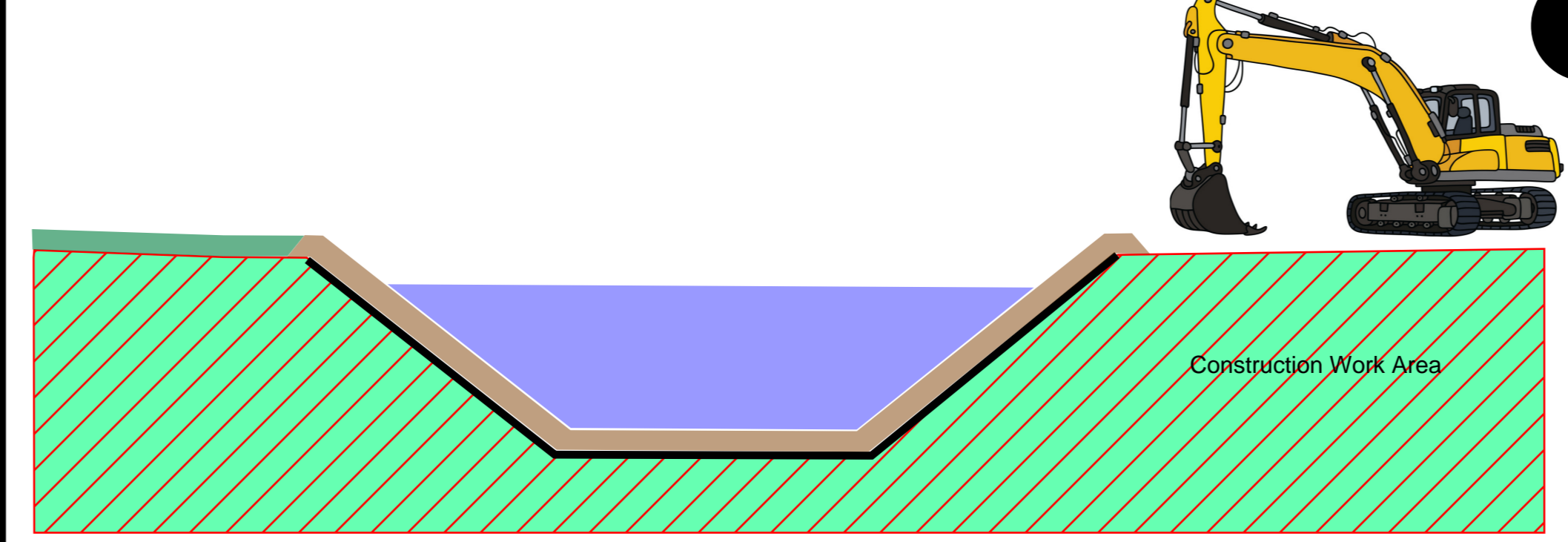

**Legend**

- Roads open & in public use
- Construction Work Area - Phase 1
- Construction Work Area - Phase 2

THIS DRAWING IS TO BE READ IN CONJUNCTION WITH THE ASSOCIATED SCHEME TECHNICAL NOTE, HE565627-AMY-HGN-S02-TN-CH-000003

P03	FBLA	FBLA	ASCR	DKID	SBAG
	20/05/21	20/05/21	20/05/21	20/05/21	20/05/21
P04	FBLA	FBLA	ASCR	DKID	SBAG
	27/05/21	27/05/21	27/05/21	01/06/21	01/06/21
P05	FBLA	FBLA	ASCR	DKID	SBAG
	11/06/21	11/06/21	11/06/21	11/06/21	11/06/21

Designer  
 Amey OW Limited  
 Chancery Exchange  
 10 Furnival Street  
 London, EC4A 1AB

**A66 NTP** Integrated Project Team

Client  
 3 Piccadilly Place  
 Manchester  
 M1 3BN

highways england

Project Name  
 A66 Northern Trans-Pennine

Drawing Title  
 Kemplay Bank  
 General Arrangement  
 Sheet 2 of 2

Project Ref. No. Stage Scale: 1:1000 @ A0  
 --- PCF3 Dimensions: M

Drawing Number  
 Project HE565627 - Originator AMY - HGN - Volume S02 - Location -DR-CH-100002

Suitability S1 Fit for Co-ordination Revision P05