

A57 Link Roads project

Public consultation
response form

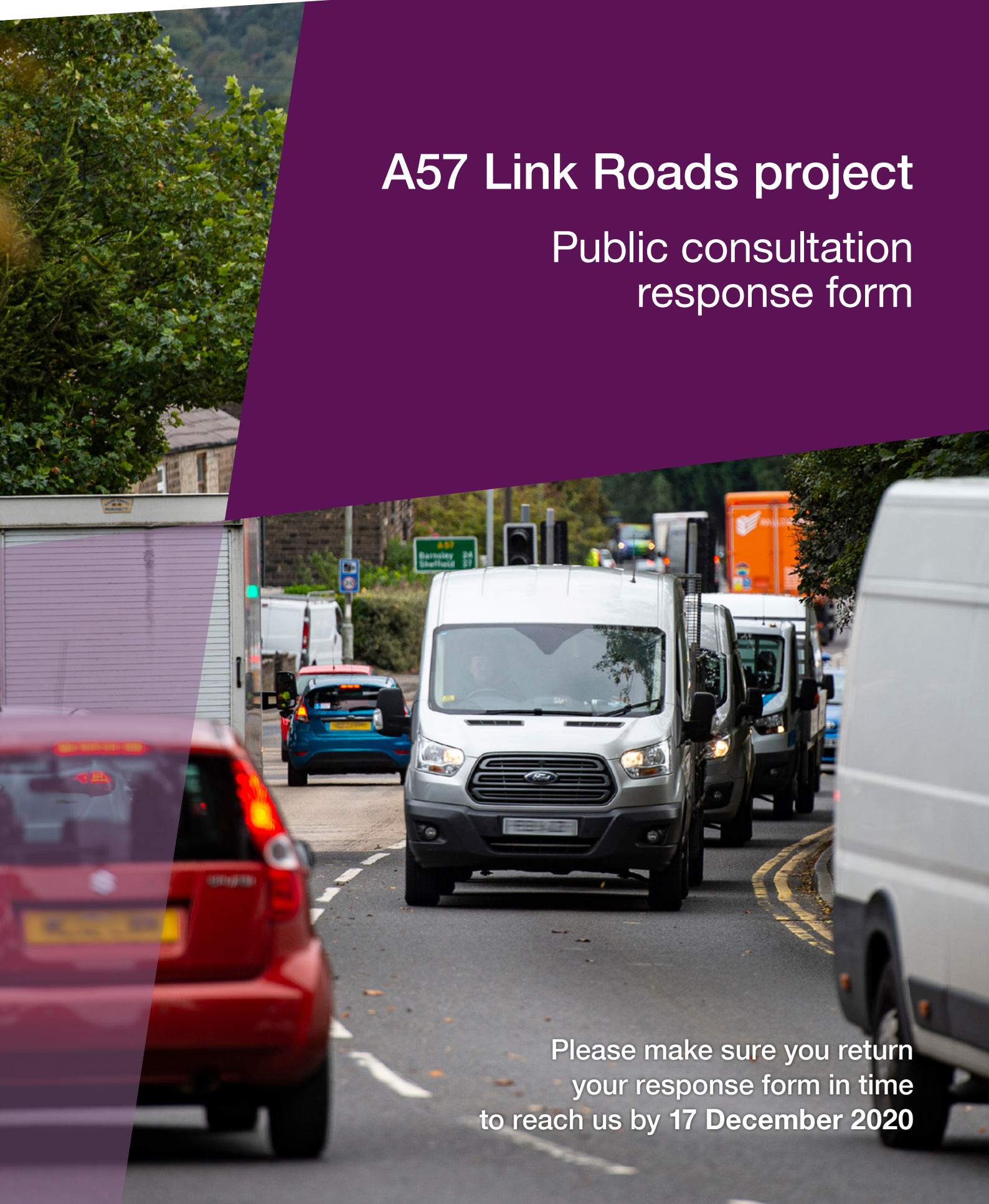

Please make sure you return
your response form in time
to reach us by 17 December 2020

A57 Link Roads project

Public consultation response form

We would like to hear your views on the design changes we have made to our proposals.

Please share your views with us by completing this response form and posting it to us using our freepost address: **Freepost A57 TRANS-PENNINE UPGRADE MAILBOX**

You can also fill out a copy of this response form online via our webpage at: www.highwaysengland.co.uk/A57-Upgrade

Please make sure you return your response form in time to reach us by **17 December 2020**.

Please provide us with your name and address, or, if you would prefer your comments to be anonymous, your postcode only.

Name:

Address:

.....

Postcode:

What do you currently use the road for? (please tick all that apply)

Business Residential Leisure

How do you normally travel on the route? (please tick all that apply)

Car Cycle Walk

Public transport HGV

Other:

The overall scheme

What is your view on our overall proposals for the scheme?

Agree Disagree Don't know

Updates to our Proposals

What is your view on our proposal to remove the Roe Cross road link, junction and roundabout from the scheme?

Agree Disagree Don't know / no preference

Is there anything we should consider or any comments you'd like to make?

.....

.....

.....

.....

.....

What is your view on our new location and design for the Mottram Underpass?

Agree Disagree Don't know / no preference

Is there anything we should consider or any comments you'd like to make?

.....

.....

.....

.....

.....

What is your view on our proposal to replace the proposed roundabout at Mottram Moor, with a signal-controlled junction?

Agree Disagree Don't know / no preference

Is there anything we should consider or any comments you'd like to make?

.....

.....

.....

.....

.....

What is your view on our proposal to reduce the length of our River Etherow crossing?

Agree Disagree Don't know / no preference

Is there anything we should consider or any comments you'd like to make?

.....

.....

.....

.....

.....

What is your view on our new design for the Woolley Bridge junction and location of the link road?

Agree Disagree Don't know / no preference

Is there anything we should consider or any comments you'd like to make?

.....

.....

.....

.....

.....

What is your view on the new provisions for cyclists and pedestrians, including additional crossings at the proposed Mottram Moor junction and connections to the former route?

Agree Disagree Don't know / no preference

Is there anything we should consider or any comments you'd like to make?

.....

.....

.....

.....

.....

What is your view on our new locations for the Carrhouse Lane underpass?

Agree Disagree Don't know / no preference

Is there anything we should consider or any comments you'd like to make?

.....

.....

.....

.....

.....

What is your view on our environmental assessment and the measures we proposed to minimise the impact in relation to air quality?

Agree Disagree Don't know / no preference

Is there anything we should consider or any comments you'd like to make?

.....

.....

.....

.....

.....

What is your view on our environmental assessment and the measures we proposed to minimise the impact in relation to noise?

Agree Disagree Don't know / no preference

Is there anything we should consider or any comments you'd like to make?

.....

.....

.....

.....

.....

The landscape

Would you describe the landscape surrounding the scheme as particularly important to you?

Yes

No

Don't know

If yes, what are the three most important natural, or man-made features of this landscape to you?

.....

.....

.....

.....

.....

Additional comments and information

Please use this space to provide any further comments or suggestions

.....

.....

.....

.....

.....

.....

.....

.....

.....

Please help us understand the range of people we are consulting by completing the following section. This information will not be used for any other purpose.

Your age: 16–24 25–34 35–44
 45–54 55–64 65+

Your gender: Male Female Prefer not to say

Do you consider yourself to have a disability?

Yes No Prefer not to say

Did you participate in one of our telephone events or join one of our webinars?

Yes No

By completing this questionnaire, you have identified that you have an interest in this project. It would help us if you could identify the nature of your interest. (You may tick more than one box.)

Business Local business Residential Agricultural interest
 Public Rights of Way Leisure Other:

How did you find out about the consultation?

.....

Considering the current situation around COVID-19, do you think we've delivered an effective consultation? Yes No Don't know

Why? Is there anything we could improve?

.....

.....

Your data, your rights

On 25 May 2018, the General Data Protection Regulations (GDPR) became law. The law requires Highways England to explain to you – consultees, stakeholders and customers – how your personal data will be used and stored.

Highways England adheres to the government's consultation principles, the Planning Act 2008 and the Highways Act 1980 as required, and may collect personal data to help shape development of highways schemes.

Personal data collected by the project team will be processed and retained by Highways England and its appointed contractors until the scheme is complete.

In some instances consultation responses may also be sent to the Planning Inspectorate. To view the Planning Inspectorate's information relating to GDPR at Examination events please visit: infrastructure.planninginspectorate.gov.uk/help/privacy-notice/

Under the GDPR regulations you have the following rights:

- Right of access to the data (Subject Access Request)
- Right for the rectification of errors
- Right to erasure of personal data – this is not an absolute right under the legislation
- Right to restrict processing or to object to processing
- Right to data portability

If, at any point, Highways England plans to process the personal data we hold for a purpose other than that for which it was originally collected, we will tell you what that other purpose is. We will do this prior to any further processing taking place and we will include any relevant additional information, including your right to object to that further processing.

You have the right to lodge a complaint with the supervisory authority, the Information Commissioners Office.



If you'd like more information about how we manage data, or a copy of our privacy notice, please contact: DataProtectionAdvice@highwaysengland.co.uk

Fold B

Freepost A57 TRANS-PENNINE UPGRADE MAILBOX

Fold A

Folding instructions

Once you've completed the questionnaire please follow these instructions before returning it to us:

1. With the return address facing you...
2. fold the bottom part backwards along Fold A
3. fold the top part backwards along Fold B
4. turn the folded questionnaire over, and...
5. secure it by sticking clear tape along the length of hatched area.
6. There's no need for a stamp, just pop it in the post.

1.

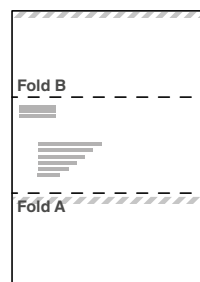

2.

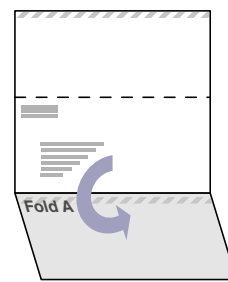

3.

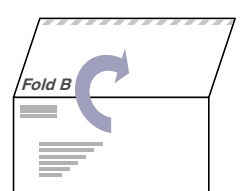

4.



5.

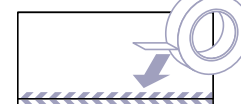

6.

