

A358 TAUNTON TO SOUTHFIELDS DUALLING SCHEME

SUPPLEMENTARY CONSULTATION 2022

WALKING, CYCLING AND HORSE RIDING INCLUDING DISABLED USERS
STRATEGY DRAWINGS

DO NOT SCALE

Millimetres
0 10 100

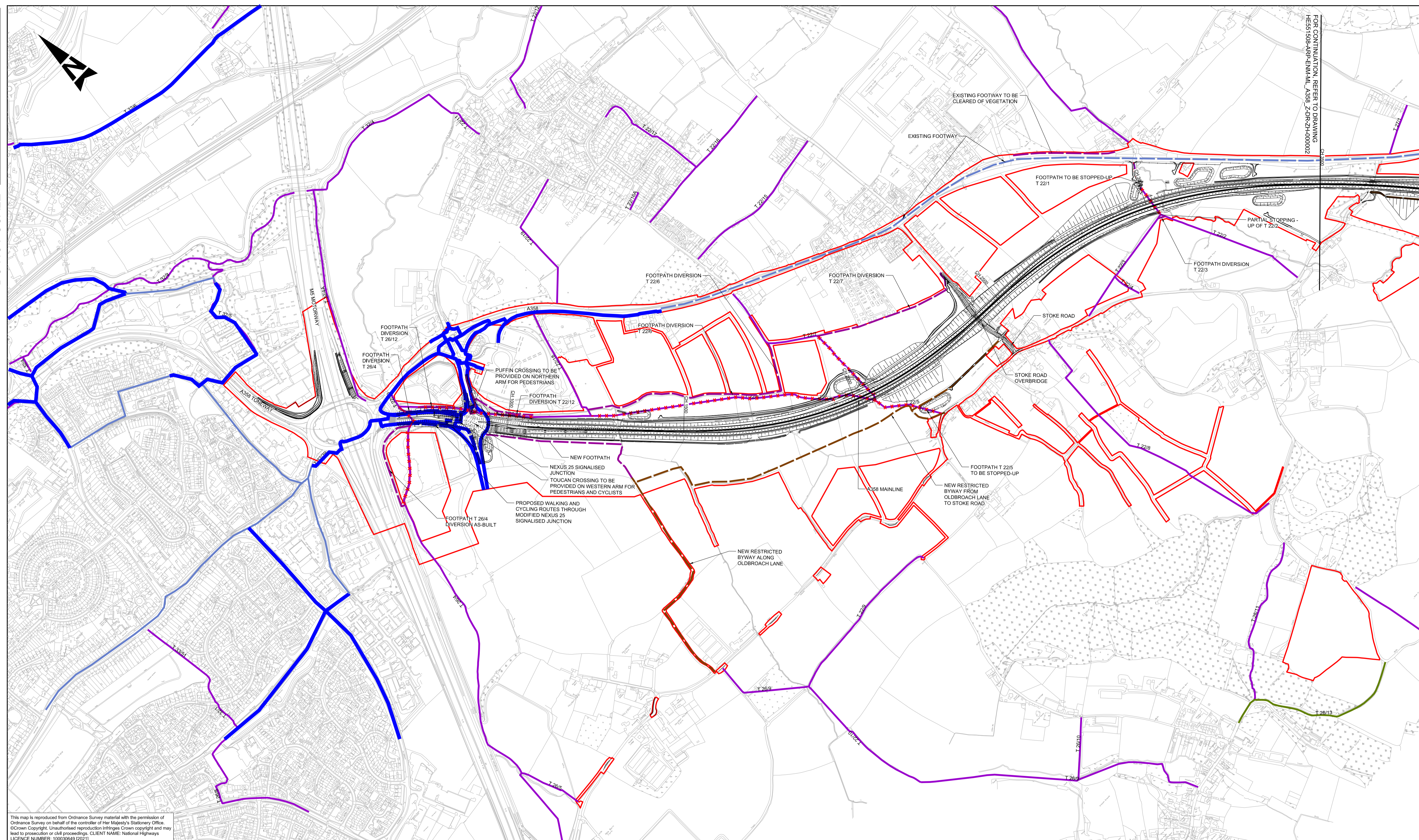

FOR CONTINUATION REFER TO DRAWING
HE551508-ARP-ENM-ML_A358_Z-DR-ZH-000002

This map is reproduced from Ordnance Survey material with the permission of Ordnance Survey on behalf of the controller of Her Majesty's Stationery Office. © Crown Copyright. Unauthorised reproduction infringes Crown copyright and may lead to prosecution or civil proceedings. CLIENT NAME: National Highways LICENCE NUMBER: 100030649 (2021)

- NOTES**
1. ALL DIMENSIONS ARE IN METRES UNLESS NOTED OTHERWISE.
 2. ONLY WRITTEN DIMENSIONS SHALL BE USED, DO NOT SCALE.
- LEGEND**
- EXISTING FOOTPATHS
 - EXISTING BRIDLEWAYS
 - EXISTING RESTRICTED BYWAY
 - EXISTING SIGNED/MAPPED CYCLE ROUTES
 - EXISTING TRAFFIC-FREE CYCLE ROUTES
 - PROPOSED FOOTPATH/FOOTWAY
 - PROPOSED BRIDLEWAY
 - PROPOSED RESTRICTED BYWAY
 - PROPOSED OFF-LINE CYCLE ROUTE
 - PROPOSED TRAFFIC-FREE CYCLE ROUTES
 - PROPOSED STOPPED-UP PATHS
 - SCHEME BOUNDARY

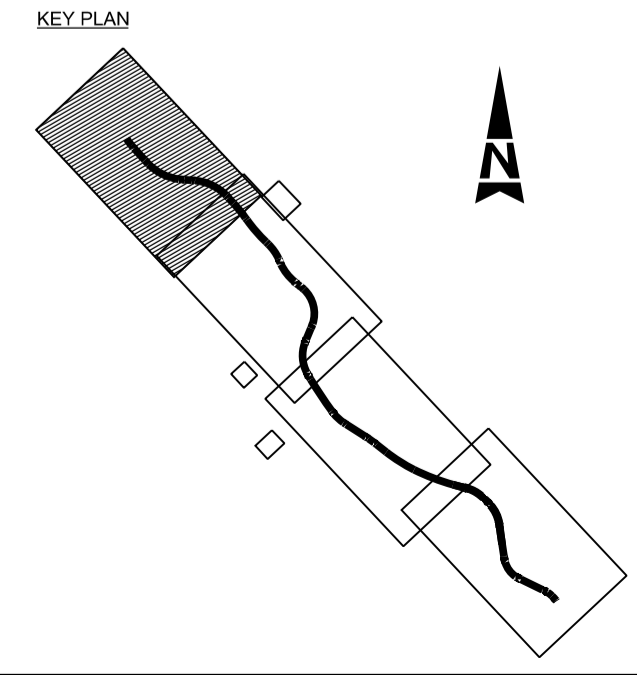

SAFETY, HEALTH AND ENVIRONMENTAL INFORMATION

IN ADDITION TO THE HAZARDS/RISKS NORMALLY ASSOCIATED WITH THE TYPES OF WORK DETAILED ON THIS DRAWING, NOTE THE FOLLOWING SIGNIFICANT RESIDUAL RISKS (REFERENCE SHALL ALSO BE MADE TO THE DESIGN HAZARD LOG).

CONSTRUCTION	MAINTENANCE / CLEANING	USE	DECOMMISSIONING / DEMOLITION
(TO BE POPULATED)	(TO BE POPULATED)	(TO BE POPULATED)	(TO BE POPULATED)

Rev.	Date	Description	By	Chk'd	App'd	Auth'd
P01	10/05/22	ISSUED FOR INFORMATION	BS	TB	SV	SV

Suitability: **S2** | Drawing Status: **SUITABLE FOR INFORMATION**

TAYLOR WOODROW
together @ VINCI

ARUP | **RAMBOLL**

Client: **national highways**

Project Title: **A358 TAUNTON TO SOUTHFIELDS DUALLING SCHEME**

Drawing Title: **WALKING, CYCLING AND HORSE RIDING STRATEGY SECTION 1 M5 JUNCTION 25 TO MATTOCK'S TREE GREEN**

Scale	By	Checked	Approved	Authorised
1:5000	BS	TB	SV	SV

Original Size	Date	Date	Date	Date
A1	10/05/22	10/05/22	10/05/22	10/05/22

Drawing Number	Originator	Volume	Revision
HE551508 - ARP - ENM - ML_A358_Z	ARP	ENM	P01

Location: **ML_A358_Z** | Type: **-DR-ZH-000001** | Role: **-DR-ZH-000001** | Number: **-DR-ZH-000001**

DO NOT SCALE

Millimetres
0 10 100

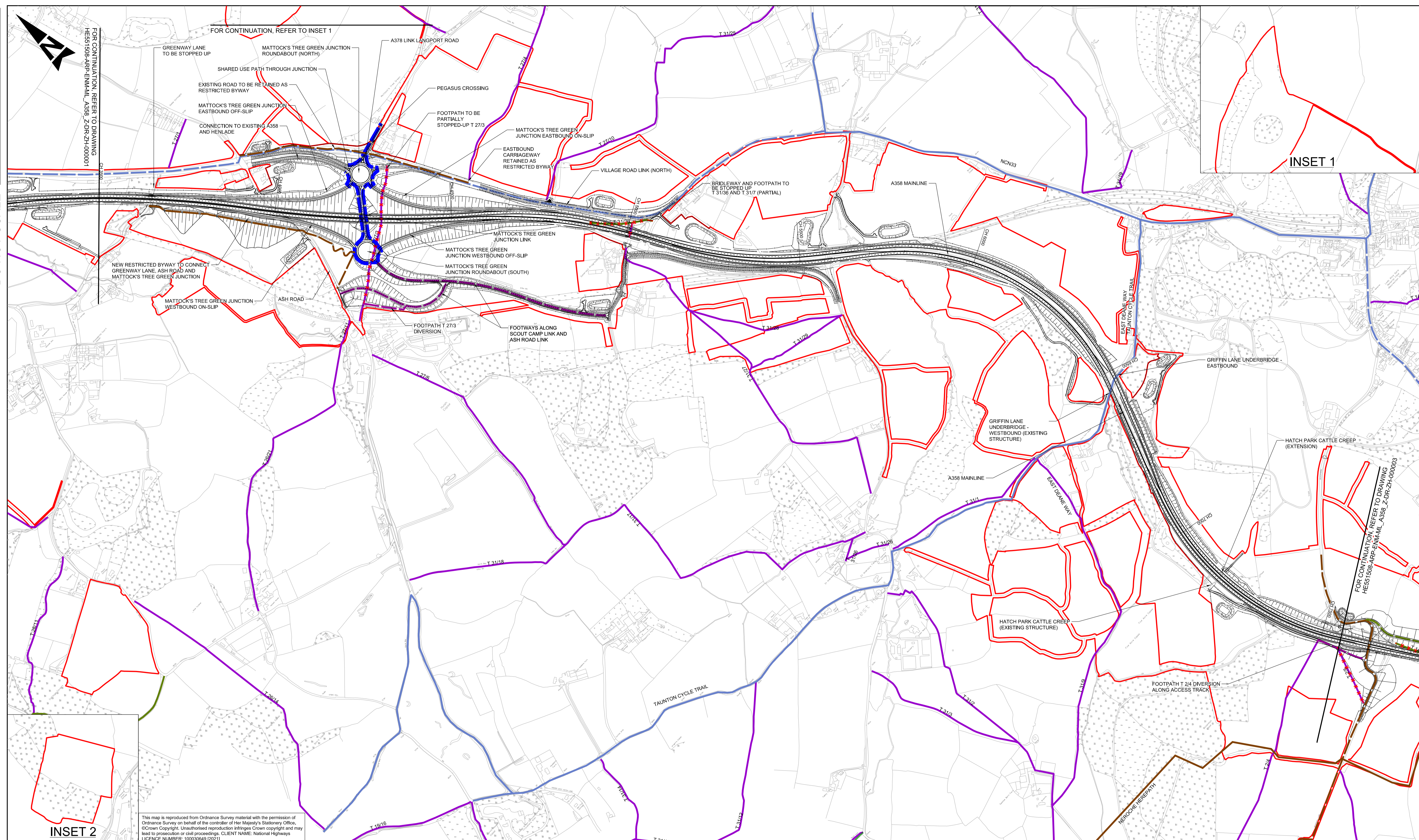

INSET 1

INSET 2

This map is reproduced from Ordnance Survey material with the permission of Ordnance Survey on behalf of the controller of Her Majesty's Stationery Office. © Crown Copyright. Unauthorised reproduction infringes Crown copyright and may lead to prosecution or civil proceedings. CLIENT NAME: National Highways LICENCE NUMBER: 100030649 (2021)

NOTES

- ALL DIMENSIONS ARE IN METRES UNLESS NOTED OTHERWISE.
- ONLY WRITTEN DIMENSIONS SHALL BE USED, DO NOT SCALE.

LEGEND

- EXISTING FOOTPATHS
- EXISTING BRIDLEWAYS
- EXISTING RESTRICTED BYWAY
- EXISTING SIGNED/MAPPED CYCLE ROUTES
- EXISTING TRAFFIC-FREE CYCLE ROUTES
- NEROCHE HEREPATH
- PROPOSED FOOTPATH/FOOTWAY
- PROPOSED BRIDLEWAY
- PROPOSED RESTRICTED BYWAY
- PROPOSED OFF-LINE CYCLE ROUTE
- PROPOSED TRAFFIC-FREE CYCLE ROUTES
- SCHEME BOUNDARY

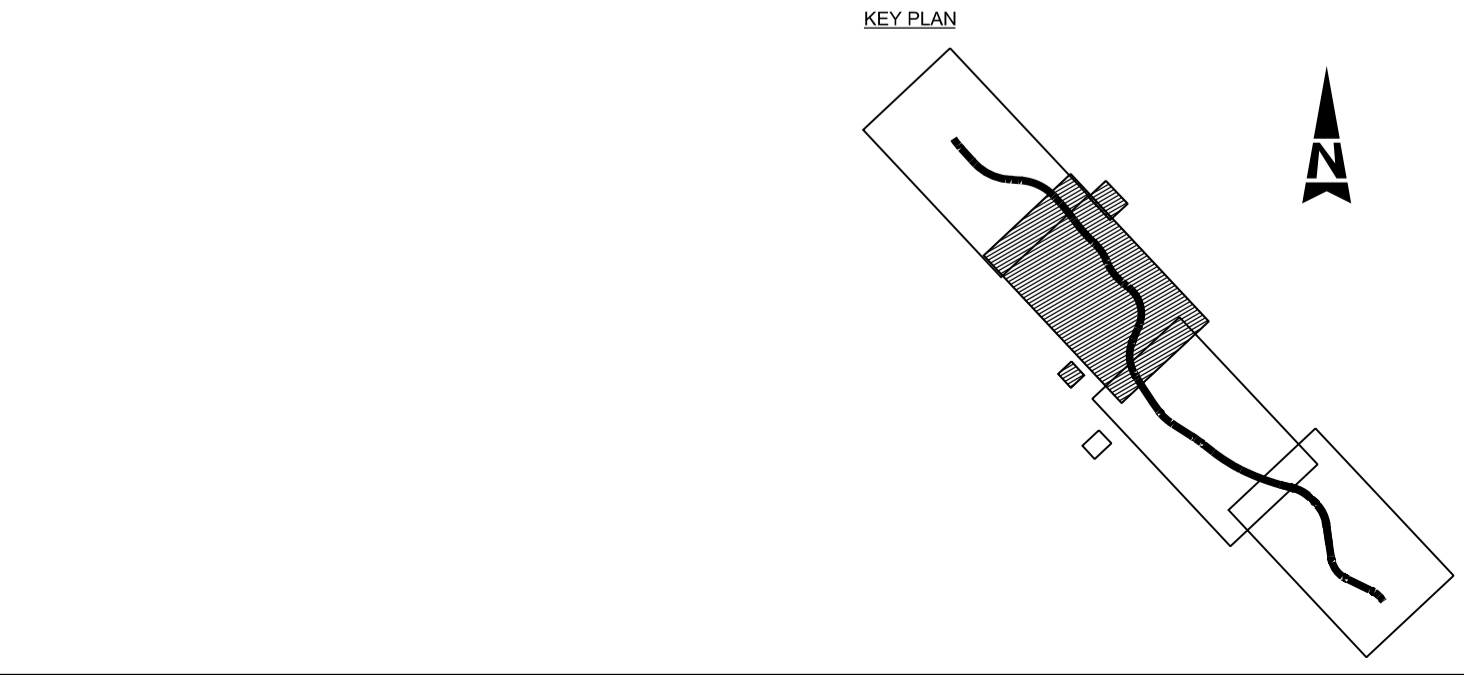

SAFETY, HEALTH AND ENVIRONMENTAL INFORMATION

IN ADDITION TO THE HAZARDS/RISKS NORMALLY ASSOCIATED WITH THE TYPES OF WORK DETAILED ON THIS DRAWING, NOTE THE FOLLOWING SIGNIFICANT RESIDUAL RISKS (REFERENCE SHALL ALSO BE MADE TO THE DESIGN HAZARD LOG).

CONSTRUCTION	MAINTENANCE / CLEANING	USE	DECOMMISSIONING / DEMOLITION
(TO BE POPULATED)	(TO BE POPULATED)	(TO BE POPULATED)	(TO BE POPULATED)

Rev.	Date	Description	By	Chk'd	App'd	Auth'd
P01	10/05/22	ISSUED FOR INFORMATION	BS	TB	SV	SV

Suitability: **S2** | Drawing Status: **SUITABLE FOR INFORMATION**

TAYLOR WOODROW
together @ VINCI

ARUP | **RAMBOLL**

national highways

Project Title: **A358 TAUNTON TO SOUTHFIELDS DUALLING SCHEME**

Drawing Title: **WALKING, CYCLING AND HORSE RIDING STRATEGY SECTION 2/3 MATTOCK'S TREE GREEN TO BICKENHALL LANE**

Scale	By	Checked	Approved	Authorised
1:5000	BS	TB	SV	SV

Original Size	Date	Date	Date	Date
A1	10/05/22	10/05/22	10/05/22	10/05/22

Drawing Number	Originator	Volume	Revision
HE551508 - ARP - ENM	ARP - ENM	ML_A358_Z -DR - ZH - 000002	P01

DO NOT SCALE

Millimetres

0 10 100

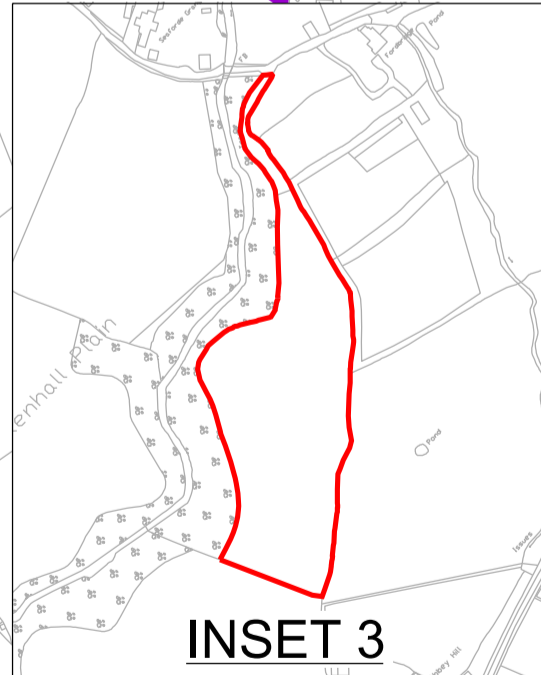
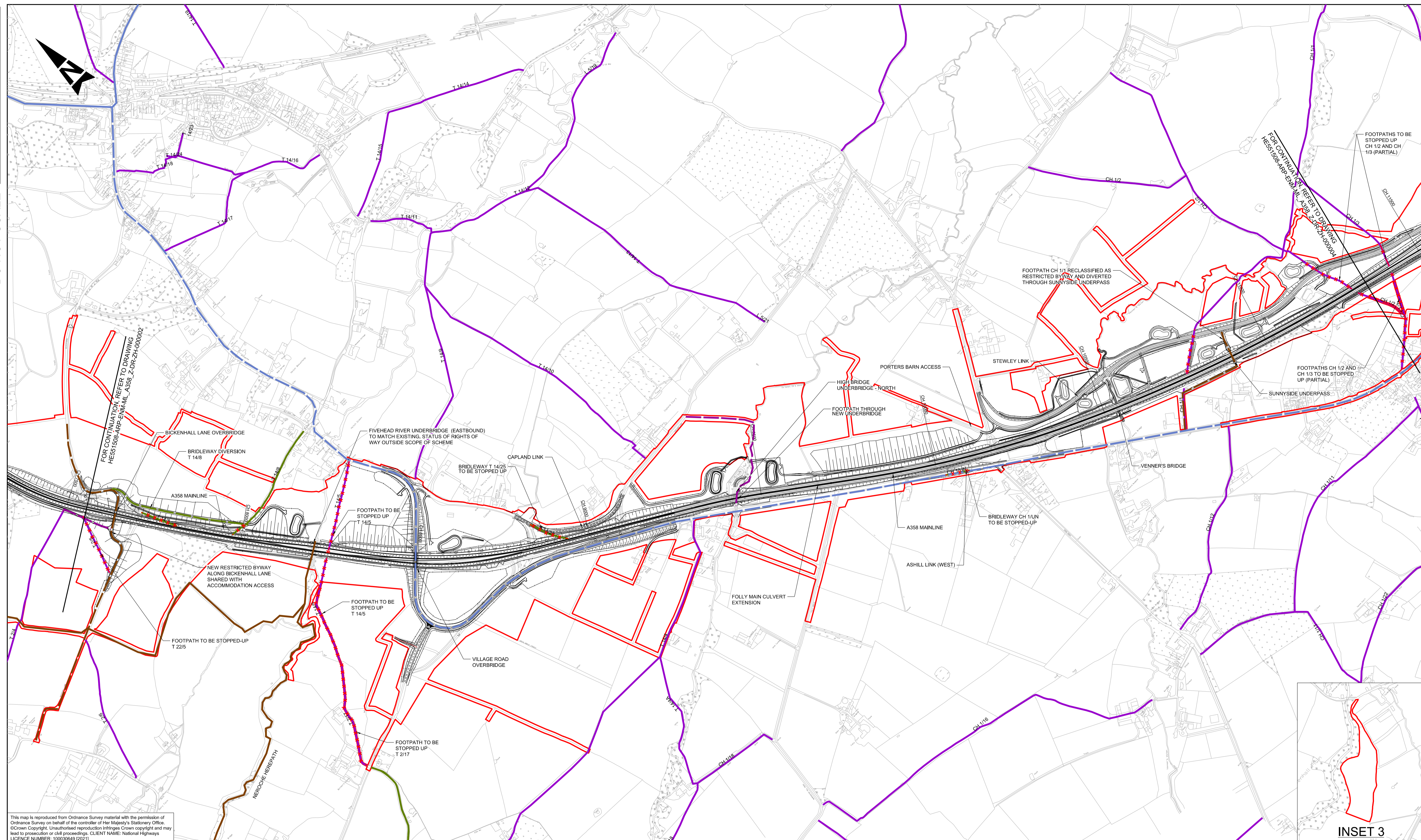

This map is reproduced from Ordnance Survey material with the permission of Ordnance Survey on behalf of the controller of Her Majesty's Stationery Office. © Crown Copyright. Unauthorised reproduction infringes Crown copyright and may lead to prosecution or civil proceedings. CLIENT NAME: National Highways LICENCE NUMBER: 100030649 (2021)

NOTES

- ALL DIMENSIONS ARE IN METRES UNLESS NOTED OTHERWISE.
- ONLY WRITTEN DIMENSIONS SHALL BE USED. DO NOT SCALE.

LEGEND

- EXISTING FOOTPATHS
- EXISTING BRIDLEWAYS
- EXISTING RESTRICTED BYWAY
- EXISTING SIGNED/MAPPED CYCLE ROUTES
- EXISTING TRAFFIC-FREE CYCLE ROUTES
- PROPOSED FOOTPATH/FOOTWAY
- PROPOSED BRIDLEWAY
- PROPOSED RESTRICTED BYWAY
- PROPOSED OFF-LINE CYCLE ROUTE
- PROPOSED TRAFFIC-FREE CYCLE ROUTES
- PROPOSED STOPPED-UP PATHS
- SCHEME BOUNDARY

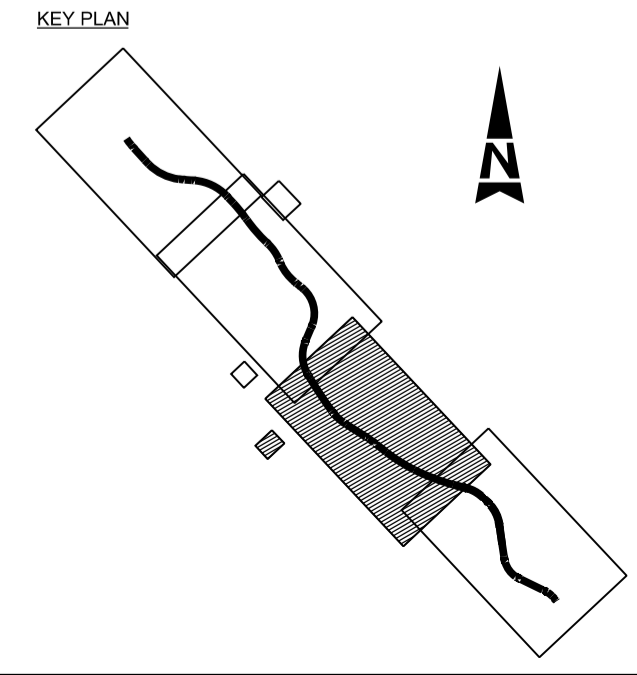

SAFETY, HEALTH AND ENVIRONMENTAL INFORMATION

IN ADDITION TO THE HAZARDS/RISKS NORMALLY ASSOCIATED WITH THE TYPES OF WORK DETAILED ON THIS DRAWING, NOTE THE FOLLOWING SIGNIFICANT RESIDUAL RISKS (REFERENCE SHALL ALSO BE MADE TO THE DESIGN HAZARD LOG).

CONSTRUCTION	MAINTENANCE / CLEANING	USE	DECOMMISSIONING / DEMOLITION
(TO BE POPULATED)	(TO BE POPULATED)	(TO BE POPULATED)	(TO BE POPULATED)

Rev.	Date	Description	By	Chk'd	App'd	Auth'd
P01	10/05/22	ISSUED FOR INFORMATION	BS	TB	SV	SV

Suitability: S2 | Drawing Status: SUITABLE FOR INFORMATION

TAYLOR WOODROW
together @ VINCI

ARUP | **RAMBOLL**

Client: **national highways**

Project Title: **A358 TAUNTON TO SOUTHFIELDS DUALLING SCHEME**

Drawing Title: **WALKING, CYCLING AND HORSE RIDING STRATEGY SECTION 3 BICKENHILL LANE TO ASHILL**

Scale	By	Checked	Approved	Authorised
1:5000	BS	TB	SV	SV

Original Size	Date	Date	Date	Date
A1	10/05/22	10/05/22	10/05/22	10/05/22

Drawing Number	Originator	Volume	Revision
HE551508 - ARP	ML_A358_Z	-DR-ZH-000003	P01

DO NOT SCALE

Millimetres

0 10 100

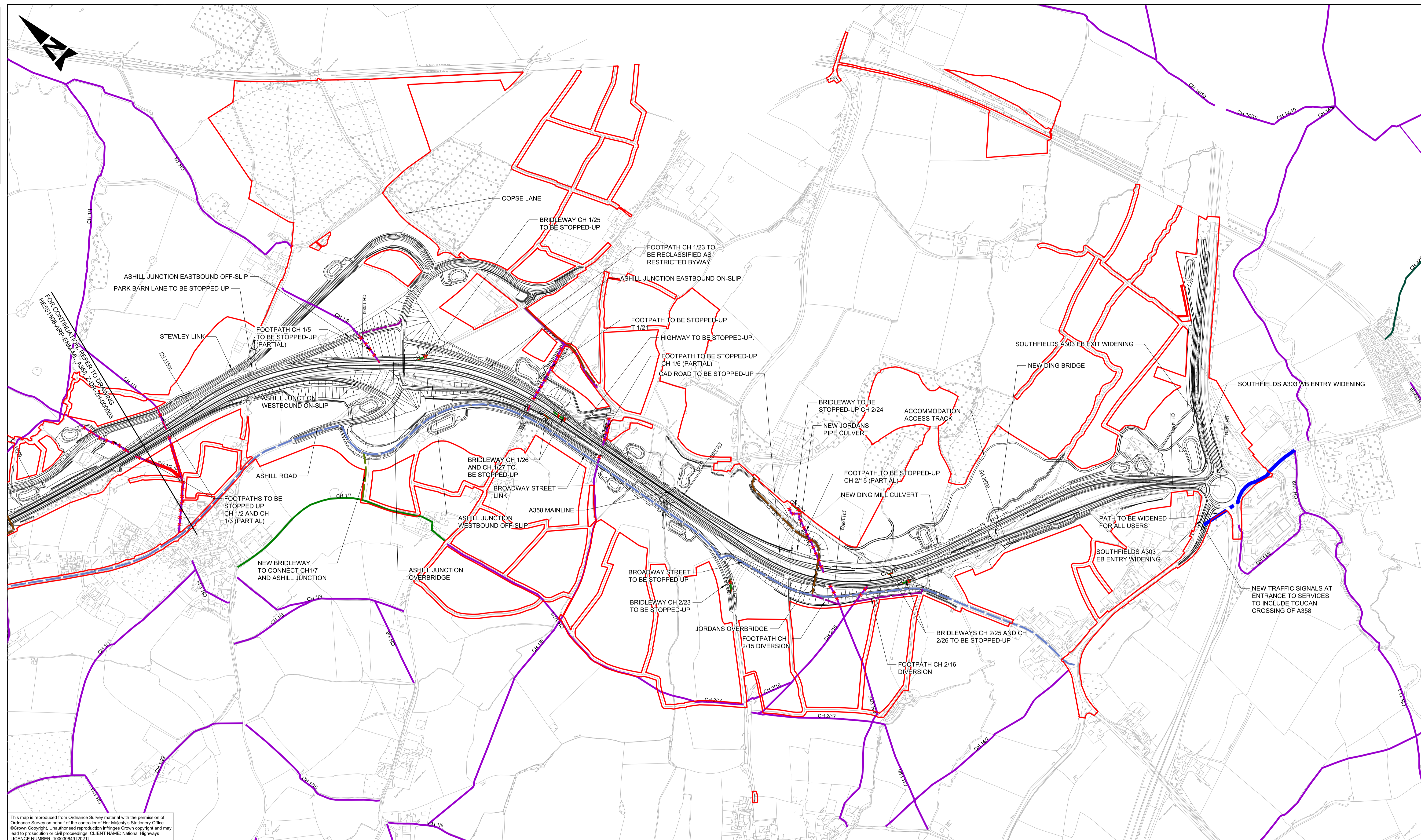

This map is reproduced from Ordnance Survey material with the permission of Ordnance Survey on behalf of the controller of Her Majesty's Stationery Office. © Crown Copyright. Unauthorised reproduction infringes Crown copyright and may lead to prosecution or civil proceedings. CLIENT NAME: National Highways LICENCE NUMBER: 100030649 (2021)

- NOTES**
1. ALL DIMENSIONS ARE IN METRES UNLESS NOTED OTHERWISE.
 2. ONLY WRITTEN DIMENSIONS SHALL BE USED, DO NOT SCALE.
- LEGEND**
- EXISTING FOOTPATHS
 - EXISTING BRIDLEWAYS
 - EXISTING RESTRICTED BYWAY
 - EXISTING SIGNED/MAPPED CYCLE ROUTES
 - EXISTING TRAFFIC-FREE CYCLE ROUTES
 - PROPOSED FOOTPATH/FOOTWAY
 - PROPOSED BRIDLEWAY
 - PROPOSED RESTRICTED BYWAY
 - PROPOSED OFF-LINE CYCLE ROUTE
 - PROPOSED TRAFFIC-FREE CYCLE ROUTES
 - PROPOSED STOPPED-UP PATHS
 - SCHEME BOUNDARY

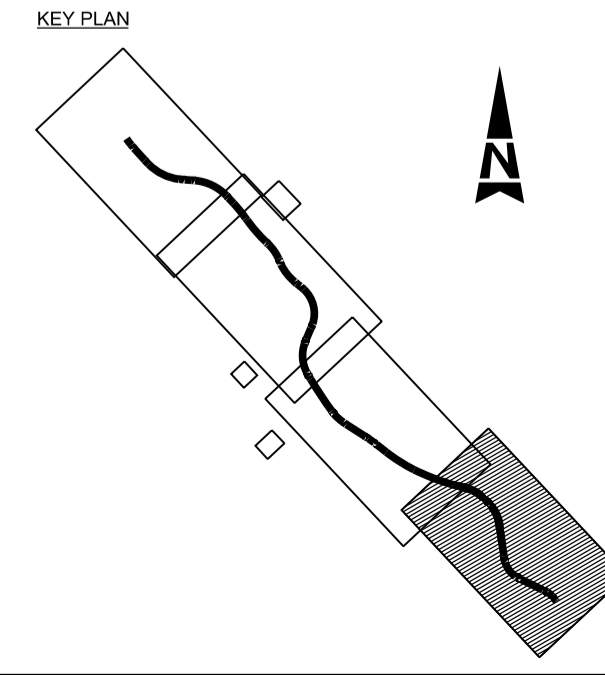

SAFETY, HEALTH AND ENVIRONMENTAL INFORMATION

IN ADDITION TO THE HAZARDS/RISKS NORMALLY ASSOCIATED WITH THE TYPES OF WORK DETAILED ON THIS DRAWING, NOTE THE FOLLOWING SIGNIFICANT RESIDUAL RISKS (REFERENCE SHALL ALSO BE MADE TO THE DESIGN HAZARD LOG).

CONSTRUCTION	MAINTENANCE / CLEANING	USE	DECOMMISSIONING / DEMOLITION
(TO BE POPULATED)	(TO BE POPULATED)	(TO BE POPULATED)	(TO BE POPULATED)

Rev.	Date	Description	By	Chk'd	App'd	Auth'd
P01	10/05/22	ISSUED FOR INFORMATION	BS	TB	SV	SV

Suitability: **S2** Drawing Status: **SUITABLE FOR INFORMATION**

TAYLOR WOODROW
together @ VINCI

ARUP **RAMBOLL**

national highways

Project Title: **A358 TAUNTON TO SOUTHFIELDS DUALLING SCHEME**

Drawing Title: **WALKING, CYCLING AND HORSE RIDING STRATEGY SECTION 4 ASHILL TO SOUTHFIELDS ROUNDABOUT**

Scale	By	Checked	Approved	Authorised
1:5000	BS	TB	SV	SV

Original Size	Date	Date	Date	Date
A1	10/05/22	10/05/22	10/05/22	10/05/22

Drawing Number	Originator	Volume	Revision
HE551508 - ARP	ENM	ENM	P01
ML_A358_Z	-DR	-ZH	-000004