

DO NOT SCALE

Millimetres
0 10 100

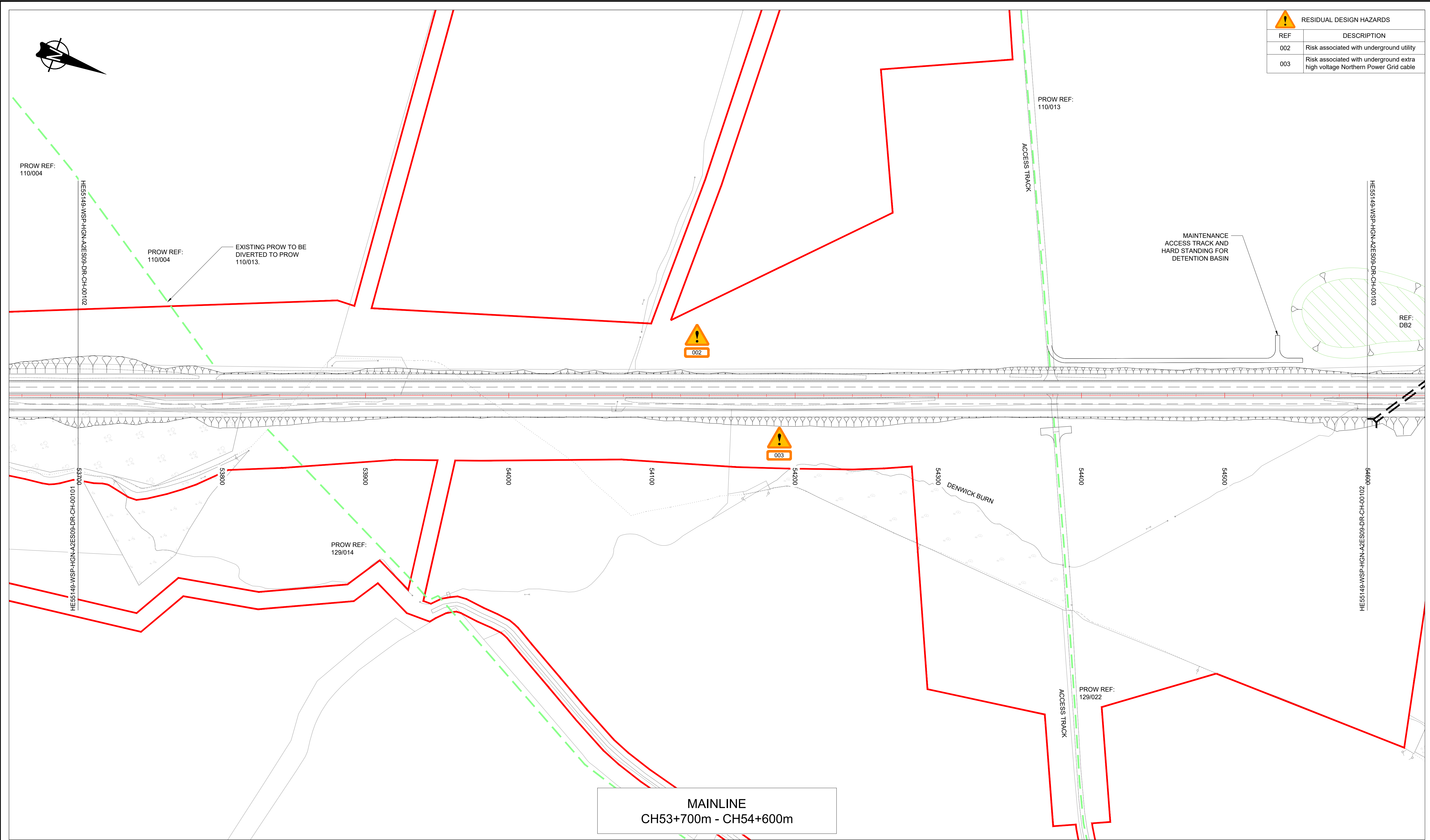

RESIDUAL DESIGN HAZARDS	
REF	DESCRIPTION
002	Risk associated with underground utility
003	Risk associated with underground extra high voltage Northern Power Grid cable

MAINLINE
CH53+700m - CH54+600m

© Crown Copyright and Database Rights 2019 Ordnance Survey 100030649

KEY:

	Proposed Road Alignment		Scheme Boundary (Extent of Environmental Assessment)
	Existing Bridleway		Culvert
	Existing Public Right of Way (to be stopped up)		Public Right of Way. Refer to: http://map.northumberland.gov.uk/prow for details
	Existing Public Right of Way (to be retained)		Maintenance Hardstanding
	Proposed Public Right of Way		Drainage Detention Basin
	Proposed Public Right of Way (constructed to Bridleway standard)		Heritage Site
	Overbridge		Existing Bus Stop to be removed
			Proposed Bus Stop Location
			Proposed Sign (not to scale)

NOTES:

- For full extent of the Scheme Boundary see drawing HE551459-WSP-HGN-A2E-DR-CH-00003.
- For full extent of PROW diversions see drawing HE551459-WSP-HGN-A2E-DR-CH-00068.
- Refer to Design Risk Management Schedule for details of residual design hazards.
- All road markings shown are indicative only.

Rev	Date	Description	By	Eng' Chk	Disc' Chk	App'd
P01	19/02/19	Design Fix 3 for Statutory Consultation First Issue	NH	TO	GH	DM

For Information

wsp

8 First Street
Manchester
M15 4RP, UK

T+ 44 (0) 161 200 5000
wsp.com

© WSP UK Ltd

**highways
england**

Project Title		A1 in Northumberland Alnwick to Ellingham Scheme			
Drawing Title		General Arrangement Overbridge Location Option 2 - Heckley Fence Sheet 2 of 13 Regulation 5 (2) (o)			
Scale	1:1250	Drawn	NH	Eng. Check	TO
Original Size	A1	Date	19/02/19	Date	19/02/19
Approved	GH	Authorised	DM		
Date	19/02/19	Date	19/02/19	Date	19/02/19
Drawing Number	HE551459	Originator	WSP	Volume	HGN
HE PIN	A2ES09	Location	DR	CH	00102
Design Stage	3	Revision	P01		

DO NOT SCALE

Millimetres
0 10 100

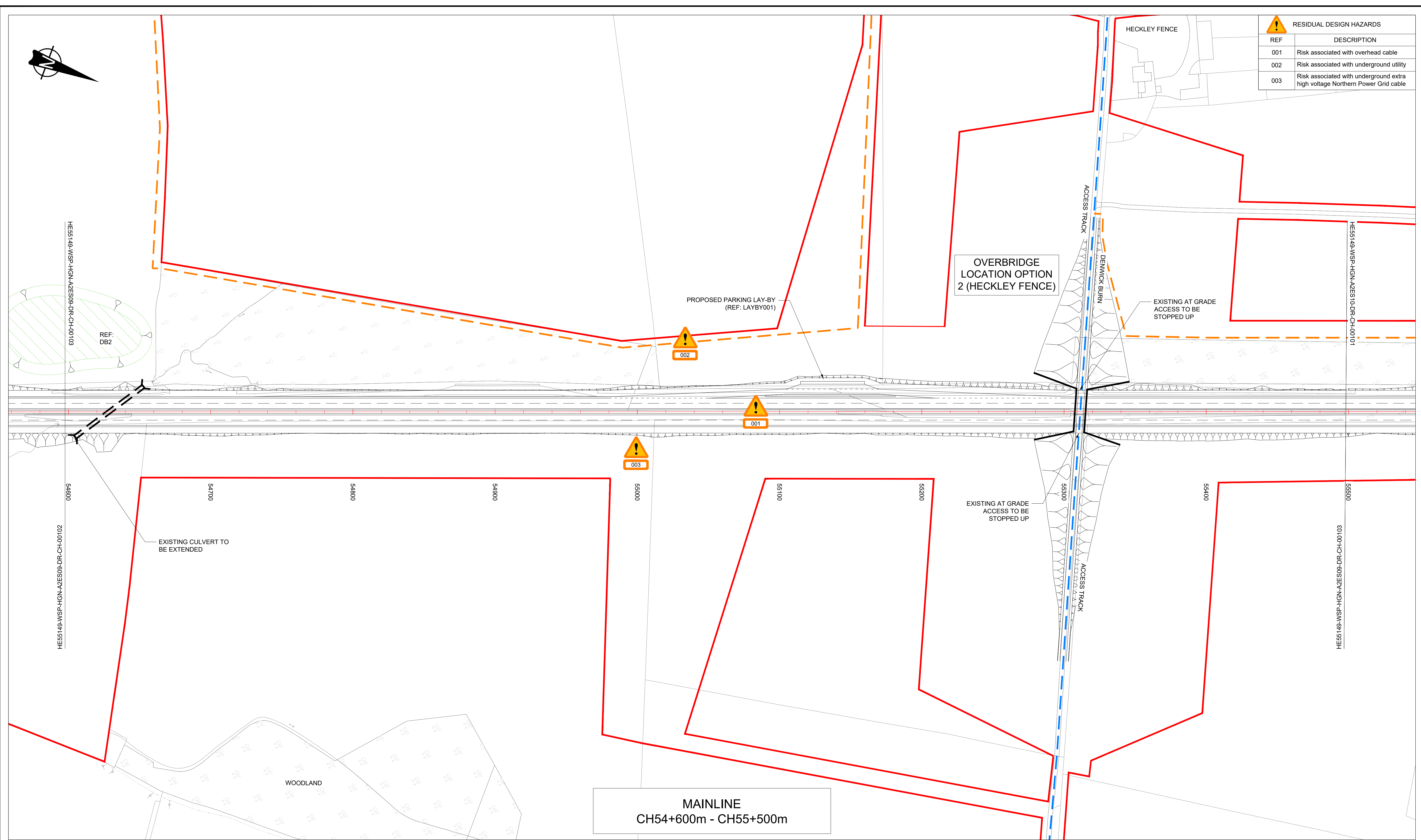

RESIDUAL DESIGN HAZARDS	
REF	DESCRIPTION
001	Risk associated with overhead cable
002	Risk associated with underground utility
003	Risk associated with underground extra high voltage Northern Power Grid cable

© Crown Copyright and Database Rights 2019 Ordnance Survey 100030649

KEY:

	Proposed Road Alignment		Scheme Boundary (Extent of Environmental Assessment)
	Existing Bridleway		Culvert
	Existing Public Right of Way (to be stopped up)		Public Right of Way. Refer to: http://map.northumberland.gov.uk/prow for details
	Existing Public Right of Way (to be retained)		Maintenance Hardstanding
	Proposed Public Right of Way		Drainage Detention Basin
	Proposed Public Right of Way (constructed to Bridleway standard)		Heritage Site
	Overbridge		Existing Bus Stop to be removed
			Proposed Bus Stop Location
			Proposed Sign (not to scale)

NOTES:

- For full extent of the Scheme Boundary see drawing HE551459-WSP-HGN-A2E-DR-CH-00003.
- For full extent of PRow diversions see drawing HE551459-WSP-HGN-A2E-DR-CH-00068.
- Refer to Design Risk Management Schedule for details of residual design hazards.
- All road markings shown are indicative only.

Rev.	Date	Description	By	Eng' Chk	Disc' Chk	App'd
P01	19/02/19	Design Fix 3 for Statutory Consultation First Issue	NH	TO	GH	DM

For Information

wsp

8 First Street
Manchester
M15 4RP, UK

T+ 44 (0) 161 200 5000
wsp.com

© WSP UK Ltd

**highways
england**

Suitability	Status	Project Title	
	S2	A1 in Northumberland Alnwick to Ellingham Scheme	
Drawing Title		General Arrangement Overbridge Location Option 2 - Heckley Fence Sheet 3 of 13 Regulation 5 (2) (o)	
Scale	Drawn	Eng. Check	Approved
1:1250	NH	TO	GH
Original Size	Date	Date	Date
A1	19/02/19	19/02/19	19/02/19
Authorised	DM	Design Stage	3
Drawing Number	HE PIN	Originator	Volume
HE551459	WSP	HGN	HGN
A2ES09	DR	CH	00103
Location	Type	Role	Number
			P01

DO NOT SCALE

100
0 10
Millimetres

RESIDUAL DESIGN HAZARDS	
REF	DESCRIPTION
002	Risk associated with underground utility
003	Risk associated with underground extra high voltage Northern Power Grid cable

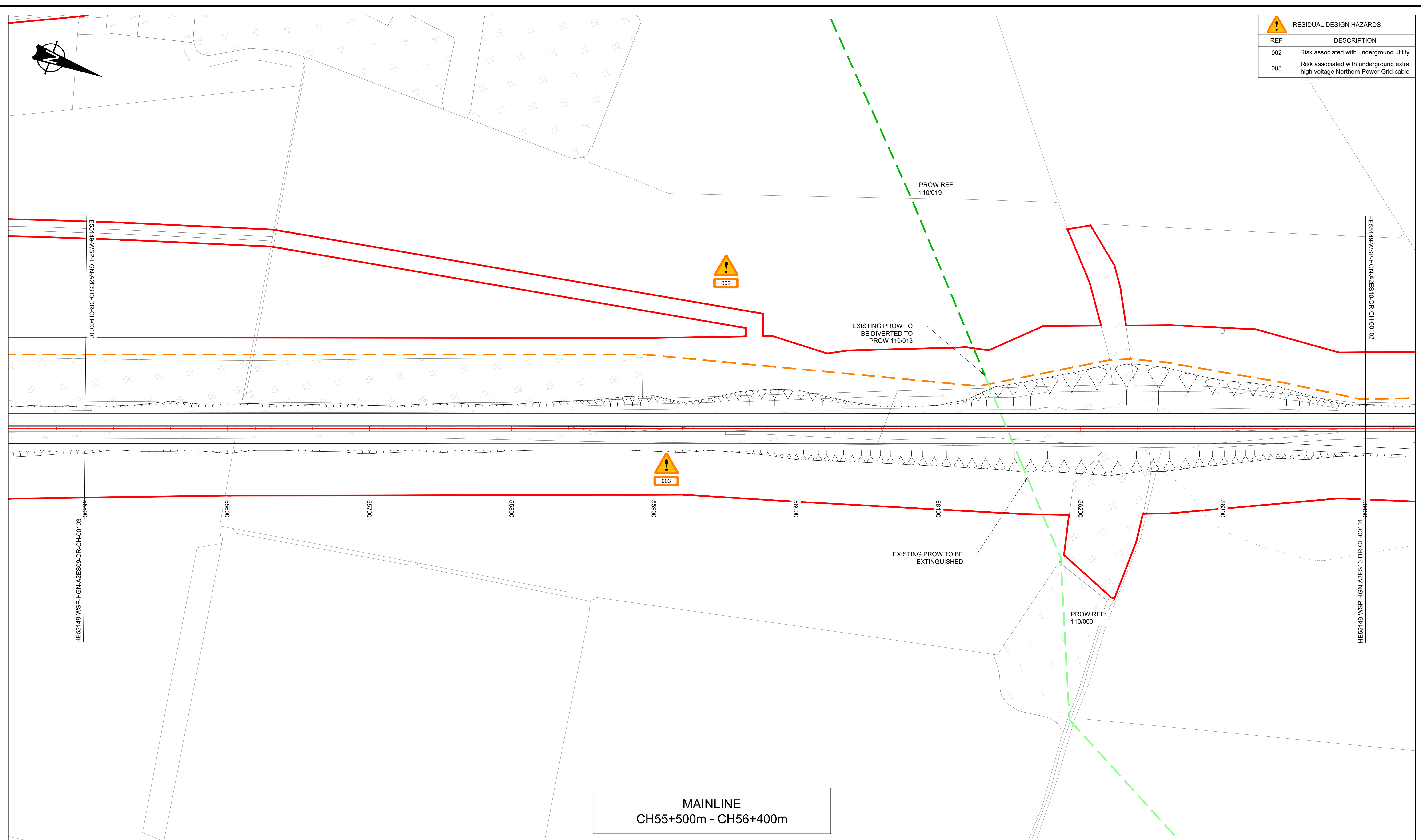

© Crown Copyright and Database Rights 2019 Ordnance Survey 100030649

KEY:	
	Proposed Road Alignment
	Existing Bridleway
	Existing Public Right of Way (to be stopped up)
	Existing Public Right of Way (to be retained)
	Proposed Public Right of Way
	Proposed Public Right of Way (constructed to Bridleway standard)
	Overbridge
	Scheme Boundary (Extent of Environmental Assessment)
	Culvert
	Public Right of Way. Refer to: http://map.northumberland.gov.uk/prow for details
	Maintenance Hardstanding
	Drainage Detention Basin
	Heritage Site
	Existing Bus Stop to be removed
	Proposed Bus Stop Location
	Proposed Sign (not to scale)

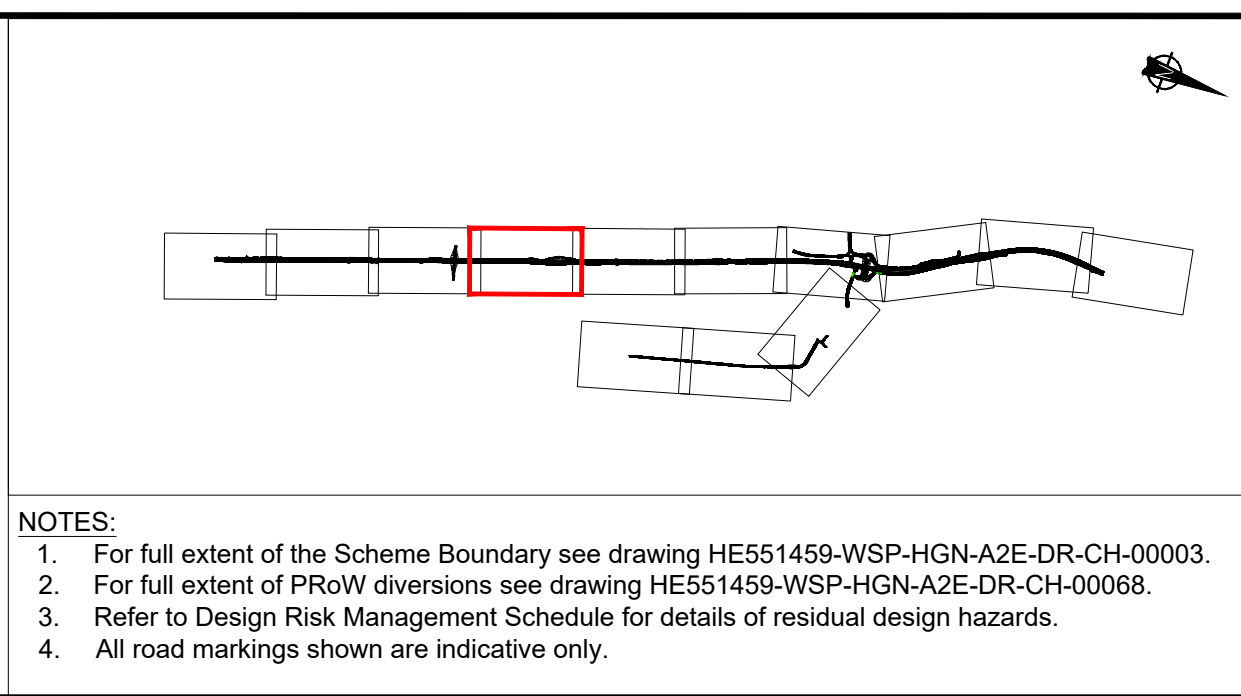

Rev.	Date	Description	By	Eng' Chk	Disc' Chk	App'd
P01	19/02/19	Design Fix 3 for Statutory Consultation First Issue	NH	TO	GH	DM

For Information

wsp

8 First Street
Manchester
M15 4RP, UK

T+ 44 (0) 161 200 5000
wsp.com

© WSP UK Ltd

Client

**highways
england**

Project Title		Status	
A1 in Northumberland Alnwick to Ellingham Scheme		S2	
Drawing Title			
General Arrangement Overbridge Location Option 2 - Heckley Fence Sheet 4 of 13 Regulation 5 (2) (o)			
Scale	Drawn	Eng. Check	Approved
1:1250	NH	TO	GH
Original Size	Date	Date	Date
A1	19/02/19	19/02/19	19/02/19
Drawing Number	Originator	Volume	Design Stage
HE551459	WSP	HGN	3
Location	Type	Role	Number
A2ES10	DR	CH	00101
			Revision
			P01

DO NOT SCALE

Millimetres

0 10

100

RESIDUAL DESIGN HAZARDS	
REF	DESCRIPTION
002	Risk associated with underground utility
003	Risk associated with underground extra high voltage Northern Power Grid cable

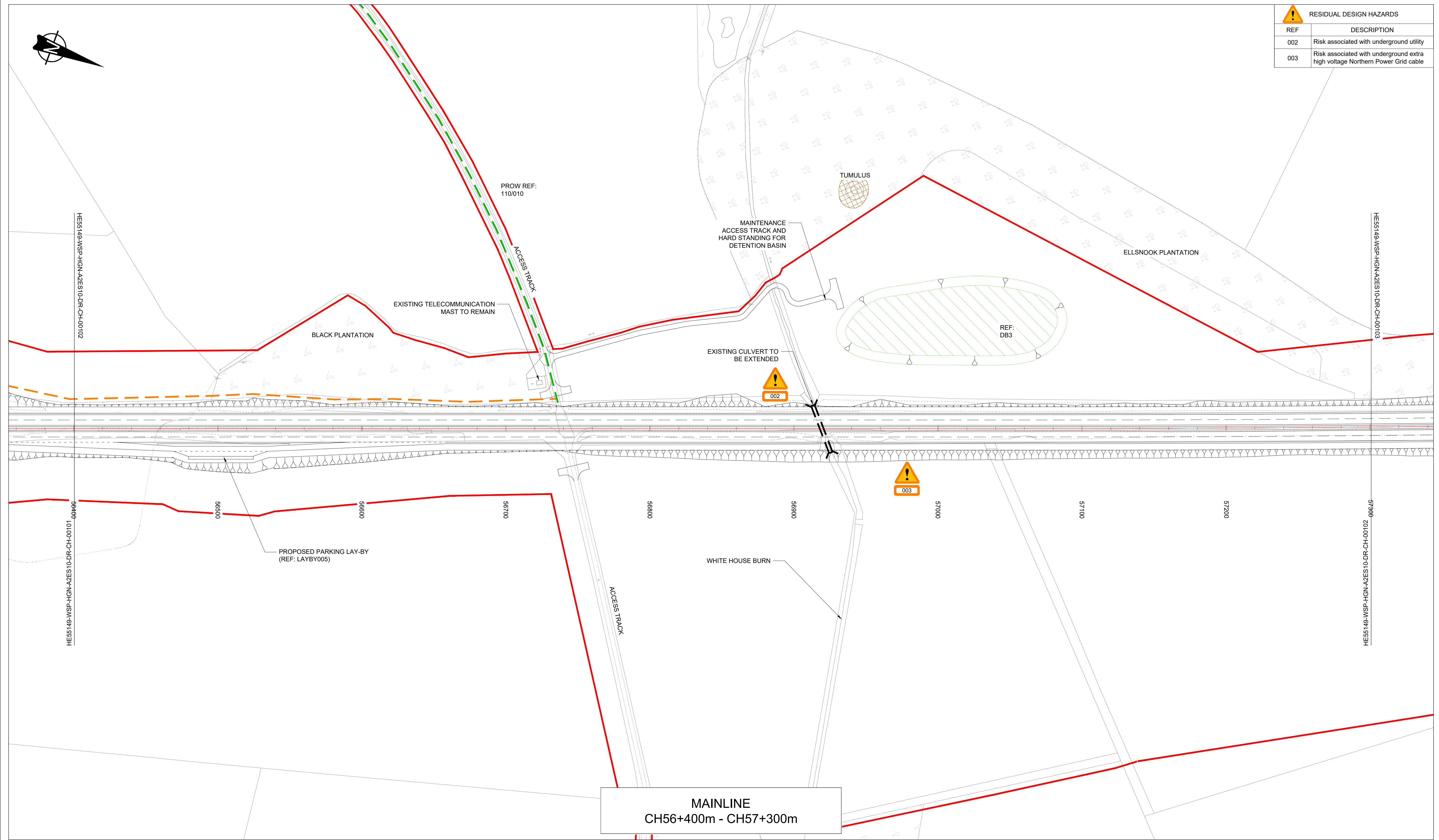

MAINLINE
CH56+400m - CH57+300m

© Crown Copyright and Database Rights 2019 Ordnance Survey 100030649

KEY:

	Proposed Road Alignment		Scheme Boundary (Extent of Environmental Assessment)
	Existing Bridleway		Culvert
	Existing Public Right of Way (to be stopped up)		Public Right of Way. Refer to: http://map.northumberland.gov.uk/prow for details
	Existing Public Right of Way (to be retained)		Maintenance Hardstanding
	Proposed Public Right of Way		Drainage Detention Basin
	Proposed Public Right of Way (constructed to Bridleway standard)		Heritage Site
	Overbridge		Existing Bus Stop to be removed
			Proposed Bus Stop Location
			Proposed Sign (not to scale)

NOTES:

- For full extent of the Scheme Boundary see drawing HE551459-WSP-HGN-A2E-DR-CH-00003.
- For full extent of PRoW diversions see drawing HE551459-WSP-HGN-A2E-DR-CH-00068.
- Refer to Design Risk Management Schedule for details of residual design hazards.
- All road markings shown are indicative only.

Rev.	Date	Description	By	Eng' Chk	Disc' Chk	App'd
P01	19/02/19	Design Fix 3 for Statutory Consultation First Issue	NH	TO	GH	DM

For Information

wsp

8 First Street
Manchester
M15 4RP, UK

T+ 44 (0) 161 200 5000
wsp.com

© WSP UK Ltd

Client

highways
england

Status	S2	Project Title	A1 in Northumberland Alnwick to Ellingham Scheme						
Drawing Title	General Arrangement Overbridge Location Option 2 - Heckley Fence Sheet 5 of 13 Regulation 5 (2) (o)								
Scale	1:1250	Drawn	NH	Eng. Check	TO	Approved	GH	Authorised	DM
Original Size	A1	Date	19/02/19	Date	19/02/19	Date	19/02/19	Date	19/02/19
Drawing Number	HE551459	Originator	WSP	Volume	HGN	Design Stage	3		
HE PIN	A2E510	Location	DR	CH	00102	Revision	P01		
Type	Role	Number							

DO NOT SCALE

Millimetres

0 10 100

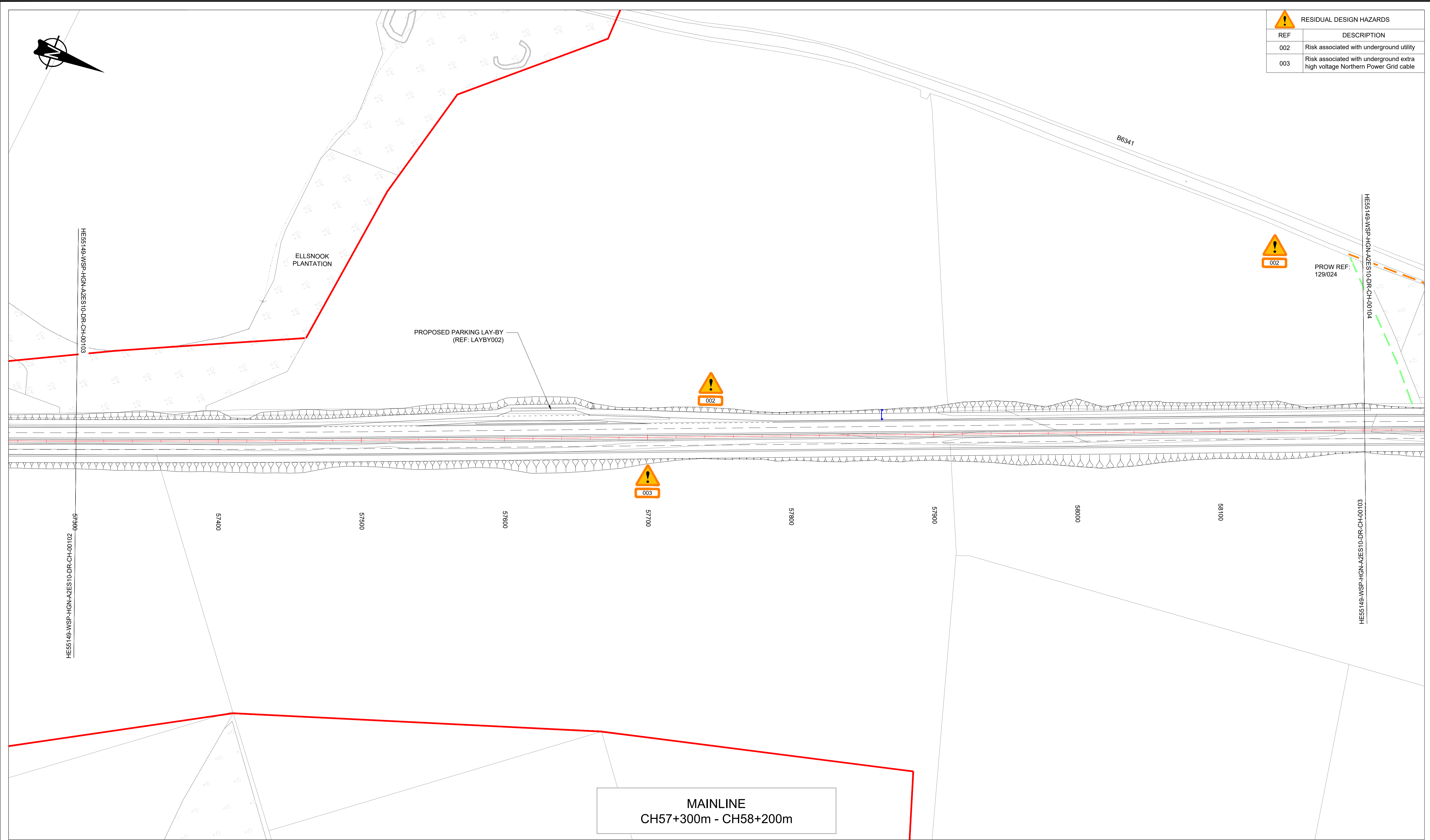

RESIDUAL DESIGN HAZARDS	
REF	DESCRIPTION
002	Risk associated with underground utility
003	Risk associated with underground extra high voltage Northern Power Grid cable

© Crown Copyright and Database Rights 2019 Ordnance Survey 100030649

KEY:

	Proposed Road Alignment		Scheme Boundary (Extent of Environmental Assessment)
	Existing Bridleway		Culvert
	Existing Public Right of Way (to be stopped up)		Public Right of Way. Refer to: http://map.northumberland.gov.uk/prow for details
	Existing Public Right of Way (to be retained)		Maintenance Hardstanding
	Proposed Public Right of Way		Drainage Detention Basin
	Proposed Public Right of Way (constructed to Bridleway standard)		Heritage Site
	Overbridge		Existing Bus Stop to be removed
			Proposed Bus Stop Location
			Proposed Sign (not to scale)

NOTES:

- For full extent of the Scheme Boundary see drawing HE551459-WSP-HGN-A2E-DR-CH-00003.
- For full extent of PRoW diversions see drawing HE551459-WSP-HGN-A2E-DR-CH-00068.
- Refer to Design Risk Management Schedule for details of residual design hazards.
- All road markings shown are indicative only.

Rev.	Date	Description	By	Eng' Chk	Disc' Chk	App'd
P01	19/02/19	Design Fix 3 for Statutory Consultation First Issue	NH	TO	GH	DM

For Information

wsp

8 First Street
Manchester
M15 4RP, UK

T+ 44 (0) 161 200 5000
wsp.com

© WSP UK Ltd

highways
england

Suitability	Status	Project Title			
	S2	A1 in Northumberland Alnwick to Ellingham Scheme			
Drawing Title					
General Arrangement Overbridge Location Option 2 - Heckley Fence Sheet 6 of 13 Regulation 5 (2) (o)					
Scale	Drawn	Eng. Check	Approved	Authorised	
N/A	NH	TO	GH	DM	
Original Size	Date	Date	Date	Date	
A1	19/02/19	19/02/19	19/02/19	19/02/19	
Drawing Number		Originator		Design Stage	
HE PIN		WSP		3	
HE551459		HGN		Revision	
A2ES10		DR CH		00103	
Location		Type		Number	
				P01	

DO NOT SCALE

Millimetres

0 10 100

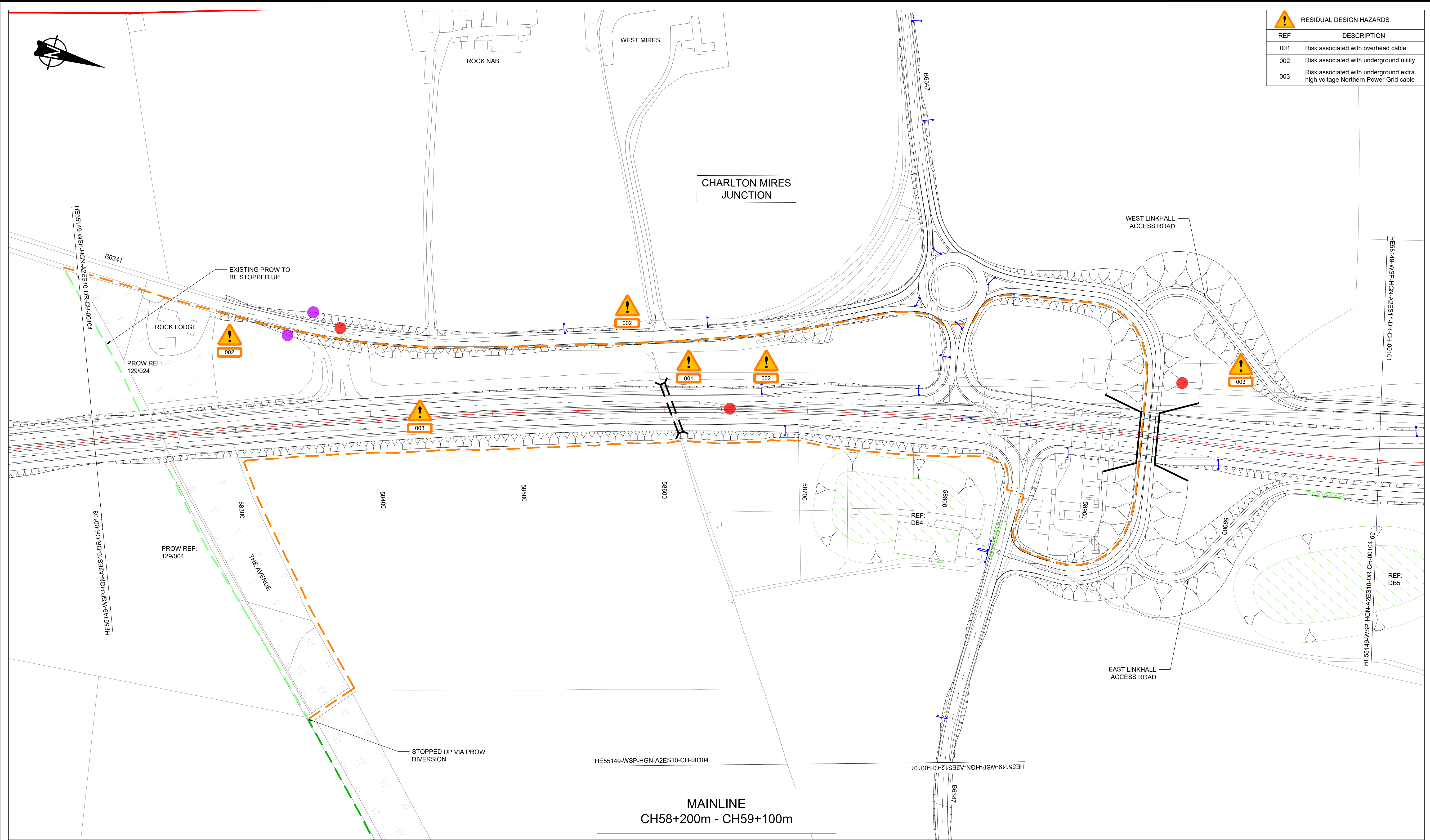

RESIDUAL DESIGN HAZARDS	
REF	DESCRIPTION
001	Risk associated with overhead cable
002	Risk associated with underground utility
003	Risk associated with underground extra high voltage Northern Power Grid cable

MAINLINE
CH58+200m - CH59+100m

© Crown Copyright and Database Rights 2019 Ordnance Survey 100030649

KEY:

	Proposed Road Alignment		Scheme Boundary (Extent of Environmental Assessment)
	Existing Bridleway		Culvert
	Existing Public Right of Way (to be stopped up)		Public Right of Way. Refer to: http://map.northumberland.gov.uk/prow for details
	Existing Public Right of Way (to be retained)		Maintenance Hardstanding
	Proposed Public Right of Way		Drainage Detention Basin
	Proposed Public Right of Way (constructed to Bridleway standard)		Heritage Site
	Overbridge		Existing Bus Stop to be removed
			Proposed Bus Stop Location
			Proposed Sign (not to scale)

NOTES:

- For full extent of the Scheme Boundary see drawing HE551459-WSP-HGN-A2E-DR-CH-00003.
- For full extent of PROw diversions see drawing HE551459-WSP-HGN-A2E-DR-CH-00068.
- Refer to Design Risk Management Schedule for details of residual design hazards.
- All road markings shown are indicative only.

Rev.	Date	Description	By	Eng' Chk	Disc' Chk	App'd
P01	19/02/19	Design Fix 3 for Statutory Consultation First Issue	NH	TO	GH	DM

For Information

wsp

8 First Street
Manchester
M15 4RP, UK

T+ 44 (0) 161 200 5000
wsp.com

© WSP UK Ltd

Client

highways england

Project Title		A1 in Northumberland Alnwick to Ellingham Scheme			
Drawing Title		General Arrangement Overbridge Location Option 2 - Heckley Fence Sheet 7 of 13 Regulation 5 (2) (o)			
Scale	1:1250	Drawn	NH	Eng. Check	TO
Original Size	A1	Date	19/02/19	Date	19/02/19
Approved	GH	Authorised	DM		
Date	19/02/19	Date	19/02/19	Date	19/02/19
Drawing Number	HE551459	Originator	WSP	Volume	HGN
HE PIN	A2ES10	Location	DR	CH	00104
Design Stage	3	Revision	P01		

DO NOT SCALE

Millimetres

0 10 100

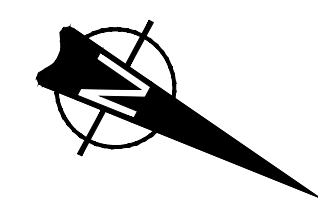

RESIDUAL DESIGN HAZARDS	
REF	DESCRIPTION
002	Risk associated with underground utility
003	Risk associated with underground extra high voltage Northern Power Grid cable

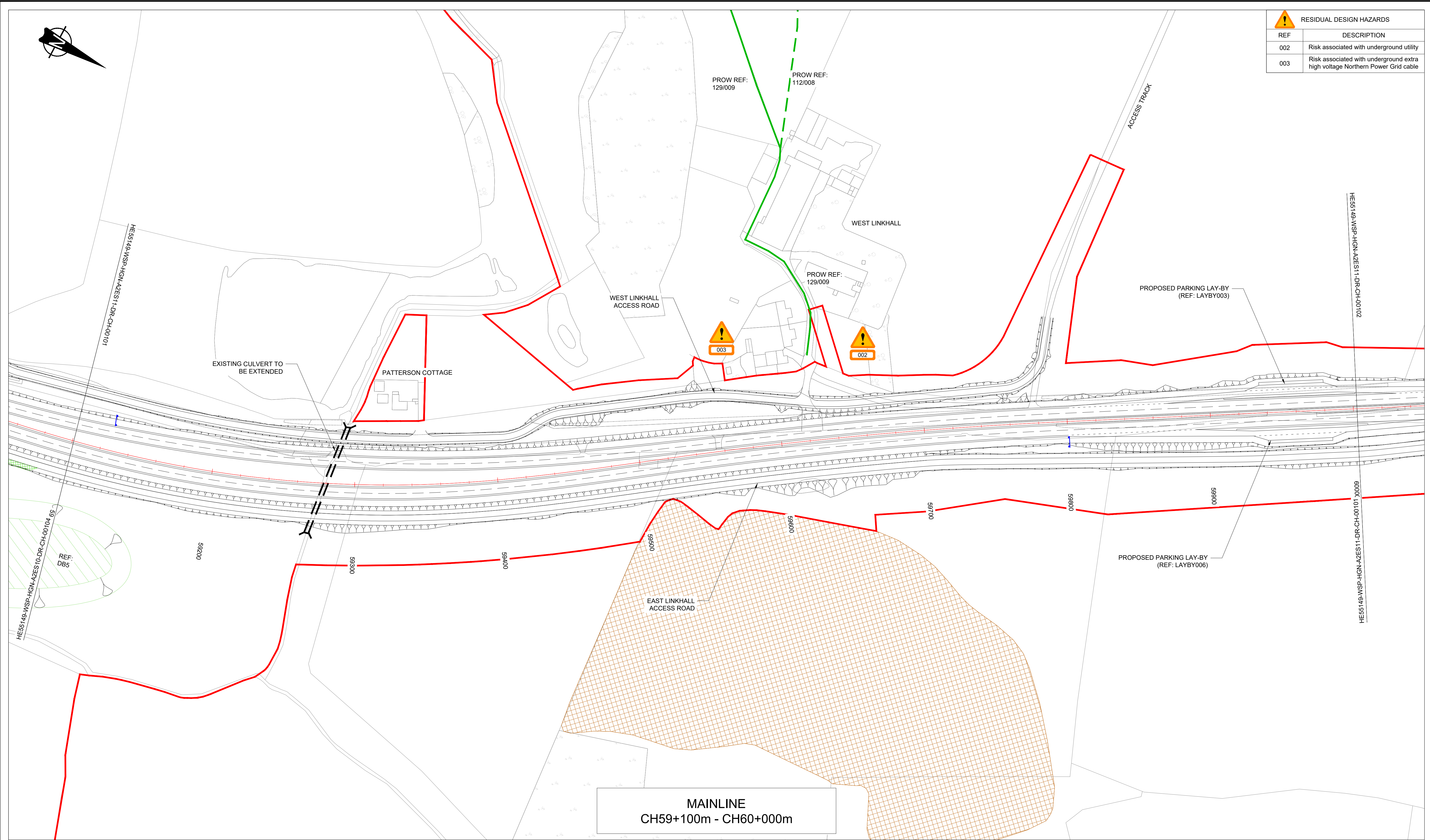

© Crown Copyright and Database Rights 2019 Ordnance Survey 100030649

KEY:

	Proposed Road Alignment		Scheme Boundary (Extent of Environmental Assessment)
	Existing Bridleway		Culvert
	Existing Public Right of Way (to be stopped up)		Public Right of Way. Refer to: http://map.northumberland.gov.uk/prow for details
	Existing Public Right of Way (to be retained)		Maintenance Hardstanding
	Proposed Public Right of Way		Drainage Detention Basin
	Proposed Public Right of Way (constructed to Bridleway standard)		Heritage Site
	Overbridge		Existing Bus Stop to be removed
			Proposed Bus Stop Location
			Proposed Sign (not to scale)

NOTES:

- For full extent of the Scheme Boundary see drawing HE551459-WSP-HGN-A2E-DR-CH-00003.
- For full extent of PRoW diversions see drawing HE551459-WSP-HGN-A2E-DR-CH-00068.
- Refer to Design Risk Management Schedule for details of residual design hazards.
- All road markings shown are indicative only.

Rev.	Date	Description	By	Eng' Chk	Disc' Chk	App'd
P01	19/02/19	Design Fix 3 for Statutory Consultation First Issue	NH	TO	GH	DM

For Information

wsp

8 First Street
Manchester
M15 4RP, UK

T+ 44 (0) 161 200 5000
wsp.com

© WSP UK Ltd

**highways
england**

Suitability	Status	Project Title
For Information	S2	A1 in Northumberland Alnwick to Ellingham Scheme
Drawing Title		
General Arrangement Overbridge Location Option 2 - Heckley Fence Sheet 8 of 13 Regulation 5 (2) (o)		
Scale	Drawn	Eng. Check
1:1250	NH	TO
Original Size	Date	Date
A1	19/02/19	19/02/19
Approved	Authorised	
GH	DM	
Date	Date	
19/02/19	19/02/19	
Drawing Number	Originator	Volume
HE PIN	WSP	HGN
HE551459		
Location	Type	Role
A2ES11	DR	CH
		00101
		Number
		P01
Design Stage	Revision	
3		

DO NOT SCALE

Millimetres

0 10 100

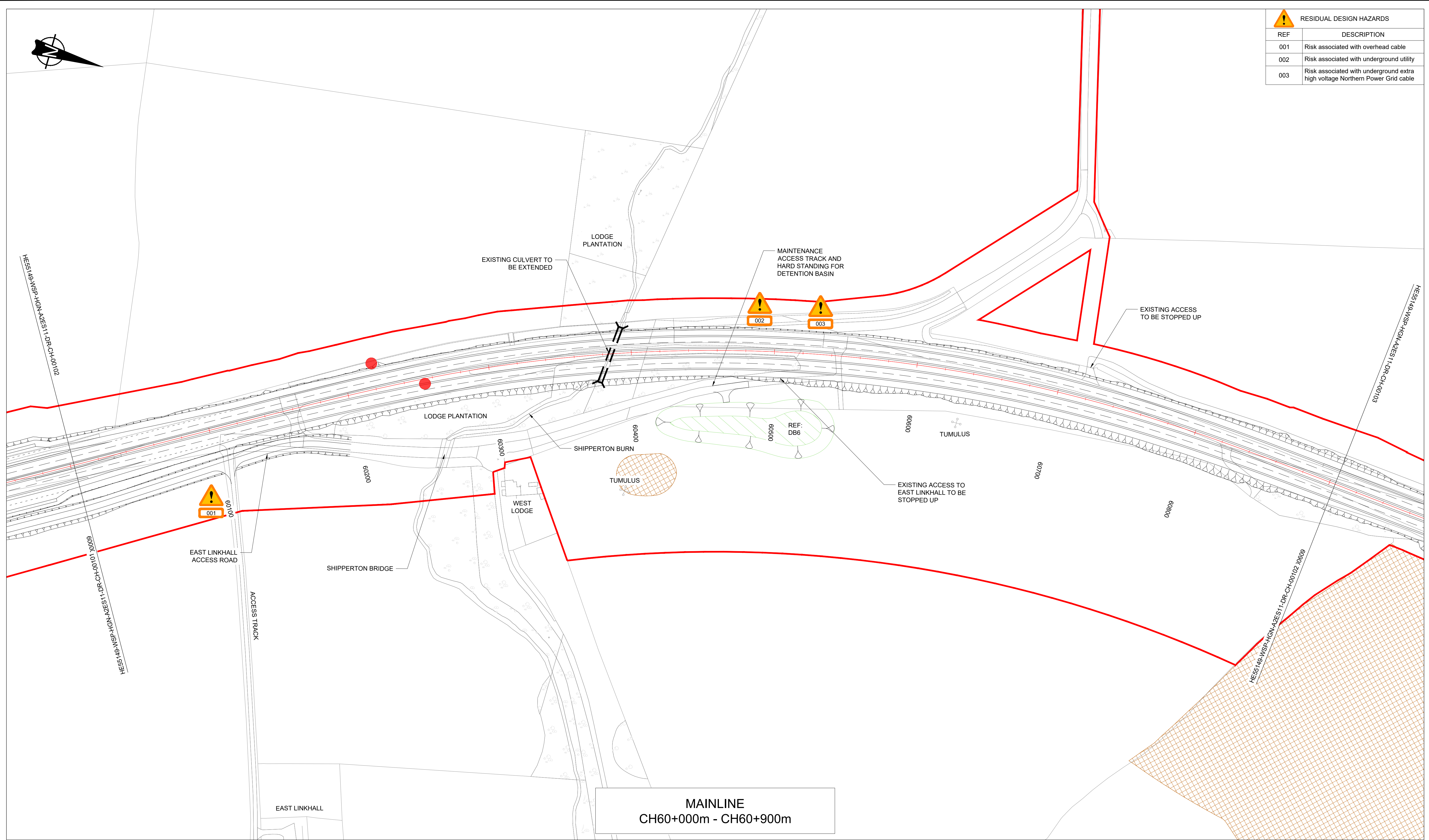

RESIDUAL DESIGN HAZARDS	
REF	DESCRIPTION
001	Risk associated with overhead cable
002	Risk associated with underground utility
003	Risk associated with underground extra high voltage Northern Power Grid cable

MAINLINE
CH60+000m - CH60+900m

© Crown Copyright and Database Rights 2019 Ordnance Survey 100030649

KEY:

	Proposed Road Alignment		Scheme Boundary (Extent of Environmental Assessment)
	Existing Bridleway		Culvert
	Existing Public Right of Way (to be stopped up)		Public Right of Way. Refer to: http://map.northumberland.gov.uk/prow for details
	Existing Public Right of Way (to be retained)		Maintenance Hardstanding
	Proposed Public Right of Way		Drainage Detention Basin
	Proposed Public Right of Way (constructed to Bridleway standard)		Heritage Site
	Overbridge		Existing Bus Stop to be removed
			Proposed Bus Stop Location
			Proposed Sign (not to scale)

NOTES:

- For full extent of the Scheme Boundary see drawing HE551459-WSP-HGN-A2E-DR-CH-00003.
- For full extent of PROW diversions see drawing HE551459-WSP-HGN-A2E-DR-CH-00068.
- Refer to Design Risk Management Schedule for details of residual design hazards.
- All road markings shown are indicative only.

Rev.	Date	Description	By	Eng' Chk	Disc' Chk	App'd
P01	19/02/19	Design Fix 3 for Statutory Consultation First Issue	NH	TO	GH	DM

For Information

wsp

8 First Street
Manchester
M15 4RP, UK

T+ 44 (0) 161 200 5000
wsp.com

© WSP UK Ltd

**highways
england**

Project Title		A1 in Northumberland Alnwick to Ellingham Scheme			
Drawing Title		General Arrangement Overbridge Location Option 2 - Heckley Fence Sheet 9 of 13 Regulation 5 (2) (o)			
Scale	1:1250	Drawn	NH	Eng. Check	TO
Original Size	A1	Date	19/02/19	Date	19/02/19
Approved	GH	Date	19/02/19	Authorised	DM
Drawing Number	HE PIN	Originator	WSP	Volume	HGN
A2ES11	HE551459	DR	CH	00102	Revision
Location		Type	Role	Number	P01

DO NOT SCALE

100
0 10
Millimetres

RESIDUAL DESIGN HAZARDS	
REF	DESCRIPTION
001	Risk associated with overhead cable
002	Risk associated with underground utility

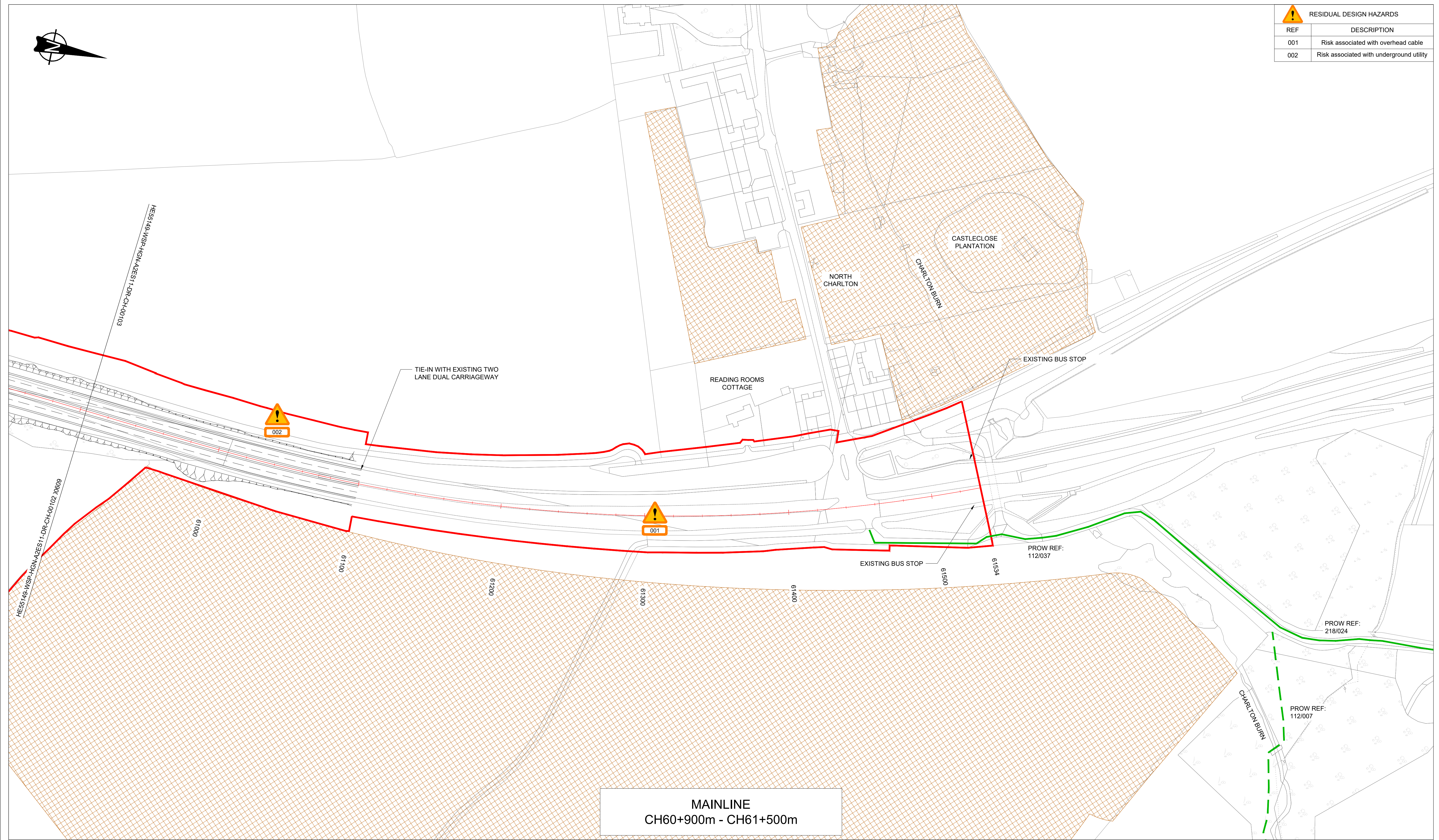

© Crown Copyright and Database Rights 2019 Ordnance Survey 100030649

KEY:

	Proposed Road Alignment		Scheme Boundary (Extent of Environmental Assessment)
	Existing Bridleway		Culvert
	Existing Public Right of Way (to be stopped up)		Public Right of Way. Refer to: http://map.northumberland.gov.uk/prow for details
	Existing Public Right of Way (to be retained)		Maintenance Hardstanding
	Proposed Public Right of Way		Drainage Detention Basin
	Proposed Public Right of Way (constructed to Bridleway standard)		Heritage Site
	Overbridge		Existing Bus Stop to be removed
			Proposed Bus Stop Location
			Proposed Sign (not to scale)

NOTES:

- For full extent of the Scheme Boundary see drawing HE551459-WSP-HGN-A2E-DR-CH-00003.
- For full extent of PRoW diversions see drawing HE551459-WSP-HGN-A2E-DR-CH-00068.
- Refer to Design Risk Management Schedule for details of residual design hazards.
- All road markings shown are indicative only.

Rev.	Date	Description	By	Eng' Chk	Disc' Chk	App'd
P01	19/02/19	Design Fix 3 for Statutory Consultation First Issue	NH	TO	GH	DM

For Information

wsp

8 First Street
Manchester
M15 4RP, UK

T+ 44 (0) 161 200 5000
wsp.com

© WSP UK Ltd

**highways
england**

Suitability	Status	Project Title	
	S2	A1 in Northumberland Alnwick to Ellingham Scheme	
Drawing Title		General Arrangement Overbridge Location Option 2 - Heckley Fence Sheet 10 of 13 Regulation 5 (2) (o)	
Scale	Drawn	Eng. Check	Approved
1:1250	NH	TO	GH
Original Size	Date	Date	Date
A1	19/02/19	19/02/19	19/02/19
Design Number	Originator	Volume	Design Stage
HE551459	WSP	HGN	3
A2ES11	DR	CH	00103
Location	Type	Role	Number
			P01

DO NOT SCALE

Millimetres

0 10 100



RESIDUAL DESIGN HAZARDS	
REF	DESCRIPTION
001	Risk associated with overhead cable
002	Risk associated with underground utility

ROCK SOUTH FARM ACCESS ROAD
CH0+000m - CH0+400m

© Crown Copyright and Database Rights 2019 Ordnance Survey 100030649

KEY:

	Proposed Road Alignment		Scheme Boundary (Extent of Environmental Assessment)
	Existing Bridleway		Culvert
	Existing Public Right of Way (to be stopped up)		Public Right of Way. Refer to: http://map.northumberland.gov.uk/prow for details
	Existing Public Right of Way (to be retained)		Maintenance Hardstanding
	Proposed Public Right of Way		Drainage Detention Basin
	Proposed Public Right of Way (constructed to Bridleway standard)		Heritage Site
	Overbridge		Existing Bus Stop to be removed
			Proposed Bus Stop Location
			Proposed Sign (not to scale)

NOTES:

- For full extent of the Scheme Boundary see drawing HE551459-WSP-HGN-A2E-DR-CH-00003.
- For full extent of PROW diversions see drawing HE551459-WSP-HGN-A2E-DR-CH-00068.
- Refer to Design Risk Management Schedule for details of residual design hazards.
- All road markings shown are indicative only.

Rev	Date	Description	By	Eng' Chk	Disc' Chk	App'd
P01	19/02/19	Design Fix 3 for Statutory Consultation First Issue	NH	TO	GH	DM

For Information

wsp

8 First Street
Manchester
M15 4RP, UK

T+ 44 (0) 161 200 5000
wsp.com

© WSP UK Ltd

**highways
england**

Project Title		A1 in Northumberland Alnwick to Ellingham Scheme			
Drawing Title		General Arrangement Overbridge Location Option 2 - Heckley Fence Sheet 11 of 13 Regulation 5 (2) (o)			
Scale	1:1250	Drawn	NH	Eng. Check	TO
Original Size	A1	Date	19/02/19	Date	19/02/19
Approved	GH	Date	19/02/19	Authorised	DM
Design Number	HE PIN	Originator	Volume	Design Stage	
HE551459	A2ES12	WSP	HGN	3	
Location	Type	Role	Number	Revision	
A1 in Northumberland	DR	CH	00101	P01	

DO NOT SCALE

Millimetres

0 10 100



ROCK SOUTH FARM ACCESS ROAD
CH0+400m - CH1+300m

© Crown Copyright and Database Rights 2019 Ordnance Survey 100030649

KEY:

	Proposed Road Alignment		Scheme Boundary (Extent of Environmental Assessment)
	Existing Bridleway		Culvert
	Existing Public Right of Way (to be stopped up)		Public Right of Way. Refer to: http://map.northumberland.gov.uk/prow for details
	Existing Public Right of Way (to be retained)		Maintenance Hardstanding
	Proposed Public Right of Way		Drainage Detention Basin
	Proposed Public Right of Way (constructed to Bridleway standard)		Heritage Site
	Overbridge		Existing Bus Stop to be removed
			Proposed Bus Stop Location
			Proposed Sign (not to scale)

NOTES:

- For full extent of the Scheme Boundary see drawing HE551459-WSP-HGN-A2E-DR-CH-00003.
- For full extent of PROW diversions see drawing HE551459-WSP-HGN-A2E-DR-CH-00068.
- Refer to Design Risk Management Schedule for details of residual design hazards.
- All road markings shown are indicative only.

Rev.	Date	Description	By	Eng' Chk	Disc' Chk	App'd
P01	19/02/19	Design Fix 3 for Statutory Consultation First Issue	NH	TO	GH	DM

For Information

wsp

8 First Street
Manchester
M15 4RP, UK

T+ 44 (0) 161 200 5000
wsp.com

© WSP UK Ltd

highways england

Project Title	A1 in Northumberland Alnwick to Ellingham Scheme				
Drawing Title	General Arrangement Overbridge Location Option 2 - Heckley Fence Sheet 12 of 13 Regulation 5 (2) (o)				
Scale	1:1250	Drawn	NH	Eng. Check	TO
Original Size	A1	Date	19/02/19	Date	19/02/19
Approved	GH	Authorised	DM	Date	19/02/19
Drawing Number	HE551459	Originator	WSP	Volume	HGN
Location	A2ES12	Type	DR	CH	00102
Revision	3	Revision	P01	Number	

DO NOT SCALE

100
0 10
Millimetres

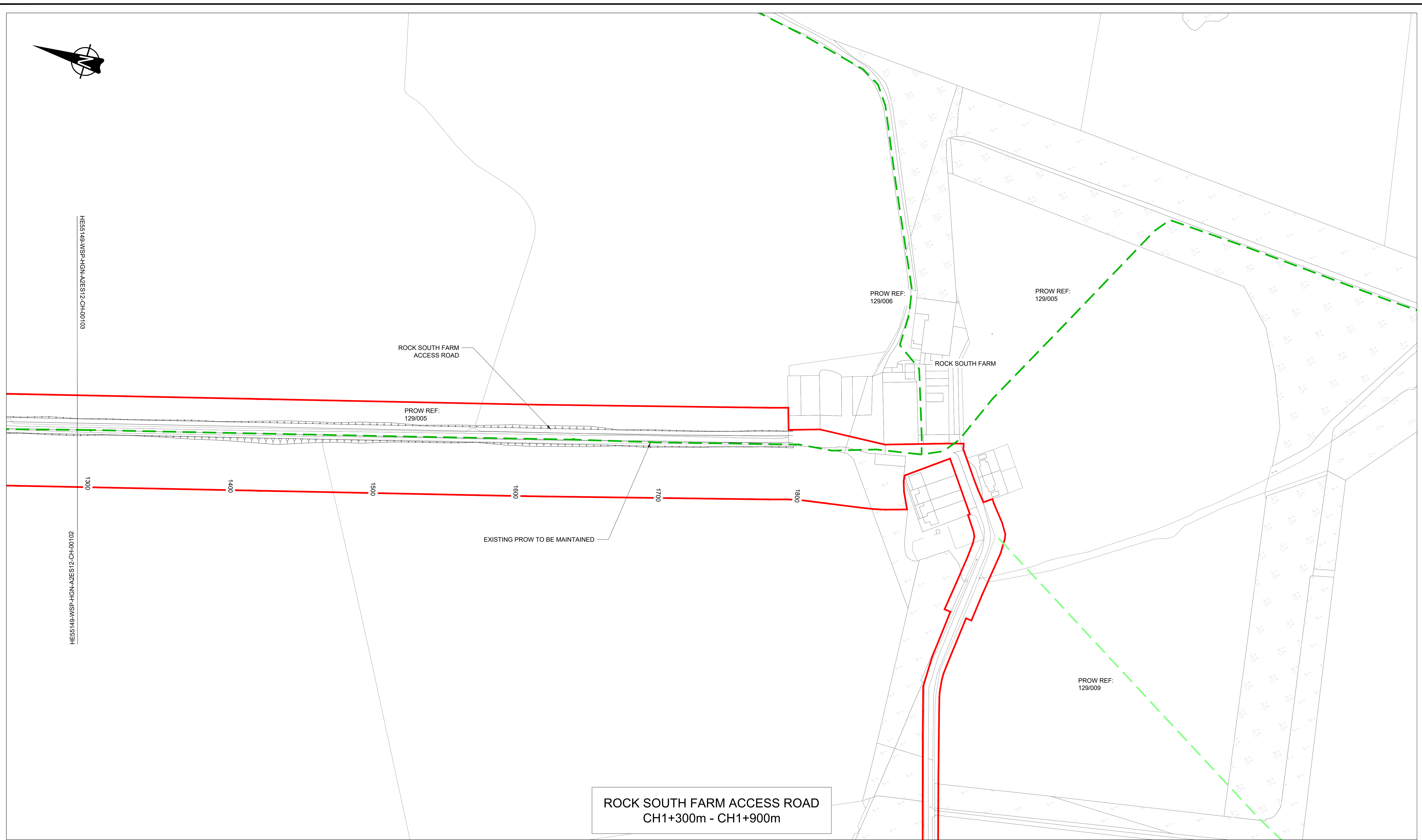

ROCK SOUTH FARM ACCESS ROAD
CH1+300m - CH1+900m

© Crown Copyright and Database Rights 2019 Ordnance Survey 100030649

KEY:

	Proposed Road Alignment		Scheme Boundary (Extent of Environmental Assessment)
	Existing Bridleway		Culvert
	Existing Public Right of Way (to be stopped up)		Public Right of Way. Refer to: http://map.northumberland.gov.uk/prow for details
	Existing Public Right of Way (to be retained)		Maintenance Hardstanding
	Proposed Public Right of Way		Drainage Detention Basin
	Proposed Public Right of Way (constructed to Bridleway standard)		Heritage Site
	Overbridge		Existing Bus Stop to be removed
			Proposed Bus Stop Location
			Proposed Sign (not to scale)

NOTES:

- For full extent of the Scheme Boundary see drawing HE551459-WSP-HGN-A2E-DR-CH-00003.
- For full extent of PRoW diversions see drawing HE551459-WSP-HGN-A2E-DR-CH-00068.
- Refer to Design Risk Management Schedule for details of residual design hazards.
- All road markings shown are indicative only.

Rev.	Date	Description	By	Eng' Chk	Disc' Chk	App'd
P01	19/02/19	Design Fix 3 for Statutory Consultation First Issue	NH	TO	GH	DM

For Information

wsp

8 First Street
Manchester
M15 4RP, UK

T+ 44 (0) 161 200 5000
wsp.com

© WSP UK Ltd

**highways
england**

Suitability		Status		Project Title	
For Information		S2		A1 in Northumberland Alnwick to Ellingham Scheme	
Drawing Title					
General Arrangement Overbridge Location Option 2 - Heckley Fence Sheet 13 of 13 Regulation 5 (2) (o)					
Scale	Drawn	Eng. Check	Approved	Authorised	
1:1250	NH	TO	GH	DM	
Original Size	Date	Date	Date	Date	Date
A1	19/02/19	19/02/19	19/02/19	19/02/19	19/02/19
Drawing Number	Originator		Volume		Design Stage
HE PIN HE551459	WSP		HGN		3
A2ES12	DR	CH	00103	Revision	
Location	Type	Role	Number	P01	