

A12 Chelmsford to A120 widening scheme

**PRELIMINARY ENVIRONMENTAL
INFORMATION REPORT**

**CHAPTER 2 – THE SCHEME
FIGURE 2.1 SECTION 3 OF 3**

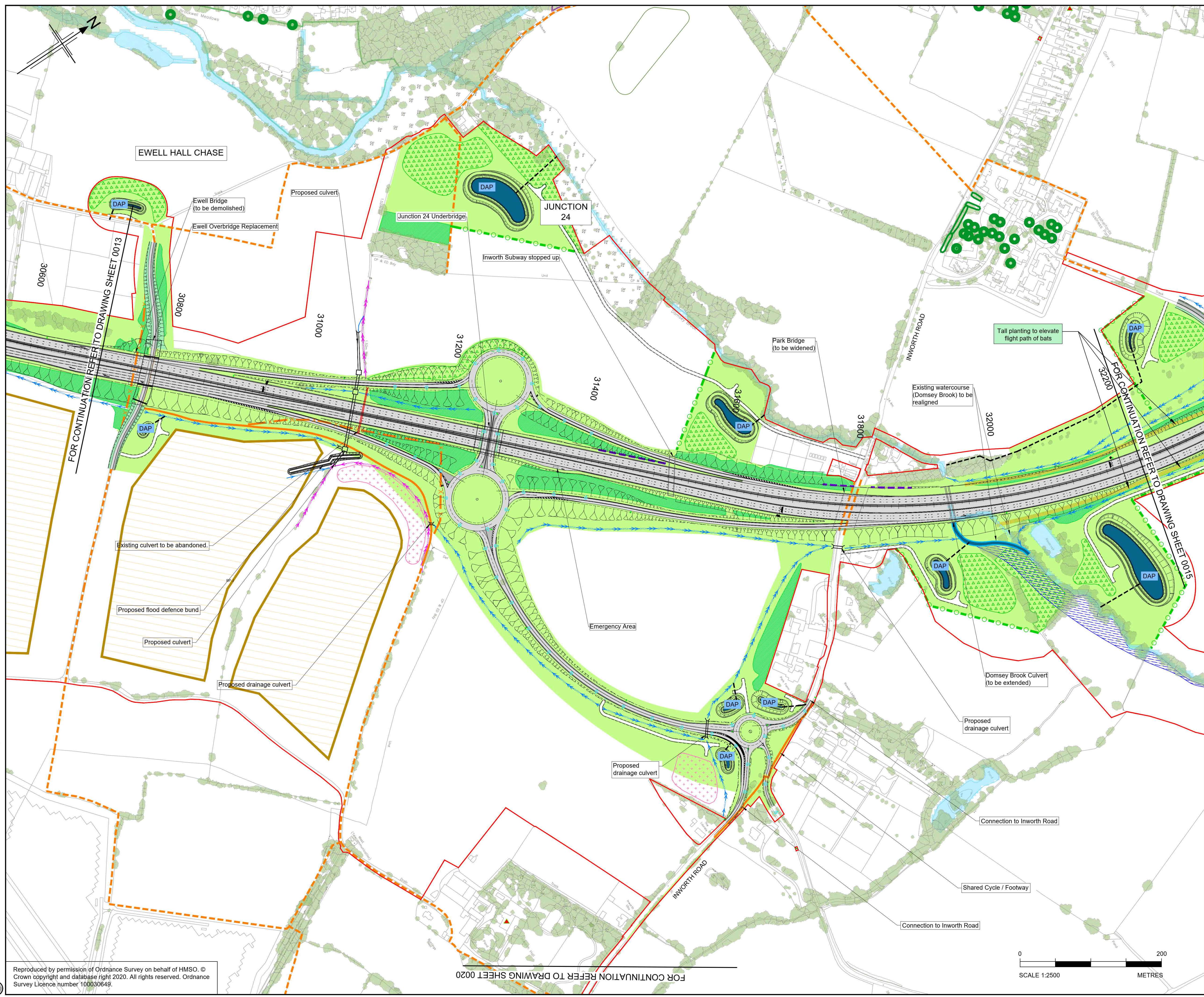

ENVIRONMENTAL TEXT BOX KEY

Landscape	Ecology	Acoustics
Water	Heritage	Contaminated Land

DRAINAGE KEY

- DAP: Proposed drainage attenuation and water treatment pond - Outfall designed to environmental best practice.
- Underground storage units
- Flood mitigation areas
- Proposed floodplain compensation area (minor watercourse)

EXISTING

- Open water
- Retained trees, hedges and shrubs
- Ancient woodland
- Ancient, noble and veteran trees
- Conservation areas
- Local nature reserve
- Listed buildings
- Registered parks and gardens
- Scheduled monument
- Trees protected by Tree Preservation Order (area or individual tree)

PROPOSED

- Woodland planting of trees and shrubs
- Wet woodlands
- Tall screening planting to elevate flight path of bats & barn owls
- Individual trees
- Hedge with intermittent trees
- Grassland
- Grassland with intermittent trees and shrubs
- Ecology mitigation area / Ecology protection measures
- Ecological pond (indicative symbol)
- Noise barrier location / Acoustic barrier
- Existing public right of way / walking, cycling and horse-riding user route - stopped up
- New/realigned public right of way / walking, cycling and horse-riding user route
- Proposed borrow pit

KEY PLAN
SCALE N.T.S.

P01	25/05/21	ORIGINAL ISSUE	HA	HM	HM	RC
Rev	Rev. Date	Purpose of revision	Drawn	Checked	Rev'd	Appr'd

Contractor: **COSTAIN** Designer: **JACOBS**
2nd Floor Cottons Centre, Cottons Lane
London SE1 2QG. Tel: +44 (0)203 9802000
www.jacobs.com

Client: **highways england**

Project: **REGIONAL DELIVERY PARTNERSHIP**
A12 CHELMSFORD TO A120 WIDENING SCHEME

Drawing title: **FIGURE 2.1 PRELIMINARY ENVIRONMENTAL DESIGN**
CH. 30700 TO 32200
SHEET 14 OF 19

Drawing status: **S4 - SUITABLE FOR STAGE APPROVAL**

State Code	Preliminary	DO NOT SCALE
Project Stage	PCF3	Rev
Scale	1:2500	P01
Jacobs No.	B36601D1	
Client no.	HE551497	

Drawing number: **HE551497 - JAC - ELS - SCHW - DR - L - 0014**

Originator: **JAC** Volume: **ELS**
Location: **SCHW** Type: **DR** Role: **L** Number: **0014**

© Copyright 2021 Jacobs UK Limited. The concepts and information contained in this document are the property of Jacobs. No copying or reuse of this document in whole or in part without the written permission of Jacobs constitutes an infringement of copyright. Limitation: This drawing has been prepared on behalf of, and for the exclusive use of, Jacobs Client, and is subject to, and issued in accordance with, the provisions of the contract between Jacobs and the Client. Jacobs accepts no liability or responsibility whatsoever for, or in respect of, any use of, or reliance upon, this drawing by any third party.

C:\Users\Aldermah\Desktop\A12\Exports\HE551497 - JAC - ELS - SCHW - DR - L - 0014.dwg - 26/05/2021 11:56:30 - A1Frame - Aldermah

Reproduced by permission of Ordnance Survey on behalf of HMSO. © Crown copyright and database right 2020. All rights reserved. Ordnance Survey Licence number 100030649.

FOR CONTINUATION REFER TO DRAWING SHEET 0020

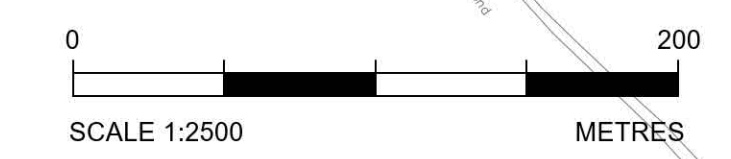

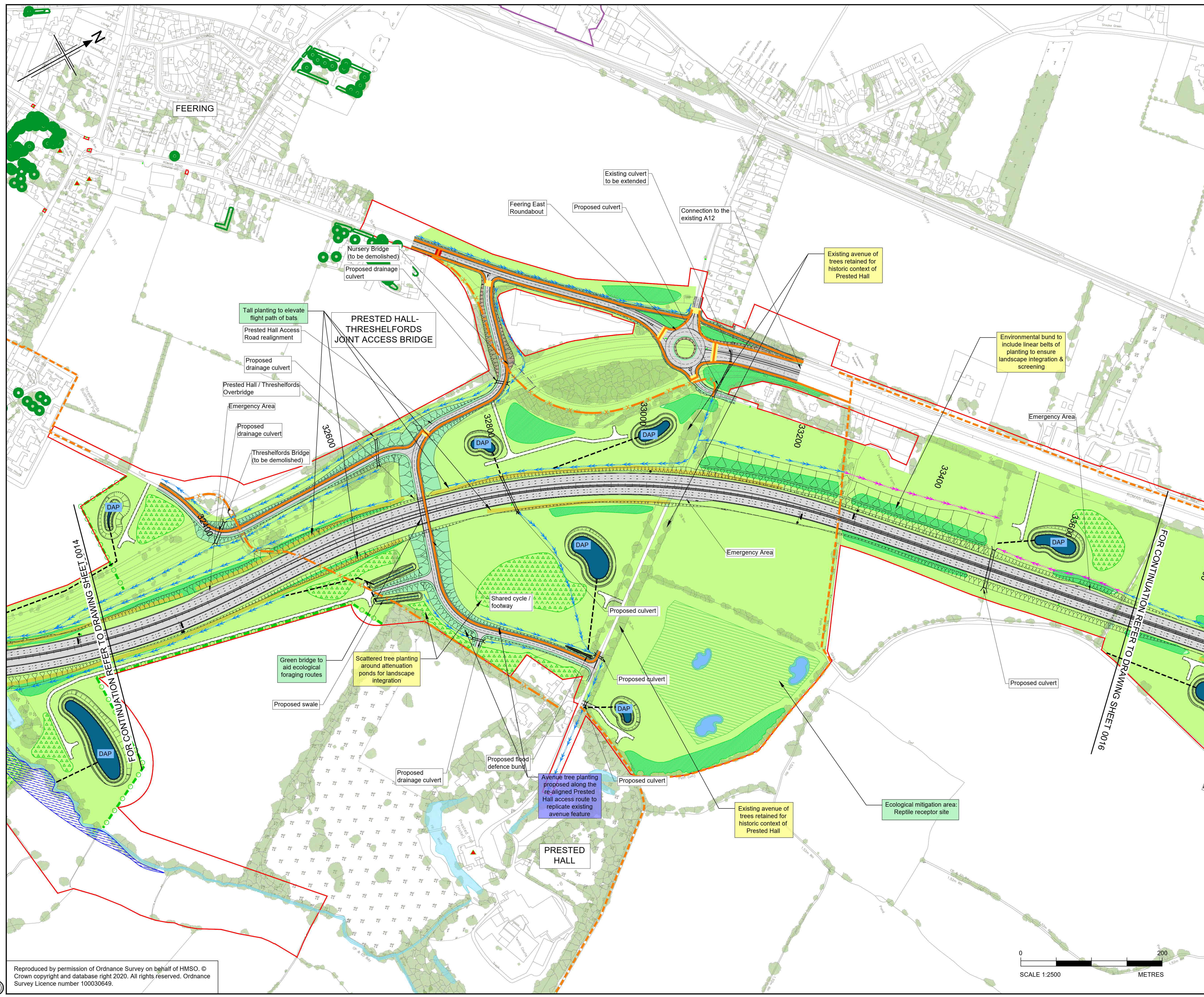

ENVIRONMENTAL TEXT BOX KEY

Landscape	Ecology	Acoustics
Water	Heritage	Contaminated Land

DRAINAGE KEY

- DAP: Proposed drainage attenuation and water treatment pond - Outfall designed to environmental best practice.
- Underground storage units
- Flood mitigation areas
- Proposed floodplain compensation area (minor watercourse)

EXISTING

- Open water
- Retained trees, hedges and shrubs
- Ancient woodland
- Ancient, noble and veteran trees
- Conservation areas
- Local nature reserve
- Listed buildings
- Registered parks and gardens
- Scheduled monument
- Trees protected by Tree Preservation Order (area or individual tree)
- Existing public right of way / walking, cycling and horse-riding user route

PROPOSED

- Woodland planting of trees and shrubs
- Wet woodlands
- Tall screen planting to elevate flight path of bats & barn owls
- Individual trees
- Hedge with intermittent trees
- Grassland
- Grassland with intermittent trees and shrubs
- Ecology mitigation area / Ecology protection measures
- Ecological pond (indicative symbol)
- Noise barrier location / Acoustic barrier
- Existing public right of way / walking, cycling and horse-riding user route - stopped up
- New/realigned public right of way / walking, cycling and horse-riding user route
- Proposed borrow pit

KEY PLAN
SCALE N.T.S.

P01	25/05/21	ORIGINAL ISSUE	HA	HM	HM	RC
Rev	Rev. Date	Purpose of revision	Drawn	Checked	Rev'd	Apprv'd
Contractor:		Designer:				
COSTAIN		Jacobs 2nd Floor Coltons Centre, Coltons Lane London SE1 2QJ. Tel: +44 (0)203 9802000 www.jacobs.com				
Client: highways england						

Project: REGIONAL DELIVERY PARTNERSHIP
A12 CHELMSFORD TO A120 WIDENING SCHEME

FIGURE 2.1 PRELIMINARY ENVIRONMENTAL DESIGN
CH. 32200 TO 33700
SHEET 15 OF 19

Drawing status:	S4 - SUITABLE FOR STAGE APPROVAL		
State Code:	Preliminary		
Project Stage:	PCF3		
Scale:	1:2500	DO NOT SCALE	
Jacobs No.:	B36801D1	Rev	P01
Client no.:	HE551497		

Drawing number:	HE551497 - JAC - ELS - SCHW	Originator:	JAC	Volume:	-DR- L -0015
Location:	SCHW	Type:	DR	Role:	L
Number:	-0015				

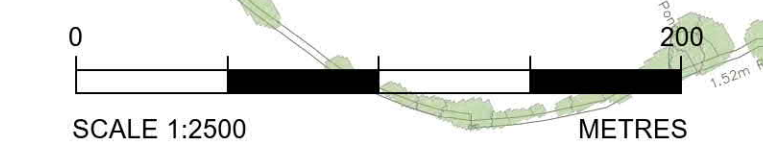

C:\Users\Aldermah\Desktop\A12\Exports\HE551497 - JAC - ELS - SCHW - DR - L -0015.dwg - 26/05/2021 12:16:40 - A1Frame - Aldermah

Reproduced by permission of Ordnance Survey on behalf of HMSO. © Crown copyright and database right 2020. All rights reserved. Ordnance Survey Licence number 100030649.

© Copyright 2021 Jacobs U.K. Limited. The concepts and information contained in this document are the property of Jacobs. Use or copying of this document in whole or in part without the written permission of Jacobs constitutes an infringement of copyright. Limitation: This drawing has been prepared on behalf of, and for the exclusive use of Jacobs' Client, and is subject to, and issued in accordance with, the provisions of the contract between Jacobs and the Client. Jacobs accepts no liability or responsibility whatsoever, for or in respect of, any use of, or reliance upon, this drawing by any third party.

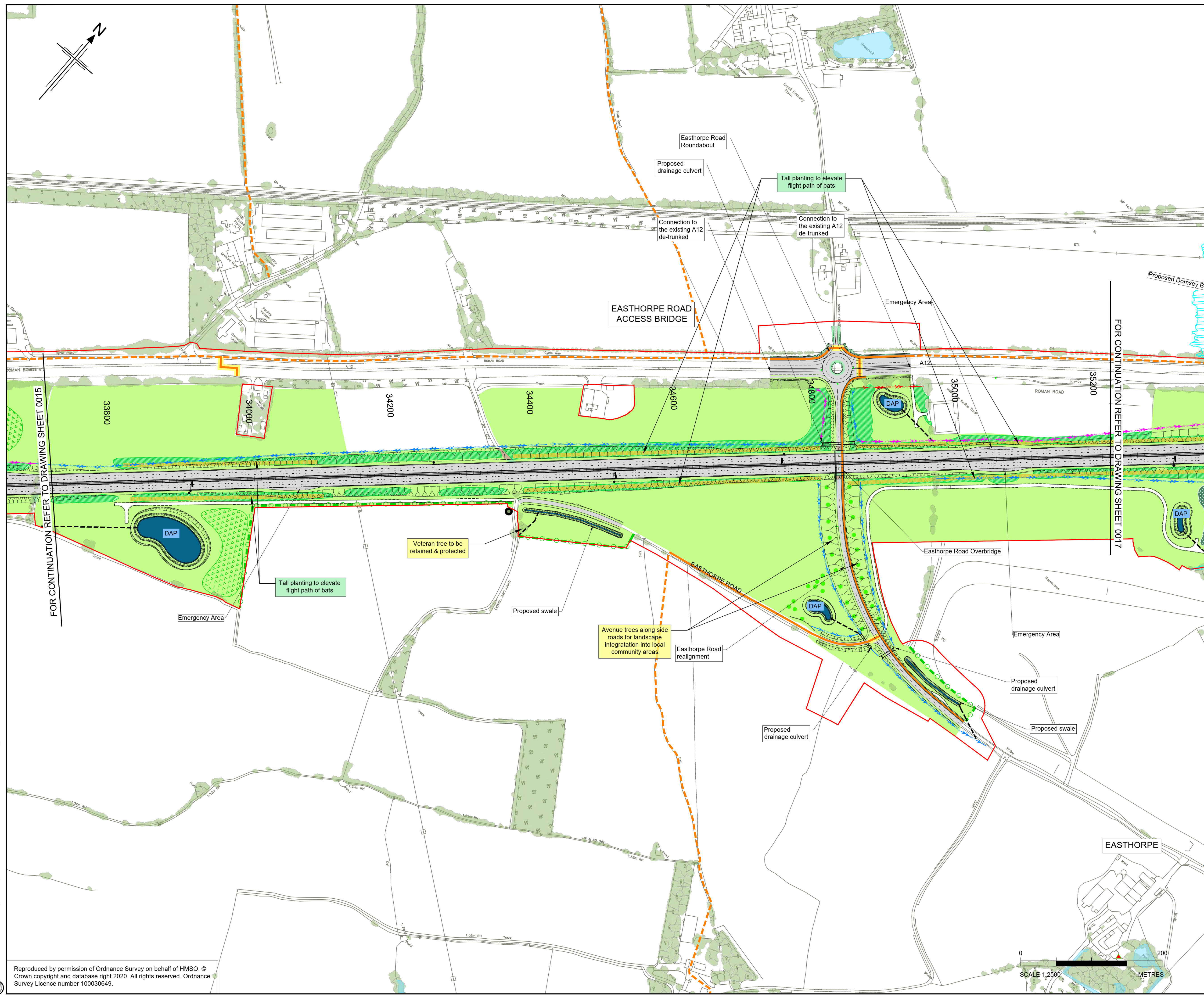

ENVIRONMENTAL TEXT BOX KEY

Landscape	Ecology	Acoustics
Water	Heritage	Contaminated Land

DRAINAGE KEY

- DAP: Proposed drainage attenuation and water treatment pond - Outfall designed to environmental best practice.
- Underground storage units
- Flood mitigation areas
- Proposed floodplain compensation area (minor watercourse)

EXISTING

- Open water
- Retained trees, hedges and shrubs
- Ancient woodland
- Ancient, noble and veteran trees
- Conservation areas
- Local nature reserve
- Listed buildings
- Registered parks and gardens
- Scheduled monument
- Trees protected by Tree Preservation Order (area or individual tree)

PROPOSED

- Woodland planting of trees and shrubs
- Wet woodlands
- Tall screen planting to elevate flight path of bats & barn owls
- Individual trees
- Hedge with intermittent trees
- Grassland
- Grassland with intermittent trees and shrubs
- Ecology mitigation area / Ecology protection measures
- Ecological pond (indicative symbol)
- Noise barrier location / Acoustic barrier
- Existing public right of way / walking, cycling and horse-riding user route - stopped up
- New/realigned public right of way / walking, cycling and horse-riding user route
- Proposed borrow pit

KEY PLAN
SCALE N.T.S.

P01	25/05/21	ORIGINAL ISSUE	HA	HM	HM	RC
Rev	Rev. Date	Purpose of revision	Drawn	Checked	Rev'd	Appr'd

Contractor: **COSTAIN** Designer: **Jacobs**
2nd Floor Cottons Centre, Cottons Lane
London SE1 2Q3. Tel: +44 (0)203 9802000
www.jacobs.com

Client: **highways england**

Project: **REGIONAL DELIVERY PARTNERSHIP**
A12 CHELMSFORD TO A120 WIDENING SCHEME

Drawing title: **FIGURE 2.1 PRELIMINARY ENVIRONMENTAL DESIGN**
CH. 33700 TO 35200
SHEET 16 OF 19

Drawing status: **S4 - SUITABLE FOR STAGE APPROVAL**

State Code	Preliminary	
Project Stage	PCF3	DO NOT SCALE
Scale	1:2500	Rev
Jacobs No.	B36801D1	P01
Client no.	HE551497	

Drawing number: **HE551497 - JAC - ELS - SCHW - DR - L - 0016**

Originator: **JAC** Volume: **ELS**
Location: **SCHW** Type: **DR** Role: **L** Number: **0016**

C:\Users\Aldermah\Desktop\A12\Exports\HE551497 - JAC - ELS - SCHW - DR - L - 0016.dwg - 26/05/2021 11:29:14 - A1Frame - Aldermah

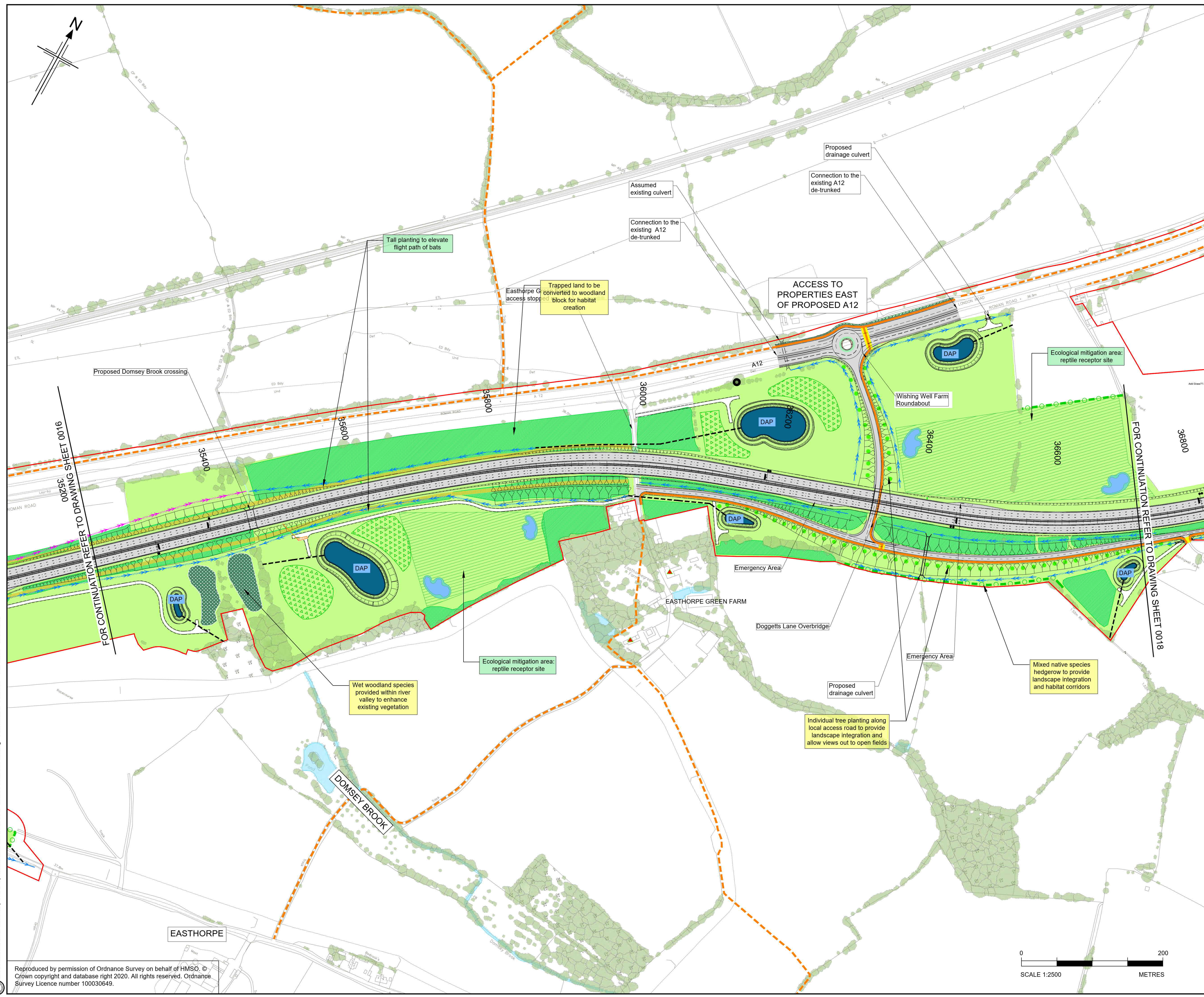

ENVIRONMENTAL TEXT BOX KEY

Landscape	Ecology	Acoustics
Water	Heritage	Contaminated Land

DRAINAGE KEY

- DAP: Proposed drainage attenuation and water treatment pond - Outfall designed to environmental best practice.
- Underground storage units
- Flood mitigation areas
- Proposed floodplain compensation area (minor watercourse)

EXISTING

- Open water
- Retained trees, hedges and shrubs
- Ancient woodland
- Ancient, noble and veteran trees
- Conservation areas
- Local nature reserve
- Listed buildings
- Registered parks and gardens
- Scheduled monument
- Trees protected by Tree Preservation Order (area or individual tree)
- Existing public right of way / walking, cycling and horse-riding user route

PROPOSED

- Woodland planting of trees and shrubs
- Wet woodlands
- Tall screen planting to elevate flight path of bats & barn owls
- Individual trees
- Hedge with intermittent trees
- Grassland
- Grassland with intermittent trees and shrubs
- Ecology mitigation area / Ecology protection measures
- Ecological pond (indicative symbol)
- Noise barrier location / Acoustic barrier
- Existing public right of way / walking, cycling and horse-riding user route - stopped up
- New/realigned public right of way / walking, cycling and horse-riding user route
- Proposed borrow pit

KEY PLAN
SCALE N.T.S.

P01	25/05/21	ORIGINAL ISSUE	HA	HM	HM	RC
Rev	Rev. Date	Purpose of revision	Drawn	Checked	Rev'd	Apprv'd

Contractor: **COSTAIN** Designer: **JACOBS**
2nd Floor Coltons Centre, Coltons Lane, London SE1 2QG, Tel: +44 (0)203 9802000, www.jacobs.com

Client: **highways england**

Project: **REGIONAL DELIVERY PARTNERSHIP**
A12 CHELMSFORD TO A120 WIDENING SCHEME

Drawing title: **FIGURE 2.1 PRELIMINARY ENVIRONMENTAL DESIGN**
CH. 35200 TO 36700
SHEET 17 OF 19

Drawing status: **S4 - SUITABLE FOR STAGE APPROVAL**

State Code	Preliminary
Project Stage	PCF3
Scale	1:2500
Jacobs No.	B36601D1
Client no.	HE551497

Drawing number: **HE551497 - JAC - ELS - SCHW - DR - L - 0017**

Originator: **JAC** Volume: **ELS**
Location: **SCHW** Type: **DR** Role: **L** Number: **0017**

Reproduced by permission of Ordnance Survey on behalf of HMSO. © Crown copyright and database right 2020. All rights reserved. Ordnance Survey Licence number 100030649.

© Copyright 2021 Jacobs U.K. Limited. The concepts and information contained in this document are the property of Jacobs. Use or copying of this document in whole or in part without the written permission of Jacobs constitutes an infringement of copyright. Limitation: This drawing has been prepared on behalf of and for the exclusive use of Jacobs' Client, and is subject to, and issued in accordance with, the provisions of the contract between Jacobs and the Client. Jacobs accepts no liability or responsibility whatsoever for, or in respect of, any use of, or reliance upon, this drawing by any third party.

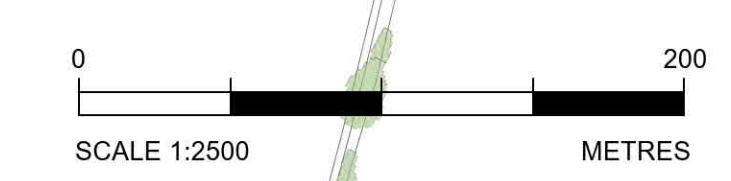

C:\Users\Aldermah\Desktop\A12\Exports\HE551497-JAC-ELS-SCHW-DR-L-0017.dwg -- 26/05/2021 16:49:07 - A1Frame - Aldermah

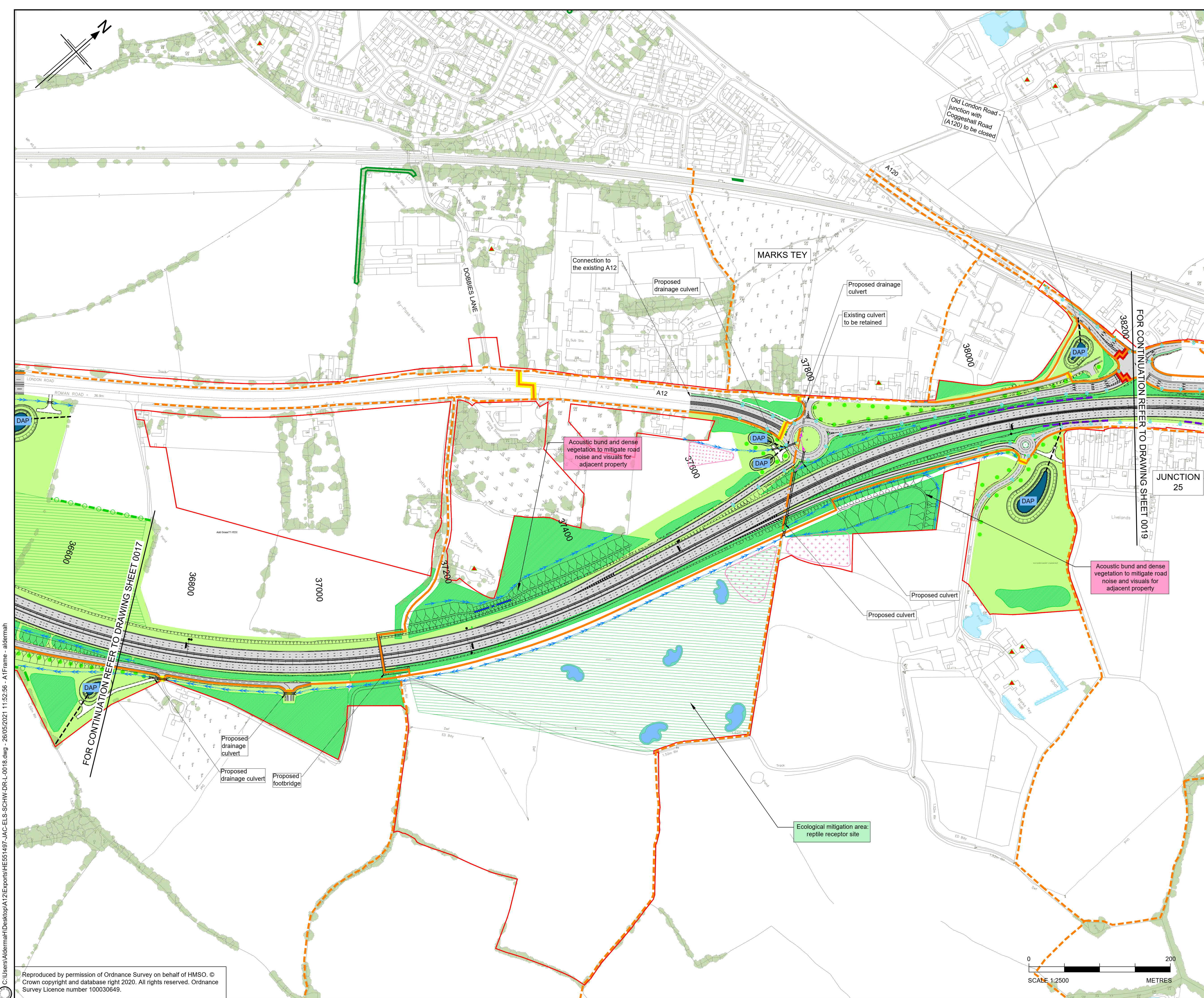

ENVIRONMENTAL TEXT BOX KEY

Landscape	Ecology	Acoustics
Water	Heritage	Contaminated Land

DRAINAGE KEY

- DAP: Proposed drainage attenuation and water treatment pond - Outfall designed to environmental best practice.
- Underground storage units
- Flood mitigation areas
- Proposed floodplain compensation area (minor watercourse)

EXISTING

- Open water
- Retained trees, hedges and shrubs
- Ancient woodland
- Ancient, noble and veteran trees
- Conservation areas
- Local nature reserve
- Listed buildings
- Registered parks and gardens
- Scheduled monument
- Trees protected by Tree Preservation Order (area or individual tree)

PROPOSED

- Woodland planting of trees and shrubs
- Wet woodlands
- Tall screen planting to elevate flight path of bats & barn owls
- Individual trees
- Hedge with intermittent trees
- Grassland
- Grassland with intermittent trees and shrubs
- Ecology mitigation area / Ecology protection measures
- Ecological pond (indicative symbol)
- Noise barrier location / Acoustic barrier
- Existing public right of way / walking, cycling and horse-riding user route - stopped up
- New/realigned public right of way / walking, cycling and horse-riding user route
- Proposed borrow pit

KEY PLAN
SCALE N.T.S.

PD1	25/05/21	ORIGINAL ISSUE	HA	HM	HM	RC
Rev	Rev. Date	Purpose of revision	Drawn	Checked	Rev'd	Apprv'd

Contractor: **COSTAIN** Designer: **Jacobs**
2nd Floor Coltons Centre, Coltons Lane
London SE1 2QG. Tel: +44 (0)203 9802000
www.jacobs.com

Client: **highways england**

Project: **REGIONAL DELIVERY PARTNERSHIP
A12 CHELMSFORD TO A120 WIDENING SCHEME**

Drawing title: **FIGURE 2.1 PRELIMINARY
ENVIRONMENTAL DESIGN
CH. 36700 TO 38200
SHEET 18 OF 19**

Drawing status: **S4 - SUITABLE FOR STAGE APPROVAL**

State Code	Preliminary
Project Stage	PCF3
Scale	1:2500
Jacobs No.	B36601D1
Client no.	HE551497

Drawing number	PM	Originator	Volume
HE551497 -	JAC	- ELS -	
Location	Type	Role	Number
SCHW	-DR-	L	-0018

© Copyright 2021 Jacobs U.K. Limited. The concepts and information contained in this document are the property of Jacobs. Use or copying of this document in whole or in part without the written permission of Jacobs constitutes an infringement of copyright. Limitation: This drawing has been prepared on behalf of and for the exclusive use of Jacobs' Client, and is subject to, and issued in accordance with, the provisions of the contract between Jacobs and the Client. Jacobs accepts no liability or responsibility whatsoever for, or in respect of, any use of, or reliance upon, this drawing by any third party.

C:\Users\AlderMah\Desktop\A12\Exports\HE551497-JAC-ELS-SCHW-DR-L-0018.dwg -- 26/05/2021 11:52:56 - A1Frame - aldermah

Reproduced by permission of Ordnance Survey on behalf of HMSO. © Crown copyright and database right 2020. All rights reserved. Ordnance Survey Licence number 100030649.

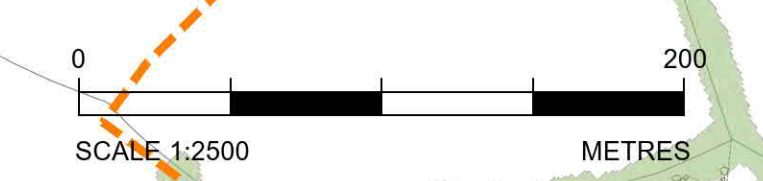

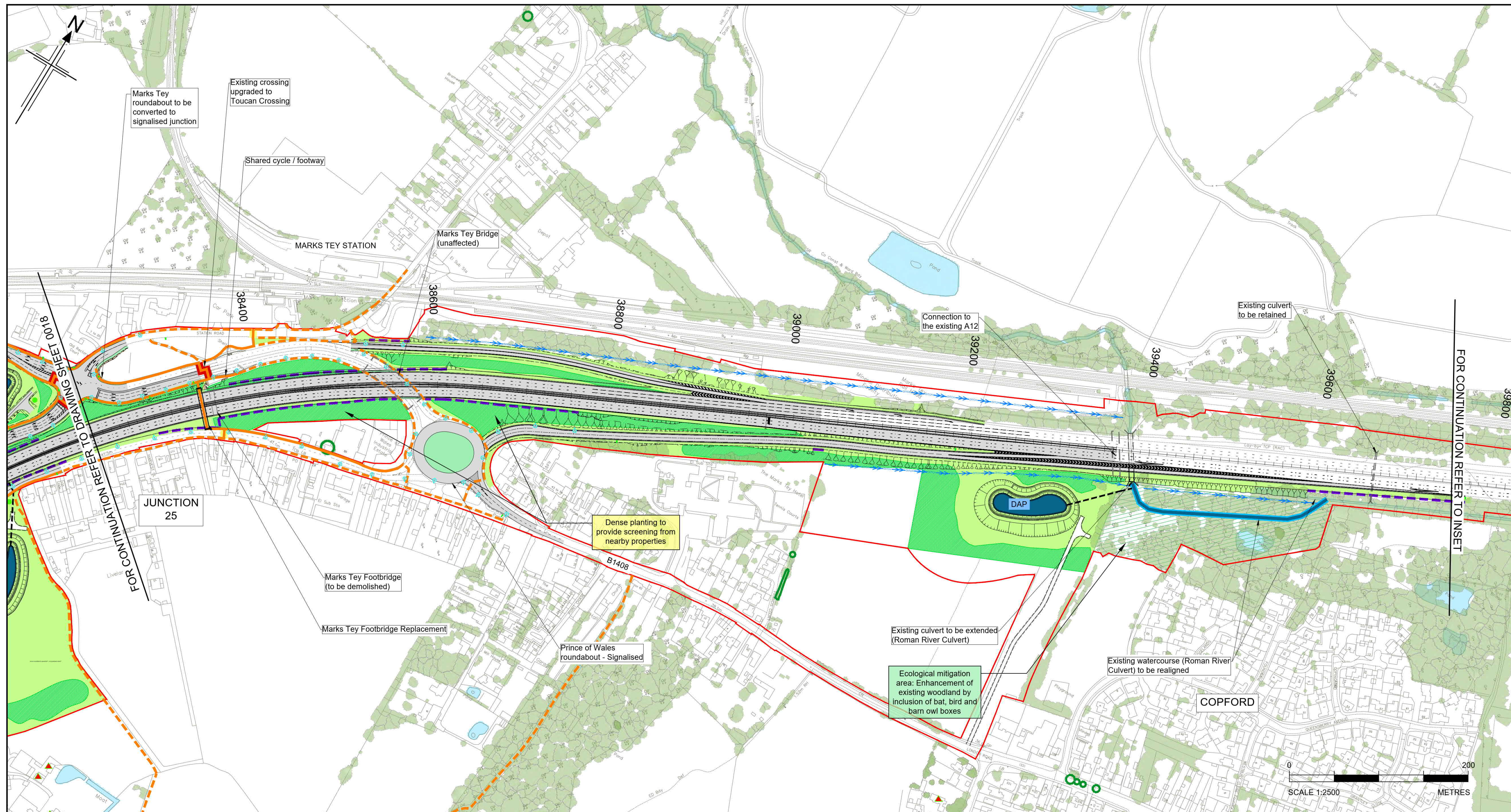

- ENVIRONMENTAL TEXT BOX KEY**
- Landscape
 - Ecology
 - Acoustics
 - Water
 - Heritage
 - Contaminated Land
- DRAINAGE KEY**
- DAP: Proposed drainage attenuation and water treatment pond - Outfall designed to environmental best practice.
 - Underground storage units
 - Flood mitigation areas
 - Proposed floodplain compensation area (minor watercourse)
- EXISTING**
- Open water
 - Retained trees, hedges and shrubs
 - Ancient woodland
 - Ancient, noble and veteran trees
 - Conservation areas
 - Local nature reserve
 - Listed buildings
 - Registered parks and gardens
 - Scheduled monument
 - Trees protected by Tree Preservation Order (area or individual tree)
 - Existing public right of way / walking, cycling and horse-riding user route
- PROPOSED**
- Woodland planting of trees and shrubs
 - Wet woodlands
 - Tall screen planting to elevate flight path of bats & barn owls
 - Individual trees
 - Hedge with intermittent trees
 - Grassland
 - Grassland with intermittent trees and shrubs
 - Ecology mitigation area / Ecology protection measures
 - Ecological pond (indicative symbol)
 - Noise barrier location / Acoustic barrier
 - Existing public right of way / walking, cycling and horse-riding user route - stopped up
 - New/realigned public right of way / walking, cycling and horse-riding user route
 - Proposed borrow pit

KEY PLAN
SCALE N.T.S.

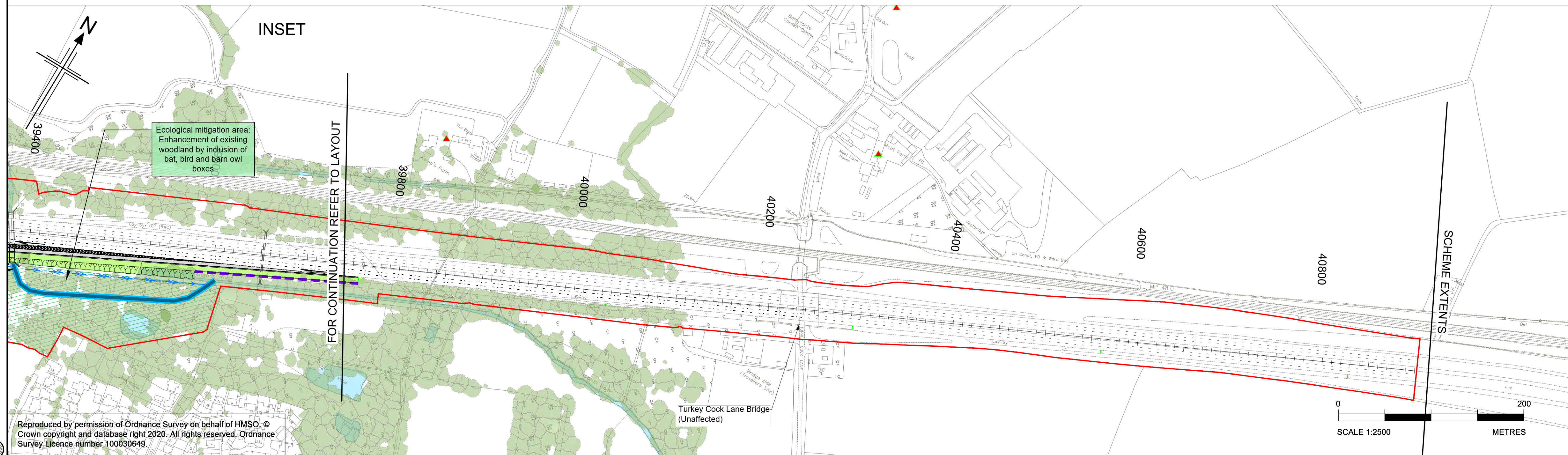
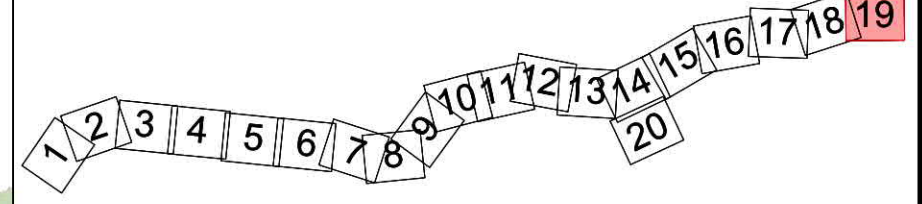

PD1	25/05/21	ORIGINAL ISSUE	HA	HM	HM	RC
Rev	Rev. Date	Purpose of revision	Drawn	Checked	Rev'd	Apprv'd
Contractor: COSTAIN			Designer: Jacobs 2nd Floor Coltons Centre, Coltons Lane London SE1 2QG, Tel: +44 (0)203 9802000 www.jacobs.com			
Client: highways england						
Project: REGIONAL DELIVERY PARTNERSHIP A12 CHELMSFORD TO A120 WIDENING SCHEME						
Drawing title: FIGURE 2.1 PRELIMINARY ENVIRONMENTAL DESIGN CH. 38200 TO 39355 SHEET 19 OF 19						
Drawing status: S4 - SUITABLE FOR STAGE APPROVAL						
State Code	Preliminary					
Project Stage	PCF3					
Scale	1:2500					DO NOT SCALE
Jacobs No.	B36601D1					Rev
Client no.	HE551497					P01
Drawing number	PM	Originator	JAC	Volume	ELS	Number
HE551497 -						
Location	SCHW		Type	Role	Number	
					-DR- L -0019	

C:\Users\Aldermah\Desktop\A12\Exports\HE551497 - JAC - ELS - SCHW - DR - L - 0019.dwg - 26/05/2021 17:16:55 - A1Frame - Aldermah

Reproduced by permission of Ordnance Survey on behalf of HMSO. © Crown copyright and database right 2020. All rights reserved. Ordnance Survey Licence number 100030649.

© Copyright 2021 Jacobs U.K. Limited. The concepts and information contained in this document are the property of Jacobs. Use or copying of this document in whole or in part without the written permission of Jacobs constitutes an infringement of copyright. Limitation: This drawing has been prepared on behalf of and for the exclusive use of Jacobs' Client, and is subject to, and issued in accordance with, the provisions of the contract between Jacobs and the Client. Jacobs accepts no liability or responsibility whatsoever for, or in respect of, any use of, or reliance upon, this drawing by any third party.