

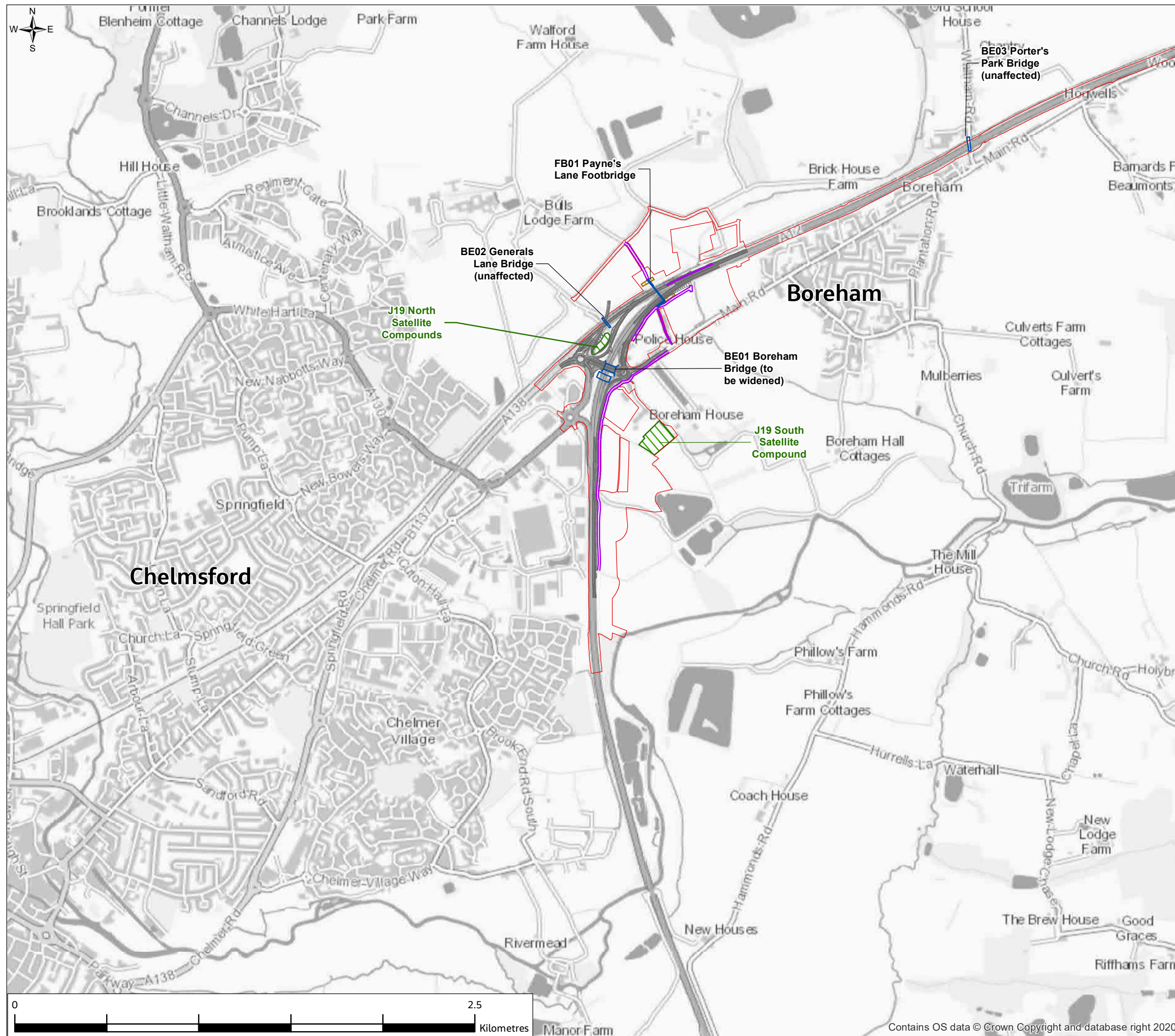
**A12 Chelmsford to A120 widening scheme**

**PRELIMINARY ENVIRONMENTAL  
INFORMATION REPORT**

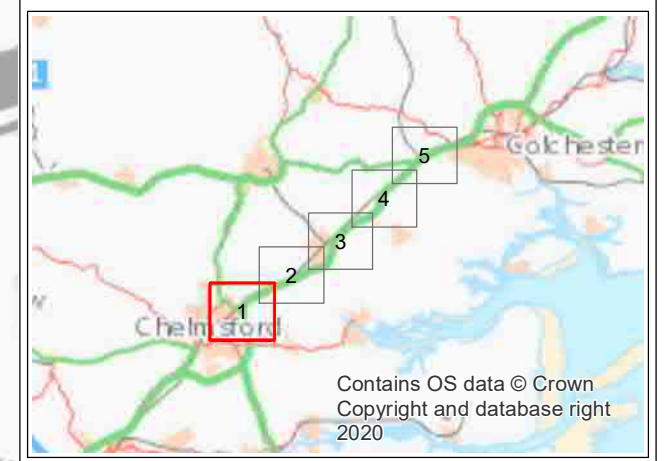
**CHAPTER 2 – THE SCHEME**

**FIGURE 2.2**

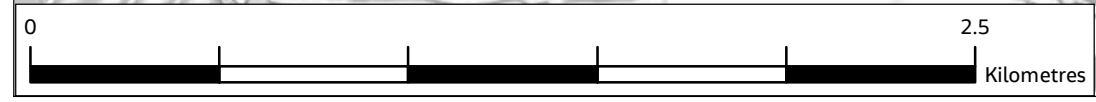
**FIGURE 2.2**



- Legend**
- Provisional Order Limits
  - Proposed Scheme
  - Structures
  - Indicative Haul Routes (Temporary Road)
  - Borrow Pits
  - Main Compounds
  - Indicative Satellite Compounds (subject to archaeological investigation)
  - Indicative Laydowns, Logistics and Welfare Compounds (subject to archaeological investigation)
- BE – Existing bridge  
 FB – Footbridge  
 BN – New bridge  
 CE – Existing culvert  
 BP – Borrow pit

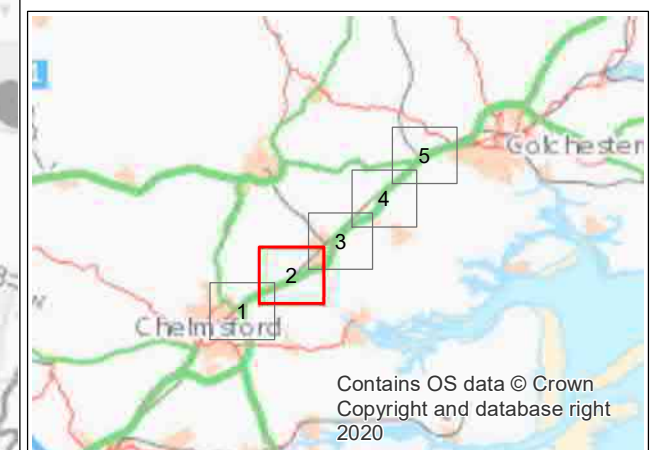
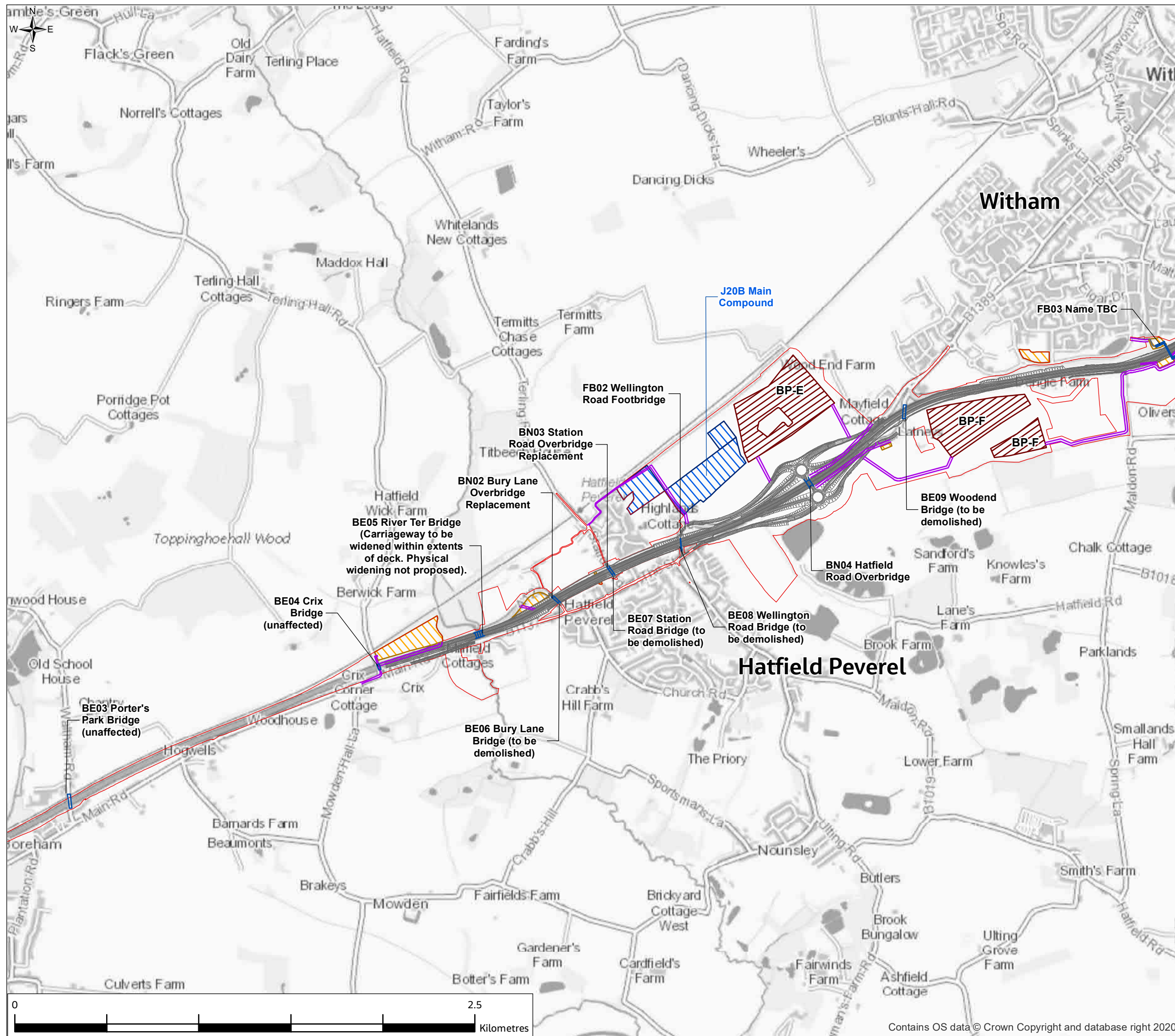


P01	5/05/21	For consultation	JC	SM	SM	SG
Rev.	Rev. Date	Purpose of revision	Drawn	Check'd	Rev'd	Appr'd
Contractor			Designer			
			 Cottons Centre, Cottons Lane, London, SE1 2QG, UK Tel: +44 (0)20 3980 2000 www.jacobs.com			
Client						
Project						
A12 CHELMSFORD TO A120 WIDENING SCHEME						
Drawing Title						
PEIR TEMPORARY WORKING AREAS, SIDE ROADS AND STRUCTURES SHEET 1 OF 5						
Drawing Number						
S4 - SUITABLE FOR STAGE APPROVAL						
Scale @ A3		1:20000	DO NOT SCALE			
Jacobs No.		B36601D1	Rev P01			
Client No.		HE551497				
Drawing Number						
HE551497-JAC-EGN-SCHW-SK-GI-0004						

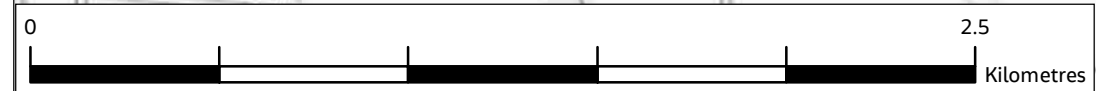


**FIGURE 2.2**

- Legend**
- Provisional Order Limits
  - Proposed Scheme
  - Structures
  - Indicative Haul Routes (Temporary Road)
  - Borrow Pits
  - Main Compounds
  - Indicative Satellite Compounds (subject to archaeological investigation)
  - Indicative Laydowns, Logistics and Welfare Compounds (subject to archaeological investigation)
- BE – Existing bridge  
 FB – Footbridge  
 BN – New bridge  
 CE – Existing culvert  
 BP – Borrow pit

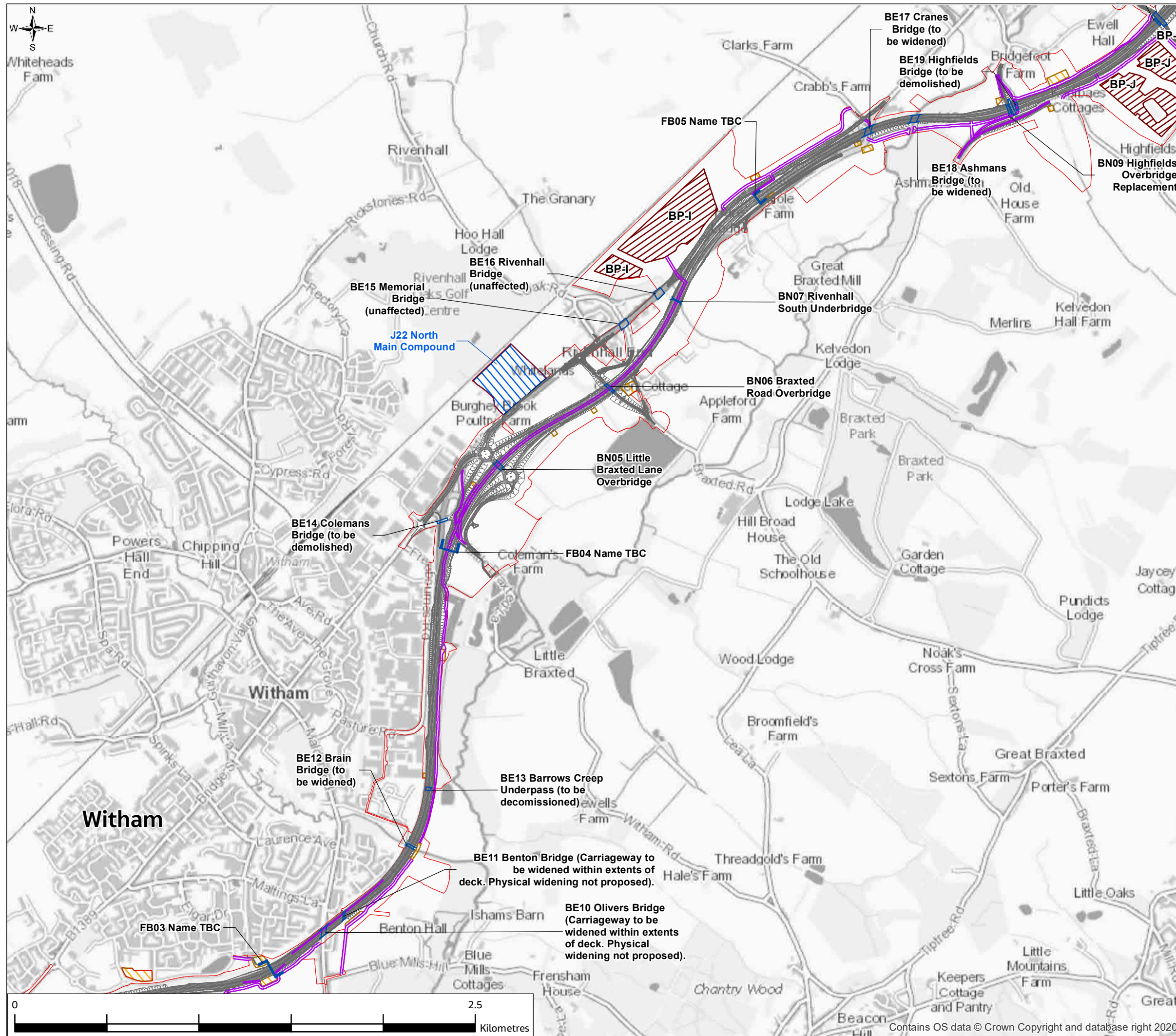


P01	5/05/21	For consultation	JC	SM	SM	SG
Rev.	Rev. Date	Purpose of revision	Drawn	Check'd	Rev'd	Appr'd
Contractor			Designer			
			 Cottons Centre, Cottons Lane, London, SE1 2QG, UK. Tel: +44 (0)20 3980 2000 www.jacobs.com			
Client						
Project						
A12 CHELMSFORD TO A120 WIDENING SCHEME						
Drawing Title						
PEIR TEMPORARY WORKING AREAS, SIDE ROADS AND STRUCTURES SHEET 2 OF 5						
Drawing Status						
S4 - SUITABLE FOR STAGE APPROVAL						
Scale @ A3		1:20000		DO NOT SCALE		
Jacobs No.		B36601D1		Rev P01		
Client No.		HE551497				
Drawing Number						
HE551497-JAC-EGN-SCHW-SK-GI-0005						



© Copyright 2021 Jacobs U.K. Limited. The concepts and information contained in this document are the property of Jacobs. Use or copying of this document in whole or in part without the written permission of Jacobs constitutes an infringement of copyright. Limitation: This drawing has been prepared on behalf of, and for the exclusive use of Jacobs' Client, and is subject to, and issued in accordance with, the provisions of the contract between Jacobs and the Client. Jacobs accepts no liability or responsibility whatsoever for, in respect of any use of, or reliance upon, this drawing by any third party.

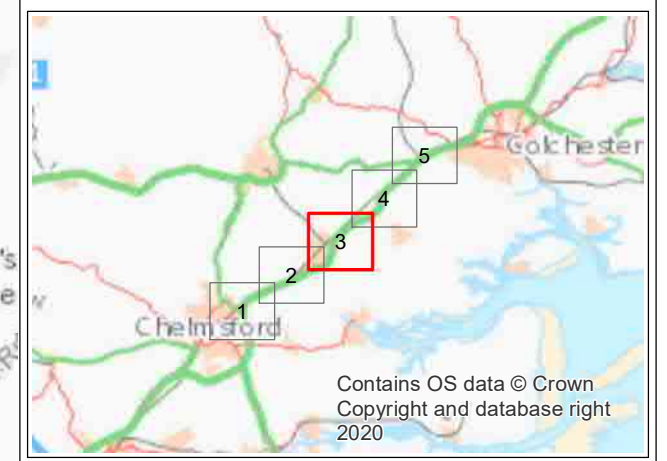
**FIGURE 2.2**



**Legend**

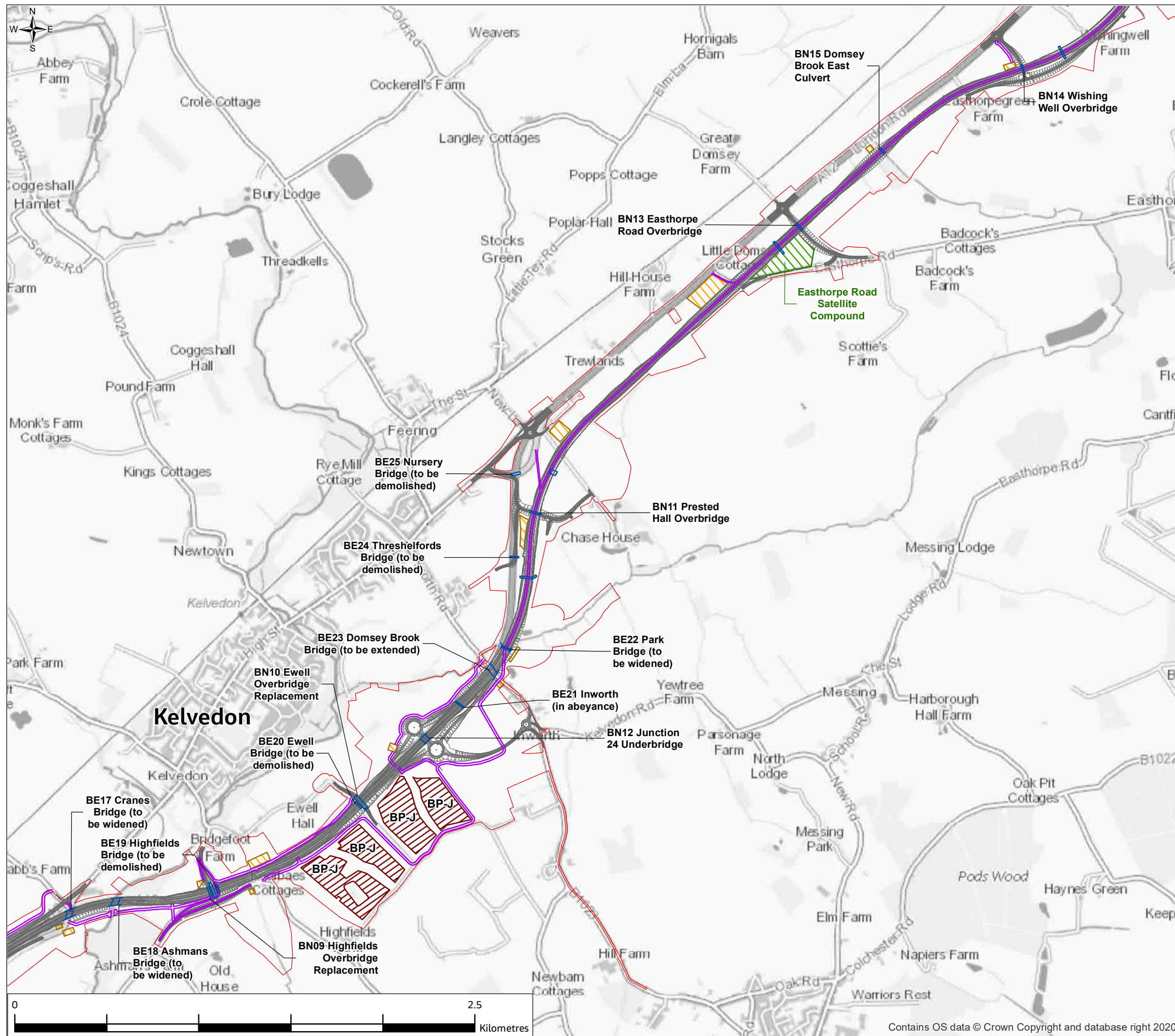
- Provisional Order Limits
- Proposed Scheme
- Structures
- Indicative Haul Routes (Temporary Road)
- Borrow Pits
- Main Compounds
- Indicative Satellite Compounds (subject to archaeological investigation)
- Indicative Laydowns, Logistics and Welfare Compounds (subject to archaeological investigation)

BE – Existing bridge  
 FB – Footbridge  
 BN – New bridge  
 CE – Existing culvert  
 BP – Borrow pit



PO1	5/05/21	For consultation	JC	SM	SM	SG
Rev.	Rev. Date	Purpose of revision	Drawn	Check'd	Rev'd	Appr'd
Contractor			Designer			
			 Cottons Centre, Cottons Lane, London, SE1 2QG, UK. Tel: +44 (0)20 3980 2000 www.jacobs.com			
Client						
Project						
A12 CHELMSFORD TO A120 WIDENING SCHEME						
Drawing Title						
PEIR TEMPORARY WORKING AREAS, SIDE ROADS AND STRUCTURES SHEET 3 OF 5						
Drawing Status						
S4 - SUITABLE FOR STAGE APPROVAL						
Scale @ A3	1:20000					DO NOT SCALE
Jacobs No.	B36601D1					Rev
Client No.	HE551497					P01
Drawing Number						
HE551497-JAC-EGN-SCHW-SK-GI-0006						

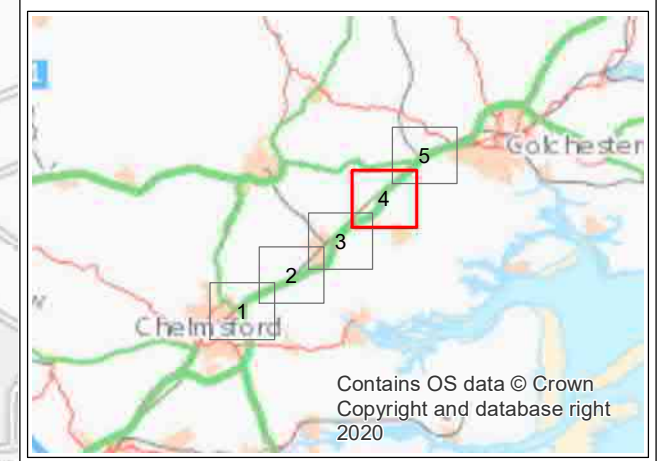
**FIGURE 2.2**



**Legend**

- Provisional Order Limits
- Proposed Scheme
- Structures
- Indicative Haul Routes (Temporary Road)
- Borrow Pits
- Main Compounds
- Indicative Satellite Compounds (subject to archaeological investigation)
- Indicative Laydowns, Logistics and Welfare Compounds (subject to archaeological investigation)

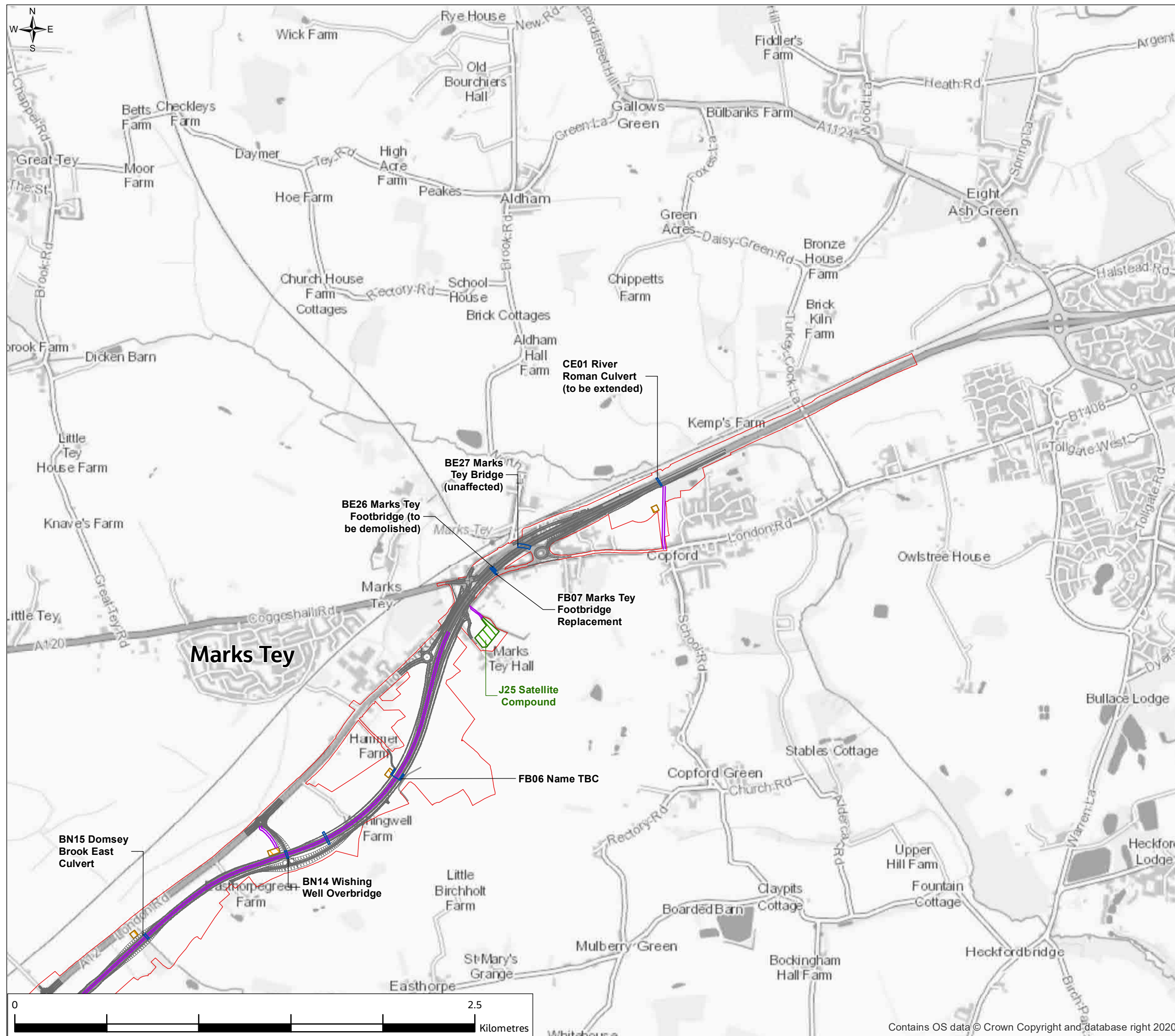
BE – Existing bridge  
 FB – Footbridge  
 BN – New bridge  
 CE – Existing culvert  
 BP – Borrow pit



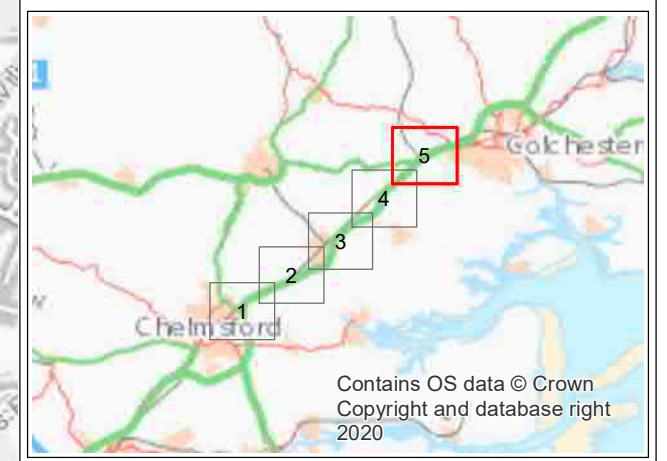
P01	5/05/21	For consultation	JC	SM	SM	SG
Rev.	Rev. Date	Purpose of revision	Drawn	Check'd	Rev'd	Appr'd
Contractor			Designer			
Client						
Project						
A12 CHELMSFORD TO A120 WIDENING SCHEME						
Drawing Title						
PEIR TEMPORARY WORKING AREAS, SIDE ROADS AND STRUCTURES SHEET 4 OF 5						
Drawing Status						
S4 - SUITABLE FOR STAGE APPROVAL						
Scale @ A3	1:20000					DO NOT SCALE
Jacobs No.	B36601D1					Rev
Client No.	HE551497					P01
Drawing Number						
HE551497-JAC-EGN-SCHW-SK-GI-0007						

© Copyright 2021 Jacobs U.K. Limited. The concepts and information contained in this document are the property of Jacobs. Use or copying of this document in whole or in part without the written permission of Jacobs constitutes an infringement of copyright. Limitation: This drawing has been prepared on behalf of, and for the exclusive use of Jacobs' Client, and is subject to, and issued in accordance with, the provisions of the contract between Jacobs and the Client. Jacobs accepts no liability or responsibility whatsoever for, or in respect of, any use of, or reliance upon, this drawing by any third party.

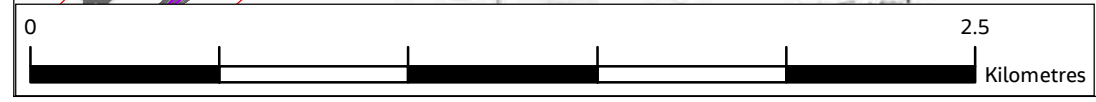
**FIGURE 2.2**



- Legend**
- Provisional Order Limits
  - Proposed Scheme
  - Structures
  - Indicative Haul Routes (Temporary Road)
  - Borrow Pits
  - Main Compounds
  - Indicative Satellite Compounds (subject to archaeological investigation)
  - Indicative Laydowns, Logistics and Welfare Compounds (subject to archaeological investigation)
- BE – Existing bridge  
 FB – Footbridge  
 BN – New bridge  
 CE – Existing culvert  
 BP – Borrow pit



P01	5/05/21	For consultation	JC	SM	SM	SG
Rev.	Rev. Date	Purpose of revision	Drawn	Check'd	Rev'd	Appr'd
Contractor			Designer			
			 Cottons Centre, Cottons Lane, London, SE1 2QG, UK. Tel: +44 (0)20 3980 2000 www.jacobs.com			
Client						
Project						
A12 CHELMSFORD TO A120 WIDENING SCHEME						
Drawing Title						
PEIR TEMPORARY WORKING AREAS, SIDE ROADS AND STRUCTURES SHEET 5 OF 5						
Drawing Status						
S4 - SUITABLE FOR STAGE APPROVAL						
Scale @ A3			1:20000		DO NOT SCALE	
Jacobs No.			B36601D1		Rev P01	
Client No.			HE551497			
Drawing Number						
HE551497-JAC-EGN-SCHW-SK-GI-0008						



© Copyright 2021 Jacobs U.K. Limited. The concepts and information contained in this document are the property of Jacobs. Use or copying of this document in whole or in part without the written permission of Jacobs constitutes an infringement of copyright. Limitation: This drawing has been prepared on behalf of, and for the exclusive use of Jacobs' Client, and is subject to, and issued in accordance with, the provisions of the contract between Jacobs and the Client. Jacobs accepts no liability or responsibility whatsoever for, or in respect of, any use of, or reliance upon, this drawing by any third party.