

A12 Chelmsford to A120 widening scheme

TR010060

**DEVELOPMENT CONSENT ORDER CHANGE
APPLICATION CONSULTATION**

**Map Book 3: Replacement Land, Witham
Part 1 of 2**

Rule 113 and 114
Infrastructure Planning (Examination Procedure)
Regulations 2010

April 2023

A12 Chelmsford to A120 widening scheme guide to map book

The six map books prepared for this consultation contain plans of the proposed scheme under the following headings:

- Map Book 1: Junction 19 Slip Road
- Map Book 2: Anglian Water Pumping Station (Bury Lane, Hatfield Peverel)
- Map Book 3: Replacement Land, Witham
- Map Book 4: B1023 Flood Mitigation and Drainage
- Map Book 5: B1023 Roundabout
- Map Book 6: Junction 25

These plans show the changes we have made since our Development Consent Order (DCO) application was accepted for examination in 2022 and are published for the purposes of the consultation on the proposed changes. The proposals are therefore subject to change due to consultation feedback and further design development.

Please read these plans in conjunction with the consultation brochure and technical notes, which provides further information on the consultation and how to respond.

Each map book shows the plans that have been updated to capture the proposed changes in that area. For example, Map Book 1 shows the changes

around the junction 19 slip road and Map Book 6 shows the changes around junction 25.

Map Book 3: Replacement Land, Witham

The Applicant has been made aware of change in ownership of parts of the open space land impacted by the accepted Application. The request for certification therefore needs to change to reflect the changed land ownership. The Applicant has also taken the opportunity to slightly alter the replacement land proposed to be provided to Witham Town Council. The land now proposed is near to the existing Whetmead Local Nature Reserve. No additional land is required, however the purposes for which the land is being used has changed.

A list of plans that have been updated to show this change is included in the following Schedule of Plans. Map Book 3 consists of two parts with the drawings in each part indicated in the table as follows:

- Map Book 3 Part 1
- Map Book 3 Part 2

Drawing Number	Drawing Title	Revision
PART 1		
HE551497-JAC-LDC-SCHW-DR-C-0010	General Arrangement Plans Key Plan	P01
HE551497-JAC-LDC-SCHW-DR-C-0020	General Arrangement Plans Legend	P02
HE551497-JAC-LDC-SCHW-DR-C-0028	General Arrangement Plans Ch. 19600/20000 to Ch. 21400 Sheet 8 of 21	P02
HE551497-JAC-LDC-SCHW-DR-C-0029	General Arrangement Plans Ch. 21400 to Ch. 22600 Sheet 9 of 21	P02
HE551497-ARD-LDC-SCHW-DR-X-0308	Land Plans Sheet 8 of 21	P03
HE551497-ARD-LDC-SCHW-DR-X-0309	Land Plans Sheet 9 of 21	P01
PART 2		
HE551497-ARD-LDC-SCHW-DR-X-0108	Special Category Land Plans Sheet 8 of 21	P03
HE551497-ARD-LDC-SCHW-DR-X-0109	Special Category Land Plans Sheet 9 of 21	P02
HE551497-JAC-LDC-SCHW-DR-L-0208	Environmental Statement Environmental Masterplan Ch. 19600/20000 to Ch. 21400 Sheet 8 of 21	P02
HE551497-JAC-LDC-SCHW-DR-L-0209	Environmental Statement Environmental Masterplan Ch. 21400 to Ch. 22600 Sheet 9 of 21	P02

C:\working\jacobs_uk_highways_ssa\enouram\0155451\HE551497_JAC-LDC-SCHW-DR-C-0010.dwg - 02/09/2022 14:05:14 - A1Frame - EnourAM

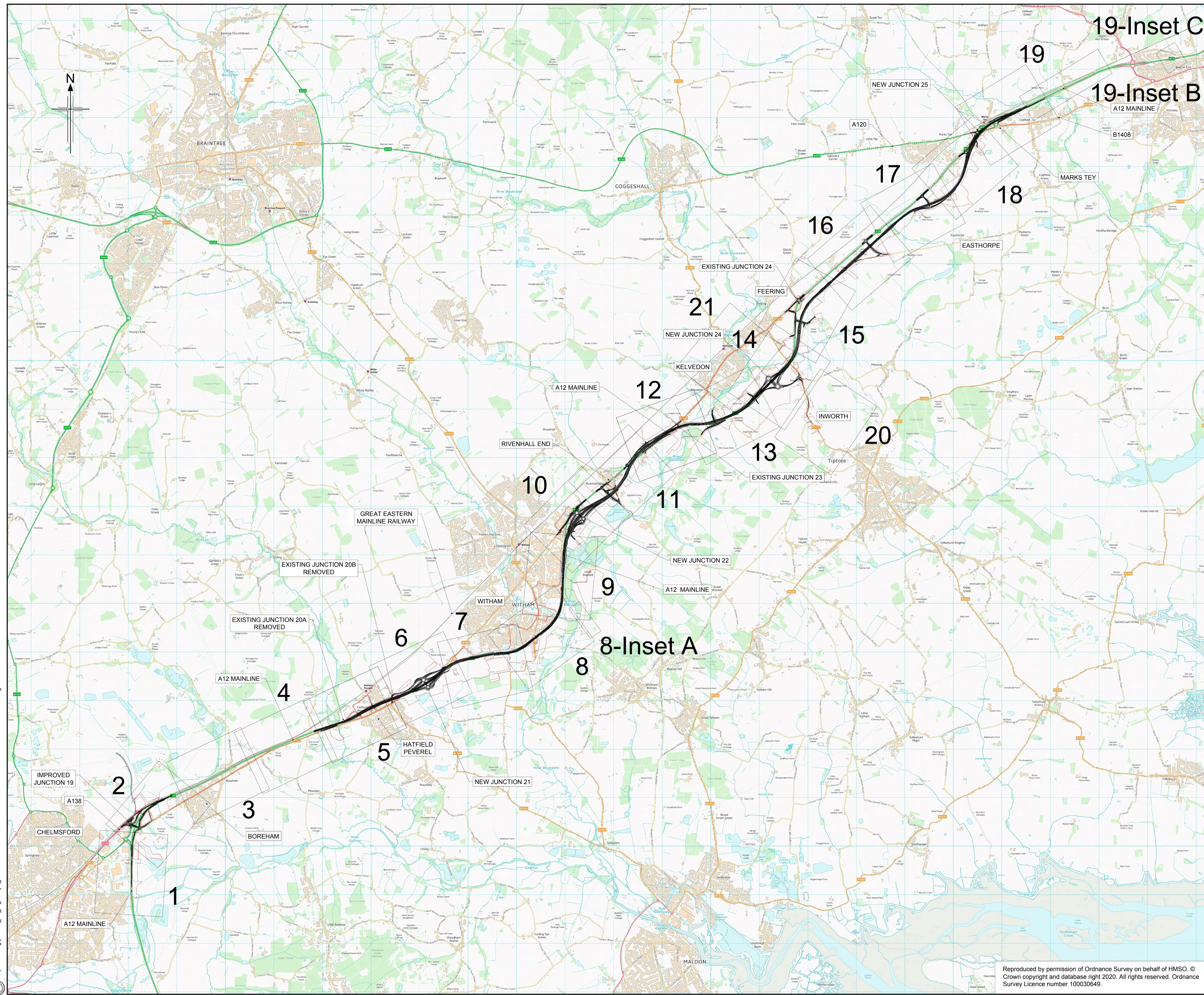

- NOTES
1. ALL DIMENSIONS ARE IN METRES UNLESS OTHERWISE STATED.
 2. THIS PLAN SHOULD BE READ IN CONJUNCTION WITH OTHER PLAN APPLICATION DOCUMENTS IN PARTICULAR SCHEDULE 3 OF THE DEVELOPMENT CONSENT ORDER.

LEGEND

ORDER LIMITS

Rev	01/08/22	DCO APPLICATION	AE	CC	CA	DT
Rev	Rev. Date	Purpose of revision	Drawn	Checked	Rev'd	Apprv'd
Development Consent Order Number:			Development Consent Order Drawing Number:			
TR010060			TR010060/APP/2.9			



Project
A12 CHELMSFORD TO A120 WIDENING SCHEME

Drawing title
GENERAL ARRANGEMENT
PLANS
KEY PLAN

Regulation	REGULATION 5(2)(o)	
Purpose of issue	DCO APPLICATION	
State Code	Preliminary	Drawing status
Project Stage	PCF 3	S4
Scale at A1 (841x594mm)	NTS	Rev
Jacobs No.	B36601D1	P01
Client no.	HE551497	

Drawing number
HE551497 - JAC - LDC - SCHW - DR - C - 0010

Originator
JAC

Volume
-

Location
SCHW

Type | Role | Number
-DR- C - 0010

Reproduced by permission of Ordnance Survey on behalf of HMSO. © Crown copyright and database right 2020. All rights reserved. Ordnance Survey Licence number 100030649.

LEGEND

BOUNDARIES

- ORDER LIMITS
- ORDER LIMITS EXCLUSION ZONE
- ADMINISTRATIVE BOUNDARY

HIGHWAYS

- NEW OR REALIGNED PUBLIC HIGHWAY/ ROAD
- NEW OR REALIGNED MAINTENANCE ACCESS / PRIVATE MEANS OF ACCESS
- EXISTING PUBLIC RIGHT OF WAY
- EXISTING CYCLE TRACK
- EXISTING PUBLIC RIGHT OF WAY - STOPPED UP
- NEW FOOTPATH / BRIDLEWAY
- PROPOSED CYCLE TRACK
- PROPOSED FOOTWAY
- NEW PERMISSIVE PATH
- PROPOSED CONTROLLED CROSSING
- PROPOSED UNCONTROLLED CROSSING
- PROPOSED TECHNOLOGY GANTRY (CANTILEVER)
- PROPOSED TECHNOLOGY GANTRY
- PROPOSED GANTRY MOUNTED DIRECTION SIGN
- PROPOSED LIGHTING COLUMN

ENGINEERING & CONSTRUCTION

- PROPOSED CONSTANT CUTTING
- PROPOSED CONSTANT EMBANKMENT
- PROPOSED MITIGATION EARTHWORKS
- PROPOSED MITIGATION EARTHWORKS (BORROW PITS)
- PROPOSED CARRIAGEWAY/ ROAD
- PROPOSED FOOTWAY / HARDSTANDING / ISLAND
- PROPOSED VERGE
- NEW OR MODIFIED BRIDGE DECK
- EXISTING BRIDGE DECK (TO BE RETAINED)
- EXISTING BRIDGE DECK (TO BE DEMOLISHED)
- PROPOSED RETAINING WALL
- EXISTING RETAINING WALL

DRAINAGE

- EXISTING CULVERT (TO BE RETAINED)
- PROPOSED CULVERT - MINOR WATERCOURSE
- EXISTING CULVERT (TO BE EXTENDED)
- EXISTING CULVERT (TO BE ABANDONED)
- PROPOSED WATERCOURSE DIVERSION (MAIN RIVER)
- WATER FLOW DIRECTION
- PROPOSED CUT-OFF DITCH (FILTER DRAIN IN SPATIAL CONSTRAINT AREA)
- EXISTING DITCH / MINOR WATERCOURSE (TO BE RETAINED)
- EXISTING DITCH / MINOR WATERCOURSE (TO BE REALIGNED)
- EXISTING DITCH / MINOR WATERCOURSE (TO BE ABANDONED)
- PROPOSED ATTENUATION POND (WITH OUTFALL CONNECTION)
- PROPOSED UNDERGROUND STORAGE UNITS
- PROPOSED FLOOD MITIGATION AREA
- PROPOSED FLOOD BUND

ENVIRONMENT

EXISTING

- EXISTING OPEN WATER
- EXISTING TREES, HEDGES AND SHRUBS
- EXISTING ANCIENT WOODLAND
- EXISTING ANCIENT, NOBLE AND VETERAN TREES
- EXISTING CONSERVATION AREAS
- EXISTING LOCAL NATURE RESERVE
- EXISTING LISTED BUILDINGS
- EXISTING REGISTERED PARKS AND GARDENS
- EXISTING SCHEDULED MONUMENT
- EXISTING TREES PROTECTED BY TREE PRESERVATION ORDER (AREA OR INDIVIDUAL TREE)

PROPOSED

- PROPOSED OPEN WATER
- PROPOSED WOODLAND PLANTING OF TREES AND SHRUBS
- PROPOSED WET WOODLAND
- PROPOSED TALL SCREEN PLANTING TO ELEVATE FLIGHT PATH OF BATS & BARN OWLS
- PROPOSED INDIVIDUAL TREES
- PROPOSED HEDGE
- PROPOSED HEDGE WITH INTERMITTENT TREES
- PROPOSED GRASSLAND
- PROPOSED INTERMITTENT TREES AND SHRUBS
- PROPOSED ECOLOGY POND (INDICATIVE)
- PROPOSED AQUATIC AND MARGINAL PLANTING (INDICATIVE)
- PROPOSED ECOLOGY MITIGATION AREA / ECOLOGY PROTECTION MEASURES
- PROPOSED NOISE BARRIER
- PROPOSED REPLACEMENT LAND

NOTES

- THIS PLAN SHOULD BE READ IN CONJUNCTION WITH OTHER PLAN APPLICATION DOCUMENTS IN PARTICULAR SCHEDULE 3 OF THE DEVELOPMENT CONSENT ORDER.
- THIS LEGEND SHOULD BE READ IN CONJUNCTION WITH THE LOCATION KEY PLAN AND THE GENERAL ARRANGEMENT DRAWINGS.

P01	01/08/2022	DCO APPLICATION	AE	CC	CA	DT
P02	30/09/22	DCO APPLICATION	ES	CA	RM	RM
Rev	Rev. Date	Purpose of revision	Drawn	Checked	Rev'd	Apprv'd

Development Consent Order Number:	Development Consent Order Drawing Number:
TR010060	TR010060/APP/2.9



Project
A12 CHELMSFORD TO A120 WIDENING SCHEME

Drawing title
**GENERAL ARRANGEMENT
PLANS
LEGEND**

Regulation	REGULATION 5(2)(g)	
Purpose of issue	DCO APPLICATION	
State Code	Statutory Procedures and Powers	
Project Stage	PCF 4	Drawing status
Scale at A1 (841x594mm)	NTS	S4
Jacobs No.	B36601D1	Rev
Client no.	HE551497	P02

Drawing number	PIN	Originator	Volume
HE551497 -	JAC	LDC -	
	SCHW	-DR- C	-0020

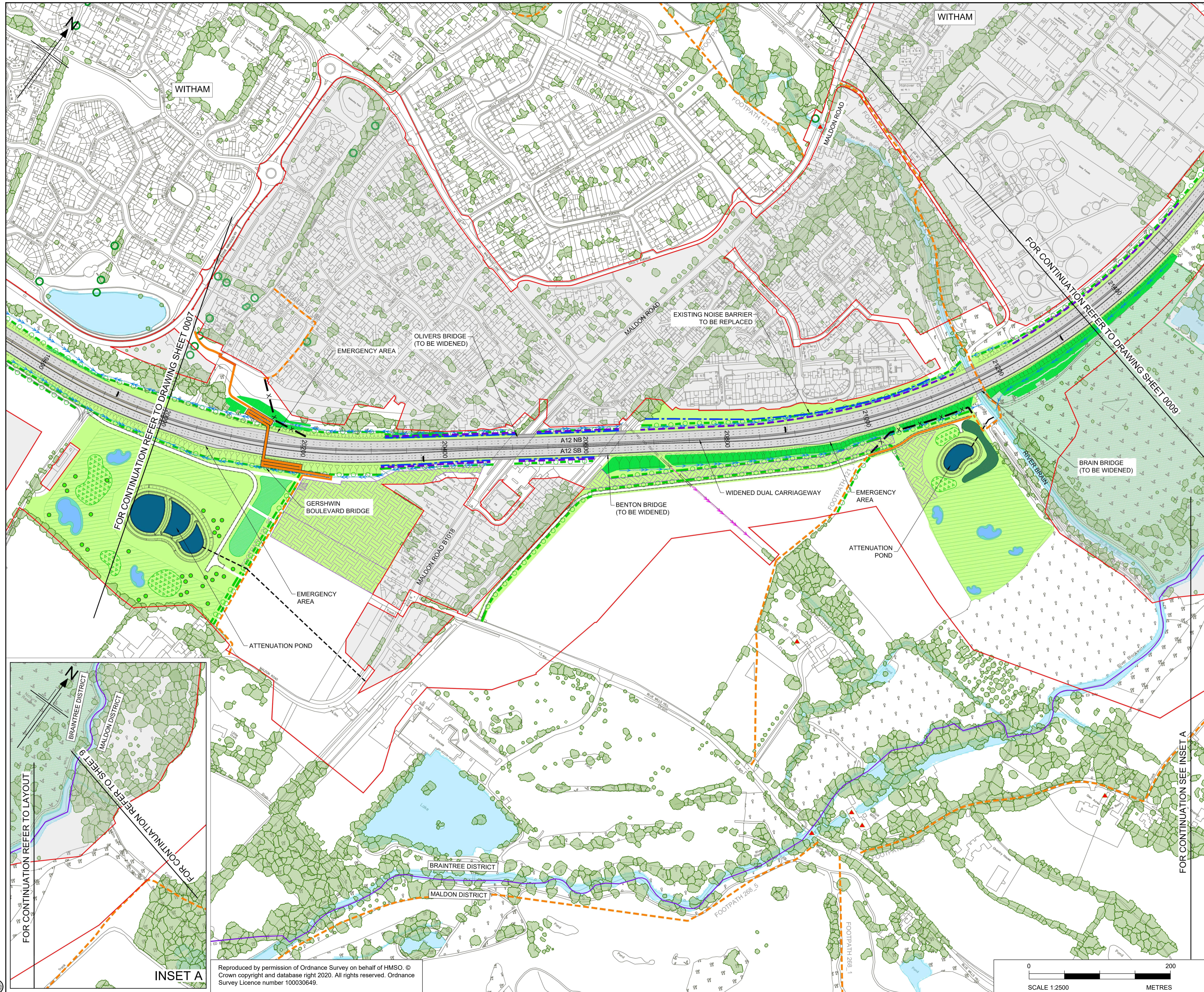

- NOTES
1. ALL DIMENSIONS ARE IN METRES UNLESS OTHERWISE STATED.
 2. THIS PLAN SHOULD BE READ IN CONJUNCTION WITH THE GENERAL ARRANGEMENT PLANS, LEGEND AND OTHER APPLICATION DOCUMENTS IN PARTICULAR SCHEDULE 3 OF THE DEVELOPMENT CONSENT ORDER.
 3. THE BASE MAPPING IS BASED ON ORDNANCE SURVEY (O/S) DATA.

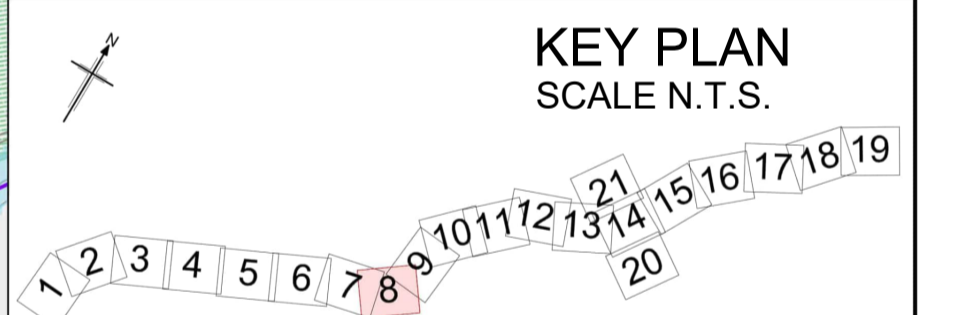

Rev	Rev. Date	Purpose of revision	Drawn	Checked	Rev'd	Apprv'd
P01	01/08/22	FINAL FOR DCO SUBMISSION	AE	CC	CA	DT
P02	04/04/23	DCO CHANGE	MB	LH	RM	RM

Development Consent Order Number: TR010060
 Development Consent Order Drawing Number: TR010060/APP/2.9



Client: national highways
 Project: A12 CHELMSFORD TO A120 WIDENING SCHEME

Drawing title: GENERAL ARRANGEMENT
 CH. 19600/20000 TO 21400
 SHEET 8 OF 21

Regulation	REGULATION 113 & 114		
Purpose of issue	DCO EXAM		
State Code	Statutory Procedures and Powers		
Project Stage	PCF 4	Drawing status	S4
Scale at A1 (841x594mm)	1:2500	Rev	P02
Jacobs No.	B36601D1		
Client no.	HE551497		

Drawing number: HE551497 - JAC - LDC - SCHW - DR - C - 0028
 PIN: | Originator: | Volume: | Location: | Type: | Role: | Number:

C:\pwworking\jacobsons_uk_highways_ssa\jgim\m074618\01055454\HE551497-JAC-LDC-SCHW-DR-C-0028.dwg - 04/04/2023 16:02:14 - A1Frame - MB074618

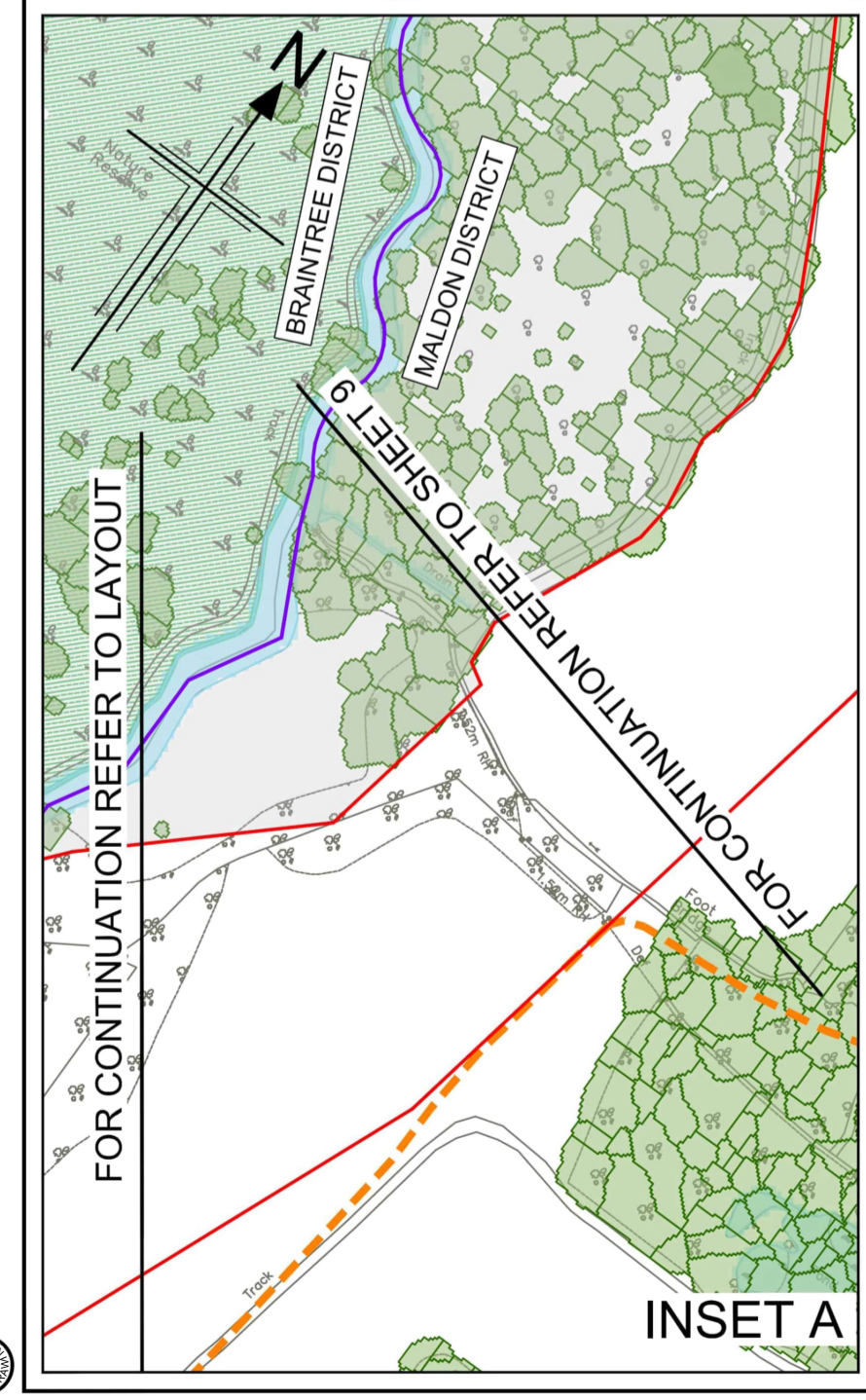

Reproduced by permission of Ordnance Survey on behalf of HMSO. © Crown copyright and database right 2020. All rights reserved. Ordnance Survey Licence number 100030649.

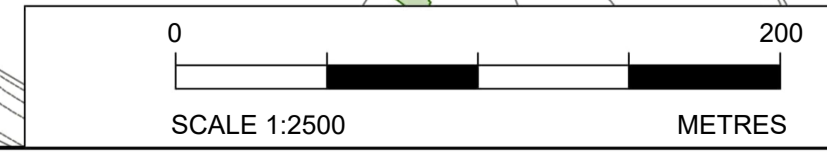

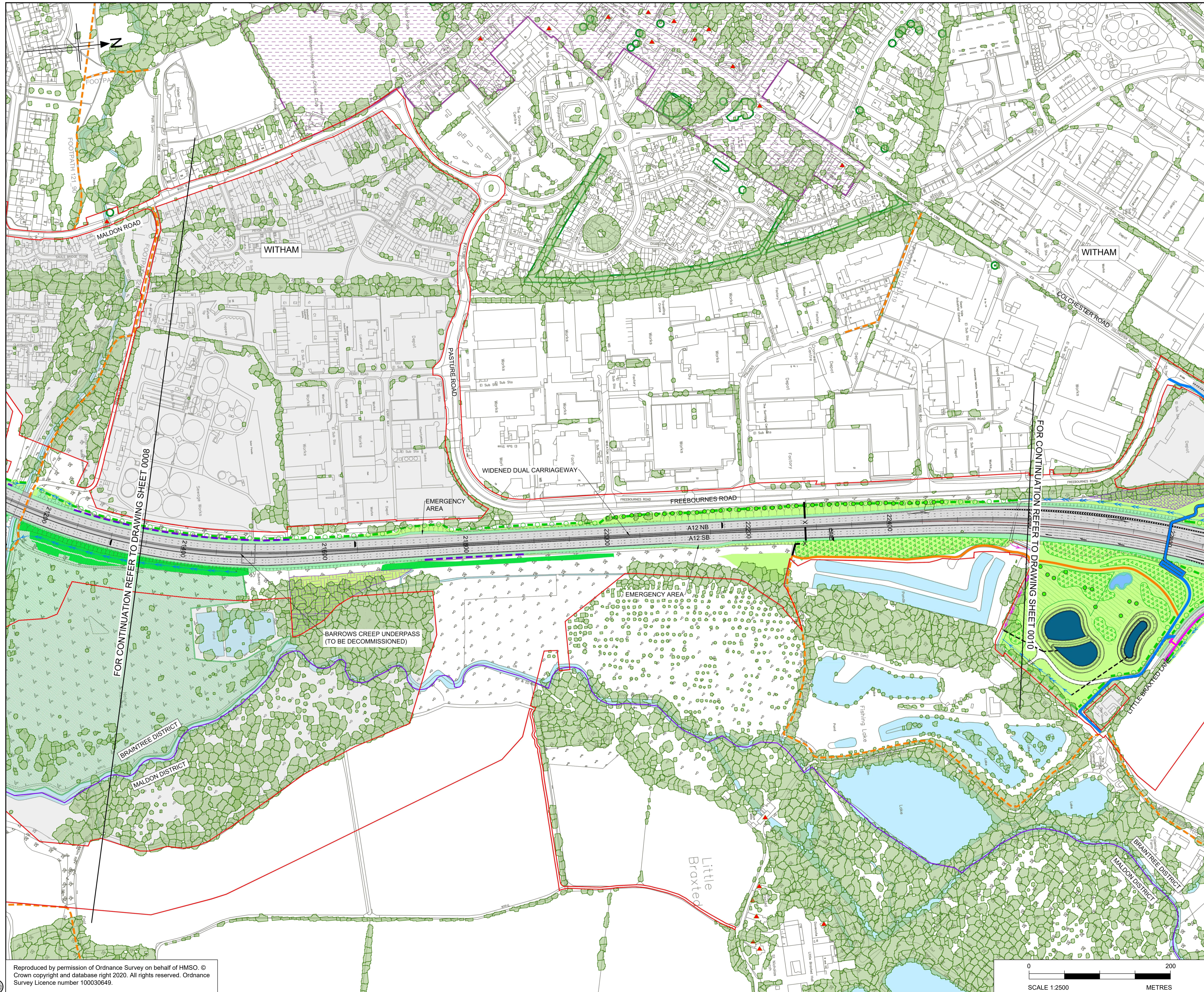

- NOTES
1. ALL DIMENSIONS ARE IN METRES UNLESS OTHERWISE STATED.
 2. THIS PLAN SHOULD BE READ IN CONJUNCTION WITH THE GENERAL ARRANGEMENT PLANS, LEGEND AND OTHER APPLICATION DOCUMENTS IN PARTICULAR SCHEDULE 3 OF THE DEVELOPMENT CONSENT ORDER.
 3. THE BASE MAPPING IS BASED ON ORDNANCE SURVEY (O/S) DATA.

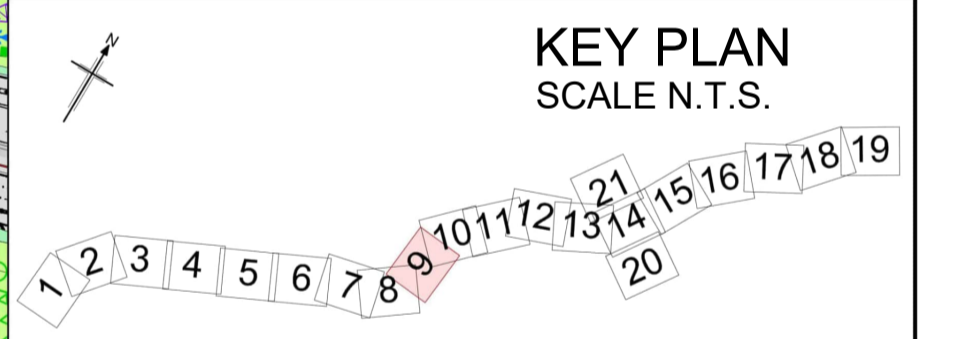

Rev	Rev. Date	Purpose of revision	Drawn	Checked	Rev'd	Apprv'd
P01	01/08/22	FINAL FOR DCO SUBMISSION	AE	CC	CA	DT
P02	04/04/23	DCO CHANGE	MB	LH	RM	RM

Development Consent Order Number: TR010060
 Development Consent Order Drawing Number: TR010060/APP/2.9



Project: A12 CHELMSFORD TO A120 WIDENING SCHEME

Drawing title: GENERAL ARRANGEMENT
 CH. 21400 TO 22600
 SHEET 9 OF 21

Regulation	REGULATION 113 & 114
Purpose of issue	DCO EXAM
State Code	Statutory Procedures and Powers
Project Stage	PCF 4
Scale at A1 (841x594mm)	1:2500
Jacobs No.	B36601D1
Client no.	HE551497
Drawing number	P02

HE551497 - JAC - LDC - SCHW - DR - C - 0029

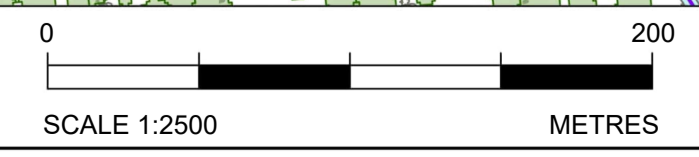

C:\pwworking\jacobs_uk_highways_ssa\legintf_mb074618\00155545\HE551497-JAC-LDC-SCHW-DR-C-0029.dwg - 04/04/2023 16:15:18 - A1Frame - MB074618

Reproduced by permission of Ordnance Survey on behalf of HMSO. © Crown copyright and database right 2020. All rights reserved. Ordnance Survey Licence number 100030649.

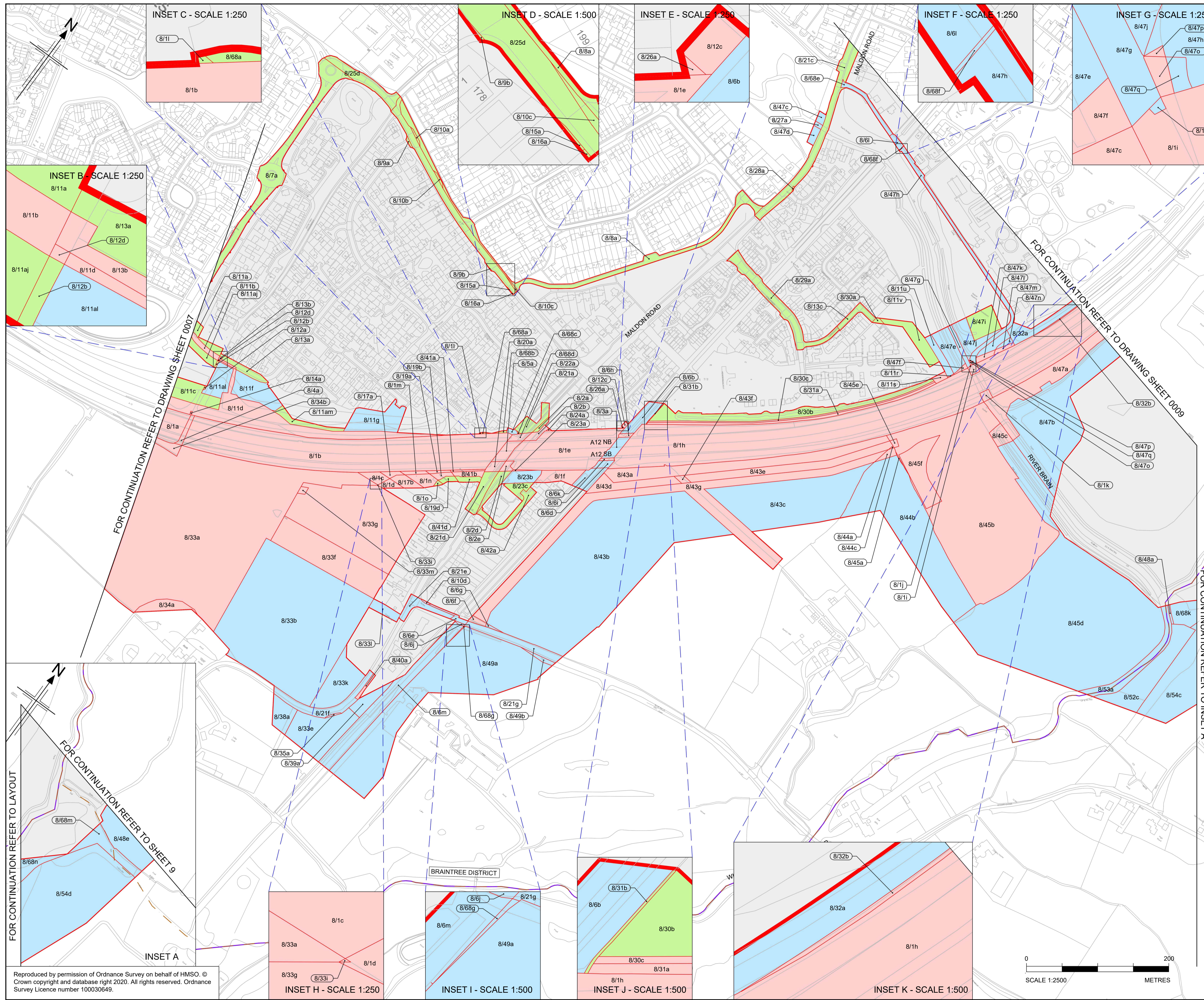

- NOTES**
- ALL DIMENSIONS ARE IN METERS UNLESS OTHERWISE STATED.
 - THE BASE MAPPING IS BASED ON ORDNANCE SURVEY (O/S) DATA.
 - ALL EASEMENTS, SERVITUDES AND PRIVATE RIGHTS ARE PROPOSED TO BE EXTINGUISHED ON LAND THAT IS TO BE ACQUIRED UNLESS STATED OTHERWISE IN THE BOOK OF REFERENCE.
 - THIS DRAWING IS TO READ IN CONJUNCTION WITH ALL OTHER PLANS AND DOCUMENTATION, IN PARTICULAR THE WORKS PLANS [TR010060/APP/2.2] AND BOOK OF REFERENCE [TR010060/APP/4.3]

- LEGEND**
- ORDER LIMITS
 - PERMANENT ACQUISITION OF ALL INTERESTS IN LAND
 - LAND TO BE USED TEMPORARILY
 - LAND TO BE USED TEMPORARILY AND NEW RIGHTS TO BE ACQUIRED PERMANENTLY
 - PERMANENT ACQUISITION OF ALL INTERESTS IN THE AIRSPACE OVER LAND
 - PERMANENT ACQUISITION OF ALL INTERESTS IN THE SUBSOIL
 - LAND NOT SUBJECT TO POWERS OF COMPULSORY ACQUISITION OR TEMPORARY POSSESSION
 - LAND NOT SUBJECT TO POWERS IN THE ORDER
 - PLOT NUMBERS
 - ADMINISTRATIVE BOUNDARY
 - PARISH BOUNDARIES

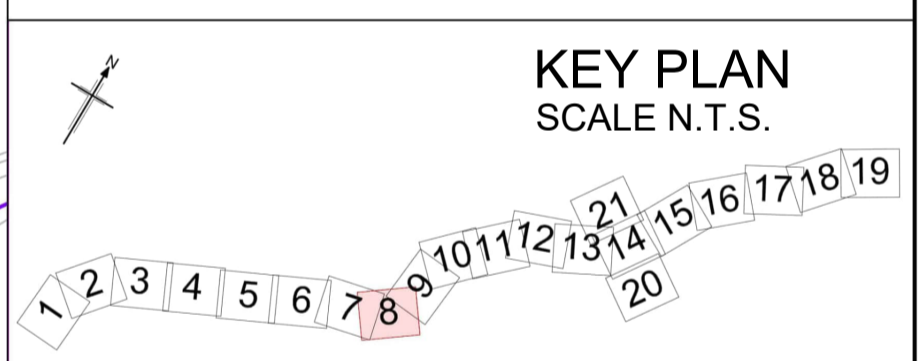

Rev	Rev. Date	Purpose of revision	Drawn	Checked	Rev'd	Appr'd
P03	31/03/2023	DCO CHANGE	GJ	CC	KC	ND
P02	28/03/2023	DEADLINE 4	GJ	CC	KC	ND
P01	20/07/2022	FINAL FOR DCO SUBMISSION	GJ	CC	KC	ND

Development Consent Order Number:		Development Consent Order Drawing Number:	
TR010060		TR010060/APP/2.7	



Project
A12 CHELMSFORD TO A120 WIDENING SCHEME

Drawing title
LAND PLANS SHEET 08 OF 21

Regulation	REGULATION 113 & 114		
Purpose of issue	DCO EXAM		
State Code	Statutory Powers and Procedures		
Project Stage	PCF4	Drawing status	
Scale at A1 (841x594mm)	1:2500	S4	
Jacobs No.	B36601D1	Rev	
Client no.	HE551497	P03	

Drawing number
HE551497 - ARD - LDC - SCHW -DR- X -0308

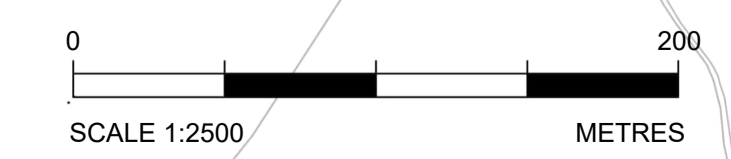

N:\CAD Team\A12\Land Plans\A12_Land_Plans\R13-Change_Consultation_31032023\16:21:53 - S8 - giones

Reproduced by permission of Ordnance Survey on behalf of HMSO. © Crown copyright and database right 2020. All rights reserved. Ordnance Survey Licence number 100030649.

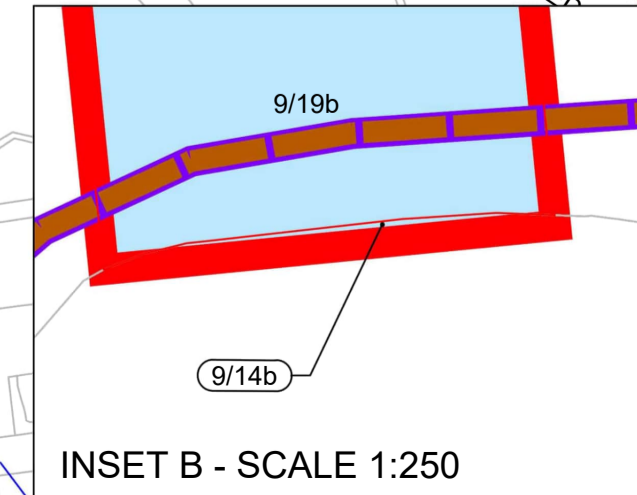
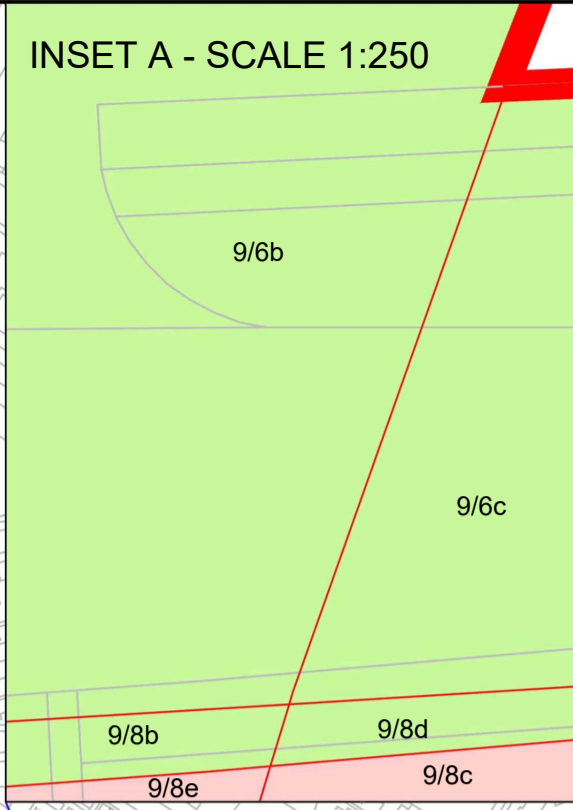
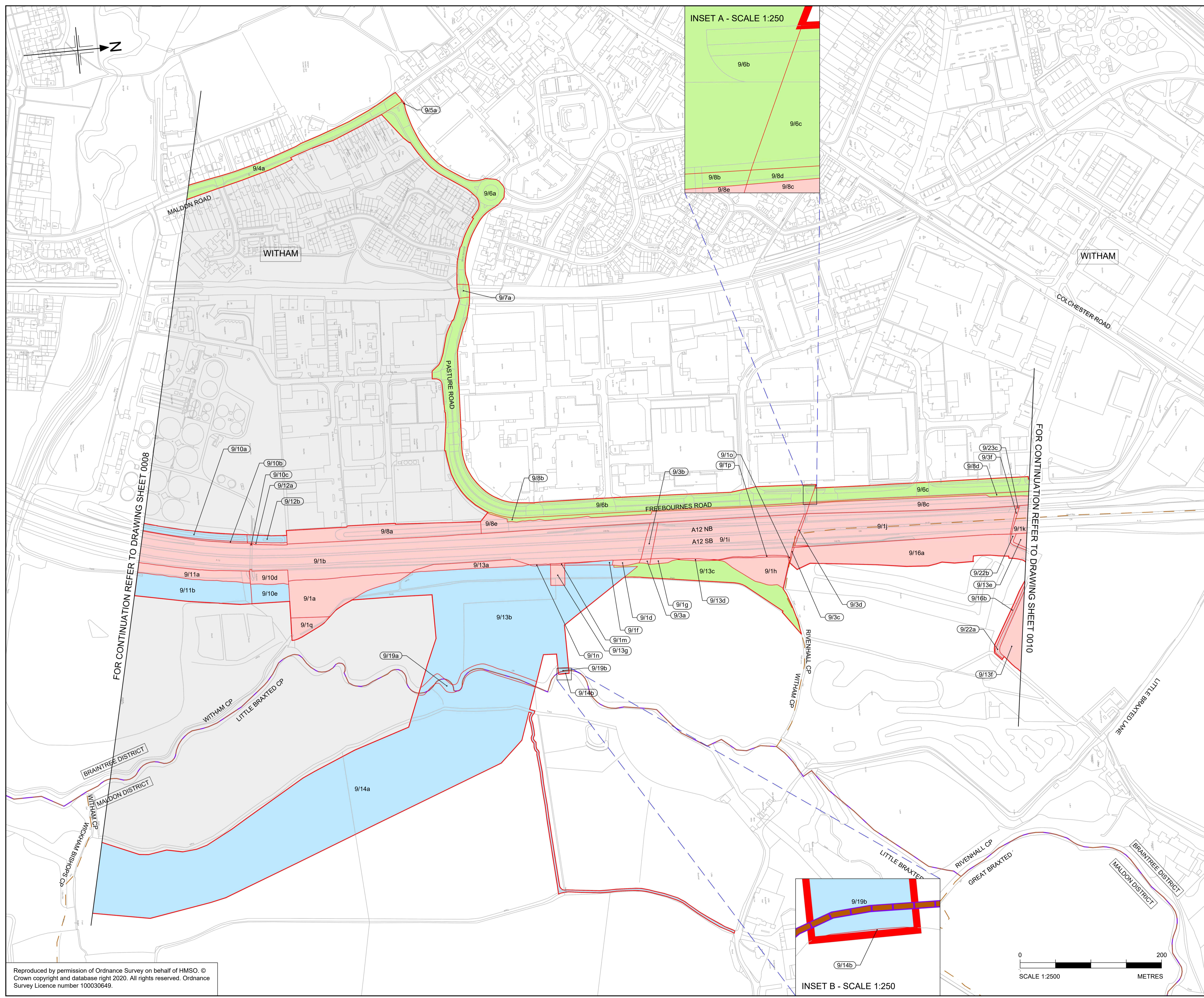

- NOTES**
1. ALL DIMENSIONS ARE IN METERS UNLESS OTHERWISE STATED.
 2. THE BASE MAPPING IS BASED ON ORDNANCE SURVEY (O/S) DATA.
 3. ALL EASEMENTS, SERVITUDES AND PRIVATE RIGHTS ARE PROPOSED TO BE EXTINGUISHED ON LAND THAT IS TO BE ACQUIRED UNLESS STATED OTHERWISE IN THE BOOK OF REFERENCE.
 4. THIS DRAWING IS TO READ IN CONJUNCTION WITH ALL OTHER PLANS AND DOCUMENTATION, IN PARTICULAR THE WORKS PLANS [TR010060/APP/2.2] AND BOOK OF REFERENCE [TR010060/APP/4.3]

- LEGEND**
- ORDER LIMITS
 - PERMANENT ACQUISITION OF ALL INTERESTS IN LAND
 - LAND TO BE USED TEMPORARILY
 - LAND TO BE USED TEMPORARILY AND NEW RIGHTS TO BE ACQUIRED PERMANENTLY
 - PERMANENT ACQUISITION OF ALL INTERESTS IN THE AIRSPACE OVER LAND
 - PERMANENT ACQUISITION OF ALL INTERESTS IN THE SUBSOIL
 - LAND NOT SUBJECT TO POWERS OF COMPULSORY ACQUISITION OR TEMPORARY POSSESSION
 - LAND NOT SUBJECT TO POWERS IN THE ORDER
 - PLOT NUMBERS (XX/XX)
 - ADMINISTRATIVE BOUNDARY
 - PARISH BOUNDARIES

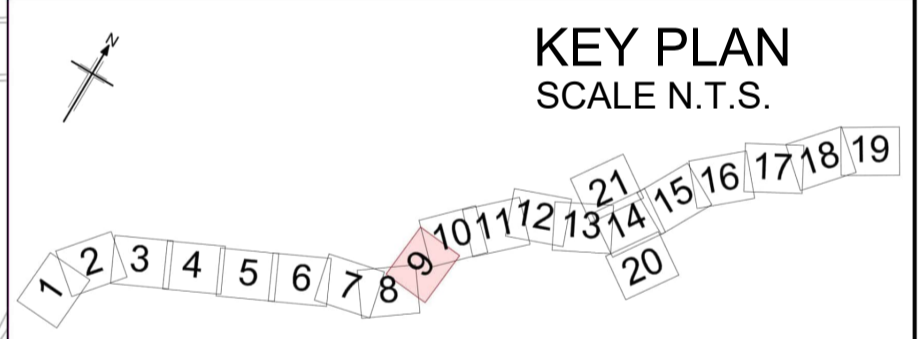

Rev	Rev. Date	Purpose of revision	Drawn	Checked	Rev'd	Apprv'd
P01	20/07/2022	FINAL FOR DCO SUBMISSION	GJ	CC	KC	ND

Development Consent Order Number:	Development Consent Order Drawing Number:
TR010060	TR010060/APP/2.7



Project
A12 CHELMSFORD TO A120 WIDENING SCHEME

Drawing title
LAND PLANS
SHEET 09 OF 21

Regulation	REGULATION 5(2)(f)
Purpose of issue	DCO APPLICATION
State Code	Preliminary
Project Stage	PCF3
Scale at A1 (841x594mm)	1:2500
Jacobs No.	B36601D1
Client no.	HE551497

Drawing number: HE551497 - ARD - LDC - SCHW -DR- X -0309
 PIN | Originator | Volume
 Location | Type | Role | Number

NICAD TeamA12\Land Plans\A12_Land_Plans\R13_28032023.dwg - 28/03/2023 13:02:15 - 59 - g Jones

Reproduced by permission of Ordnance Survey on behalf of HMSO. © Crown copyright and database right 2020. All rights reserved. Ordnance Survey Licence number 100030649.

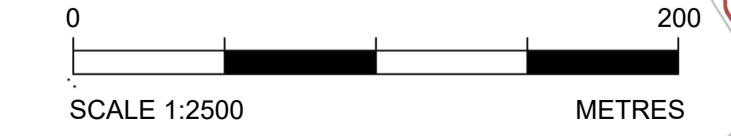

FOR CONTINUATION REFER TO DRAWING SHEET 0008

FOR CONTINUATION REFER TO DRAWING SHEET 0010

© Crown copyright 2021.

You may re-use this information (not including logos) free of charge in any format or medium, under the terms of the Open Government Licence. To view this licence: visit www.nationalarchives.gov.uk/doc/open-government-licence/ write to the **Information Policy Team, The National Archives, Kew, London TW9 4DU**, or email psi@nationalarchives.gsi.gov.uk.

Mapping (where present): © Crown copyright and database rights 2021 OS 100030649. You are permitted to use this data solely to enable you to respond to, or interact with, the organisation that provided you with the data. You are not permitted to copy, sub-licence, distribute or sell any of this data to third parties in any form.

This document is also available on our website at www.highwaysengland.co.uk
For an accessible version of this publication please call **0300 123 5000** and we will help you.

If you have any enquiries about this publication email info@highwaysengland.co.uk or call **0300 123 5000***. Please quote the Highways England publications code **PR48/21**.

*Calls to 03 numbers cost no more than a national rate call to an 01 or 02 number and must count towards any inclusive minutes in the same way as 01 and 02 calls.

These rules apply to calls from any type of line including mobile, BT, other fixed line or payphone. Calls may be recorded or monitored.

Registered office Bridge House, 1 Walnut Tree Close, Guildford GU1 4LZ
Highways England Company Limited registered in England and Wales number 09346363