

A428

Black Cat to Caxton Gibbet improvements

Supplementary consultation 2020

Map book 2 – Updated land use plans



June 2020

Map book 2 – Updated land use plans

These plans show the areas of land needed for the scheme. The land needed can be broadly categorised as set out below:

Permanent works

Land will be required permanently along the route of the new dual carriageway, for example to re-connect existing local roads to the new dual carriageway and for associated structures, drainage ponds and landscaping areas.

Where required, the land or permanent new rights will be acquired by Highways England either compulsorily or by agreement with the landowner.

Temporary works

Some land will be required on a temporary basis during construction of the scheme to enable safe and efficient working. The plans show the land which we may need temporarily for construction compounds and storage areas, for example soil storage, along the route. In places, we will also require rights of access across land to divert utilities such as gas pipelines, electricity cables and water pipes. Any land that is only required temporarily will be returned to its previous use wherever possible once construction is complete.

Compensation land

Land may also be required for environmental measures such as the creation of habitats for wildlife and flood compensation. This land may need to be compulsorily acquired permanently or subject to permanent rights.

Land for borrow pits

We have identified the need for additional land at the western and eastern ends of the scheme which will help to provide material required to construct the scheme. More information about borrow pits is available at www.highwaysengland.co.uk/a428.

These areas will be acquired permanently, albeit, on completion of the works. We will discuss the potential options for the ongoing use of the land with the original landowner.

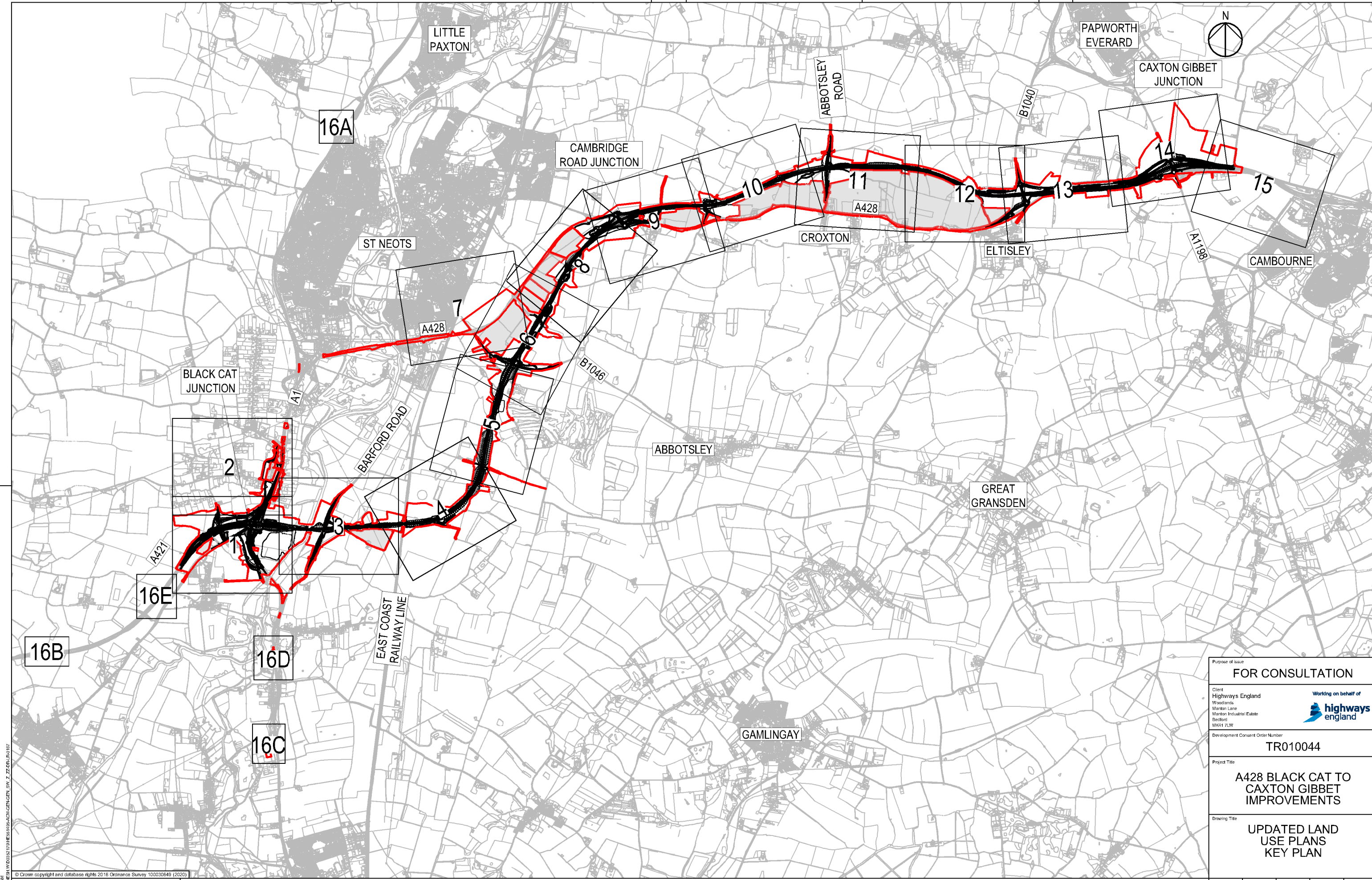

© Crown copyright and database rights 2016 Ordnance Survey 100030649 (2020)

Revision Details		WV	TD	Date	Suffix
Update for Supplementary Consultation		WV	TD	03/06/20	P02
By	Check				

KEY
 ORDER LIMITS BOUNDARY
 ORDER LIMIT EXCLUSION AREAS

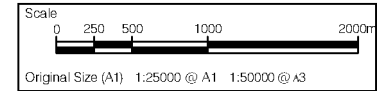

Purpose of Issue				
FOR CONSULTATION				
Client Highways England Woodlands Manton Lane Manton Industrial Estate Bosford MK41 2LW		Working on behalf of 		
Development Consent Order Number TR010044				
Project Title A428 BLACK CAT TO CAXTON GIBBET IMPROVEMENTS				
Drawing Title UPDATED LAND USE PLANS KEY PLAN				
Designed JT	Drawn WV	Checked JMW	Approved TD	Date 03/06/20
Internal Project No. 60541541		Suitability D8		
Scale @ A1 1:25000		Zone General		
Drawing Number HE551495		Originator ACM		Volume GEN
Location GEN_SW_Z_ZZ		DR-LR-0167		Rev P02

File Name: C:\pwworking\highways\150030649\GEN_SW_Z_ZZ\DR-LR-0167
 Plot Date: Thursday, June 04, 2020 10:58:41 AM

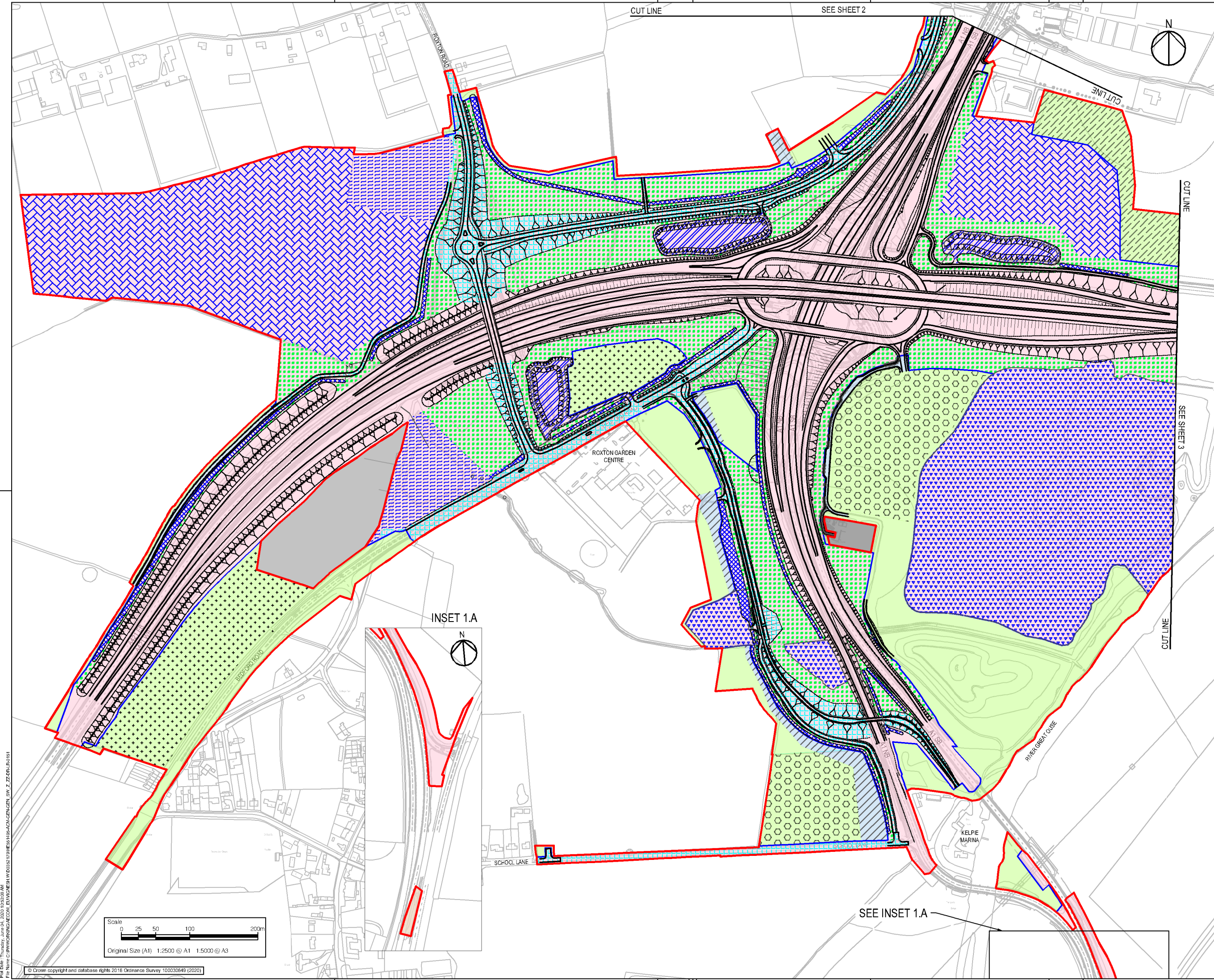

- KEY**
- RED LINE BOUNDARY
 - HIGHWAY BOUNDARY
 - PERMANENT LAND ACQUISITION - MAINLINE
 - PERMANENT LAND ACQUISITION - SIDE ROADS
 - PERMANENT LAND ACQUISITION - DITCHES
 - PERMANENT LAND ACQUISITION - PONDS
 - PERMANENT LAND ACQUISITION - LANDSCAPING
 - PERMANENT LAND ACQUISITION - FLOOD STORAGE AREA
 - PERMANENT LAND ACQUISITION - BORROW PITS
 - PERMANENT LAND ACQUISITION - MATERIAL STORAGE
 - PERMANENT LAND ACQUISITION - LAND TAKEN FOR PRACTICALITY
 - PERMANENT LAND ACQUISITION - LIMITS OF DEVIATION
 - TEMPORARY LAND ACQUISITION - WORKING ROOM
 - TEMPORARY LAND ACQUISITION - CONSTRUCTION USE
 - TEMPORARY LAND ACQUISITION - STOPPING UP OF FOOTPATH
 - TEMPORARY LAND ACQUISITION - DETRUNKING EXTENTS
 - TEMPORARY LAND ACQUISITION - SITE COMPOUND
 - TEMPORARY LAND ACQUISITION - MULTIPLE-PURPOSE CONSTRUCTION AREA
 - TEMPORARY LAND ACQUISITION - PERMANENT ACCESS RIGHTS
 - TEMPORARY LAND ACQUISITION - PERMANENT ACCESS RIGHTS - STAFF DIVERSION
 - ORDER LIMITS EXCLUSION AREAS

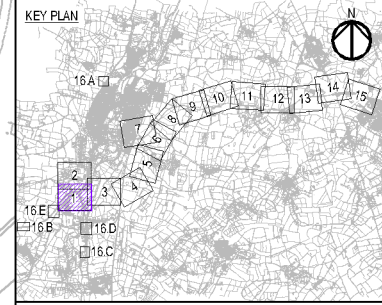

Revision Details			
By	TD	Date	Suffix
WV	TD	03/06/20	P03
Check			

FOR CONSULTATION

Client
 Highways England
 Woodlands
 Marston Lane
 Marston Industrial Estate
 Bedford
 MK41 7LW

Working on behalf of

Development Consent Order Number
TR010044

Project Title
A428 BLACK CAT TO CAXTON GIBBET IMPROVEMENTS

Drawing Title
UPDATED LAND USE PLANS SHEET 1 OF 16

Designed JT	Drawn WV	Checked JMW	Approved TD	Date 03/06/20
Internal Project No. 60541541			Suitability DB	
Scale @ A1 1:2500			Zone General	

THIS DOCUMENT HAS BEEN PREPARED PURSUANT TO AND SUBJECT TO THE TERMS OF AECOM'S APPOINTMENT BY ITS CLIENT. AECOM ACCEPTS NO LIABILITY FOR ANY USE OF THIS DOCUMENT OTHER THAN BY ITS ORIGINAL CLIENT OR FOLLOWING AECOM'S EXPRESS AGREEMENT TO SUCH USE, AND ONLY FOR THE PURPOSES FOR WHICH IT WAS PREPARED AND PROVIDED.

Drawing Number HE551495	Originator ACM	Volume GEN	Rev P03
Location GEN_SW_Z_ZZ-DR-LR-0151			
Type	Role	Number	

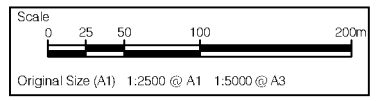
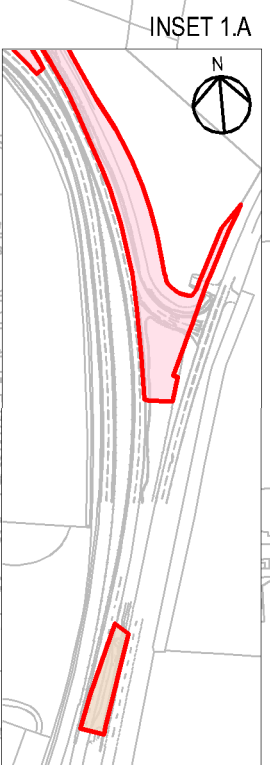

File Name: C:\P\W\W\GEN\ACM\ELV\W\ES\119\ACM\GEN_SW_Z_ZZ\DR-LR-0151
 Plot Date: Thursday, June 04, 2020, 11:52:39 AM

INSET 2.A

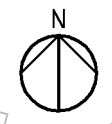

SEE INSET 2.A

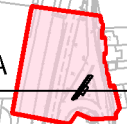

- KEY**
- RED LINE BOUNDARY
 - HIGHWAY BOUNDARY
 - PERMANENT LAND ACQUISITION - MAINLINE
 - PERMANENT LAND ACQUISITION - SIDE ROADS
 - PERMANENT LAND ACQUISITION - DITCHES
 - PERMANENT LAND ACQUISITION - PONDS
 - PERMANENT LAND ACQUISITION - LANDSCAPING
 - PERMANENT LAND ACQUISITION - FLOOD STORAGE AREA
 - PERMANENT LAND ACQUISITION - BORROW PITS
 - PERMANENT LAND ACQUISITION - MATERIAL STORAGE
 - PERMANENT LAND ACQUISITION - LAND TAKEN FOR PRACTICALITY
 - PERMANENT LAND ACQUISITION - LIMITS OF DEVIATION
 - TEMPORARY LAND ACQUISITION - WORKING ROOM
 - TEMPORARY LAND ACQUISITION - CONSTRUCTION USE
 - TEMPORARY LAND ACQUISITION - STOPPING UP OF FOOTPATH
 - TEMPORARY LAND ACQUISITION - DE-TRUNKING EXTENTS
 - TEMPORARY LAND ACQUISITION - SITE COMPOUND
 - TEMPORARY LAND ACQUISITION - MULTIPLE-PURPOSE CONSTRUCTION AREA
 - TEMPORARY LAND ACQUISITION - PERMANENT ACCESS RIGHTS
 - TEMPORARY LAND ACQUISITION - PERMANENT ACCESS RIGHTS - STAFF DIVERSION
 - ORDER LIMITS EXCLUSION AREAS

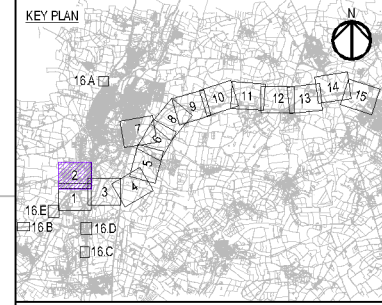

Revision Details		By	Check	Date	Suffix
Update for Supplementary Consultation		WV	TD	03/06/20	P03

Purpose of Issue: **FOR CONSULTATION**

Client: **Highways England**
 Woodlands
 Marston Lane
 Marston Industrial Estate
 Bedford
 MK41 2LW

Working on behalf of

Development Consent Order Number: **TR010044**

Project Title: **A428 BLACK CAT TO CAXTON GIBBET IMPROVEMENTS**

Drawing Title: **UPDATED LAND USE PLANS SHEET 2 OF 16**

Designed	Drawn	Checked	Approved	Date
JT	WV	JMW	TD	03/06/20

Internal Project No: 60541541 Suitability: DB
 Scale @ A1: 1:2500 Zone: General

THIS DOCUMENT HAS BEEN PREPARED PURSUANT TO AND SUBJECT TO THE TERMS OF AECOM'S APPOINTMENT BY ITS CLIENT. AECOM ACCEPTS NO LIABILITY FOR ANY USE OF THIS DOCUMENT OTHER THAN BY ITS ORIGINAL CLIENT OR FOLLOWING AECOM'S EXPRESS AGREEMENT TO SUCH USE, AND ONLY FOR THE PURPOSES FOR WHICH IT WAS PREPARED AND PROVIDED.

Drawing Number	Originator	Volume	Rev
HE551495 - ACM - GEN - GEN_SW_Z_ZZ_DR_LR_0152			P03

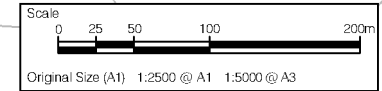

File Name: C:\P\W\GEN\SW_Z_ZZ\DR_LR_0152.dwg

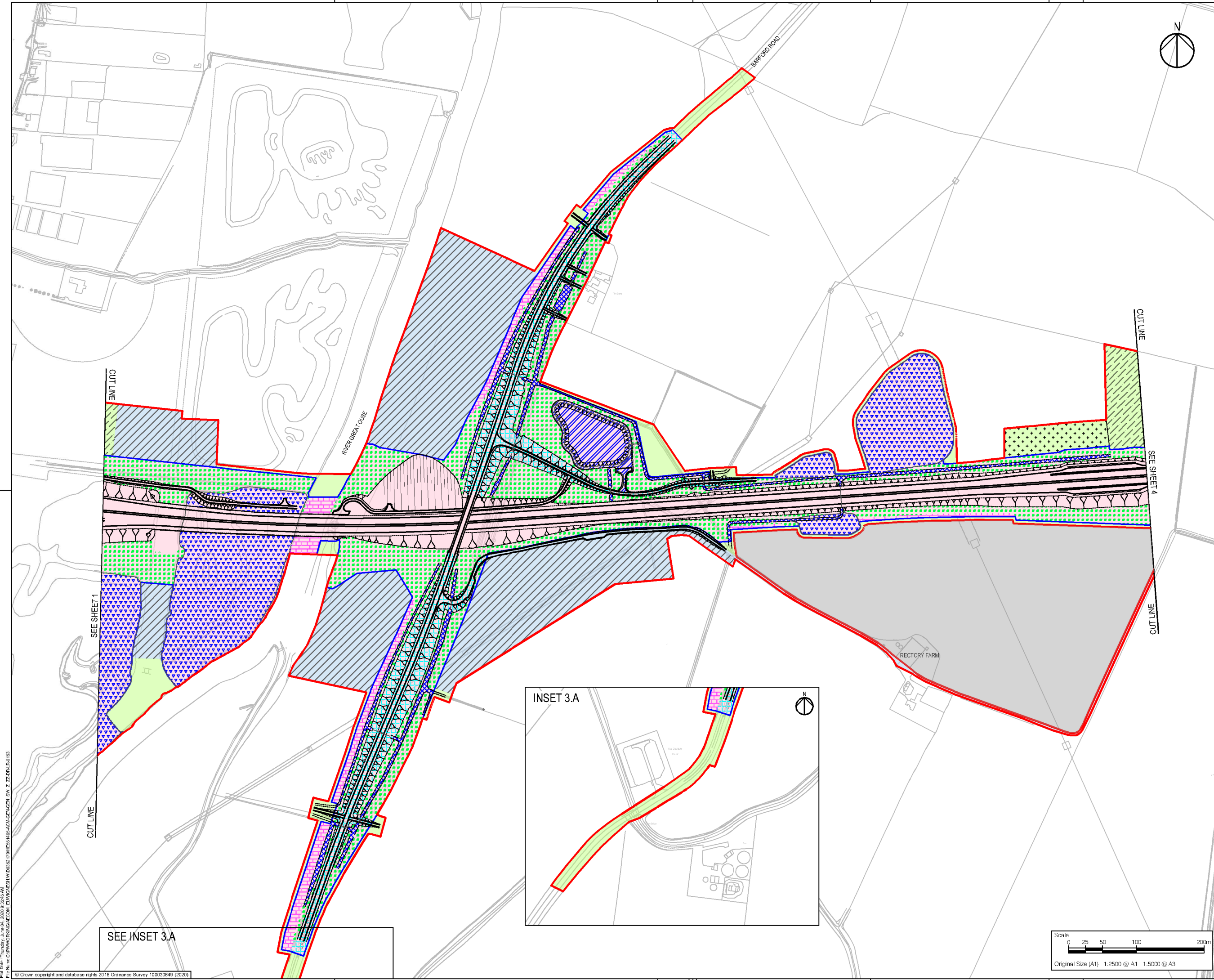

KEY

- RED LINE BOUNDARY
- HIGHWAY BOUNDARY
- PERMANENT LAND ACQUISITION - MAINLINE
- PERMANENT LAND ACQUISITION - SIDE ROADS
- PERMANENT LAND ACQUISITION - DITCHES
- PERMANENT LAND ACQUISITION - PONDS
- PERMANENT LAND ACQUISITION - LANDSCAPING
- PERMANENT LAND ACQUISITION - FLOOD STORAGE AREA
- PERMANENT LAND ACQUISITION - BORROW PITS
- PERMANENT LAND ACQUISITION - MATERIAL STORAGE
- PERMANENT LAND ACQUISITION - LAND TAKEN FOR PRACTICALITY
- PERMANENT LAND ACQUISITION - LIMITS OF DEVIATION
- TEMPORARY LAND ACQUISITION - WORKING ROOM
- TEMPORARY LAND ACQUISITION - CONSTRUCTION USE
- TEMPORARY LAND ACQUISITION - STOPPING UP OF FOOTPATH
- TEMPORARY LAND ACQUISITION - DETRUNKING EXTENTS
- TEMPORARY LAND ACQUISITION - SITE COMPOUND
- TEMPORARY LAND ACQUISITION - MULTIPLE-PURPOSE CONSTRUCTION AREA
- TEMPORARY LAND ACQUISITION - PERMANENT ACCESS RIGHTS
- TEMPORARY LAND ACQUISITION - PERMANENT ACCESS RIGHTS - STAFF DIVERSION
- ORDER LIMITS EXCLUSION AREAS

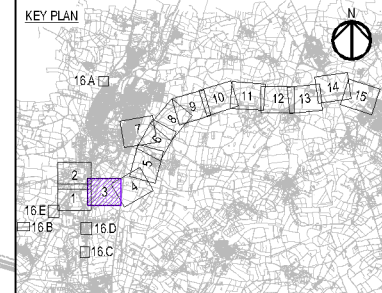

Revision Details		By	Date	Suffix
Update for Supplementary Consultation	WV	TD	03/06/20	P03
		Check		

FOR CONSULTATION

Client
Highways England
Woodlands
Marston Lane
Marston Industrial Estate
Bedford
MK41 2LW

Development Consent Order Number
TR010044

Project Title
A428 BLACK CAT TO CAXTON GIBBET IMPROVEMENTS

Drawing Title
UPDATED LAND USE PLANS SHEET 3 OF 16

Designed JT	Drawn WV	Checked JMW	Approved TD	Date 03/06/20
Internal Project No. 60541541		Suitability DR		
Scale @ A1 1:2500		Zone General		

THIS DOCUMENT HAS BEEN PREPARED PURSUANT TO AND SUBJECT TO THE TERMS OF AECOM'S APPOINTMENT BY ITS CLIENT. AECOM ACCEPTS NO LIABILITY FOR ANY USE OF THIS DOCUMENT OTHER THAN BY ITS ORIGINAL CLIENT OR FOLLOWING AECOM'S EXPRESS AGREEMENT TO SUCH USE, AND ONLY FOR THE PURPOSES FOR WHICH IT WAS PREPARED AND PROVIDED.

Drawing Number
HE551495

Highways England PIN
ACM

Originator
GEN

Volume
GEN_SW_Z_ZZ_DR_LR_0153

Rev
P03

Location
Type
Role
Number

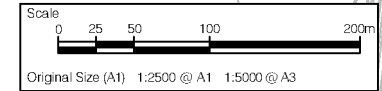
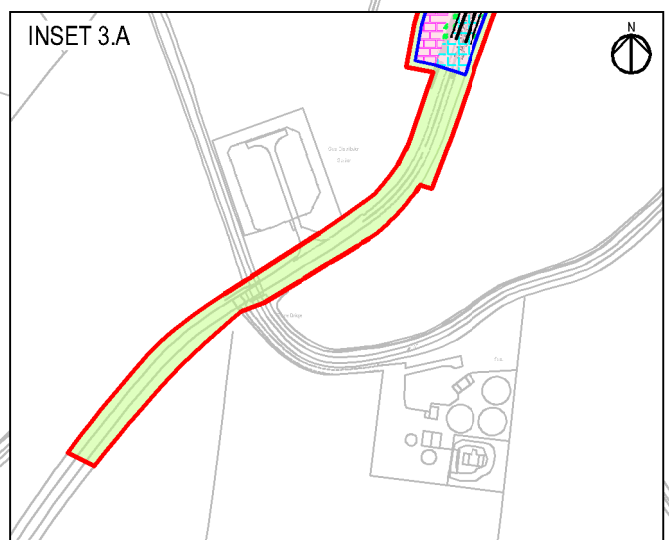

File Name: C:\pwworking\AECOM\ELVINGESH\W0033279\HE551495-ACM\GEN_SW_Z_ZZ\DR_LR_0153
 Plot Date: Thursday, June 04, 2020 09:46:41 AM
 © Crown copyright and database rights 2016 Ordnance Survey 100030649 (2020)

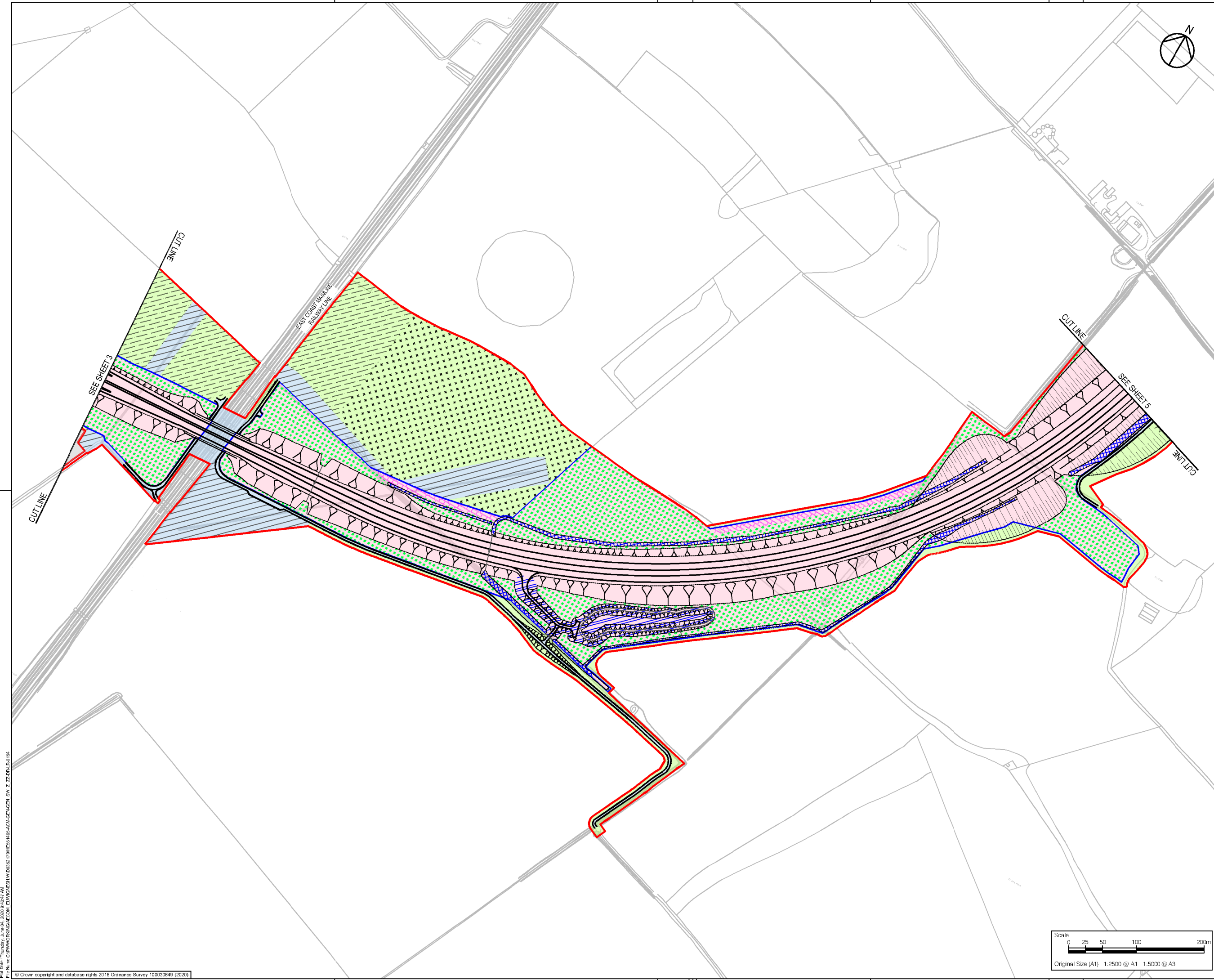

KEY

- RED LINE BOUNDARY
- HIGHWAY BOUNDARY
- PERMANENT LAND ACQUISITION - MAINLINE
- PERMANENT LAND ACQUISITION - SIDE ROADS
- PERMANENT LAND ACQUISITION - DITCHES
- PERMANENT LAND ACQUISITION - PONDS
- PERMANENT LAND ACQUISITION - LANDSCAPING
- PERMANENT LAND ACQUISITION - FLOOD STORAGE AREA
- PERMANENT LAND ACQUISITION - BORROW PITS
- PERMANENT LAND ACQUISITION - MATERIAL STORAGE
- PERMANENT LAND ACQUISITION - LAND TAKEN FOR PRACTICALITY
- PERMANENT LAND ACQUISITION - LIMITS OF DEVIATION
- TEMPORARY LAND ACQUISITION - WORKING ROOM
- TEMPORARY LAND ACQUISITION - CONSTRUCTION USE
- TEMPORARY LAND ACQUISITION - STOPPING UP OF FOOTPATH
- TEMPORARY LAND ACQUISITION - DETRUNKING EXTENTS
- TEMPORARY LAND ACQUISITION - SITE COMPOUND
- TEMPORARY LAND ACQUISITION - MULTIPLE-PURPOSE CONSTRUCTION AREA
- TEMPORARY LAND ACQUISITION - PERMANENT ACCESS RIGHTS
- TEMPORARY LAND ACQUISITION - PERMANENT ACCESS RIGHTS - STAFF DIVERSION
- ORDER LIMITS EXCLUSION AREAS

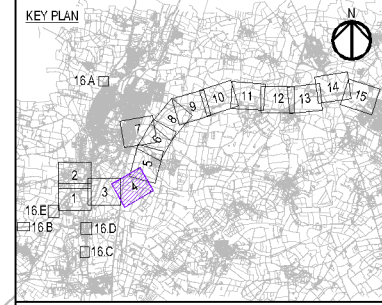

Revision Details		By	Date	Suffix
Update for Supplementary Consultation	WV	TD	03/06/20	P03

FOR CONSULTATION

Client
Highways England
Woodlands
Manton Lane
Manton Industrial Estate
Bedford
MK41 7LW

Working on behalf of
highways england

Development Consent Order Number
TR010044

Project Title
A428 BLACK CAT TO CAXTON GIBBET IMPROVEMENTS

Drawing Title
UPDATED LAND USE PLANS SHEET 4 OF 16

Designed	Drawn	Checked	Approved	Date
JT	WV	JMW	TD	03/06/20

Internal Project No. 60541541
Scale @ A1 1:2500
Suitability DB
Zone General

THIS DOCUMENT HAS BEEN PREPARED PURSUANT TO AND SUBJECT TO THE TERMS OF AECOM'S APPOINTMENT BY ITS CLIENT. AECOM ACCEPTS NO LIABILITY FOR ANY USE OF THIS DOCUMENT OTHER THAN BY ITS ORIGINAL CLIENT OR FOLLOWING AECOM'S EXPRESS AGREEMENT TO SUCH USE AND ONLY FOR THE PURPOSES FOR WHICH IT WAS PREPARED AND PROVIDED.

Drawing Number	Originator	Volume	Rev
HE551495	ACM	GEN	P03

Location: GEN_SW_Z_ZZ_DR_LR_0154
Type: LR
Role: DR

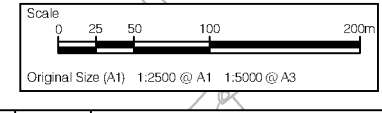

File Name: C:\P\W\UR\N\GEN\CON\EL\W\GEN\SW_Z_ZZ\DR_LR_0154
 Plot Date: Thursday, June 04, 2020 09:42:47 AM
 © Crown copyright and database rights 2016 Ordnance Survey 100030649 (2020)



KEY

- RED LINE BOUNDARY
- HIGHWAY BOUNDARY
- PERMANENT LAND ACQUISITION - MAINLINE
- PERMANENT LAND ACQUISITION - SIDE ROADS
- PERMANENT LAND ACQUISITION - DITCHES
- PERMANENT LAND ACQUISITION - PONDS
- PERMANENT LAND ACQUISITION - LANDSCAPING
- PERMANENT LAND ACQUISITION - FLOOD STORAGE AREA
- PERMANENT LAND ACQUISITION - BORROW PITS
- PERMANENT LAND ACQUISITION - MATERIAL STORAGE
- PERMANENT LAND ACQUISITION - LAND TAKEN FOR PRACTICALITY
- PERMANENT LAND ACQUISITION - LIMITS OF DEVIATION
- TEMPORARY LAND ACQUISITION - WORKING ROOM
- TEMPORARY LAND ACQUISITION - CONSTRUCTION USE
- TEMPORARY LAND ACQUISITION - STOPPING UP OF FOOTPATH
- TEMPORARY LAND ACQUISITION - DETRUNKING EXTENTS
- TEMPORARY LAND ACQUISITION - SITE COMPOUND
- TEMPORARY LAND ACQUISITION - MULTIPLE-PURPOSE CONSTRUCTION AREA
- TEMPORARY LAND ACQUISITION - PERMANENT ACCESS RIGHTS
- TEMPORARY LAND ACQUISITION - PERMANENT ACCESS RIGHTS - STATS DIVERSION
- ORDER LIMITS EXCLUSION AREAS

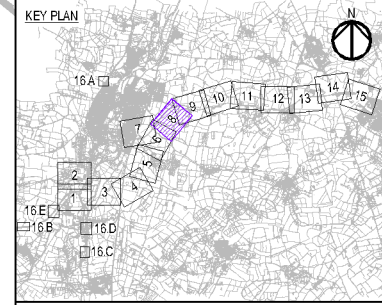

Revision Details		By	Check	Date	Suffix
Update for Supplementary Consultation		WV	TD	03/06/20	P03

Purpose of issue
FOR CONSULTATION

Client
Highways England
Woodlands
Manton Lane
Manton Industrial Estate
Bedford
MK41 2LW

Working on behalf of
highways england

Development Consent Order Number
TR010044

Project Title
A428 BLACK CAT TO CAXTON GIBBET IMPROVEMENTS

Drawing Title
UPDATED LAND USE PLANS SHEET 8 OF 16

Designed	Drawn	Checked	Approved	Date
JT	WV	JMW	TD	03/06/20

Internal Project No. 60541541 Suitability DB
Scale @ A1 1:2500 Zone General

THIS DOCUMENT HAS BEEN PREPARED PURSUANT TO AND SUBJECT TO THE TERMS OF AECOM'S APPOINTMENT BY ITS CLIENT. AECOM ACCEPTS NO LIABILITY FOR ANY USE OF THIS DOCUMENT OTHER THAN BY ITS ORIGINAL CLIENT OR FOLLOWING AECOM'S EXPRESS AGREEMENT TO SUCH USE, AND ONLY FOR THE PURPOSES FOR WHICH IT WAS PREPARED AND PROVIDED.

Drawing Number	Originator	Volume	Rev
HE551495	ACM	GEN	P03

Location: GEN_SW_Z_ZZ_DR_LR_0158 Role: 1 Number: 1

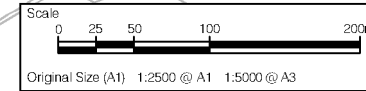

Pdf Date: Thursday, June 04, 2020 09:41:47 AM
 File Name: C:\P\W\UR\N\GEN\CON_ED\W\GEN\SW_Z_ZZ\DR_LR_0158



KEY

	RED LINE BOUNDARY		HIGHWAY BOUNDARY
	PERMANENT LAND ACQUISITION - MAINLINE		PERMANENT LAND ACQUISITION - SIDE ROADS
	PERMANENT LAND ACQUISITION - DITCHES		PERMANENT LAND ACQUISITION - PONDS
	PERMANENT LAND ACQUISITION - LANDSCAPING		PERMANENT LAND ACQUISITION - FLOOD STORAGE AREA
	PERMANENT LAND ACQUISITION - BORROW PITS		PERMANENT LAND ACQUISITION - MATERIAL STORAGE
	PERMANENT LAND ACQUISITION - LAND TAKEN FOR PRACTICALITY		PERMANENT LAND ACQUISITION - LIMITS OF DEVIATION
	TEMPORARY LAND ACQUISITION - WORKING ROOM		TEMPORARY LAND ACQUISITION - CONSTRUCTION USE
	TEMPORARY LAND ACQUISITION - STOPPING UP OF FOOTPATH		TEMPORARY LAND ACQUISITION - DETRUNKING EXTENTS
	TEMPORARY LAND ACQUISITION - SITE COMPOUND		TEMPORARY LAND ACQUISITION - MULTIPLE-PURPOSE CONSTRUCTION AREA
	TEMPORARY LAND ACQUISITION - PERMANENT ACCESS RIGHTS		TEMPORARY LAND ACQUISITION - PERMANENT ACCESS RIGHTS - STAFF DIVERSION
	ORDER LIMITS EXCLUSION AREAS		

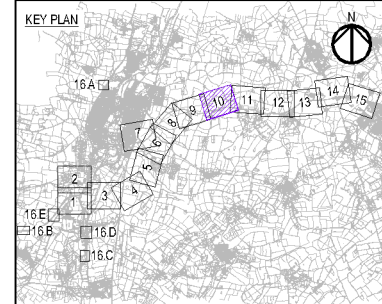

Revision Details		By	Date	Suffix
Update for Supplementary Consultation	WV	TD	03/06/20	P03
		Check		

Purpose of Issue
FOR CONSULTATION

Client
Highways England
Woodlands
Marston Lane
Marston Industrial Estate
Bedford
MK41 7LW

Working on behalf of

Development Consent Order Number
TR010044

Project Title
A428 BLACK CAT TO CAXTON GIBBET IMPROVEMENTS

Drawing Title
UPDATED LAND USE PLANS SHEET 10 OF 16

Designed	Drawn	Checked	Approved	Date
JT	WV	JMW	TD	03/06/20

Internal Project No. 60541541
Scale @ A1 1:2500
Suitability DB
Zone General

THIS DOCUMENT HAS BEEN PREPARED PURSUANT TO AND SUBJECT TO THE TERMS OF AECOM'S APPOINTMENT BY ITS CLIENT. AECOM ACCEPTS NO LIABILITY FOR ANY USE OF THIS DOCUMENT OTHER THAN BY ITS ORIGINAL CLIENT OR FOLLOWING AECOM'S EXPRESS AGREEMENT TO SUCH USE, AND ONLY FOR THE PURPOSES FOR WHICH IT WAS PREPARED AND PROVIDED.

Drawing Number HE551495	Originator ACM	Volume GEN	Rev P03
Location GEN_SW_Z_ZZ_DR_LR_0160			
Type LR			
Role DR			
Number 0160			

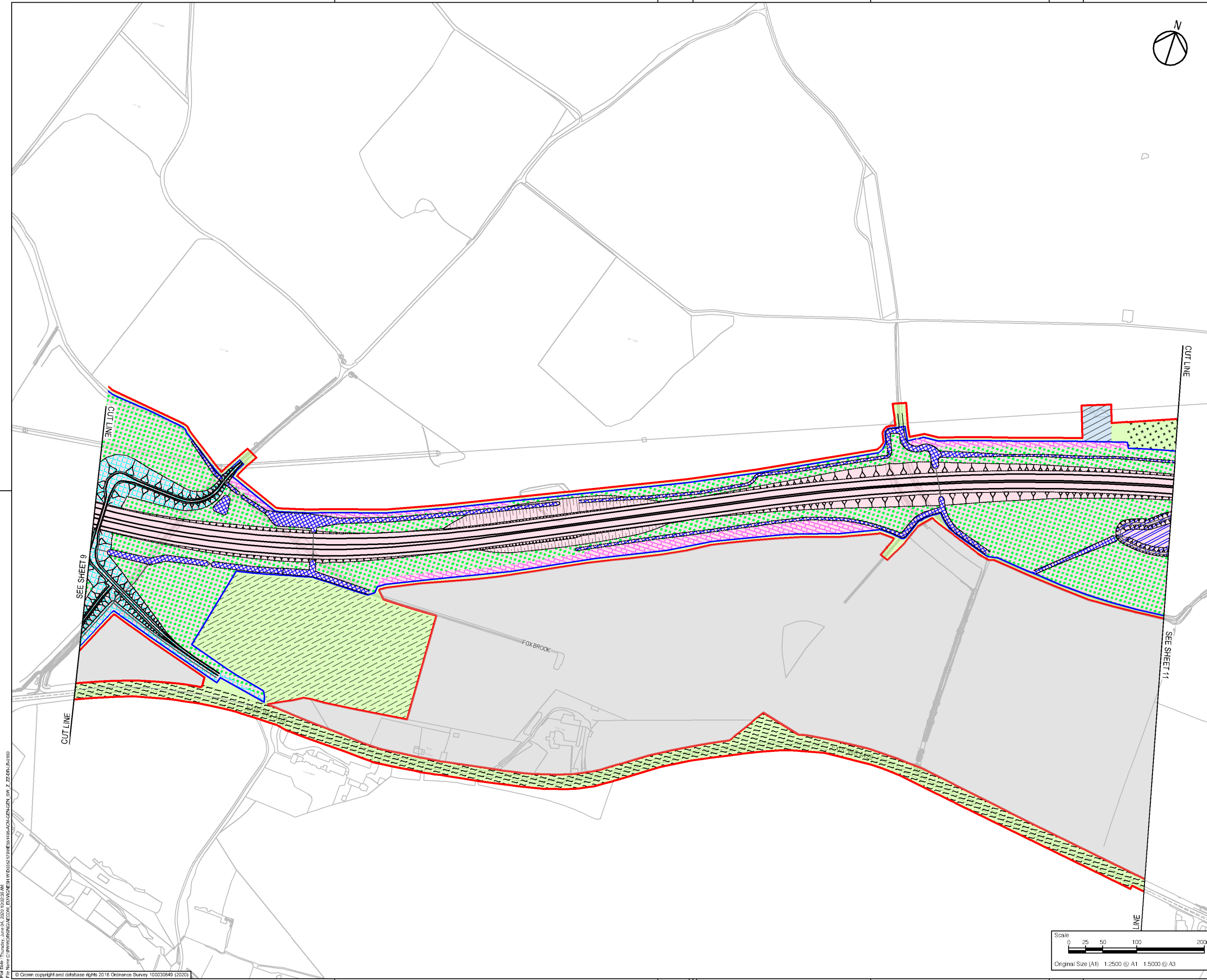
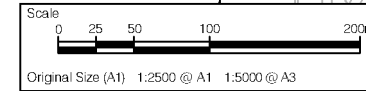

File Name: C:\P\W\UR\N\GEN\CON\EL\W\GEN\SW_Z_ZZ\DR_LR_0160.dwg
 Date: 03/06/2020 10:20:28 AM
 © Crown copyright and database rights 2016 Ordnance Survey 100030649 (2020)

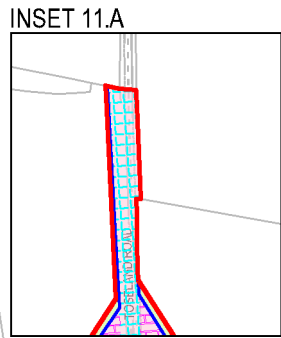

SEE INSET 11.A



- KEY**
- RED LINE BOUNDARY
 - HIGHWAY BOUNDARY
 - PERMANENT LAND ACQUISITION - MAINLINE
 - PERMANENT LAND ACQUISITION - SIDE ROADS
 - PERMANENT LAND ACQUISITION - DITCHES
 - PERMANENT LAND ACQUISITION - PONDS
 - PERMANENT LAND ACQUISITION - LANDSCAPING
 - PERMANENT LAND ACQUISITION - FLOOD STORAGE AREA
 - PERMANENT LAND ACQUISITION - BORROW PITS
 - PERMANENT LAND ACQUISITION - MATERIAL STORAGE
 - PERMANENT LAND ACQUISITION - LAND TAKEN FOR PRACTICALITY
 - PERMANENT LAND ACQUISITION - LIMITS OF DEVIATION
 - TEMPORARY LAND ACQUISITION - WORKING ROOM
 - TEMPORARY LAND ACQUISITION - CONSTRUCTION USE
 - TEMPORARY LAND ACQUISITION - STOPPING UP OF FOOTPATH
 - TEMPORARY LAND ACQUISITION - DETRUNKING EXTENTS
 - TEMPORARY LAND ACQUISITION - SITE COMPOUND
 - TEMPORARY LAND ACQUISITION - MULTIPLE-PURPOSE CONSTRUCTION AREA
 - TEMPORARY LAND ACQUISITION - PERMANENT ACCESS RIGHTS
 - TEMPORARY LAND ACQUISITION - PERMANENT ACCESS RIGHTS - STAFF DIVERSION
 - ORDER LIMITS EXCLUSION AREAS

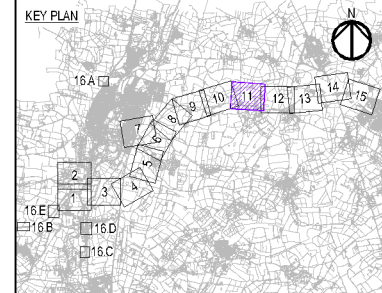

Revision Details		By	Date	Suffix
Update for Supplementary Consultation	WV	TD	03/06/20	P03
	Check			

Purpose of Issue
FOR CONSULTATION

Client
Highways England
Woodlands
Manton Lane
Manton Industrial Estate
Bedford
MK41 2LW

Working on behalf of
highways england

Development Consent Order Number
TR010044

Project Title
A428 BLACK CAT TO CAXTON GIBBET IMPROVEMENTS

Drawing Title
UPDATED LAND USE PLANS SHEET 11 OF 16

Designed JT	Drawn WV	Checked JMW	Approved TD	Date 03/06/20
Internal Project No. 60541541		Suitability DR		
Scale @ A1 1:2500		Zone General		

THIS DOCUMENT HAS BEEN PREPARED PURSUANT TO AND SUBJECT TO THE TERMS OF AECOM'S APPOINTMENT BY ITS CLIENT. AECOM ACCEPTS NO LIABILITY FOR ANY USE OF THIS DOCUMENT OTHER THAN BY ITS ORIGINAL CLIENT OR FOLLOWING AECOM'S EXPRESS AGREEMENT TO SUCH USE AND ONLY FOR THE PURPOSES FOR WHICH IT WAS PREPARED AND PROVIDED.

Drawing Number HE551495	Originator ACM	Volume GEN	Rev P03
Location GEN_SW_Z_ZZ-DR-LR-0161		Type LR	

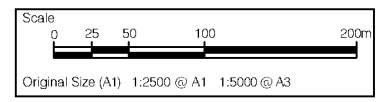
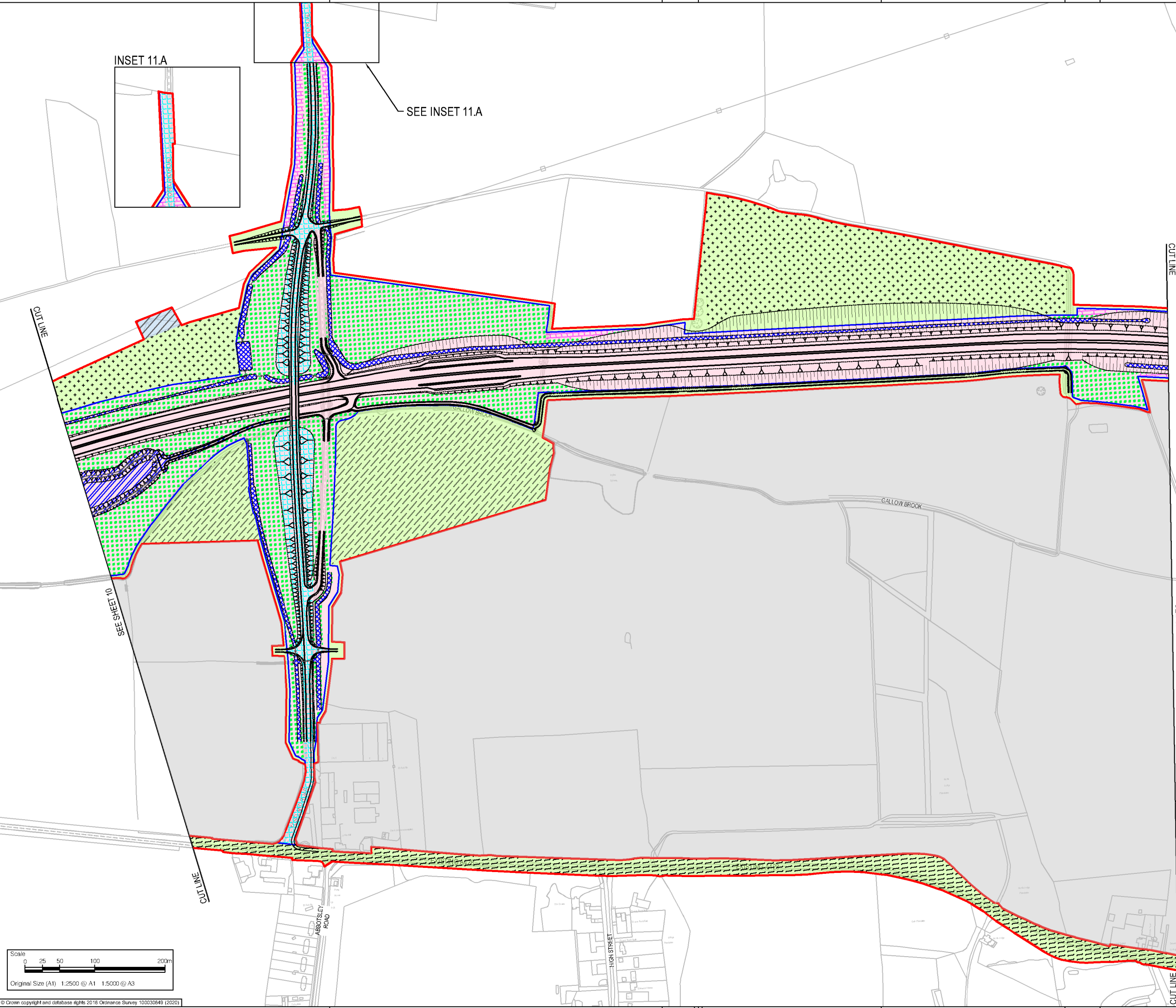

File Name: C:\pwworking\accon\ELVINGESH\W00532179\HE551495-ACM\GEN_SW_Z_ZZ-DR-LR-0161
 Plot Date: Thursday, June 04, 2020 11:02:39 AM
 © Crown copyright and database rights 2016 Ordnance Survey 100030649 (2020)

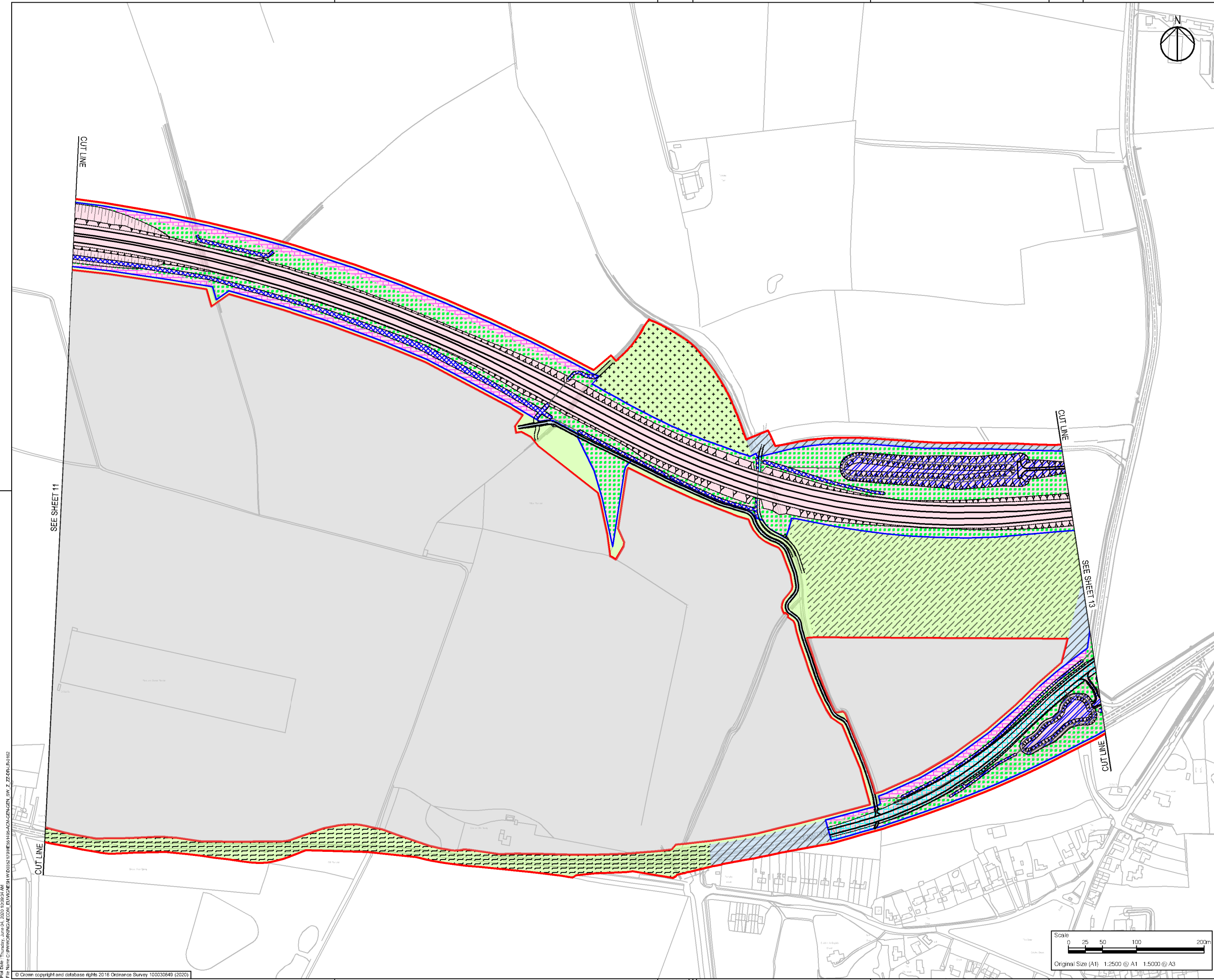

KEY

- RED LINE BOUNDARY
- HIGHWAY BOUNDARY
- PERMANENT LAND ACQUISITION - MAINLINE
- PERMANENT LAND ACQUISITION - SIDE ROADS
- PERMANENT LAND ACQUISITION - DITCHES
- PERMANENT LAND ACQUISITION - PONDS
- PERMANENT LAND ACQUISITION - LANDSCAPING
- PERMANENT LAND ACQUISITION - FLOOD STORAGE AREA
- PERMANENT LAND ACQUISITION - BORROW PITS
- PERMANENT LAND ACQUISITION - MATERIAL STORAGE
- PERMANENT LAND ACQUISITION - LAND TAKEN FOR PRACTICALITY
- PERMANENT LAND ACQUISITION - LIMITS OF DEVIATION
- TEMPORARY LAND ACQUISITION - WORKING ROOM
- TEMPORARY LAND ACQUISITION - CONSTRUCTION USE
- TEMPORARY LAND ACQUISITION - STOPPING UP OF FOOTPATH
- TEMPORARY LAND ACQUISITION - DETRUNKING EXTENTS
- TEMPORARY LAND ACQUISITION - SITE COMPOUND
- TEMPORARY LAND ACQUISITION - MULTIPLE-PURPOSE CONSTRUCTION AREA
- TEMPORARY LAND ACQUISITION - PERMANENT ACCESS RIGHTS
- TEMPORARY LAND ACQUISITION - PERMANENT ACCESS RIGHTS - STAFF DIVERSION
- ORDER LIMITS EXCLUSION AREAS

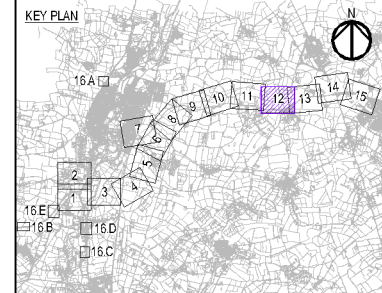

Revision Details		By	Date	Suffix
Update for Supplementary Consultation	WV	TD	03/06/20	P03
	Check			

Purpose of Issue
FOR CONSULTATION

Client
Highways England
Woodlands
Manton Lane
Manton Industrial Estate
Bedford
MK41 2LW

Working on behalf of
highways england

Development Consent Order Number
TR010044

Project Title
A428 BLACK CAT TO CAXTON GIBBET IMPROVEMENTS

Drawing Title
UPDATED LAND USE PLANS SHEET 12 OF 16

Designed	Drawn	Checked	Approved	Date
JT	WV	JMW	TD	03/06/20
Internal Project No. 60541541		Suitability DR		
Scale @ A1 1:2500		Zone General		

THIS DOCUMENT HAS BEEN PREPARED PURSUANT TO AND SUBJECT TO THE TERMS OF AECOM'S APPOINTMENT BY ITS CLIENT. AECOM ACCEPTS NO LIABILITY FOR ANY USE OF THIS DOCUMENT OTHER THAN BY ITS ORIGINAL CLIENT OR FOLLOWING AECOM'S EXPRESS AGREEMENT TO SUCH USE, AND ONLY FOR THE PURPOSES FOR WHICH IT WAS PREPARED AND PROVIDED.

Drawing Number	Originator	Volume	Rev
HE551495	ACM	GEN	P03
GEN_SW_Z_ZZ_DR_LR_0162			
Location	Type	Role	Number

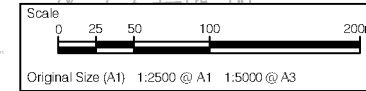

File Name: C:\P\W\UR\N\A\ACOM\EL\W\G\5\17\9\HE551495-ACM\GEN_SW_Z_ZZ\DR_LR_0162
 Plot Date: Thursday, June 04, 2020 10:09:04 AM
 © Crown copyright and database rights 2016 Ordnance Survey 100030649 (2020)

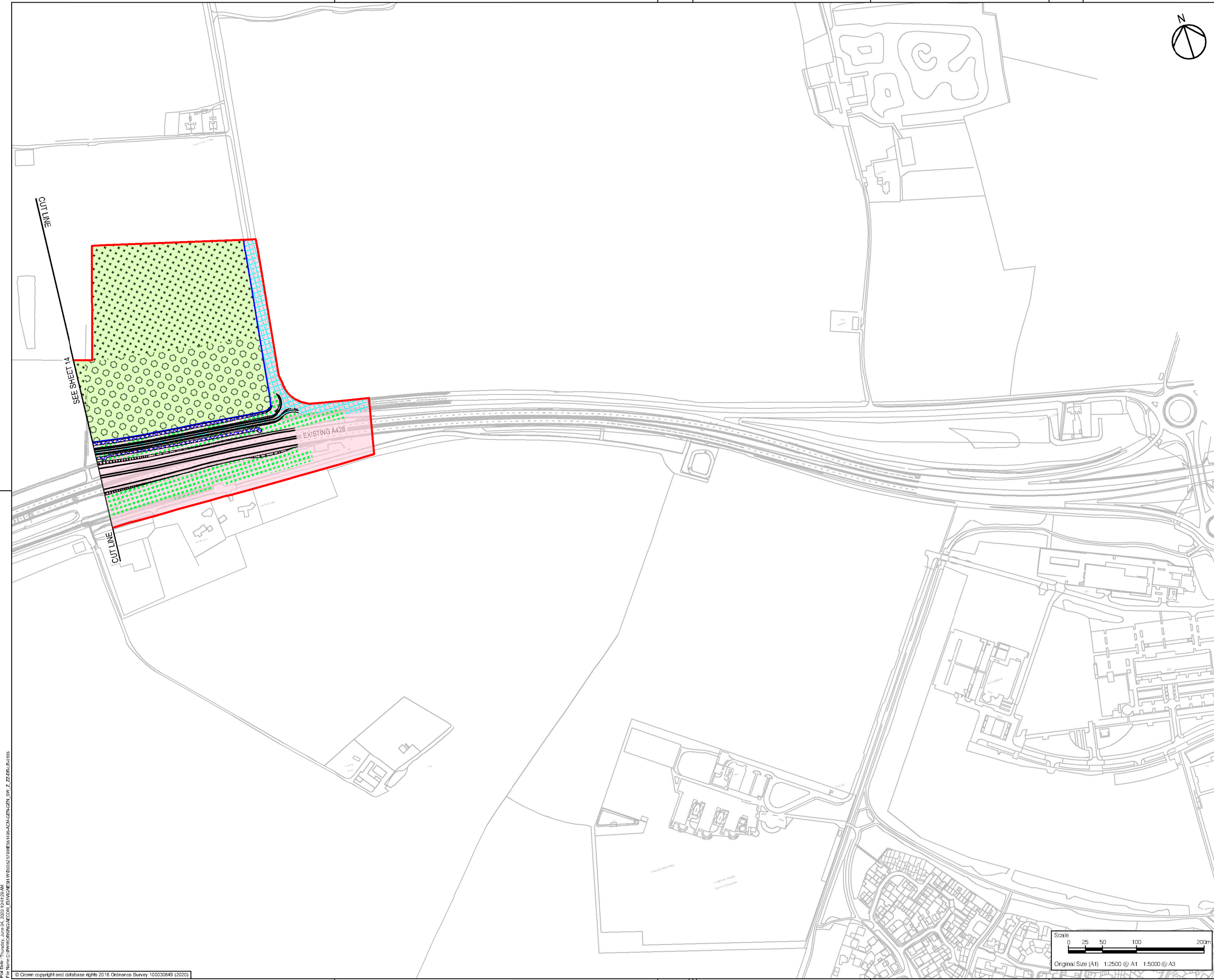

KEY

- RED LINE BOUNDARY
- HIGHWAY BOUNDARY
- PERMANENT LAND ACQUISITION - MAINLINE
- PERMANENT LAND ACQUISITION - SIDE ROADS
- PERMANENT LAND ACQUISITION - DITCHES
- PERMANENT LAND ACQUISITION - PONDS
- PERMANENT LAND ACQUISITION - LANDSCAPING
- PERMANENT LAND ACQUISITION - FLOOD STORAGE AREA
- PERMANENT LAND ACQUISITION - BORROW PITS
- PERMANENT LAND ACQUISITION - MATERIAL STORAGE
- PERMANENT LAND ACQUISITION - LAND TAKEN FOR PRACTICALITY
- PERMANENT LAND ACQUISITION - LIMITS OF DEVIATION
- TEMPORARY LAND ACQUISITION - WORKING ROOM
- TEMPORARY LAND ACQUISITION - CONSTRUCTION USE
- TEMPORARY LAND ACQUISITION - STOPPING UP OF FOOTPATH
- TEMPORARY LAND ACQUISITION - DETRUNKING EXTENTS
- TEMPORARY LAND ACQUISITION - SITE COMPOUND
- TEMPORARY LAND ACQUISITION - MULTIPLE-PURPOSE CONSTRUCTION AREA
- TEMPORARY LAND ACQUISITION - PERMANENT ACCESS RIGHTS
- TEMPORARY LAND ACQUISITION - PERMANENT ACCESS RIGHTS - STAFF DIVERSION
- ORDER LIMITS EXCLUSION AREAS

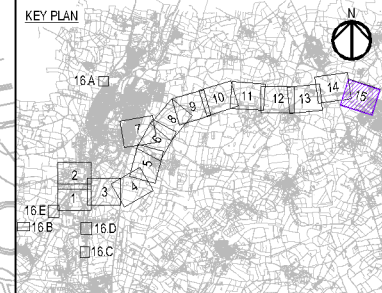

Revision Details	By	Check	Date	Suffix
Update for Supplementary Consultation	WV	TD	03/06/20	P03

FOR CONSULTATION

Client
Highways England
Woodlands
Manton Lane
Manton Industrial Estate
Bedford
MK41 2LW

Working on behalf of
highways england

Development Consent Order Number
TR010044

Project Title
A428 BLACK CAT TO CAXTON GIBBET IMPROVEMENTS

Drawing Title
UPDATED LAND USE PLANS SHEET 15 OF 16

Designed	Drawn	Checked	Approved	Date
JT	WV	JMW	TD	03/06/20

Internal Project No. 60541541
Subsidiary DB

Scale @ A1 1:2500
Zone General

THIS DOCUMENT HAS BEEN PREPARED PURSUANT TO AND SUBJECT TO THE TERMS OF AECOM'S APPOINTMENT BY ITS CLIENT. AECOM ACCEPTS NO LIABILITY FOR ANY USE OF THIS DOCUMENT OTHER THAN BY ITS ORIGINAL CLIENT OR FOLLOWING AECOM'S EXPRESS AGREEMENT TO SUCH USE AND ONLY FOR THE PURPOSES FOR WHICH IT WAS PREPARED AND PROVIDED.

Drawing Number	Highways England PIN	Originator	Volume	Rev
HE551495	ACM	GEN		P03

Location: GEN_SW_Z_ZZ_DR_LR_0165
Type: R
Role: L
Number: 0165

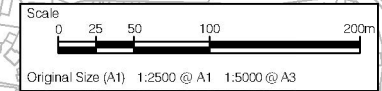

If you need help accessing this or any other Highways England information, please call **0300 123 5000** and we will help you.

These plans show current proposals and are published for the purposes of consultation on the scheme. The proposals are therefore subject to change as a result of responses to the consultation and further design development.

© Crown copyright 2020.

You may re-use this information (not including logos) free of charge in any format or medium, under the terms of the Open Government Licence. To view this licence:

visit www.nationalarchives.gov.uk/doc/open-government-licence/

write to the **Information Policy Team, The National Archives, Kew, London TW9 4DU**, or email psi@nationalarchives.gsi.gov.uk.

Mapping (where present): © Crown copyright and database rights 2019 OS 100030649. You are permitted to use this data solely to enable you to respond to, or interact with, the organisation that provided you with the data. You are not permitted to copy, sub-licence, distribute or sell any of this data to third parties in any form.

This document is also available on our website at www.highwaysengland.co.uk

For an accessible version of this publication please call **0300 123 5000** and we will help you.

If you have any enquiries about this publication email info@highwaysengland.co.uk or call **0300 123 5000***. Please quote the Highways England publications code **PR253/18**.

Highways England creative job number BED20 0050

*Calls to 03 numbers cost no more than a national rate call to an 01 or 02 number and must count towards any inclusive minutes in the same way as 01 and 02 calls.

These rules apply to calls from any type of line including mobile, BT, other fixed line or payphone. Calls may be recorded or monitored.

Printed on paper from well-managed forests and other controlled sources when issued directly by Highways England.

Registered office Bridge House, 1 Walnut Tree Close, Guildford GU1 4LZ

Highways England Company Limited registered in England and Wales number 09346363